

## STATEMENT

---

I am \_\_\_\_\_, Superintendent of the Willis Riffe Coal Company Protest Denied mine. Thank you for responding to our emergency. You are located on the surface.

Last night a 3-person crew entered the mine to perform cleanup work. When the outside person had not heard from them in a while, she tried to communicate with them and was not able to make contact. All Agencies have been contacted and are present. An action plan has been approved for mine rescue teams to explore underground. Previous mine rescue teams have established a fresh air base. The Fresh air base is what we believe to be 4 crosscuts out by the face area. A drill company has a hole down, what we think is out by the last open crosscut, that showed methane in the area. This mines also has a history of bad roof conditions.

Power to the mine fan is currently off. The mine is being ventilated by an blowing fan. The #1 entry and #3 entry are the returns. The #2 entry is the intake. All mine power underground has been disconnected. Power may be controlled by the command center.

## PROBLEM

---

- Once Started the Mine Fan can not be stopped, stalled, or reversed.
- REPORT NAMES AND ANY EXPLOSIVE MIXTURE TO COMMAND CENTER BEFORE LEAVING TEAM STOP.
- ACCOUNT FOR ALL MISSING MINERS
- THERE IS A 90 MINUTE TIME LIMIT AND YOU WILL RECEIVE A 10 MINUTE WARNING

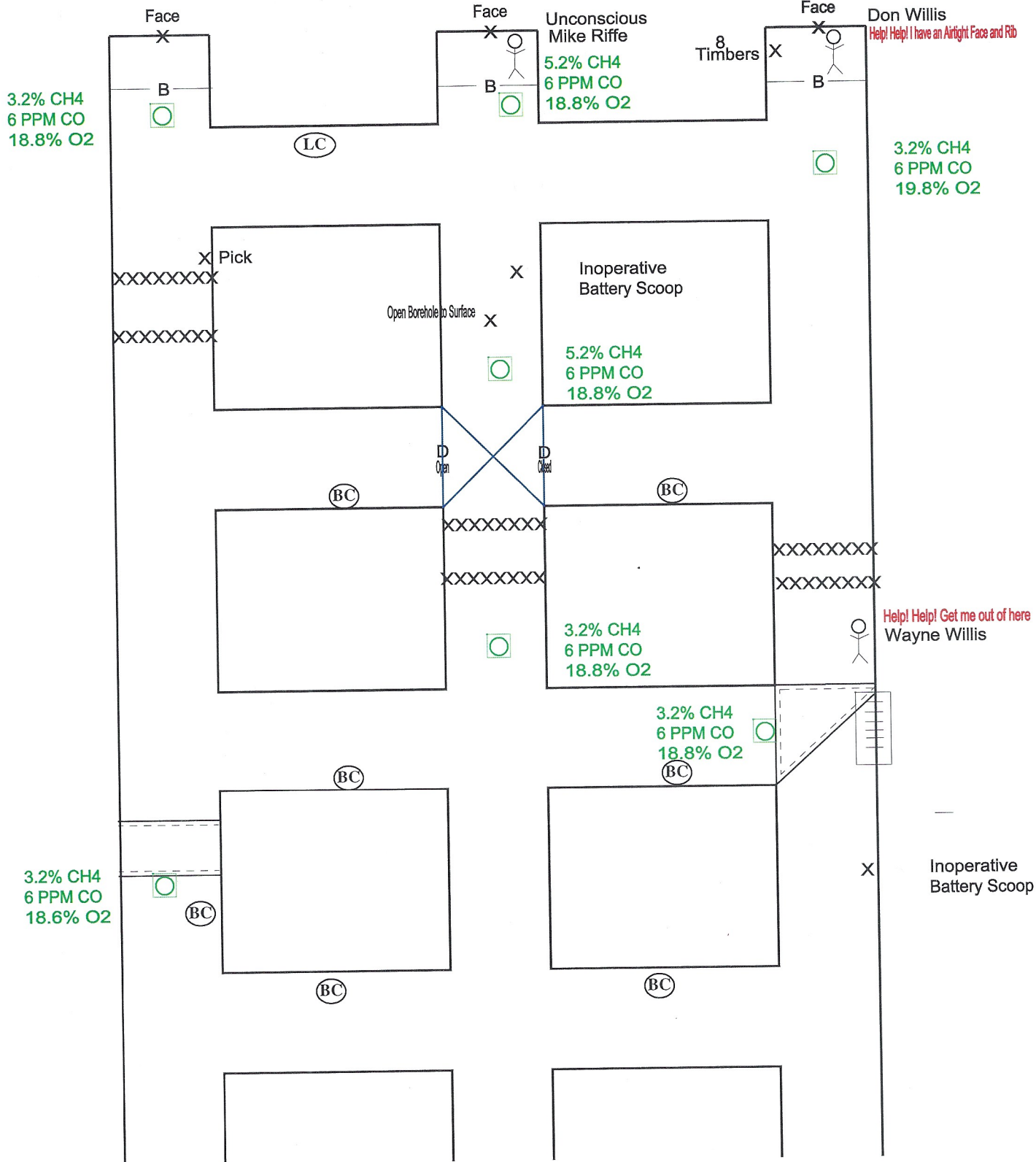

# 1st Vent

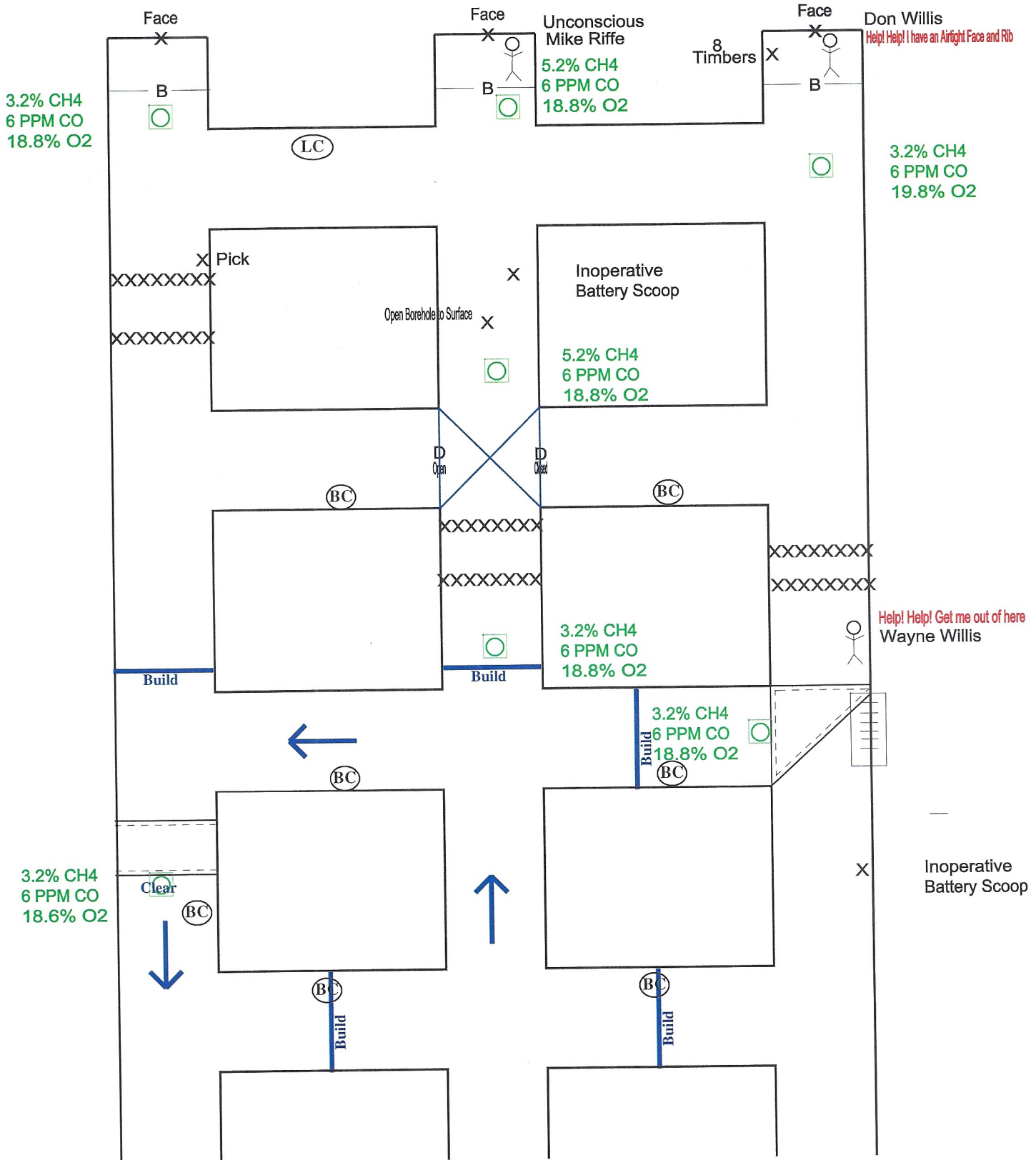

# 2nd Vent

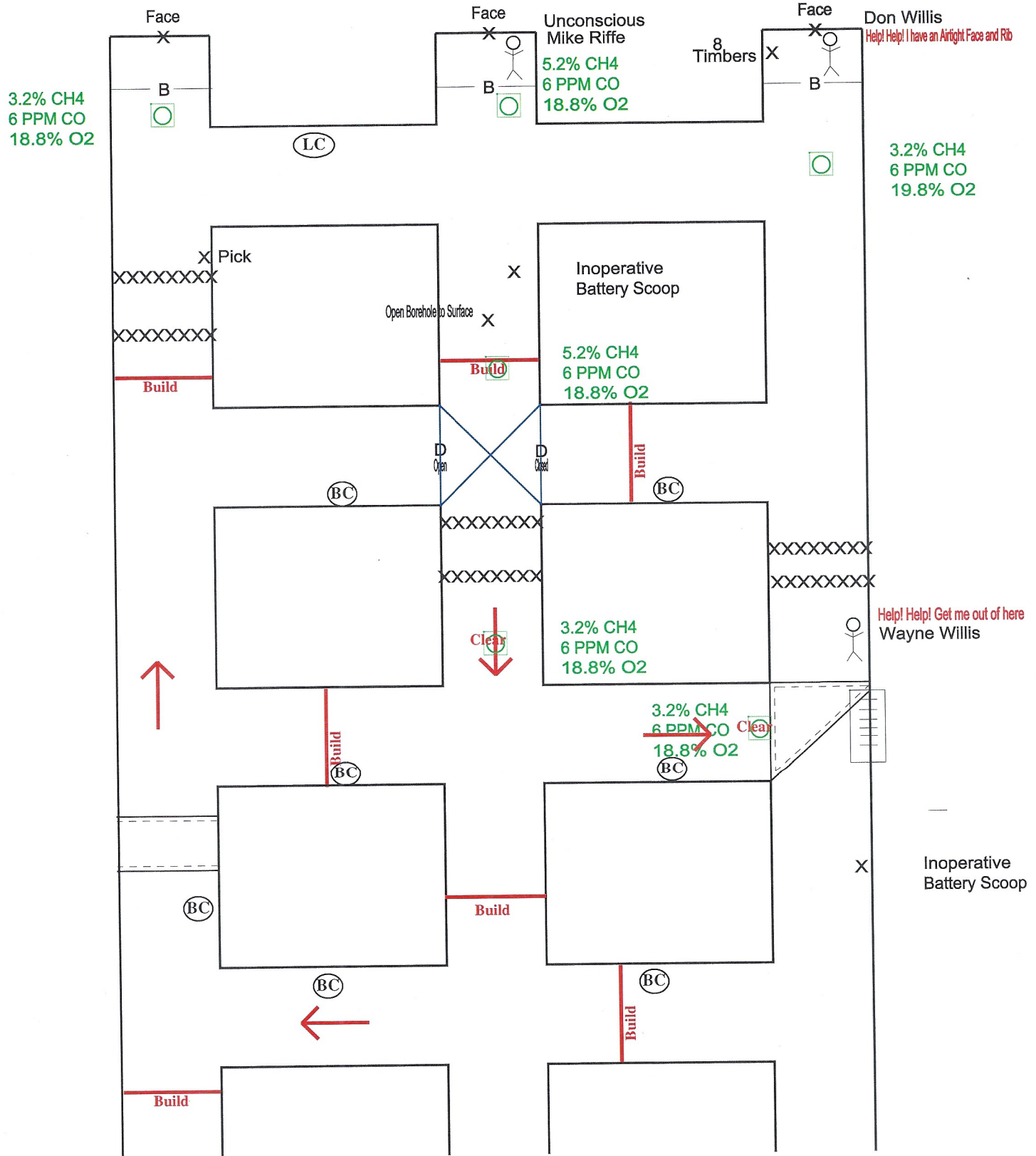



### 3rd Vent

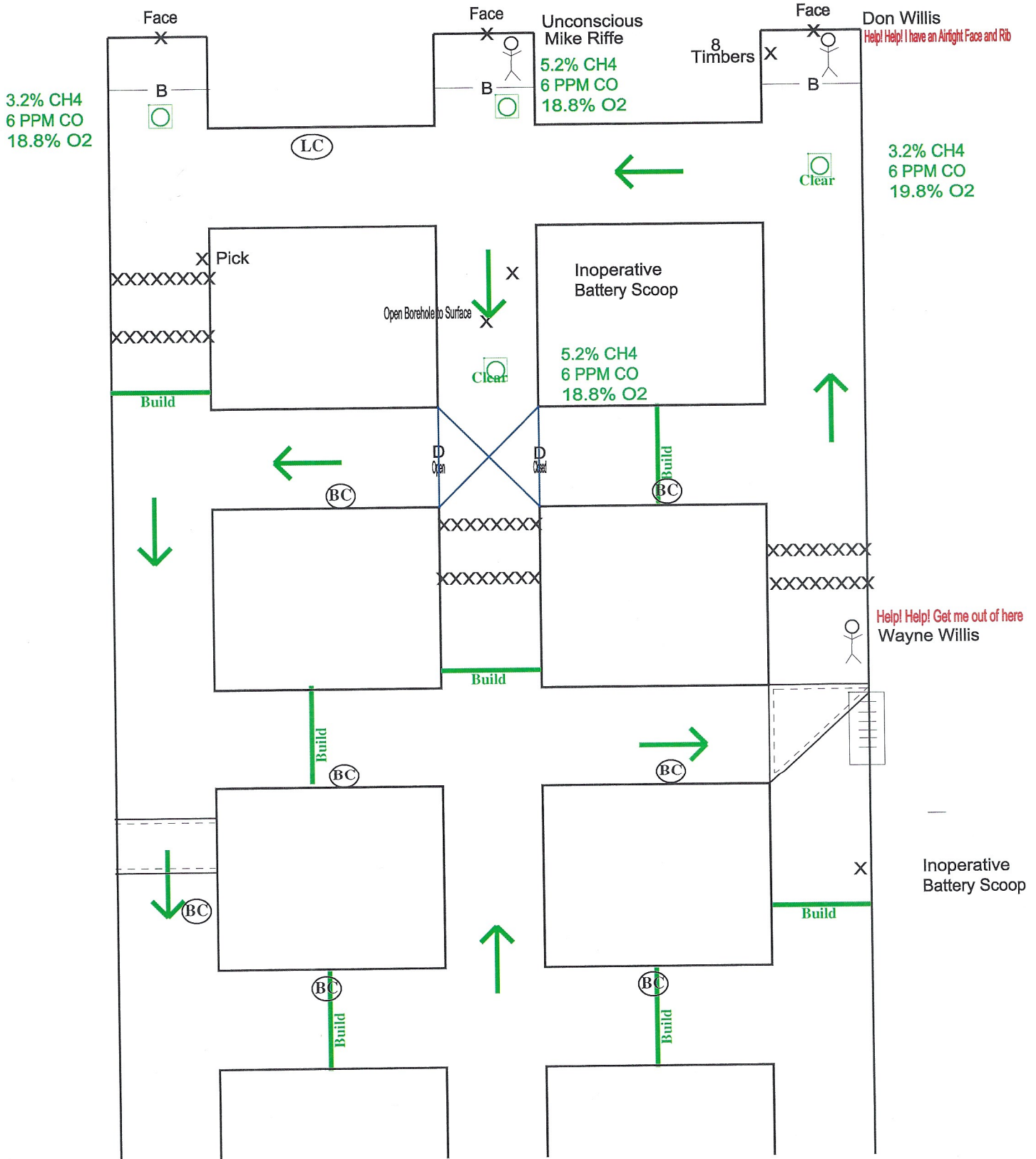

# 4th Vent

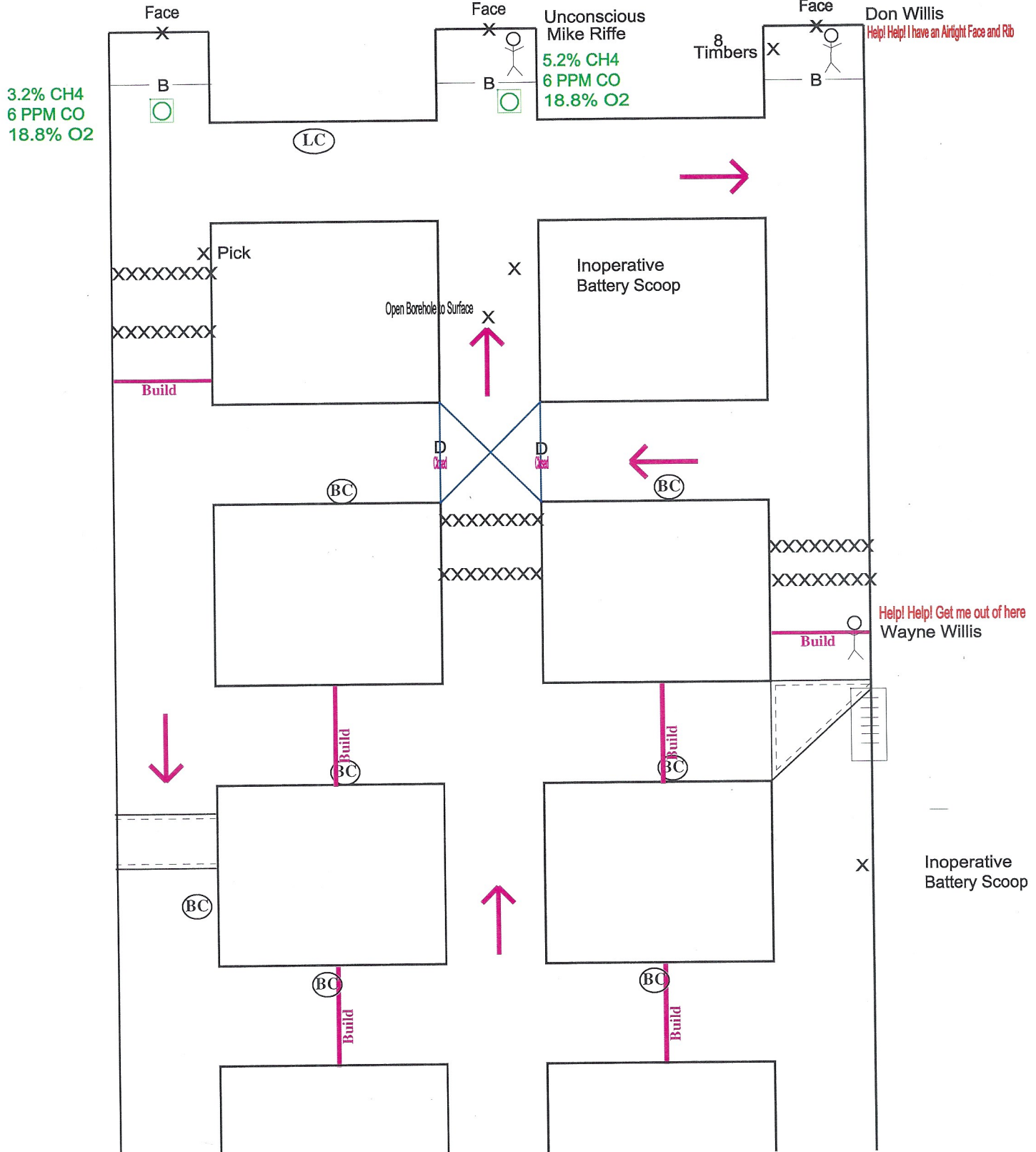

# Final Vent

