

The depth of water in no. 2 entry just inby the FAB was inadvertently left off the problem. It should be labeled "over knee deep."

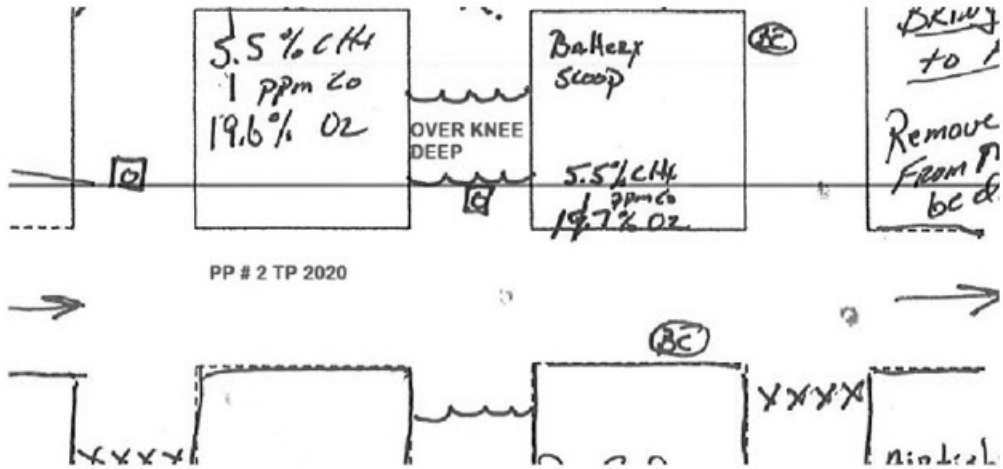

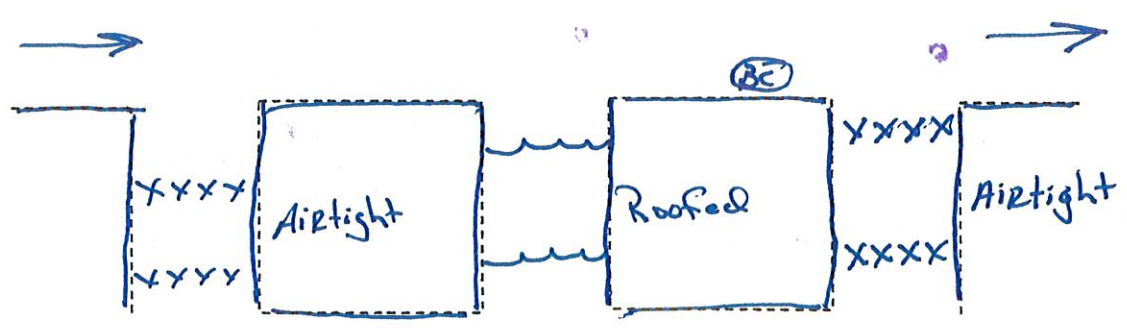

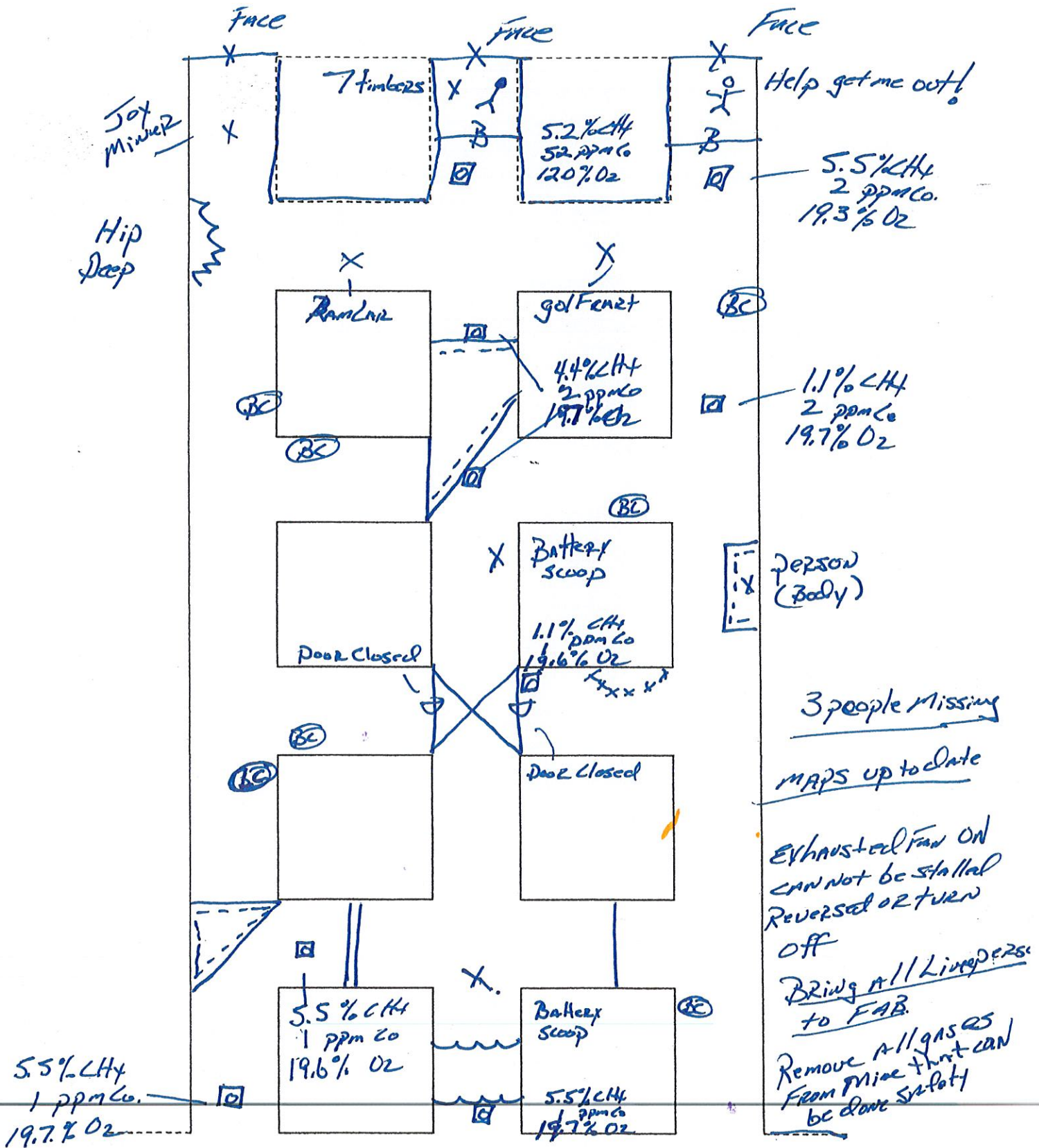
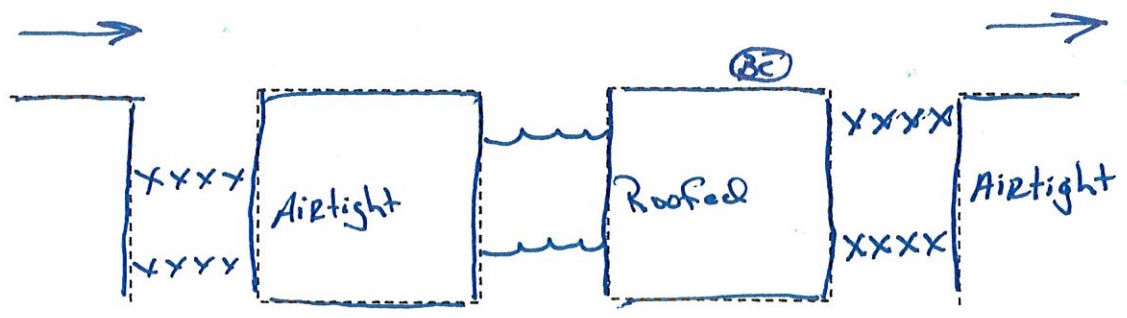
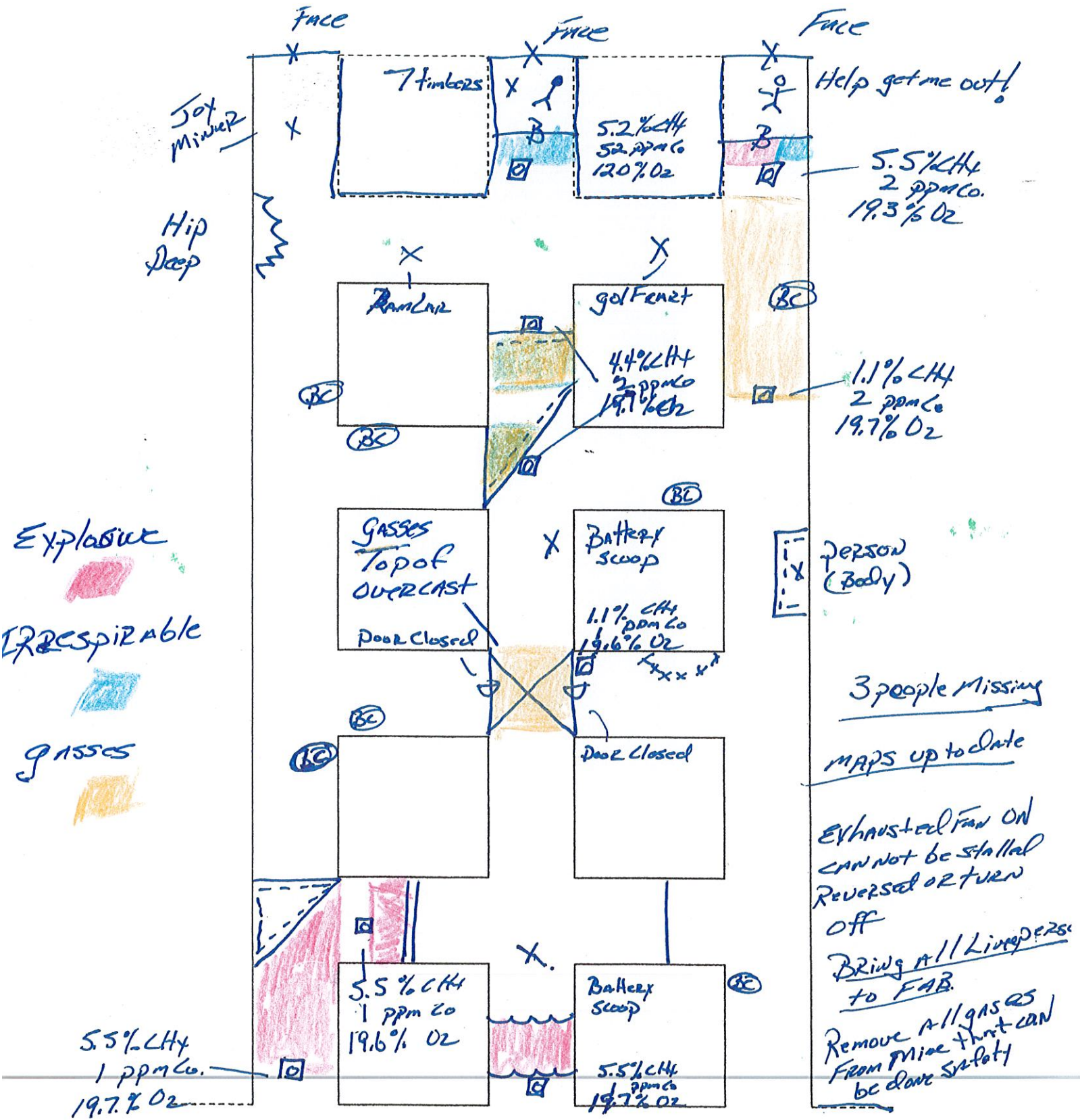

2nd Vent

Hip Deep

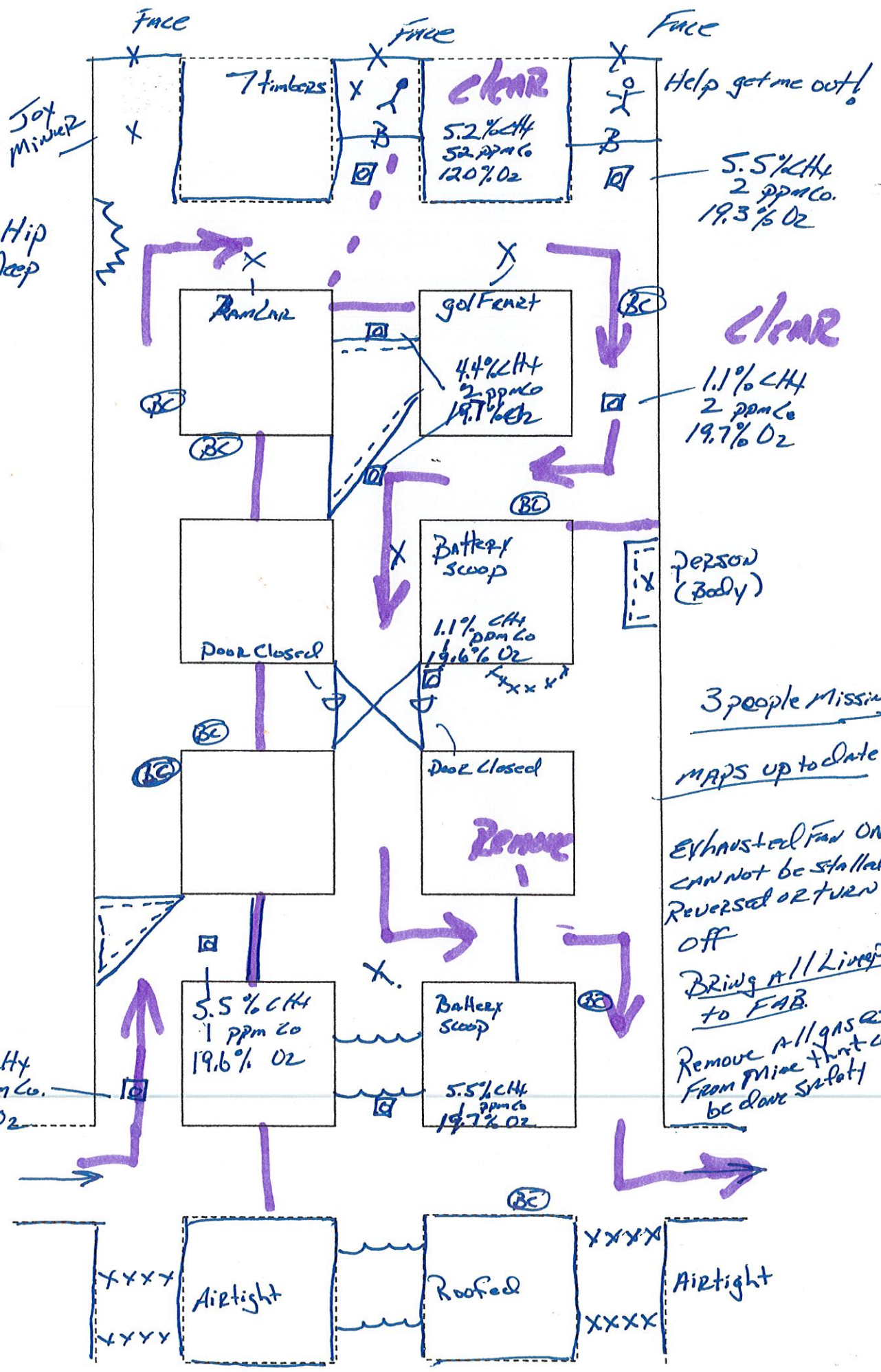

5.5% CH₄
1 ppm CO
19.7% O₂

5.5% CH₄
1 ppm CO
19.6% O₂

5.5% CH₄
1 ppm CO
19.7% O₂

EXHAUSTED FAN ON
CANNOT BE STALLED
REVERSED OR TURN
OFF

BRING ALL LIVED PERS.
TO FAB.

Remove ALL GASES
FROM MINE THAT CAN
BE DONE SAFELY

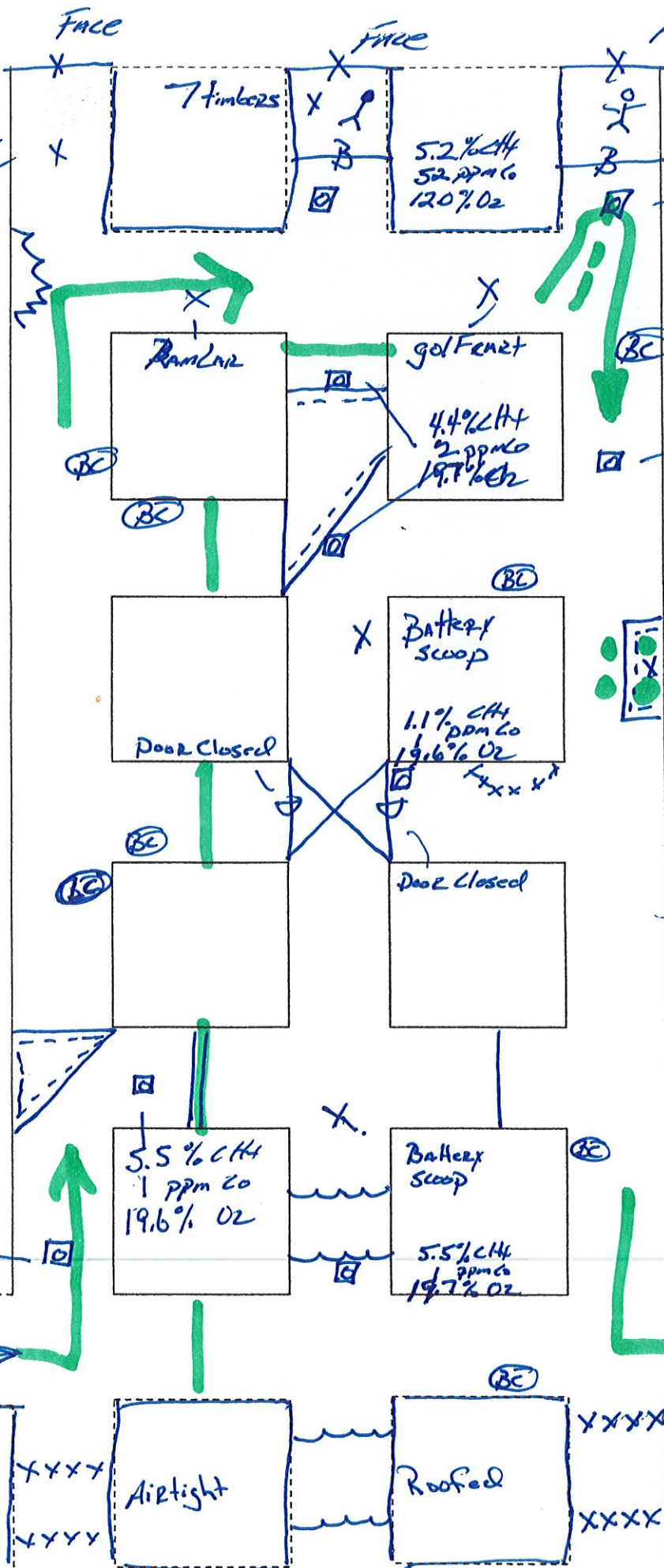

320 Vent

Joy Miner

Hip Deep

Help get me out!
Chad
 5.5% CH₄
 2 ppm CO
 19.3% O₂

7 timbers
 5.2% CH₄
 52 ppm CO
 12.0% O₂

golfer net
 4.4% CH₄
 2 ppm CO
 19.7% O₂

1.1% CH₄
 2 ppm CO
 19.7% O₂

Tina

person (body)

3 people missing

MAPS up to date

Exhausted Fan ON
 cannot be stalled
 Reversed or turn
 off

Bring all Live person
 to FAB.

Remove all gases
 from mine that can
 be done safely

5.5% CH₄
 1 ppm CO
 19.7% O₂

5.5% CH₄
 1 ppm CO
 19.6% O₂

5.5% CH₄
 1 ppm CO
 19.7% O₂

Airtight

Roofed

Airtight

4th Vent
Remove GASSES

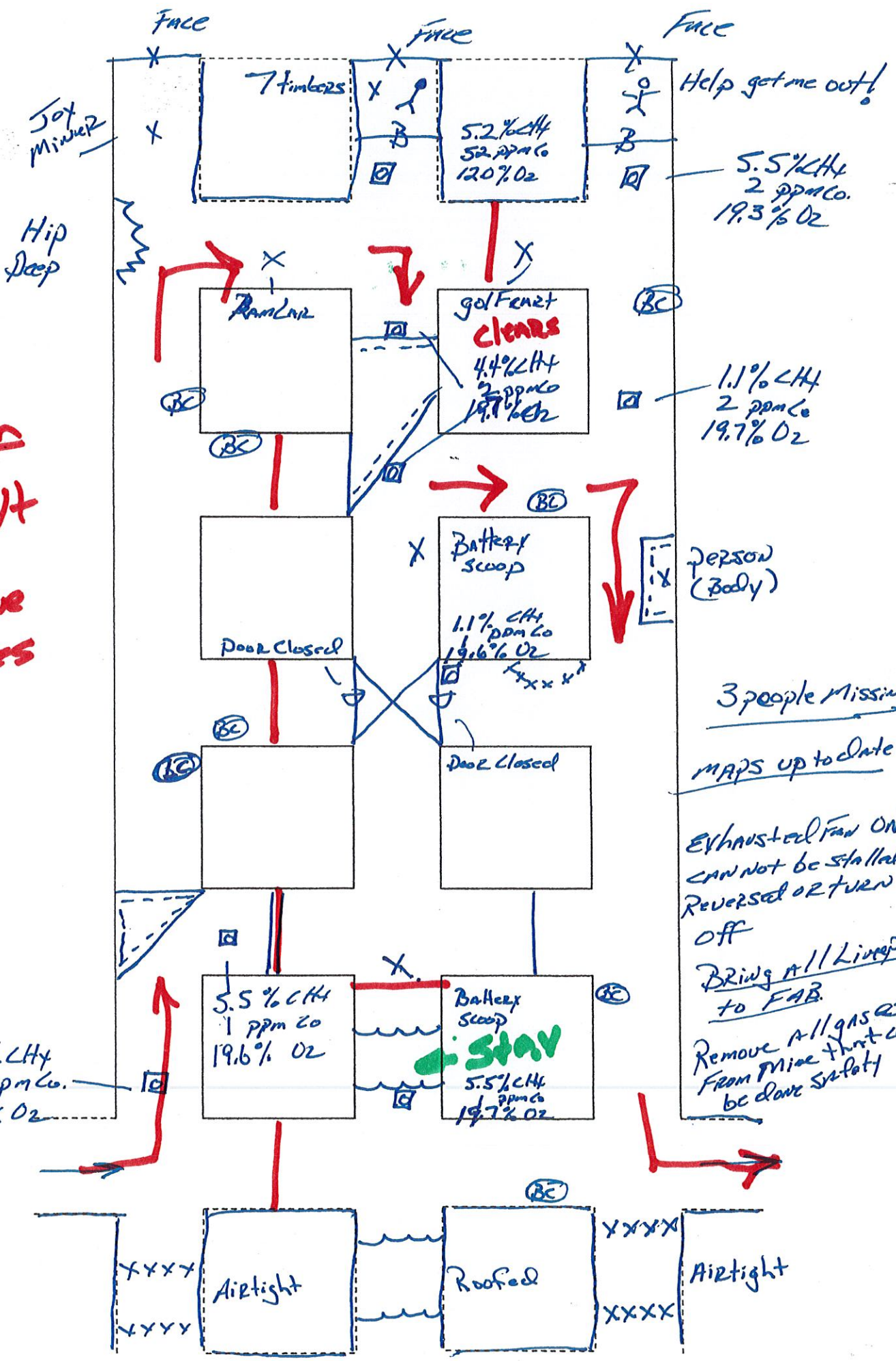

3 people missing
MAPS up to date
EXHAUSTED fan ON cannot be stalled REVERSED or TURN OFF
Bring ALL Live pers. to FAB.
Remove ALL GASSES From mine that can be done SAFELY

