

PROBLEM #18

**DH**

STATEMENT

WE APPRECIATE YOU ANSWERING OUR CALL FOR HELP.

LAST NIGHT A BUMP OCCURED AND THE MINE WAS EVACUATED. WE HAD CONTRACTORS WHO WERE WORKING THEIR FIRST SHIFT AT THIS MINE WHO WERE TAKEN TO THEIR WORK AREA BY AN OUTBY FOREMAN. THE OUTBY FOREMAN WAS ASSIGNED TO "PLACE THEM UP", DIRECT THEIR WORK AND PICK THEM UP AT QUITTING TIME. DURING THE SHIFT, ONE OF OUR FIREBOSSSES HAD TO LEAVE UNEXPECTEDLY AND THE OUBY FOREMAN HAD TO LEAVE THE CONTRACTORS WHILE HE WENT TO HELP FIREBOSS THE BELTS.

WHEN THE FOREMAN LEFT, HE INSTRUCTED A BELTMAN TO PICK THE CONTRACTORS UP AT QUITTING TIME. WHEN THE BUMP OCCURED, THE BELTMAN FAILED TO GO TO THE AREA THE CONTRACTORS WERE IN AND PICK THEM UP. WHEN THE OUTBY FOREMAN GOT TO THE SURFACE, THE BELTMAN HAD LEFT AND THE FOREMAN ASSUMED THE CONTRACTORS WERE GONE ALSO.

WHEN THE CONTRACTORS WHO WERE TO WORK ON THE NEXT SHIFT ARRIVED ON THE PROPERTY, ONE OF THEM, RECOGNIZING THE OTHER CONTRACTORS VEHICLES, CAME AND TOLD THE MINE FOREMAN HE HAD TRIED TO FIND THE PEOPLE WHO DROVE THE VEHICLES BUT DID NOT FIND ANY OF THEM ON THE PROPERTY. THE MINE FOREMAN GOT IN TOUCH WITH THE COMPANY THE CONTRACTORS WORK FOR AND HAD THEM TRY AND CONTACT THE MEN WHO WERE ON THE SHIFT THE BUMP OCCURED ON. IT WAS THEN WE BECAME AWARE THE CONTRACTORS HAD NOT COME OUT OF THE MINE.

UPON REENTRY INTO THE MINE, TO ACCESS THE DAMAGE TO THE MINE AND TO LOOK FOR THE CONTRACTORS, HIGH LEVELS OF METHANE WERE FOUND. MINE RESCUE TEAMS WERE CALLED IN TO VENTILATE THE MINE AND FIND THE MISSING CONTRACTORS.

THE AREA YOU WILL BE EXPLORING IS AN ABANDONED AREA OF THE MINE. WE NEVER SEALED THIS AREA; HOWEVER, OTHER THAN INSURING IT CAN BE EXAMINED TO MEET THE REQUIREMENTS OF THE LAW, NO WORK HAS GONE ON IN THIS AREA IN OVER A YEAR. LAST YEAR WE MOVED TO ANOTHER AREA BECAUSE MARKET CONDITIONS NO LONGER MADE IT VIABLE TO WORK IN THIS AREA.

INTAKE AIR IN THIS AREA COMES IN THE RIGHT SIDE OF THE FRESH AIR BASE. RETURN AIR GOES OUT THE NUMBER 1 ENTRY. THERE ARE NO ELECTRICAL CIRCUITS IN THE AREA, BUT I HAVE BEEN TOLD WE ABANDONED SOME EQUIPMENT IN THIS AREA.

# **Instructions**

- **Fan is off and can be turned on and off by the Command Center / BO on the surface**
- **Explore all accessible areas of the mine**
- **Account for the 3 missing miners**
- **Maps are not up to date**
- **Can carry only 2 brattice cloth while traveling**
- **Stoppings built by previous teams must stay intact**
- **No teams to do outby work**

Problem 18.1 DH

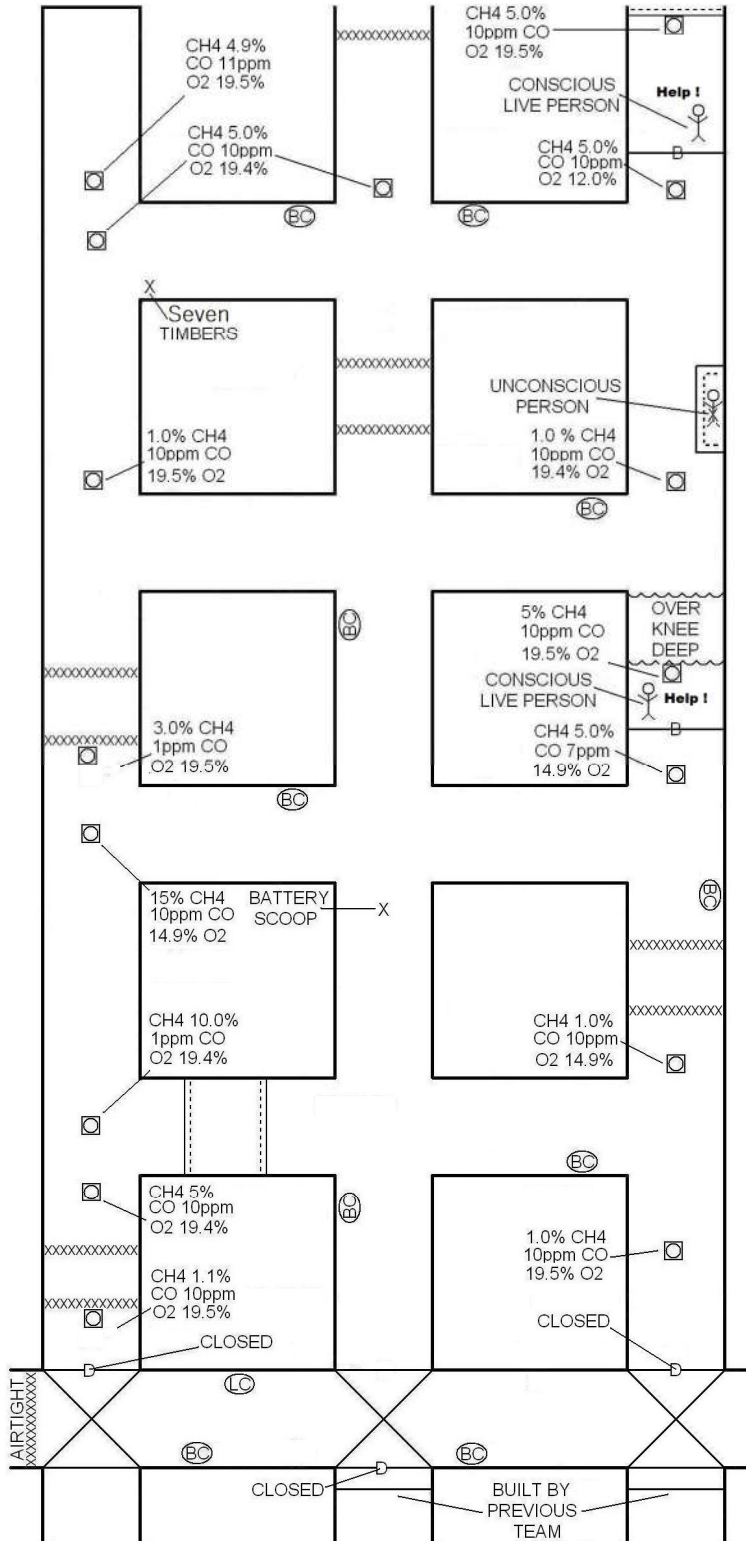

**Problem is not a quitter because of solid line map**

**Team must not go to team stop 12 until timbering is unsafe roof and vent both Barricades**

**Team can explore while in FAB, if not, must tie in before going in by crosscut B**

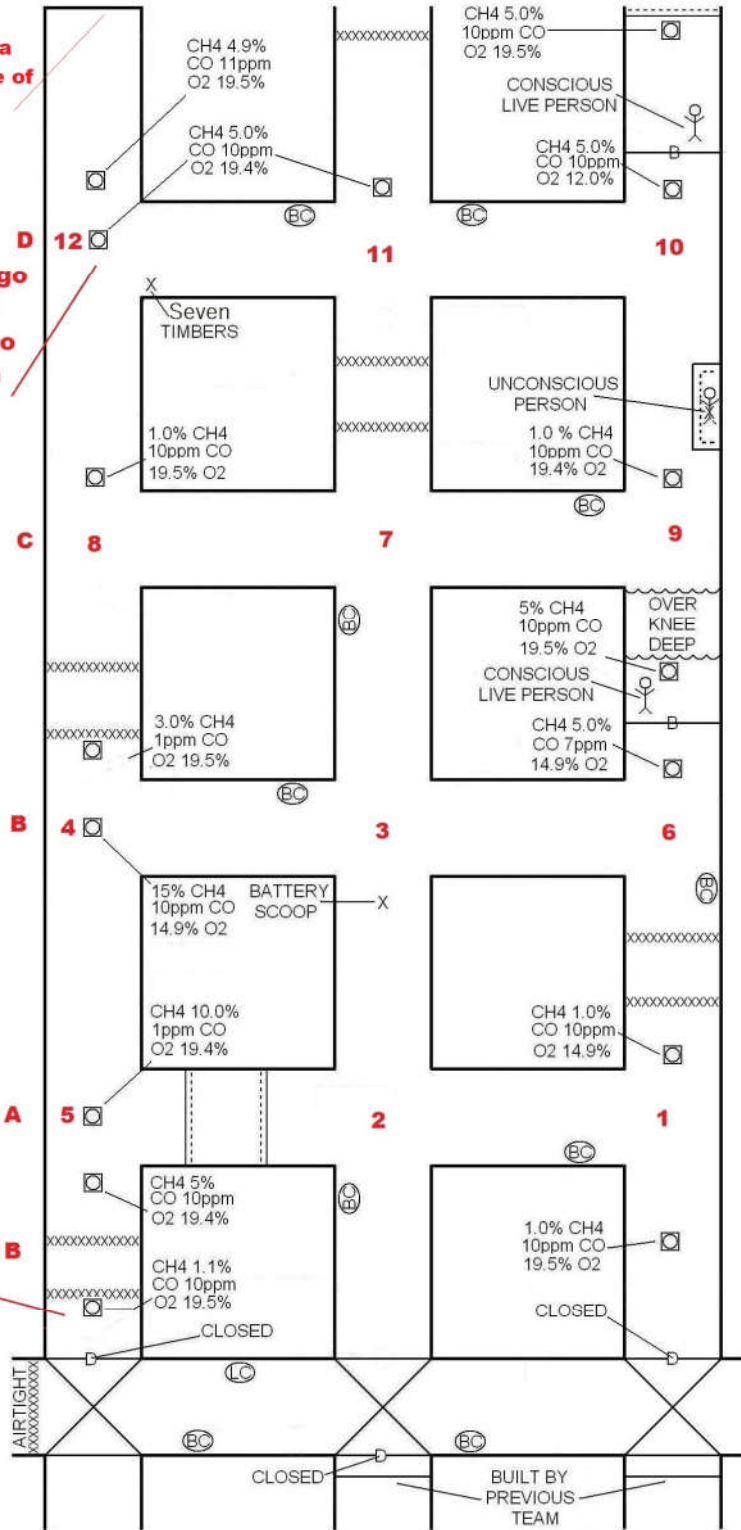

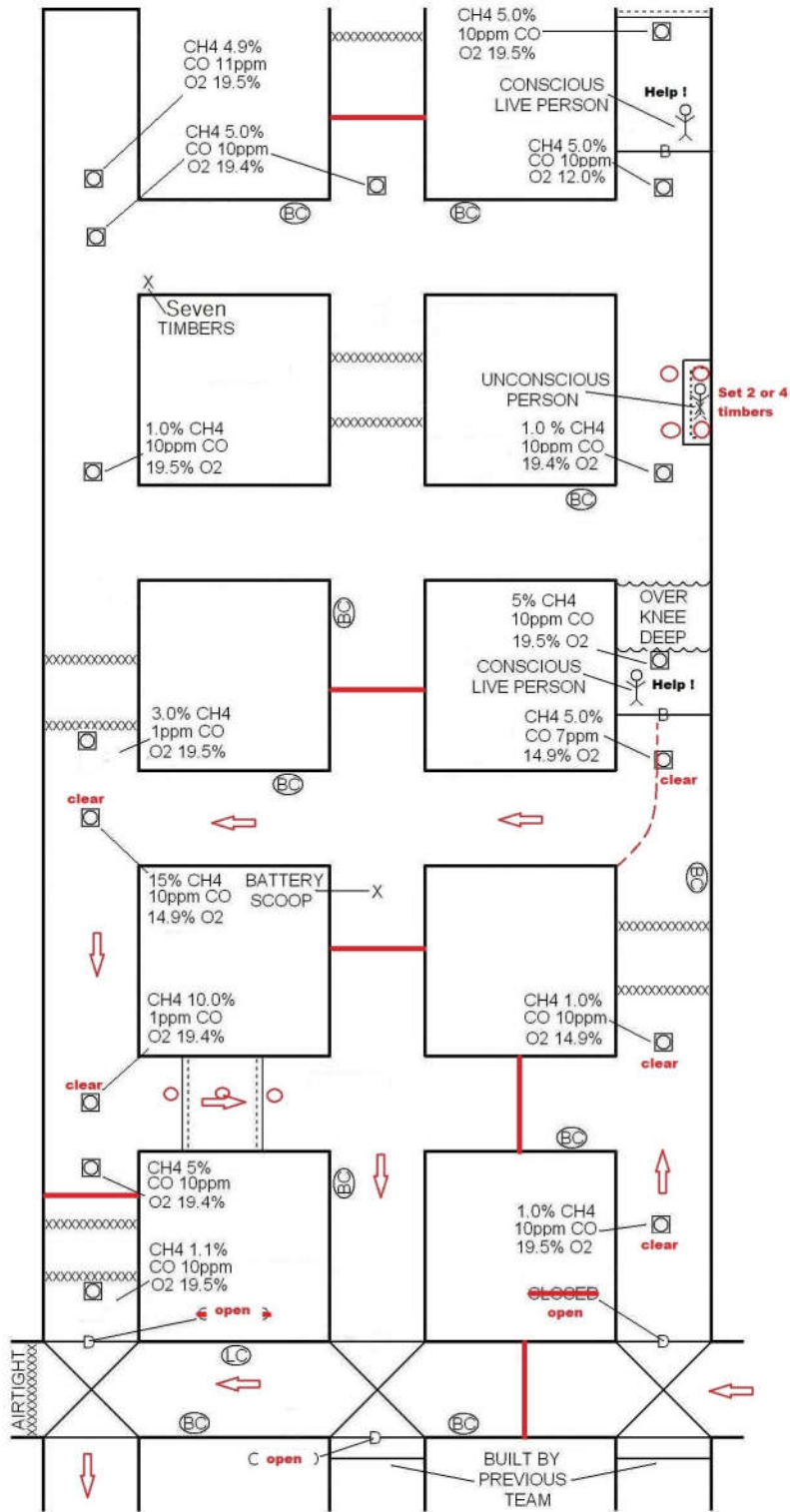

**Vent 1 or vent 2 ... Team is tied to both Barricades and can ventilate Both before going to team stop 12**

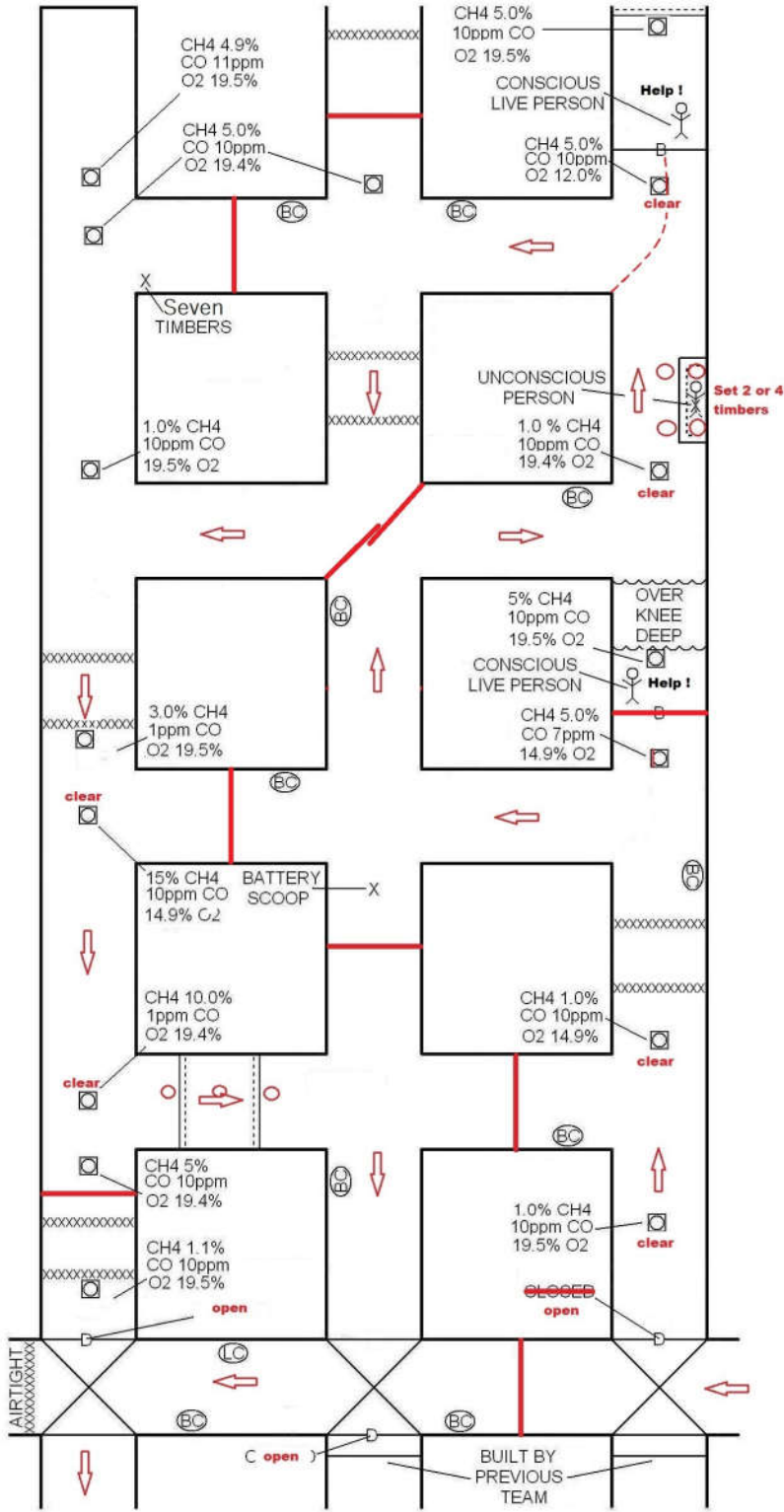

**Vent 2 or vent 1 ... Team is tied to both Barricades and can ventilate Both before going to team stop 12**

