

PROBLEM # 1 – DH

STATEMENT

YOU ARE LOCATED AT THE FRESH AIR BASE ON 5 NORTH SECTION. ALL AREAS OF THE MINE HAVE BEEN EXPLORED UP TO THIS FRESH AIR BASE. AIR IS MOVING ACROSS THE FRESH AIR BASE FROM THE #3 ENTRY TO THE #1 ENTRY. NUMBER 1 ENTRY IS NORMALLY THE RETURN AND NUMBER 3 ENTRY IS NORMALLY THE INTAKE.

AN EIGHT MAN CREW ENTERED THE MINE ON MIDNIGHT SHIFT TO DO CLEANUP, BOLTING AND MAINTENANCE IN VARIOUS PARTS OF THE MINE. AT ABOUT 3:20 A.M. THE OUTSIDE PERSON NOTICED A CHANGE OF THE TONE OF THE FAN AND SAID IT SOUNDED LIKE THE FANS DOORS BANGED. HE IMMEDIATELY STARTED CALLING INSIDE BUT COULD NOT GET IN TOUCH WITH ANYONE. ABOUT 30 MINUTES LATER, TWO OF THE MINERS WHO WERE UNDERGROUND CAME OUT OF THE PORTAL. THEY SAID THERE WAS A RUSH OF AIR OUT OF THE 5 NORTH SECTION. WHEN THEY CHECKED THE RETURN AT THE MOUTH OF 5 NORTH THEY FOUND LOW OXYGEN AND CARBON MONOXIDE.

WE THINK THERE HAS BEEN AN IGNITION / EXPLOSION INSIDE OF A SEALED AREA INBY 5 NORTH. WE SEALED THIS AREA APPROXIMATELY THREE WEEKS AGO AND HAD ALSO BUILT A SEAL AND COVERED IT WITH BACKFILL AT A SURFACE PUNCH OUT ON THE OTHER SIDE OF THE MOUNTAIN. WE HAVE BEEN NOTIFIED BY PEOPLE IN THE AREA OF THE PUNCH OUT OF A TREMENDOUS BLAST AT 3:20 A.M. THIS MORNING. SINCE THE PEOPLE WHO CAME TO THE SURFACE TOLD US THEY FOUND CARBON MONOXIDE IN THE RETURN AT THE MOUTH OF 5 NORTH AND THE BLAST CAME OUT THE PUNCHOUT, WE BELIEVE THE SEALS HAVE BEEN BREACHED ON 5 NORTH.

THE TWO PEOPLE WHO CAME TO THE SURFACE TOLD US EVERYONE ELSE WAS SUPPOSED TO BE PREPARING THE EQUIPMENT ON 5 NORTH TO BE MOVED.

THE MINE IS WALKING HEIGHT. THE ROOF IS SUPPORTED BY ROOF BOLTS. METHANE, WATER AND ADVERSE ROOF CONDITIONS ARE COMMON AT THIS MINE. ALL ELECTRICAL POWER INTO THE MINE HAS BE DISCONNECTED, LOCKED OUT AND IS GUARDED. THE FAN, WHICH IS ON THE SURFACE, IS RUNNING AND CANNOT BE REVERSED. THE FAN MUST REMAIN ON AT ALL TIMES AND CANNOT BE STALLED.

THE MINE MAP IS ACCURATE AS OF THREE WEEKS AGO.

MINE RESCUE TEAMS ARE PRESENT TO SERVE AS BACKUP WHILE YOUR TEAM WORKS.

THIS IS ALL THE INFORMATION I HAVE AT THIS TIME.

PROBLEM

ACCOUNT FOR ALL MISSING MINERS.

BRING ALL SURVIVORS TO THE FRESH AIR BASE.

EXPLORE THE MINE IN ITS ENTIRETY IF IT CAN BE
SAFELY DONE.

PATIENT STATEMENT

HELP! GET ME OUT OF HERE!

Please use this map only as
your layout and placard map

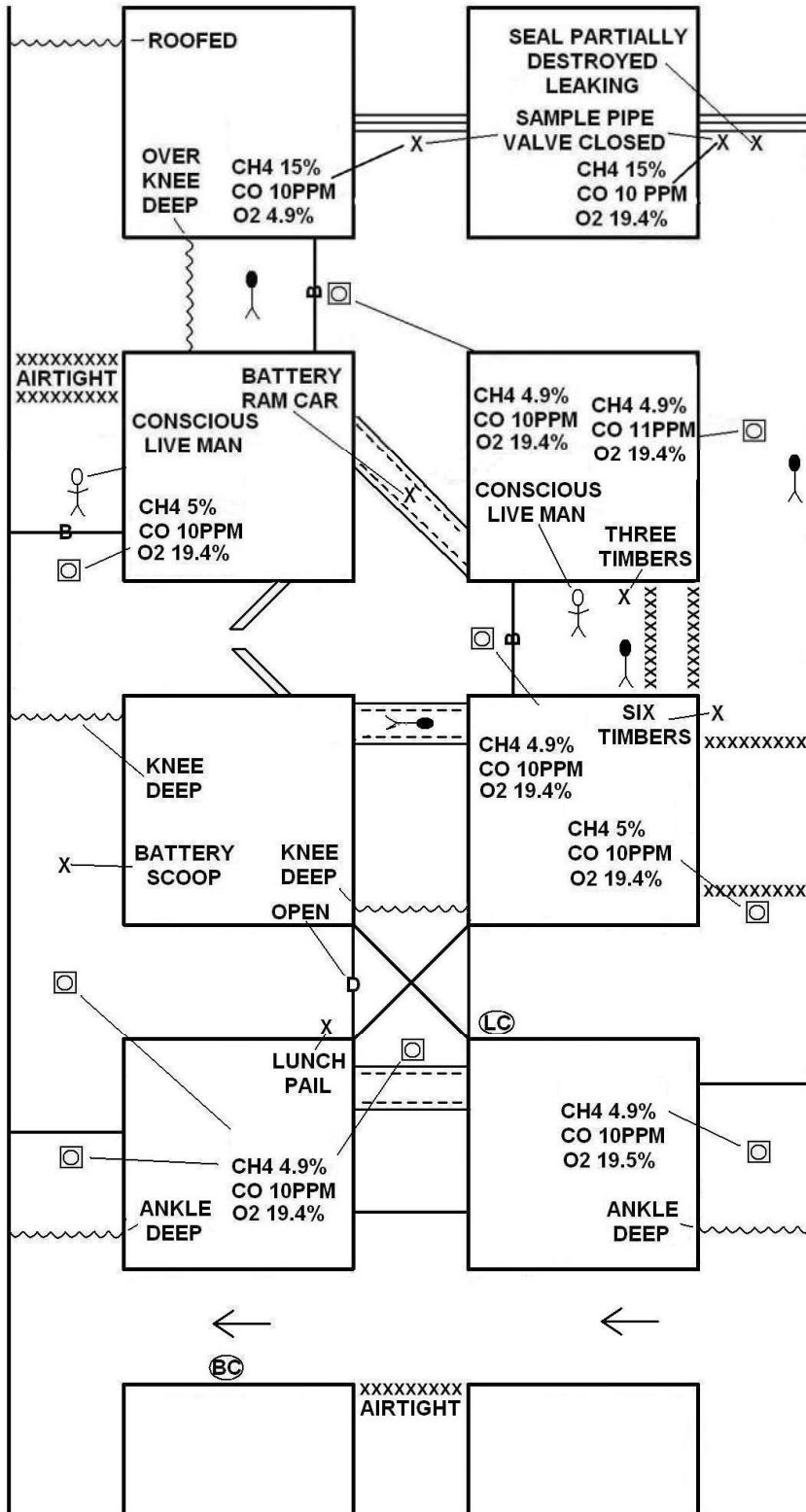

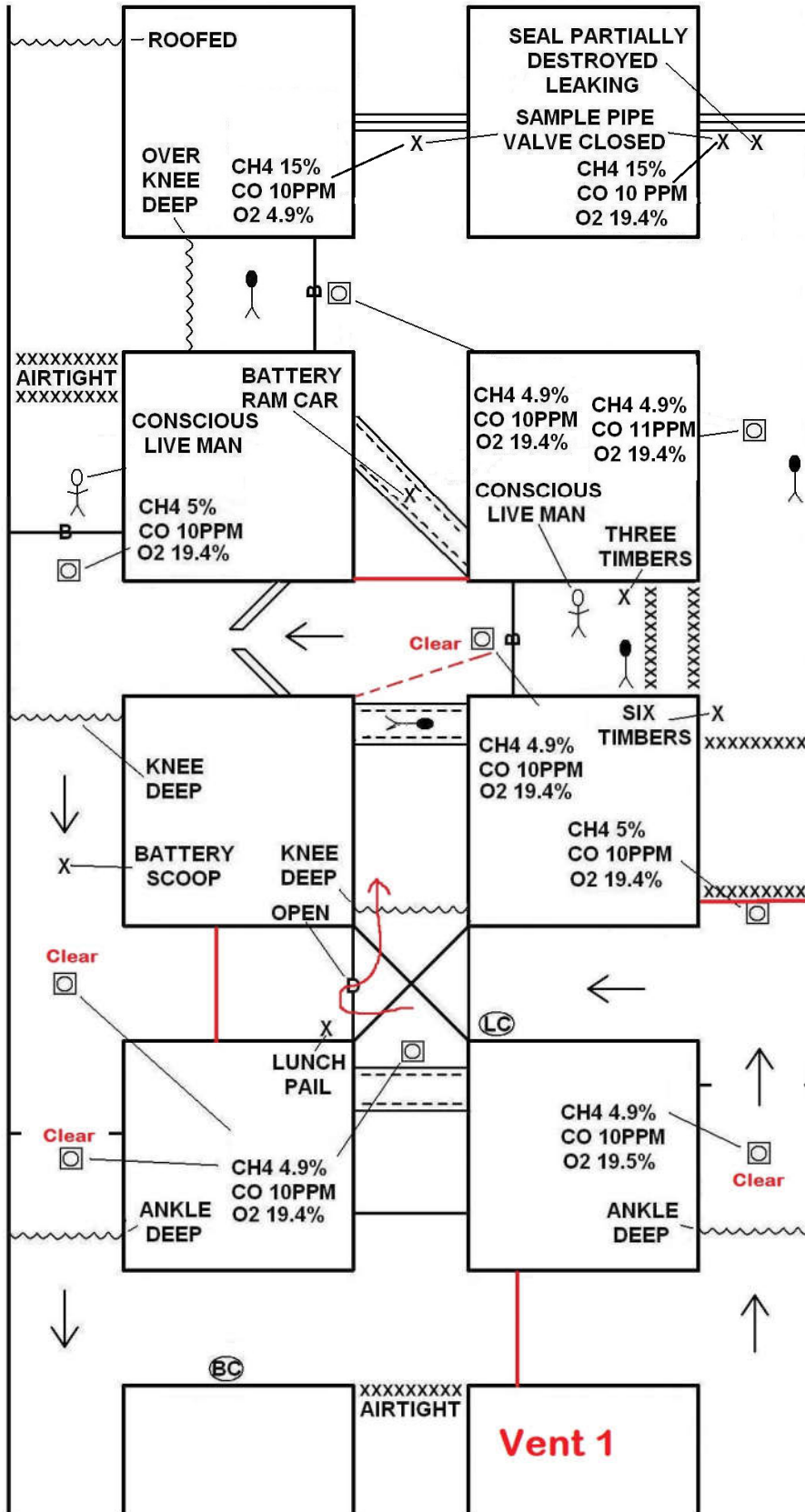

AFTER TAKING FIRST PATIENT OUT

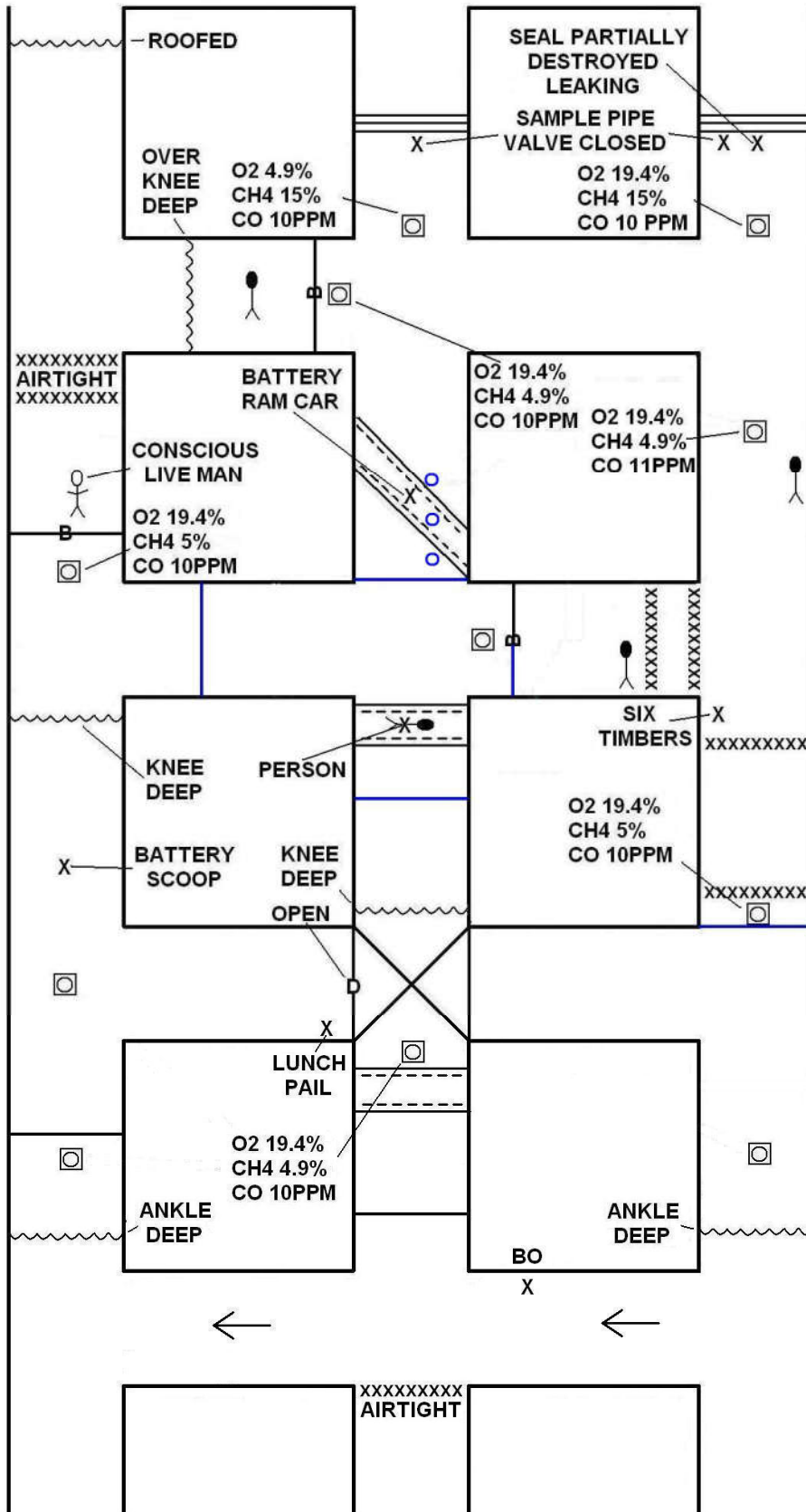

VENTILATION # 2

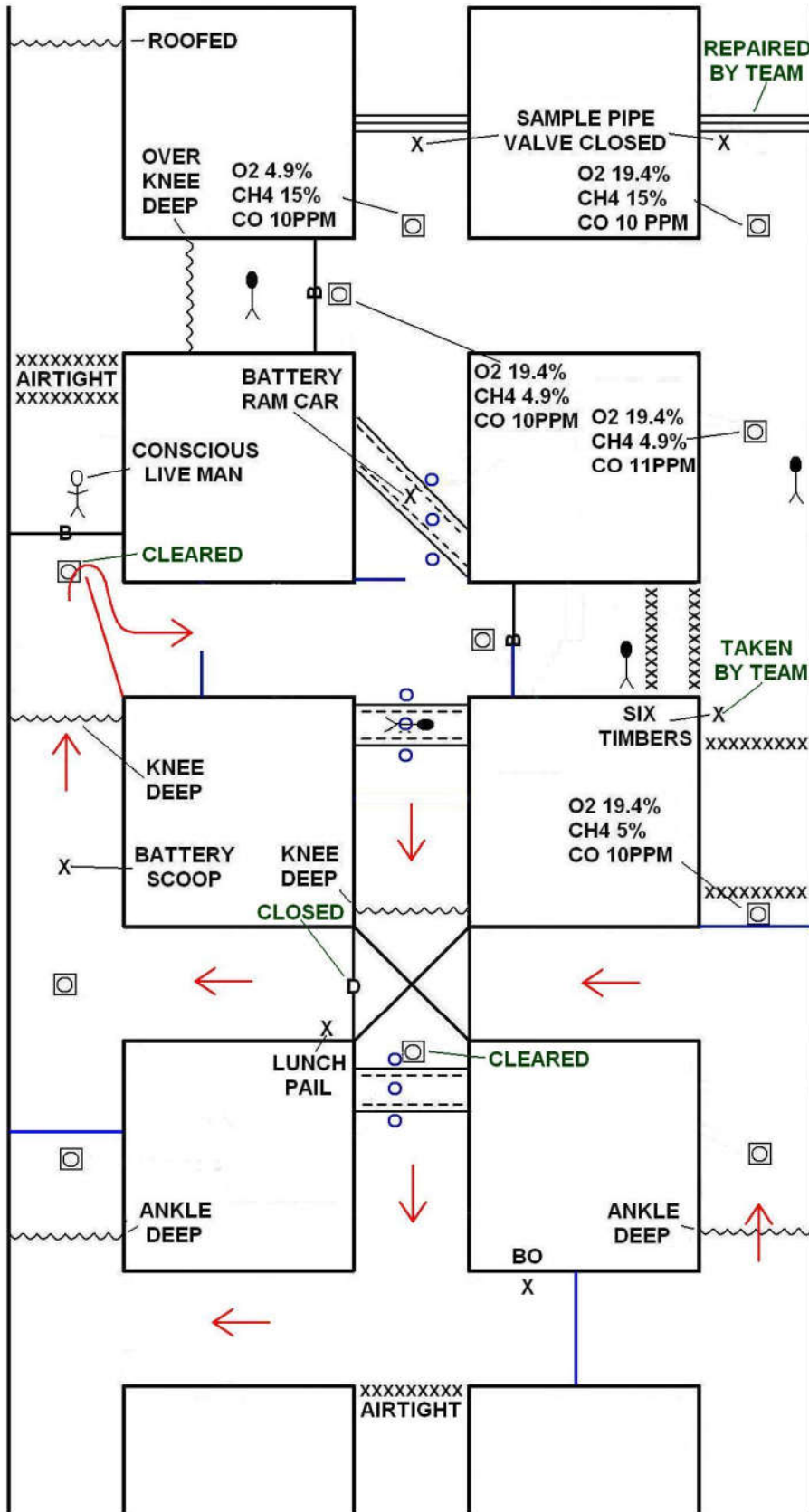

VENTILATION # 3

