

Problem 1

TEAM INSTRUCTIONS

- Call out the names of all miners found.
- Explore all areas of the mine that can be safely explored.
- Ventilate all contaminants out of the mine.
- There will be a 70 minute time limit.
- You will be notified when you have 10 minutes remaining.
- No more than 2 building materials can be carried at one time.

SWVA2020

DAY 1

STATEMENT

Welcome to the Mine Academy No. 1 Mine. We appreciate you answering our call for help. Yesterday a 7 man production crew went underground on the day shift. At 11 pm the CO sensors went off and smoke was observed coming from the drift mouth. All miners were notified and instructed to exit the mine. State and Federal officials were notified as well as local mine rescue teams. All miners except for 3 made it safely out of the mine. A mine rescue team went underground and found a battery scoop on fire which in turn caught a rib on fire. After the fire was extinguished mine rescue teams started ventilating the smoke out of the mine and looking for the three missing mines. All of the smoke has been removed from the mine and a fresh air base has been established underground at the location where you will start your exploration.

The mine fan is currently off but can be started whenever you ask. The fan is an exhausting fan that intakes up the #3 entry and returns down the #1 entry. Once running the fan can be stopped and reversed but cannot be stalled. The mine map is up to date. Thank you and good luck.

PROBLEM MAP

Team Working Order # _____

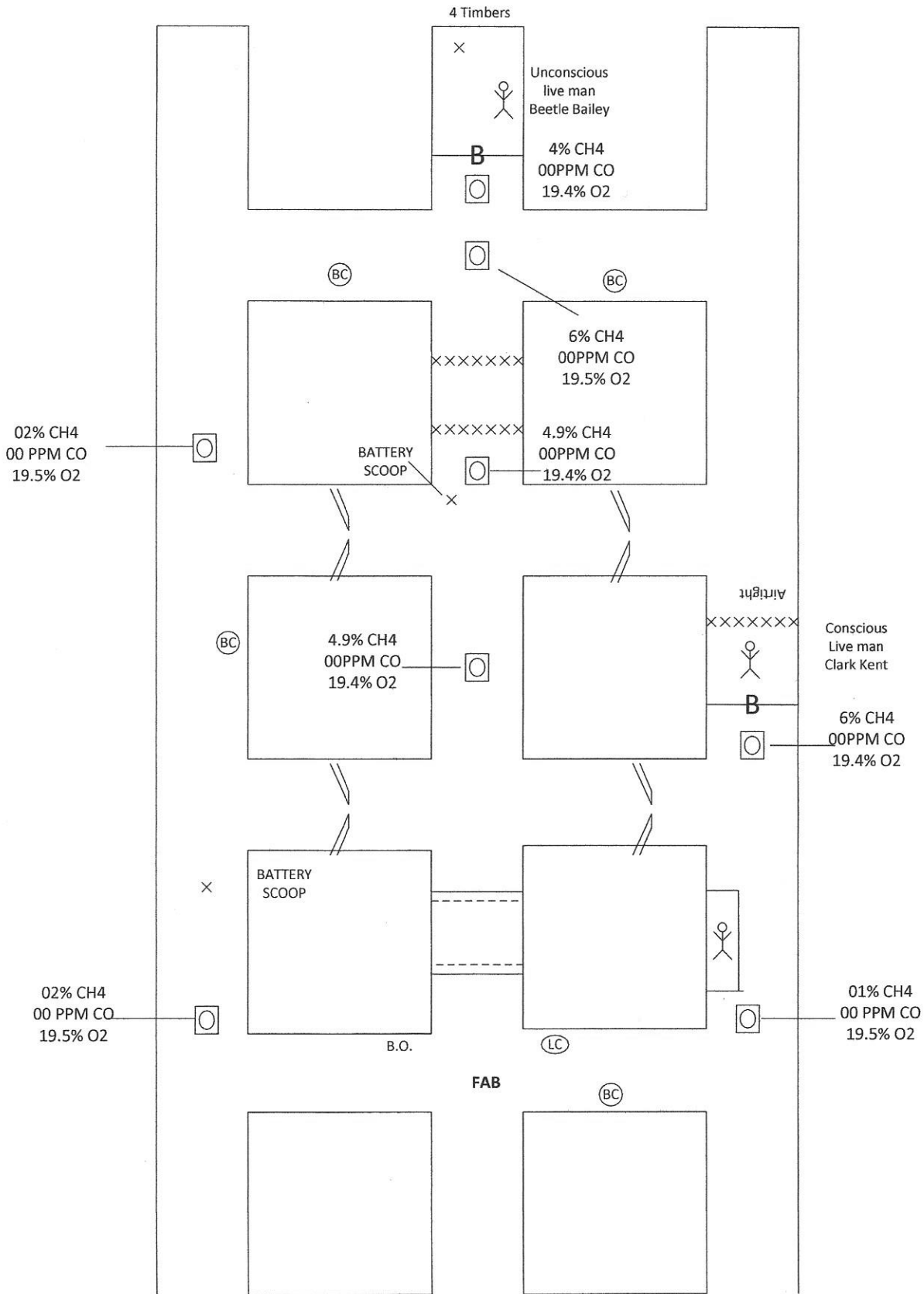

TEAM STOPS

Day 1

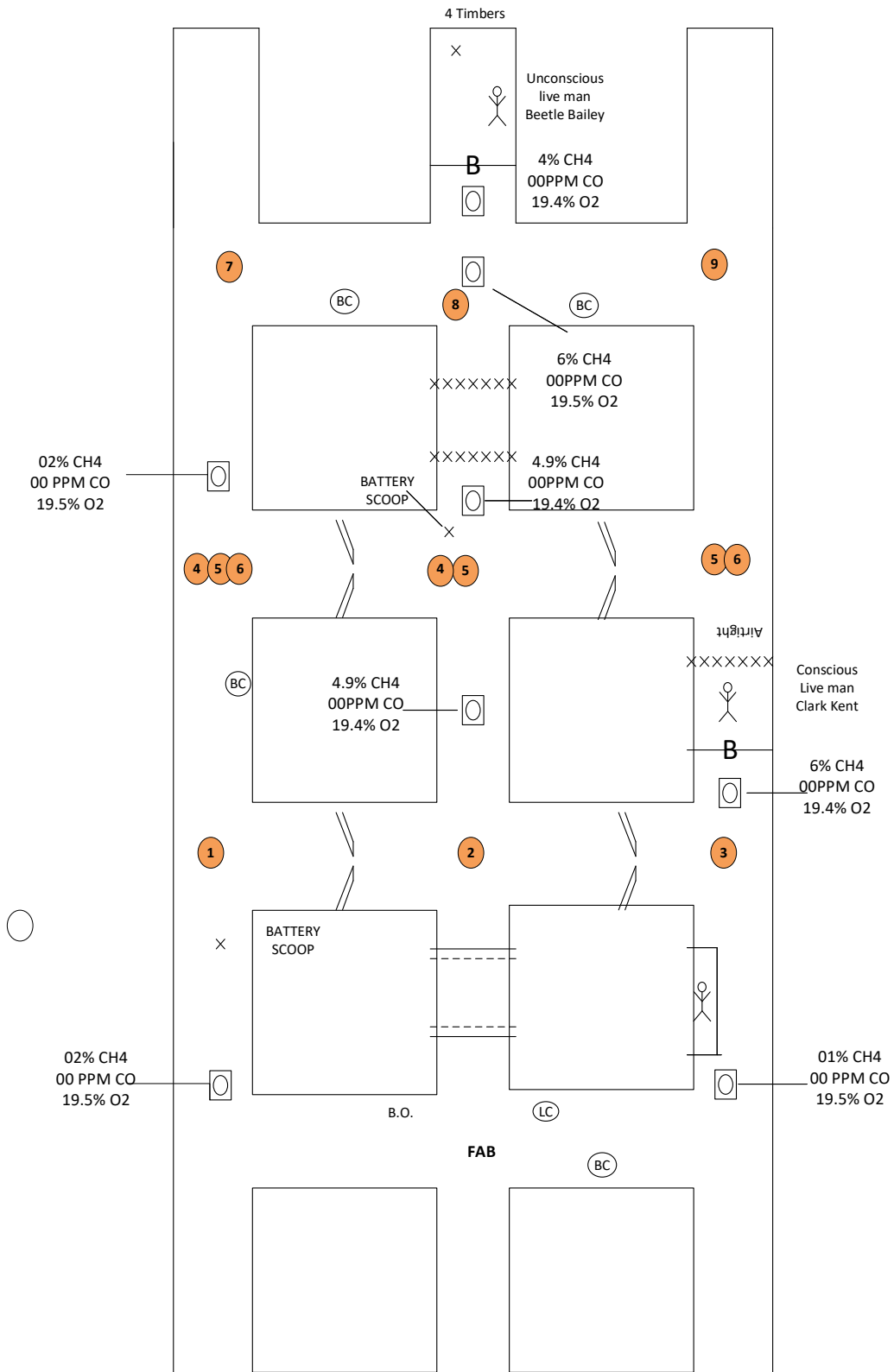

TEAM STOPS

Day 1

From the fresh air base the teams will check the opening of the #1,2 & 3 entries. No.1 entry has 2% CH₄, 0 PPM CO and 19.5% O₂ and a battery scoop. No. 2 entry has unsafe roof and #3 entry has 1% CH₄, 0 PPM CO and 19.5% O₂. Midway up the #3 entry they will find a person laying in elongated unsafe roof on the left rib.

TS1: CH₄ above 1% is considered a contaminant so the team will have to travel up # 1 entry to the A line of crosscuts due to the 2% CH₄ in #1 and the adjacent entry being blocked. Inby the No1 intersection is clear as is the crosscut between No. 1 & 2 entries.

TS2: The team will tie across the A line of crosscuts to the No. 2 entry where they will make the backside of the unsafe roof. Inby the #2 entry intersection the team will find 4.9% CH₄ 0PPM CO and 19.4% O₂

TS3: The team will travel on across the A line of crosscuts to the intersection of the #3 entry. A conscious live man will say help, get me out of here. Just inby the imaginary line of the intersection the team will find 6% CH₄ 0PPM CO and 19.4% O₂ that extends up to the barricade.

TS4: The team can travel up entry 1 or 2 to the B line of crosscuts. If they travel up #1 entry they will find 2% CH₄, 0 PPM CO and 19.5% O₂ just inby the imaginary line of the intersection in #1. 1 Right is clear.

TS5: The team will travel across the B line of crosscuts to the #2 entry intersection. There's a battery scoop in the intersection. Just inby the imaginary line of the intersection going up #2 they find 4.9% CH₄, 0PPM CO and 19.4% O₂. The gases extends up to and ends at the caved area.

TS6: The team will travel across the B line of crosscuts to the # 3 intersection. Outby the intersection they will find caved airtight. Inby the intersection is clear.

TS7: The team will have to follow the 2% CH₄ up the #1 entry to the C line of crosscuts in #1. Inby the intersection is the face of #1 entry. 1 Right is clear.

TS8: The team will travel across the C line of crosscuts to the #2 entry intersection. In the intersection they find 6% CH₄, 0 PPM CO and 19.5% O₂. Outby the intersection they find the backside of the caved area. Inby the intersection they find 4% CH₄ 0 PPM CO and 19.4% O₂ extending up to a barricade. No answer behind the barricade.

TS9: The team will travel across the C line of crosscuts to the #3 entry intersection. Inby and outby the intersection is clear.

The team will have to make all team stops prior to breaching the barricade in #3 entry. No delay of patient.

HELP!! HELP!!

GET ME OUT

OF HERE!!!!

1st VENT

Day 1

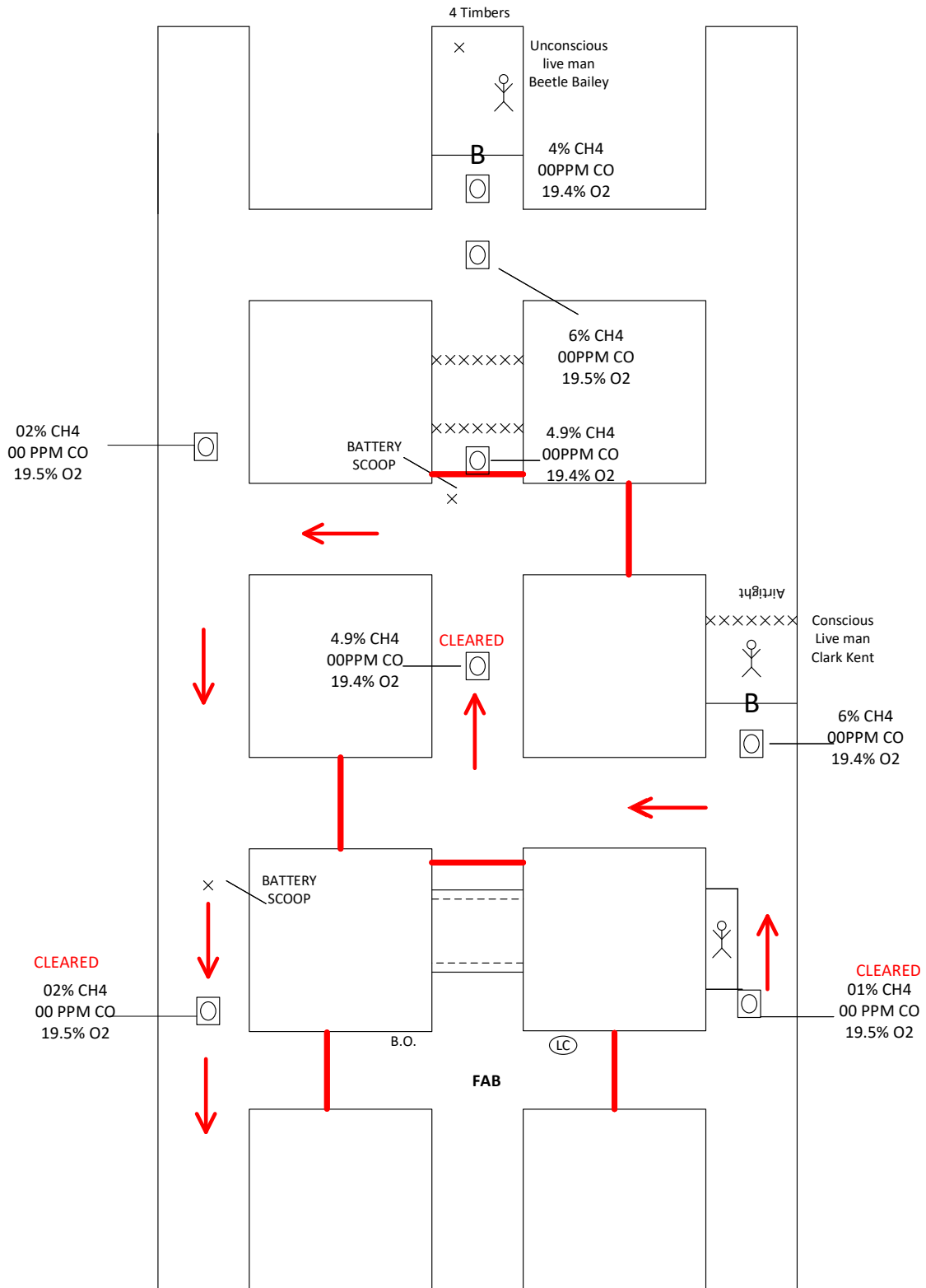

3RD VENT

Day 1

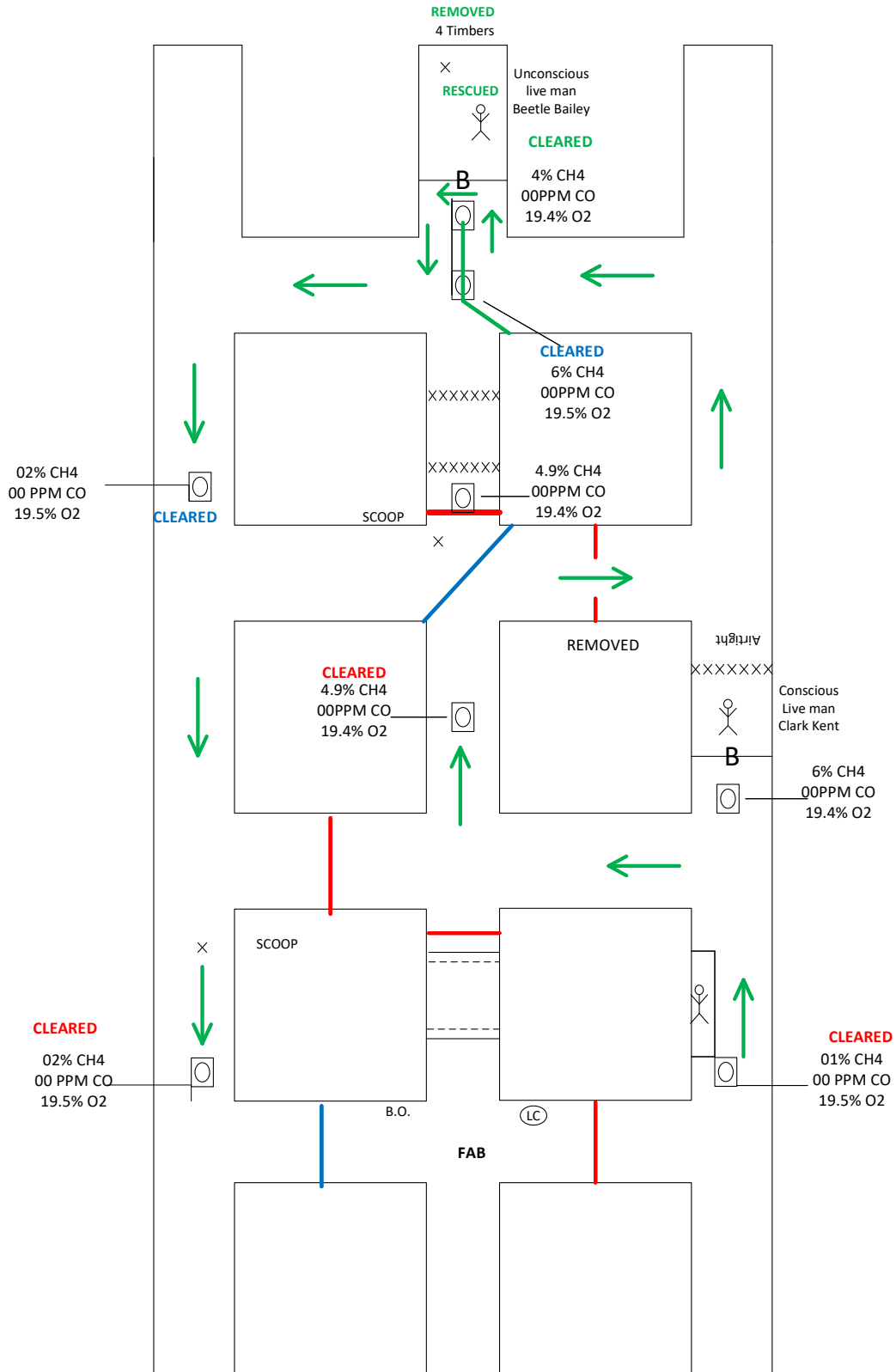

4TH VENT

Day 1

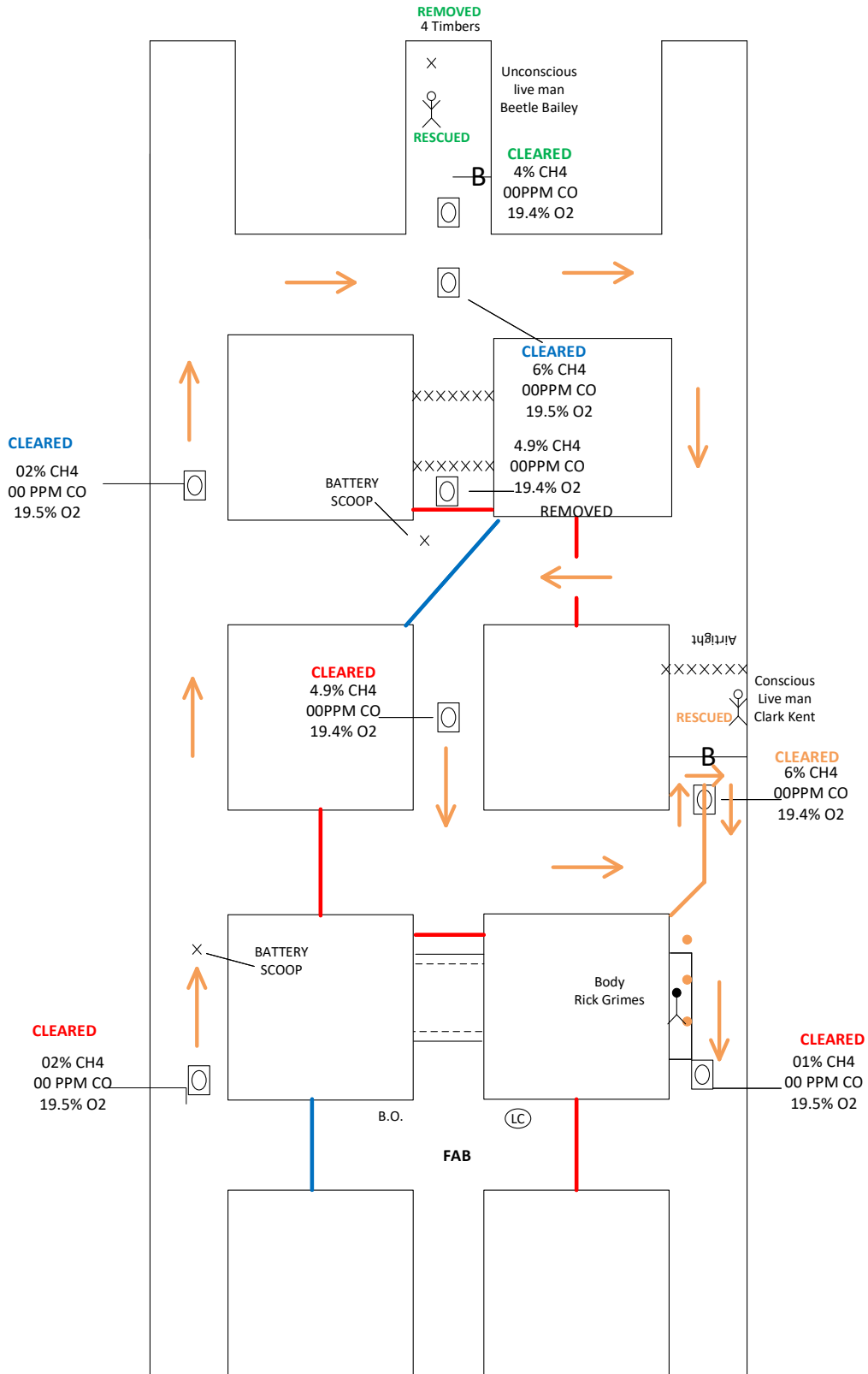

5TH VENT

Day 1

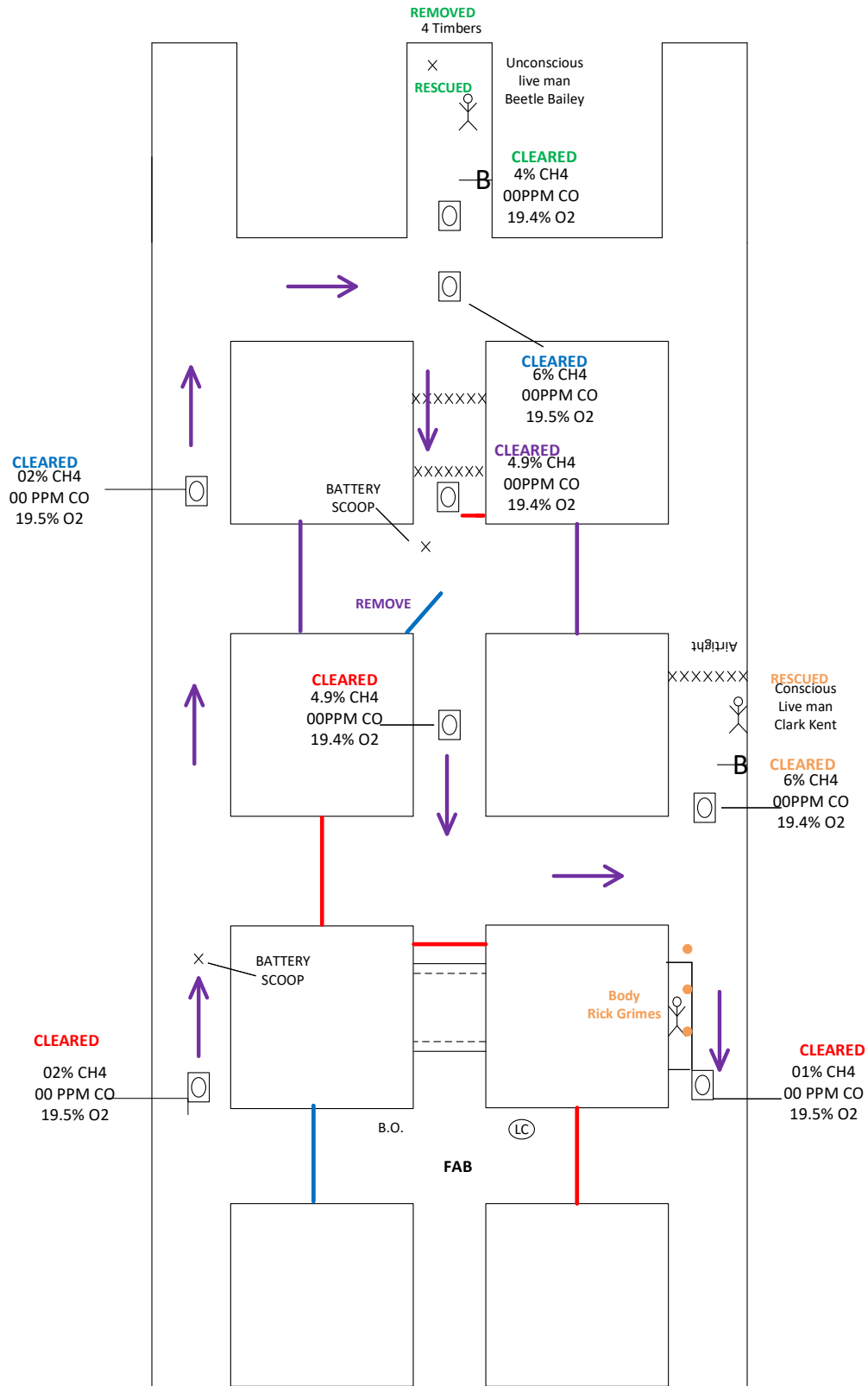

EXTENT OF GAS

Day 1

