



Welch Post 1
Bluefield State

2019

Mine Rescue Contest

Problem Statement

Thank you for answering our call for help. You are located at the Big Dog # 1 Mine. At 8:00 a.m. this morning a four man crew entered the mines to do dead work. We lost contact with the crew a short time later.

The mine is ventilated by an exhaust fan, located off the No. 3 entry. The entries are numbered left to right. The fan is currently off.

The previous teams explored the No. 1 and No. 2 entries to outby number 10 crosscut in which they encountered a roof fall. The third team explored the number 3 entry to 10 crosscut and established a fresh air base before retreating due to low bottle pressure. The number three entry is safe to ventilate through.

There is an intake air shaft located in the No, 1 entry. The shaft will be located on the team map.

Good Luck

Written Instructions

- 1: Explore all areas of the mine that can be explored safely**
- 2: Account for the four missing miners**
- 3: The exhaust fan, once started cannot be turned off, stalled or reversed**
- 4: The mine map is not up to date**
- 5: There is intake air shaft located in the number 1 entry**
- 6: The number 3 entry outby the fresh air base is safe to ventilate through**
- 7: The team can carry only two brattices while traveling**

**Person behind barricade in
No. 2 Entry**

**“Help get me out, it is airtight
behind me”**

2019 Welch Post 1

1ST Vent Map

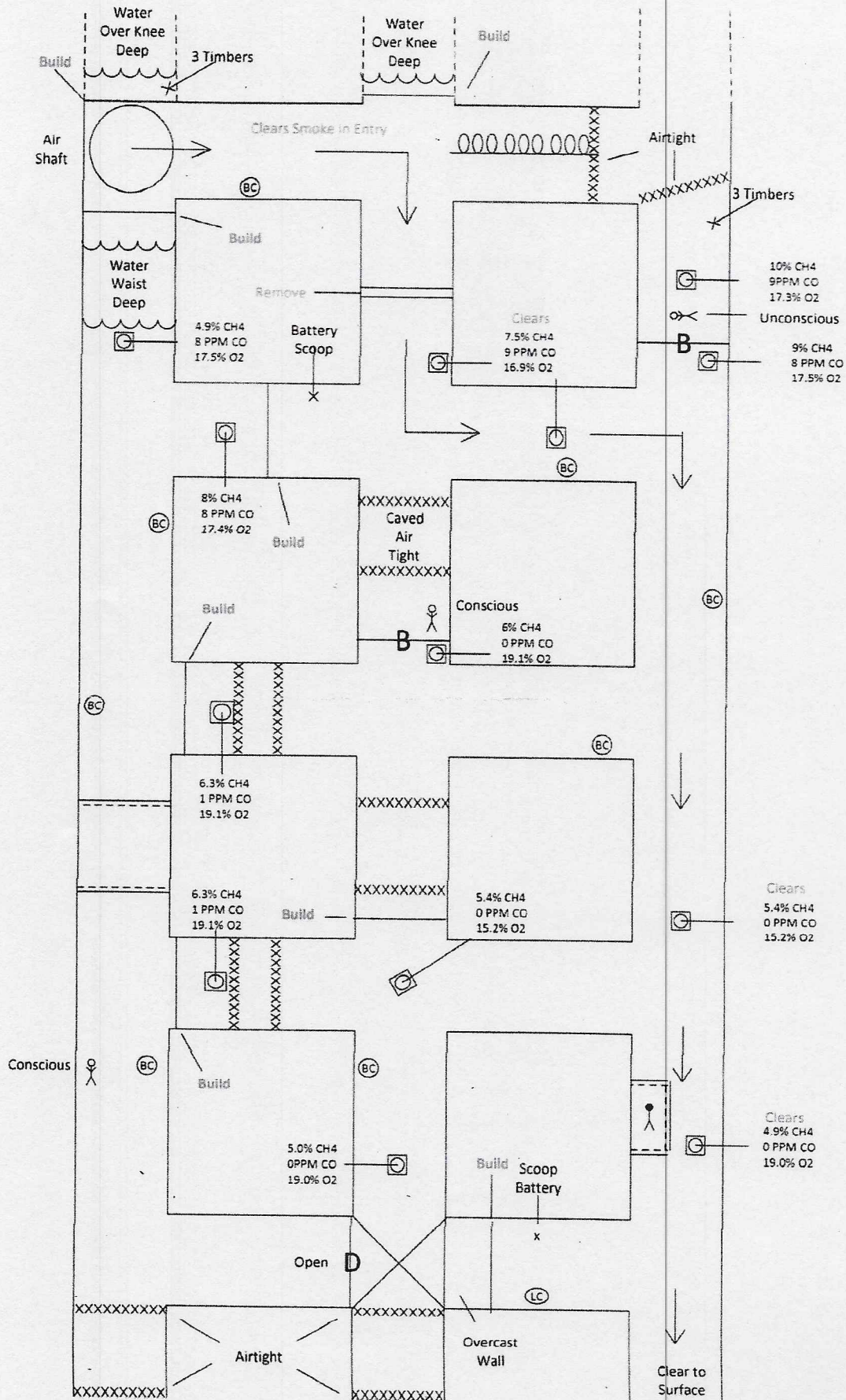

Weich Post 1 1st Vent Alt.

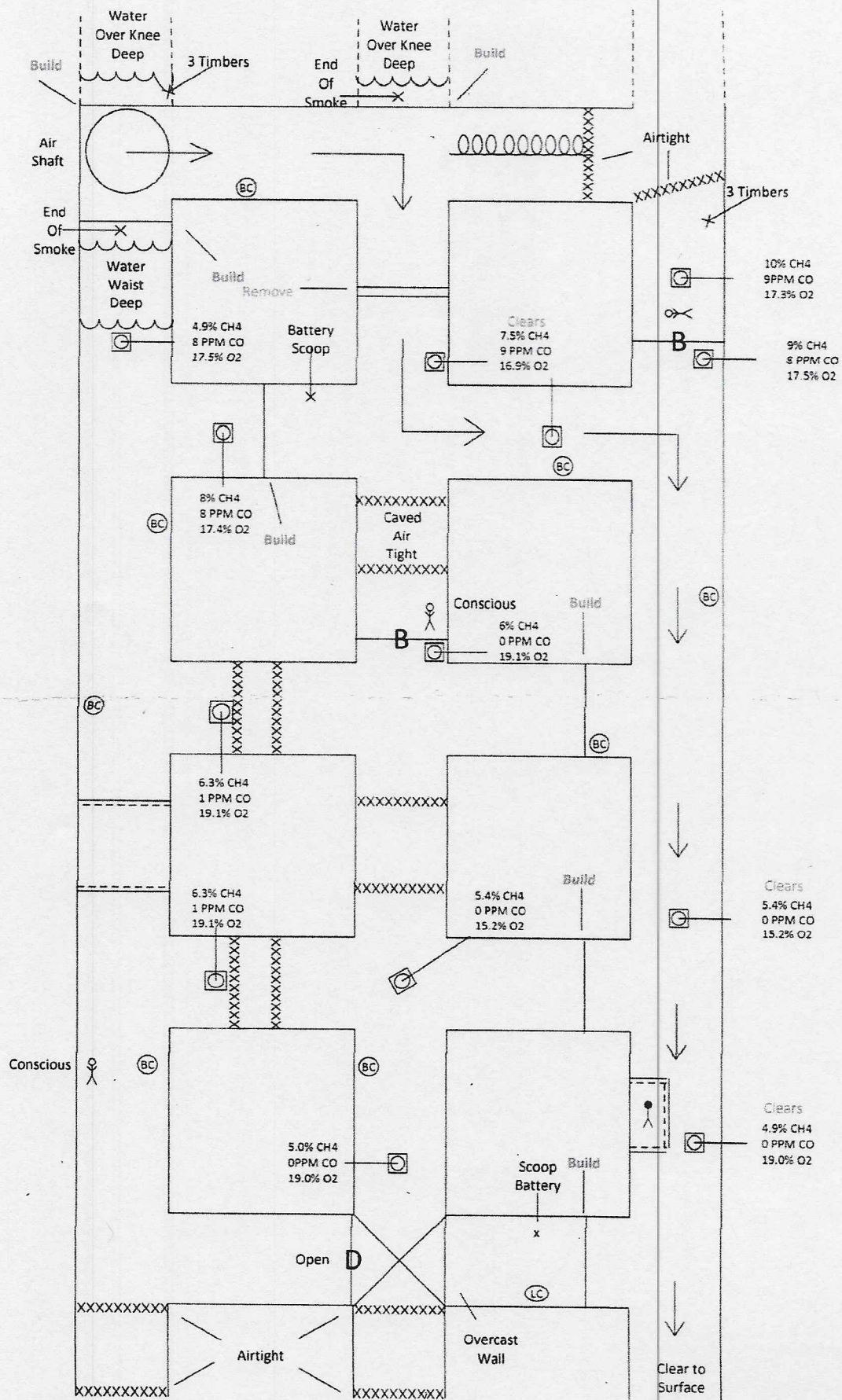

2019 Welch Post 1 2nd Vent

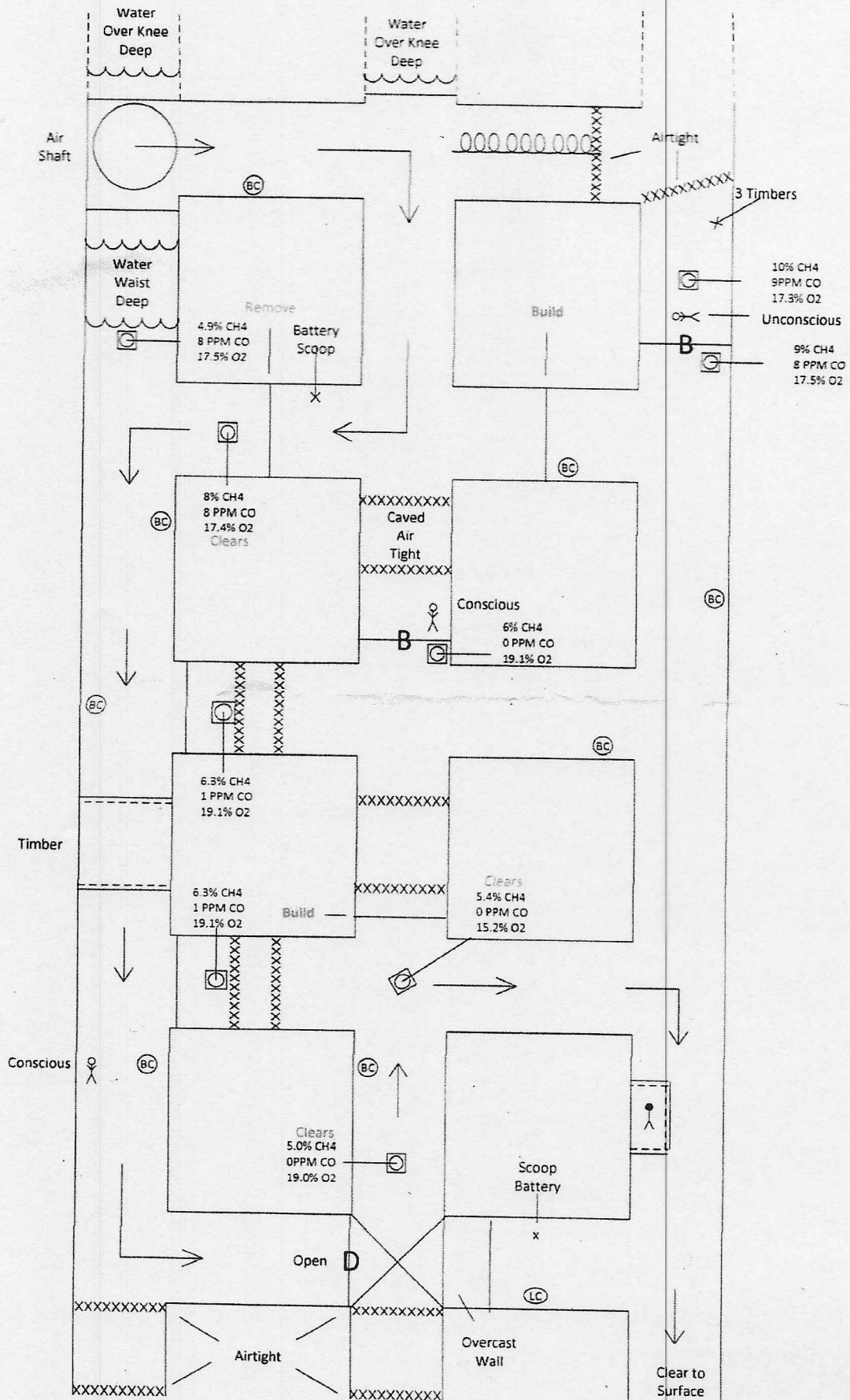

Welch Post 1 3rd Vent

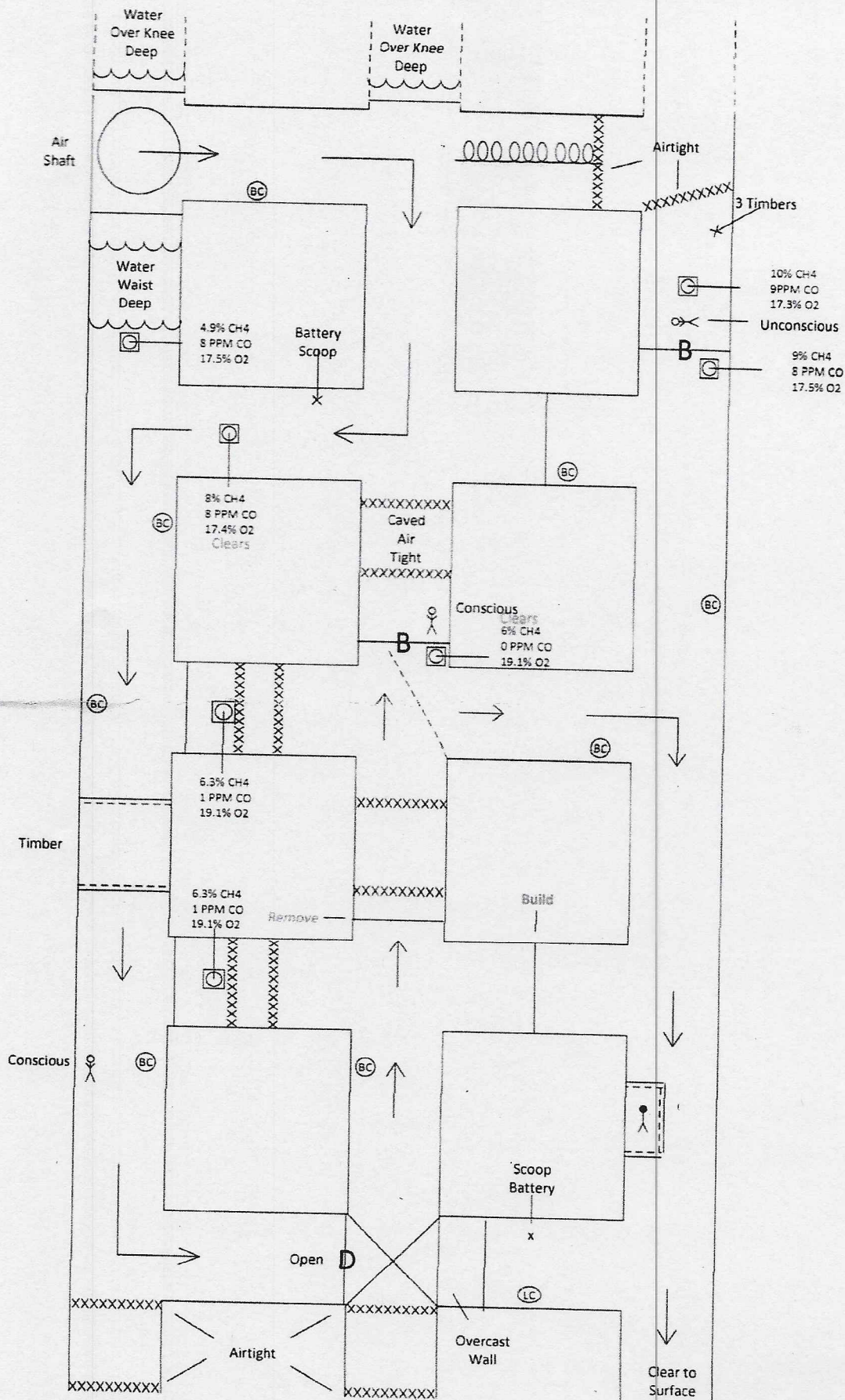

Welch Post 1 4th Vent

