

12th Annual Mine Rescue Competition

Saturday, 19 May 2018



Center for Applied Research and Technology, Inc.



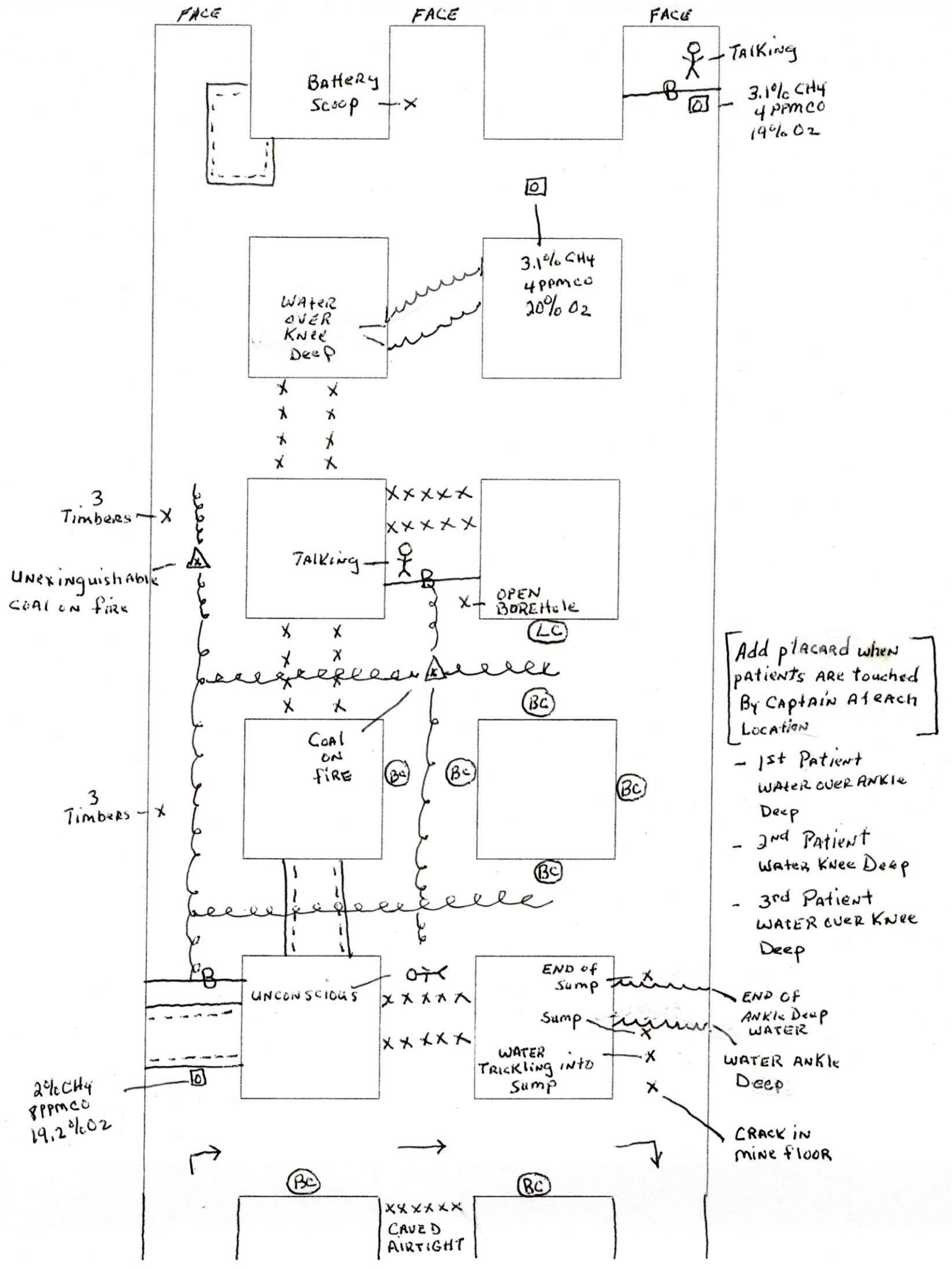

Add placard when patients are touched by Captain at each location

- 1st Patient Water over ANKLE Deep
- 2nd Patient Water Knee Deep
- 3rd Patient WATER over KNEE Deep

1st Vent

3 Timbers
Unextinguishable COAL ON FIRE

3 Timbers

2% CH₄
8ppm CO
19.2% O₂

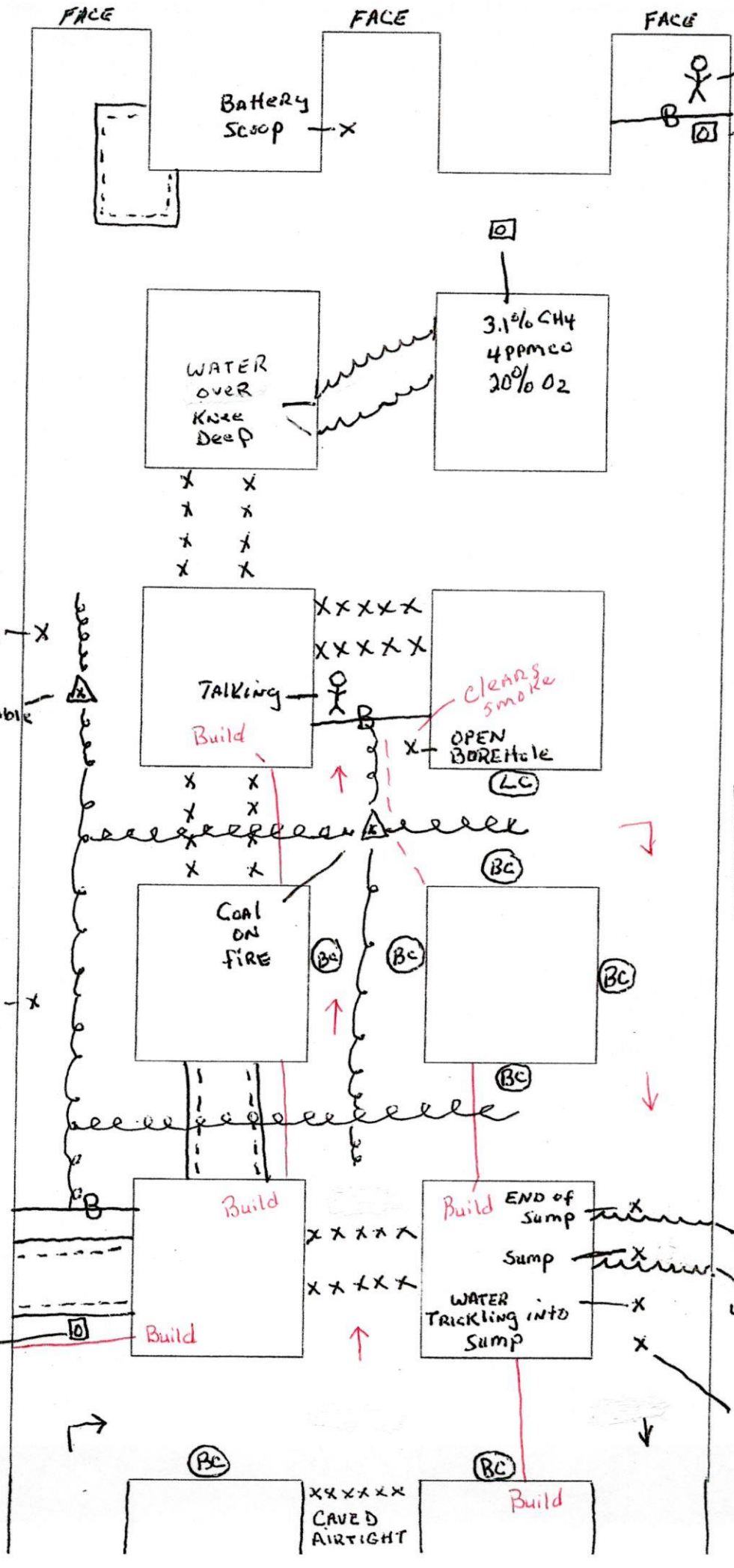

Add placard when PATIENTS ARE TOUCHED By Captain At each Location

- 1st Patient WATER OVER ANKLE DEEP
- 2nd Patient WATER KNEE DEEP
- 3rd Patient WATER OVER KNEE DEEP

END OF ANKLE DEEP WATER
WATER ANKLE DEEP
CRACK IN MINE FLOOR

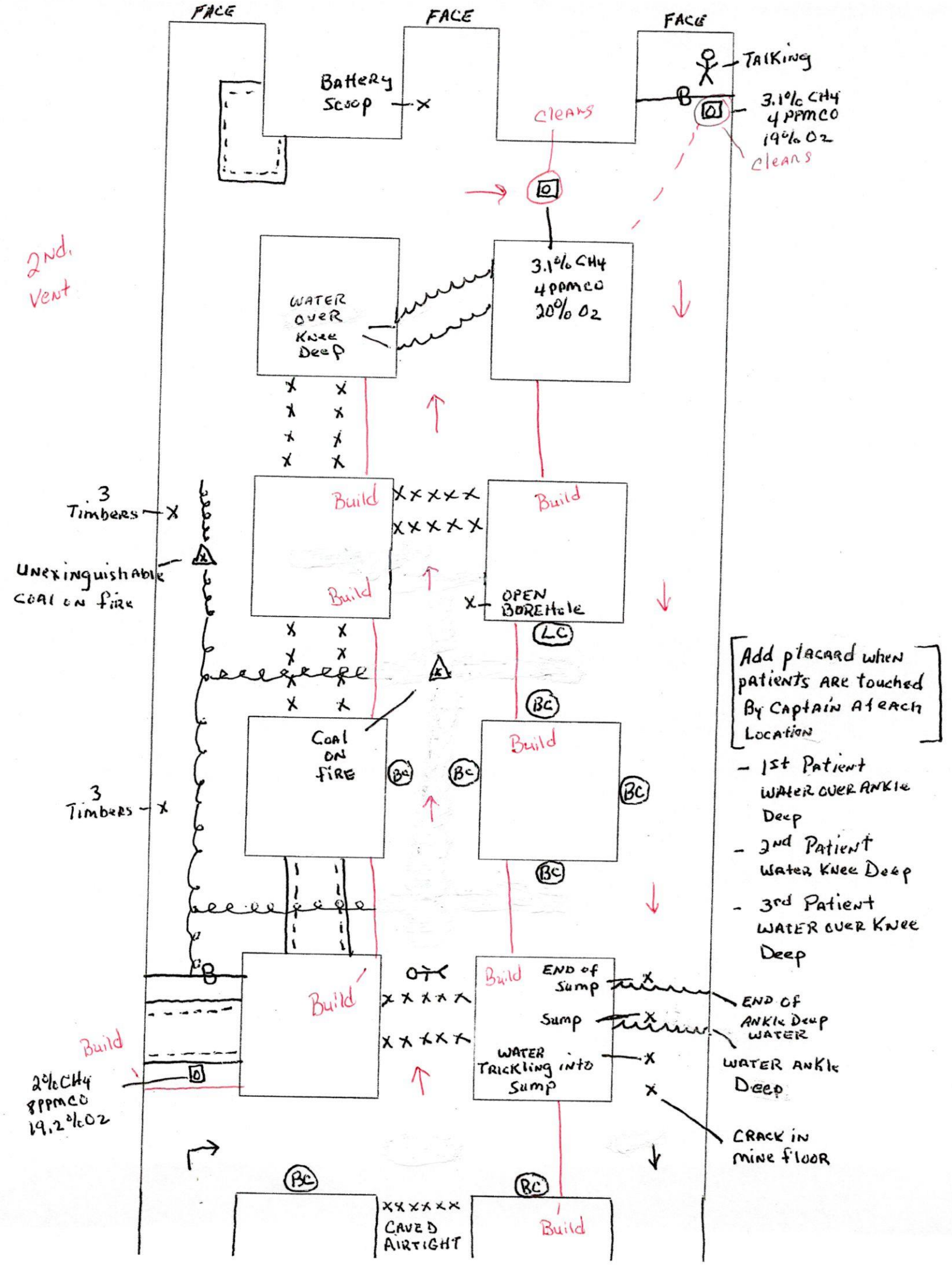

Add placard when patients ARE touched By Captain At each Location

- 1st Patient WATER OVER ANKLE Deep
- 2nd Patient WATER KNEE Deep
- 3rd Patient WATER OVER KNEE Deep

END OF ANKLE DEEP WATER
WATER ANKLE Deep
CRACK IN MINE FLOOR

2nd Vent

UNEXtinguishable COAL ON FIRE

3 Timbers

3 Timbers

Build
2% CH4
8 PPM CO
19.2% O2

CAVED AIRTIGHT

3rd
Vent.

