

2017 Indiana State Mine Rescue and Pre-Shift Contest

Mine Rescue Problem



2017 INDIANA STATE MINE RESCUE STATEMENT

I am _____, Superintendent of the Federal #14 Mine. You are located on the surface of the mine. Last night a six (6) man crew entered the mine and proceeded to the #4 Unit to perform maintenance and set up to run coal. At 6:35 a.m. this morning a miner called to surface from the unit and said they were experiencing problems. No contact has been established with the miners since the call. At 6:50 a.m., two (2) miners made it to the bottom of the shaft and came out of the mine. The miners who came out said they could not find the other miners and had no contact with them.

The #4 Unit has experienced bad roof and rib conditions, water problems, and high concentrations of methane gas. All power going into the mine has been de-energized and locked out. Air pumps can be used if available.

The #4 Unit has been ventilated by a blowing fan that is in operation located at the Main Portal. The fan can be interchanged from blowing to exhausting, but cannot be stalled. We have been doing construction work on this unit as it is the bottom area for our new air shaft. There is compressed air and water discharge line installed to the bottom of the air shaft if needed.

All proper authorities have been notified, a command center has been established on the surface, back-up mine rescue teams are on mine property but cannot be used to perform work underground.

This is all the information we have available at this time.

2017 INDIANA STATE MINE RESCUE CONTEST

WRITTEN INSTRUCTIONS

**EXPLORE THE MINE IN ITS ENTIRETY WHERE
SAFE TO DO SO. VENTILATE THE MINE AND
LEAVE THE MINE FOR BAREFACED
EXPLORATION.**

**THE FAN(S) YOU ARE WORKING WITH CAN BE
REVERSED, BUT CANNOT BE STALLED.**

**ACCOUNT FOR ALL MISSING PERSONS AND
BRING ALL SURVIVORS TO THE FRESH AIR
BASE.**

**THE TEAM MAY NOT CARRY MORE THAN TWO
(2) BRATTICE CURTAINS AT ANY ONE TIME.**

**IF ANY PERMANENT STOPPINGS ARE
ENCOUNTERED UNDERGROUND THEY CANNOT
BE REMOVED OR USED ANYWHERE BESIDES
THE LOCATION AT WHICH THEY ARE
DISCOVERED.**

BLANK FIELD MAP

Team Working Order # _____

2017 INDIANA STATE MINE RESCUE CONTEST

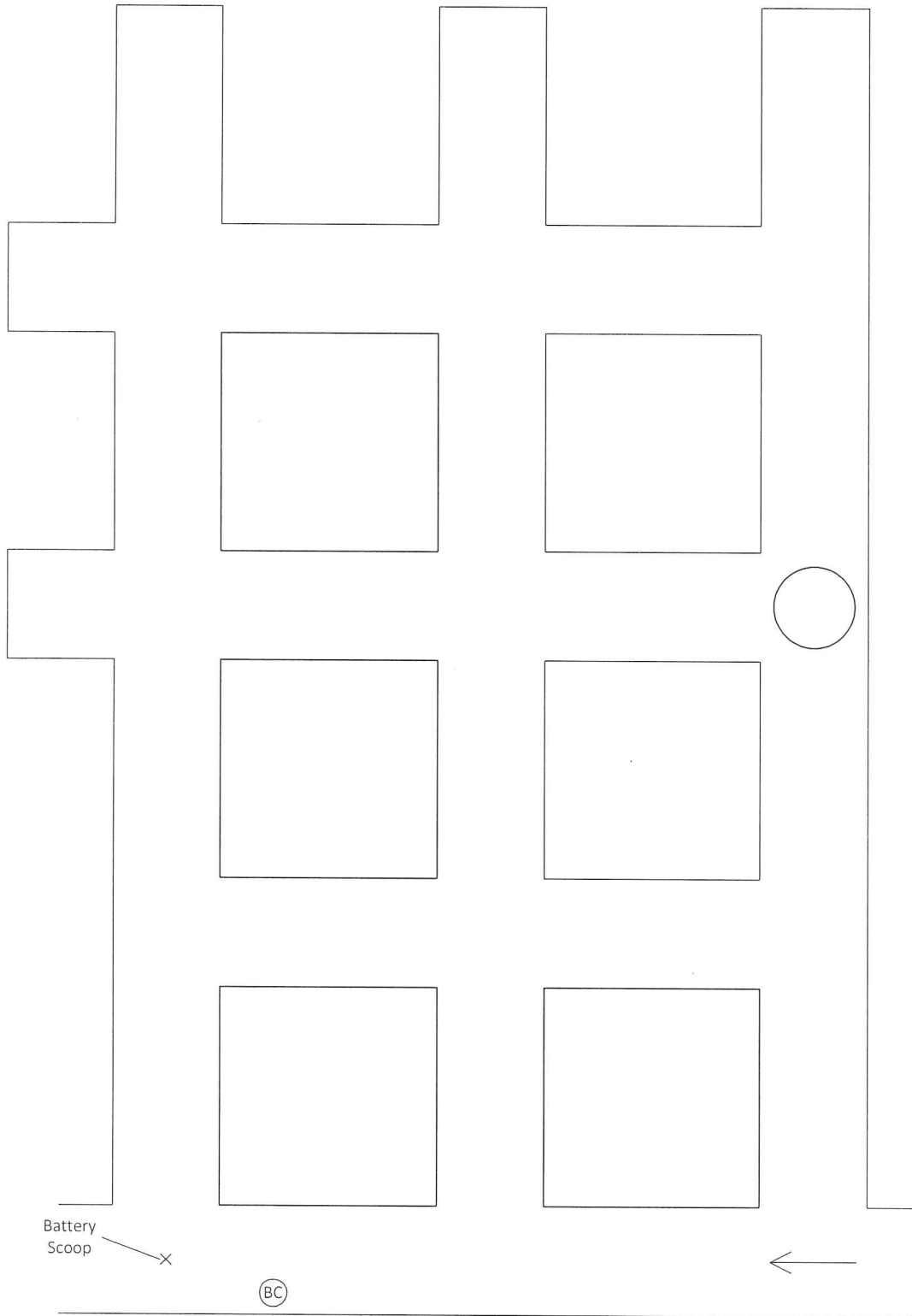

COMMAND CENTER ATTENDANT ☐

BRIEFING OFFICER MAP ☐

TEAM MAP ☐

FIELD MAP

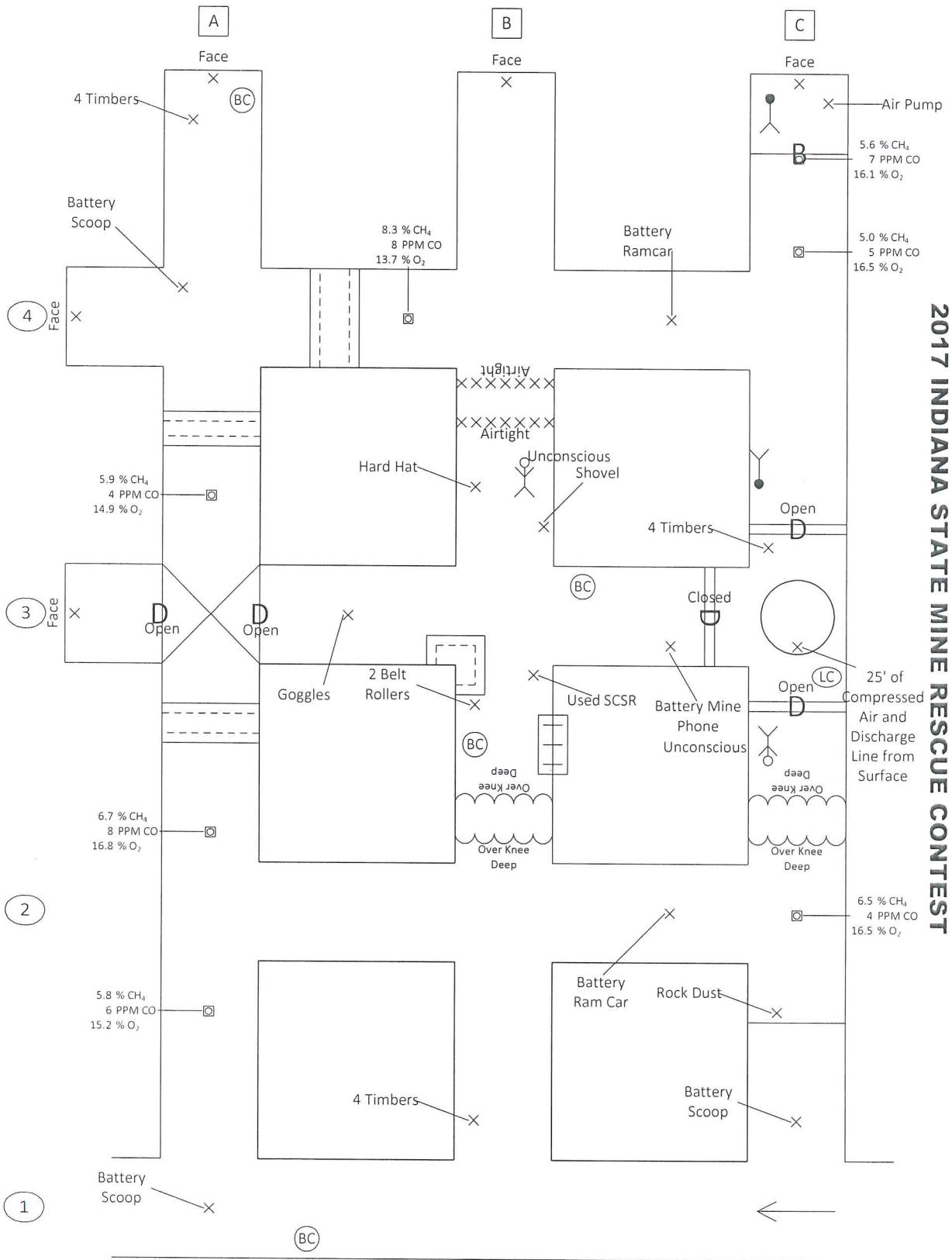

1st VENT MAP

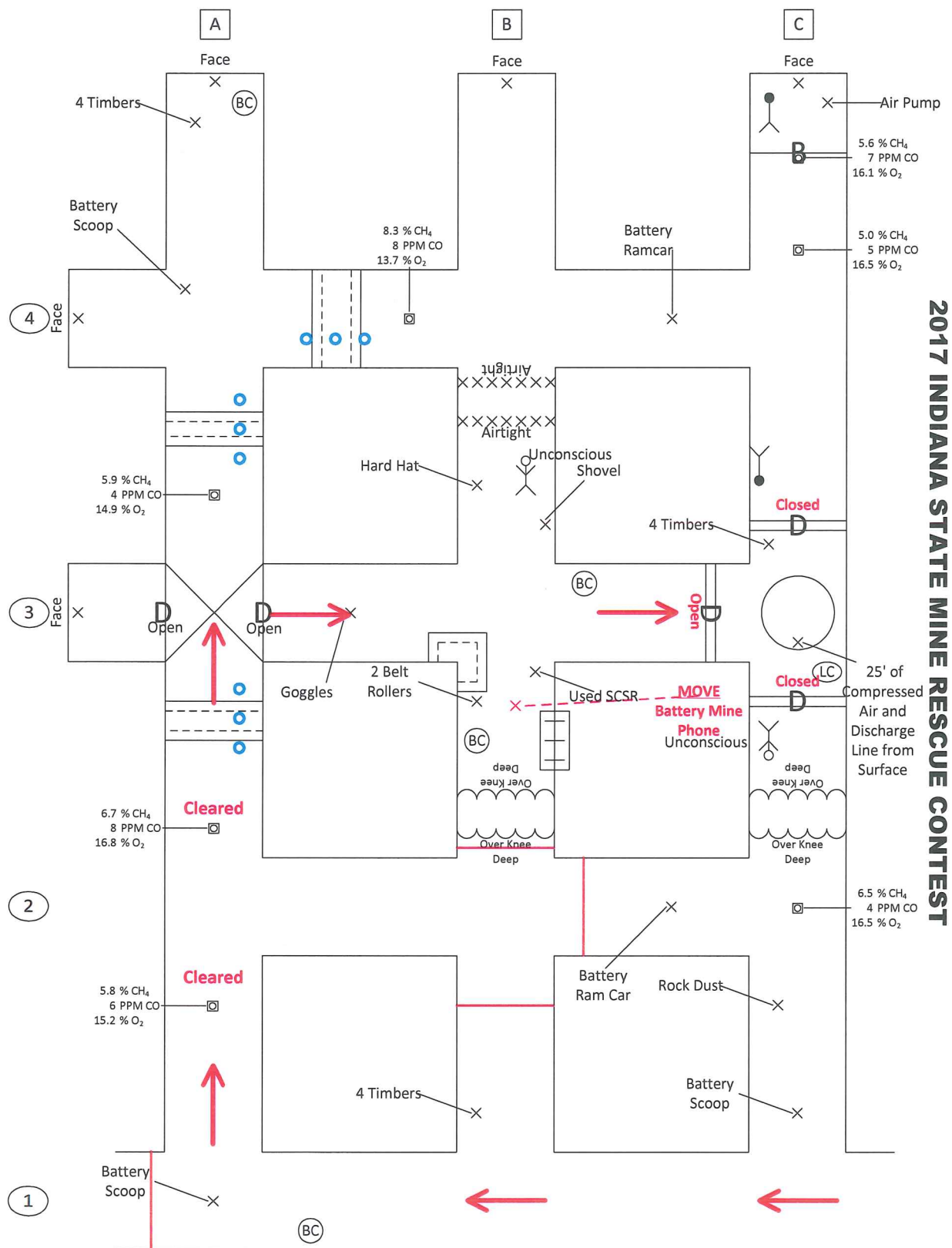

2017 INDIANA STATE MINE RESCUE CONTEST

2nd VENT MAP



3rd VENT MAP

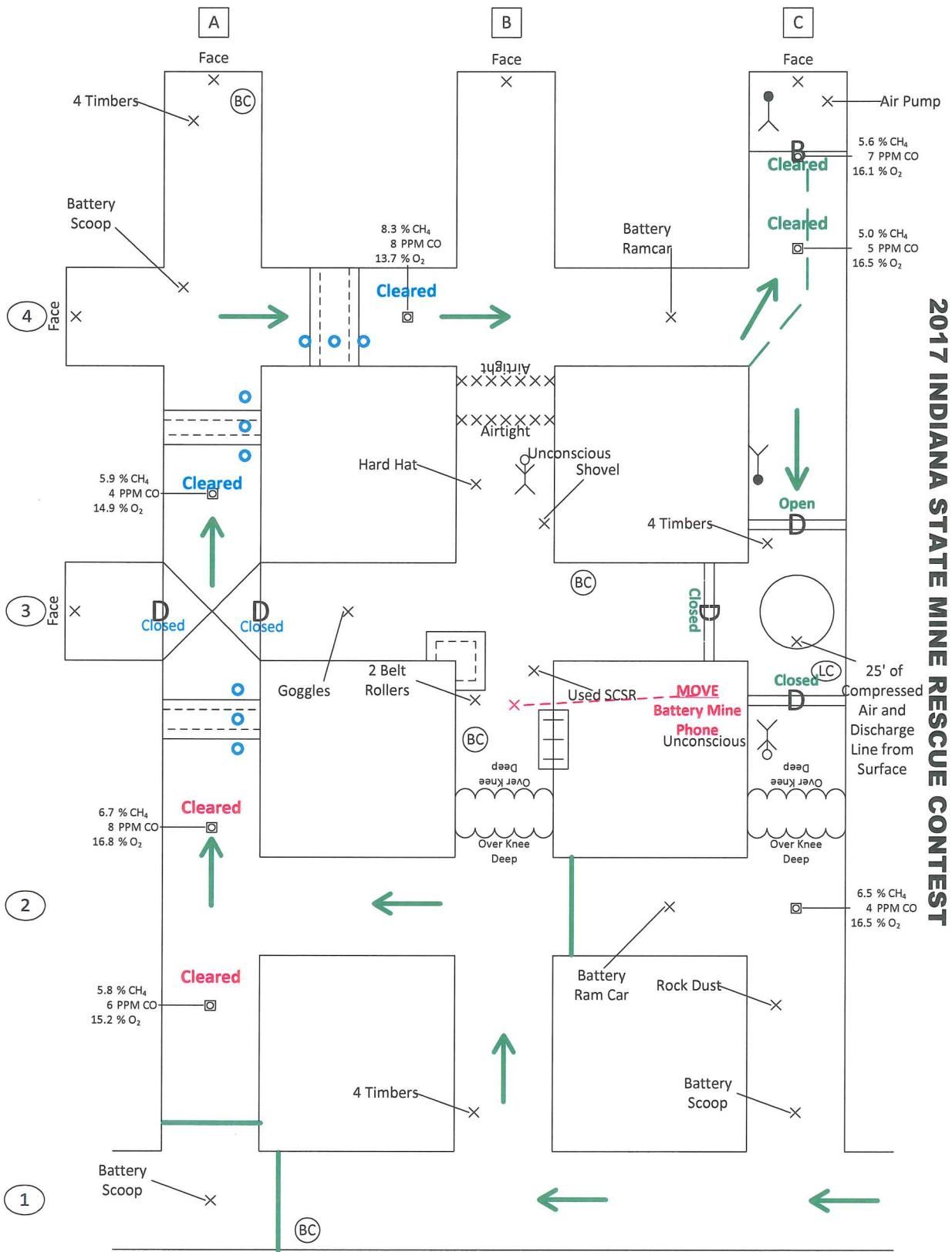

2017 INDIANA STATE MINE RESCUE CONTEST

4th VENT MAP

