

Southern WV Day One
Statement

You are located at the underground fresh air base of the Gravy Train #1 Mine. Last night a four person crew was sent to the B-Panel section to do dead work. The crew failed to notify the outside yard attendant of their Mid-shift report. All attempts to notify the crew has been unsuccessful.

B-Panel is a three entry section, under normal conditions air travels up #1 Entry and exhausts out #3 with #2 being neutral. There is a sealed area that runs parallel with the #3 entry. Mine Rescue Teams have explored to the mouth of B-Panel, and due to low bottle pressures, established a fresh air base and returned to the surface. There will be a team stationed at the fresh air base to serve as a back-up, but can do no work. Any electrical circuits that need to be energized will be done by the Command Center Attendant.

All outby areas are safe to ventilate through. The fan is currently off and once started cannot be stopped, reversed or stalled.

The mine maps are not up to date.

Good Luck

**Southern WV Day One
Problem**

- **Explore the entire mines**
- **Account for the four missing miners**
- **Bring survivors to the Fresh Air Base**
- **You can only carry two brattices while traveling**

Patient

Patient behind Barricade in #1 to #2 crosscut

Help get me out I have a airtight caved area behind me!!!!

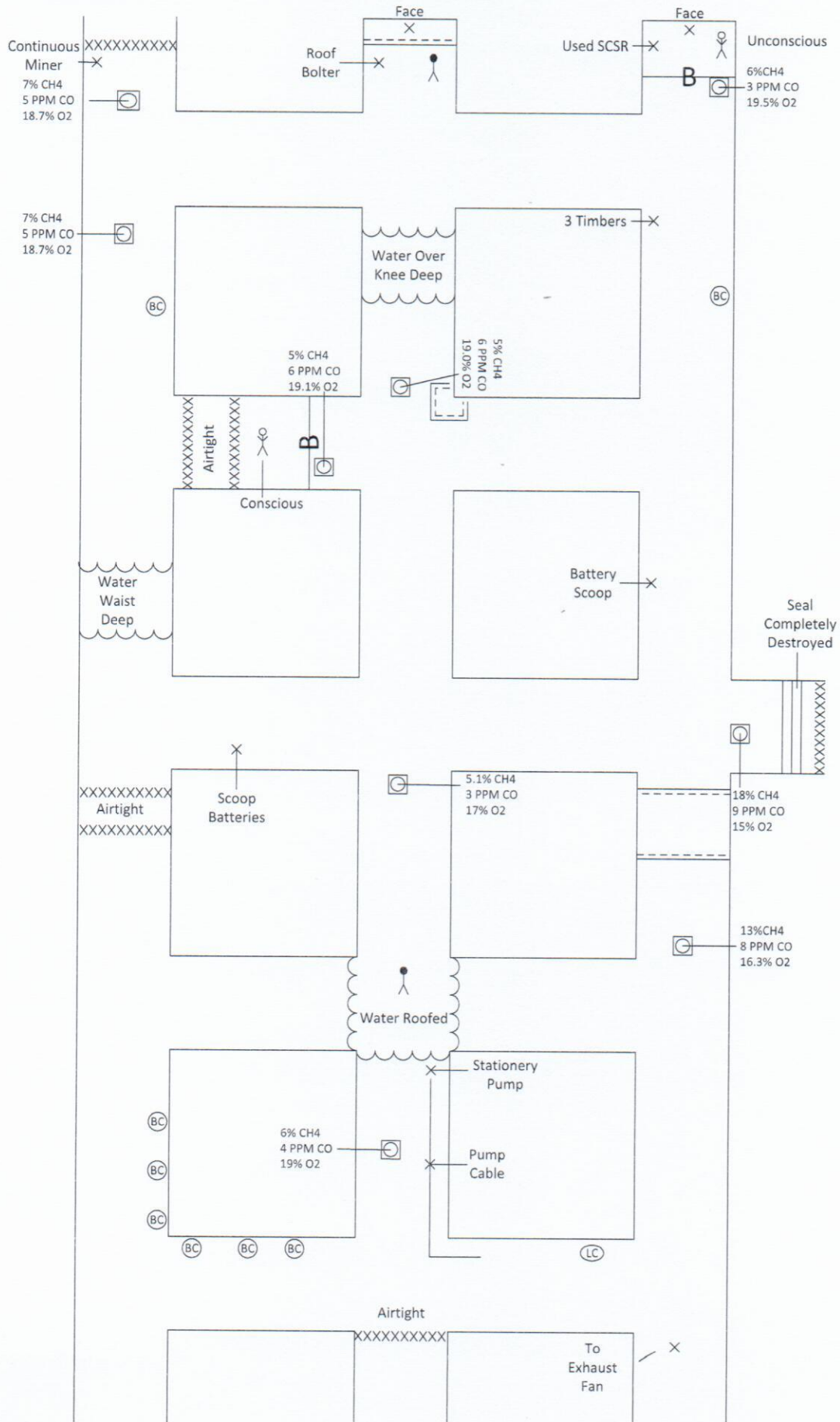

1st Vent and pumping of Water
*Water pumps down completely

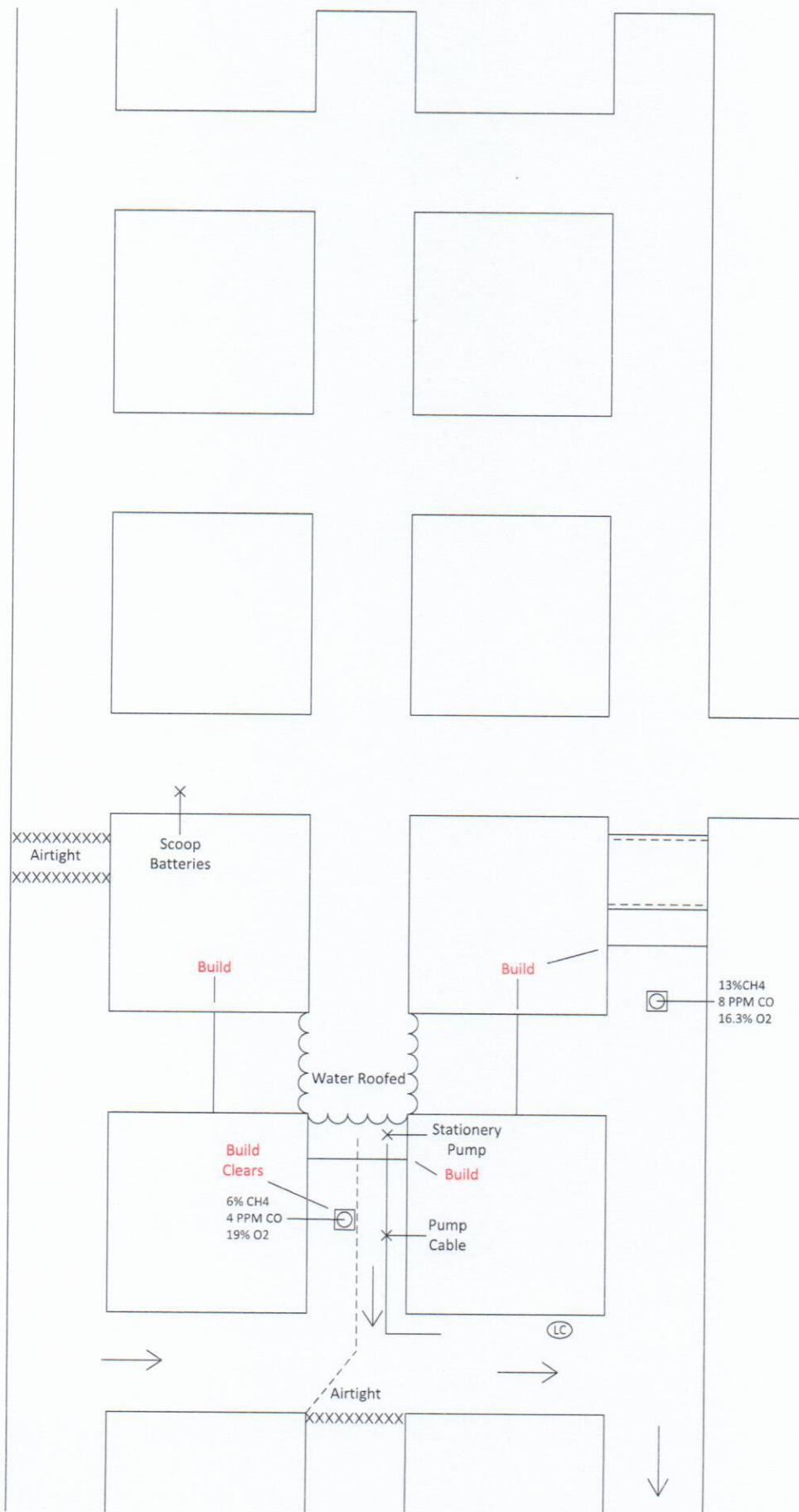

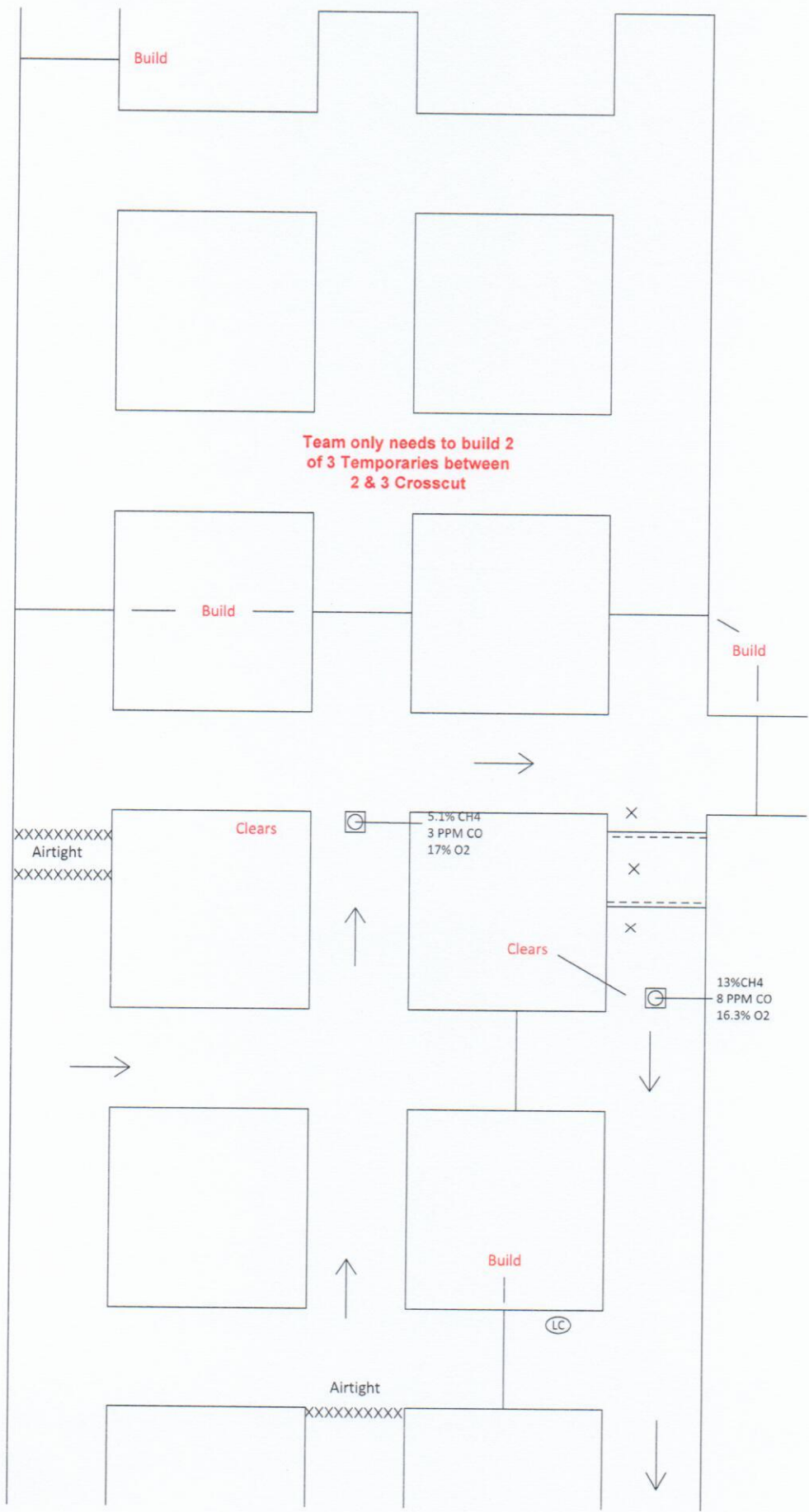

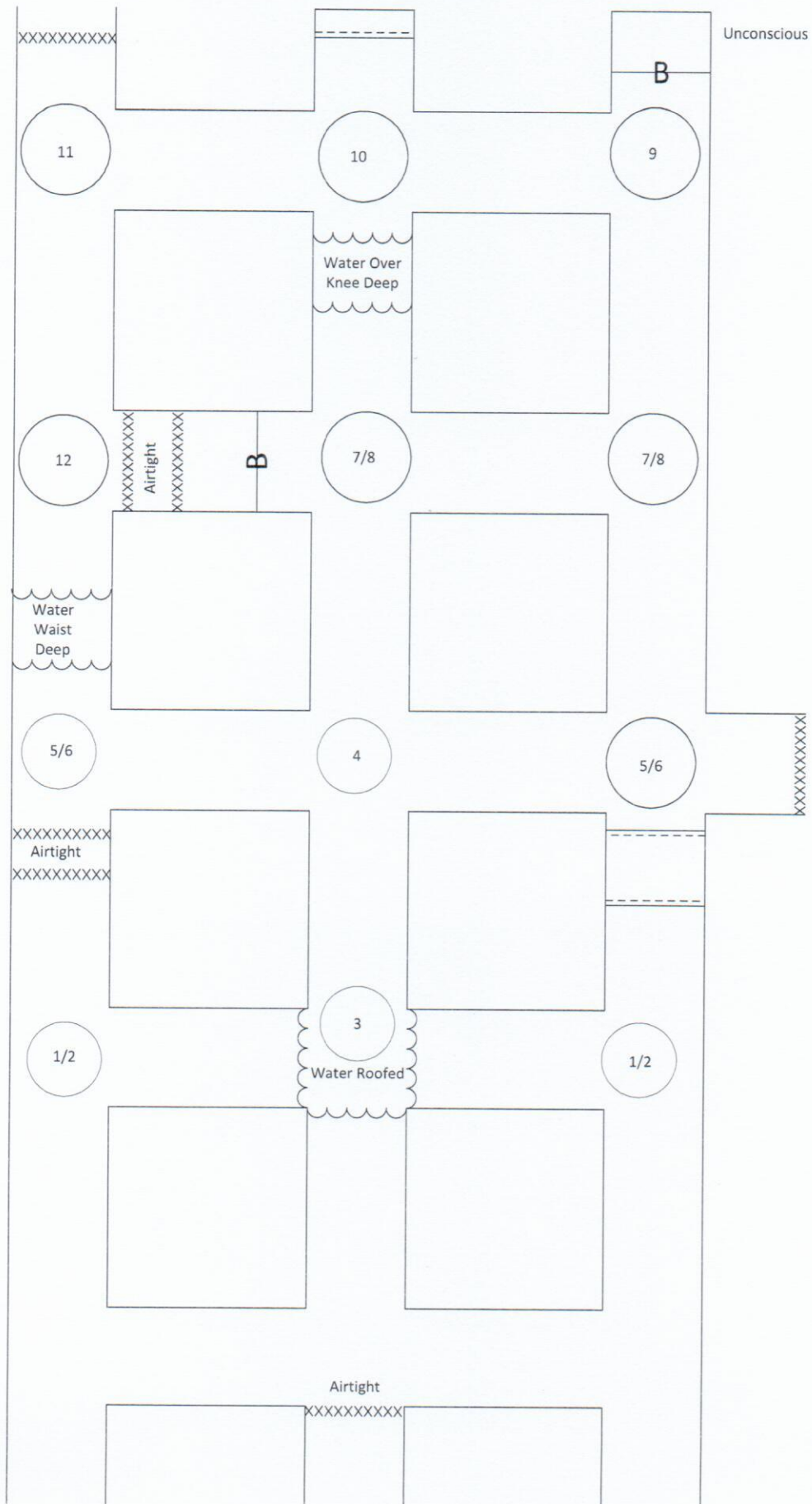

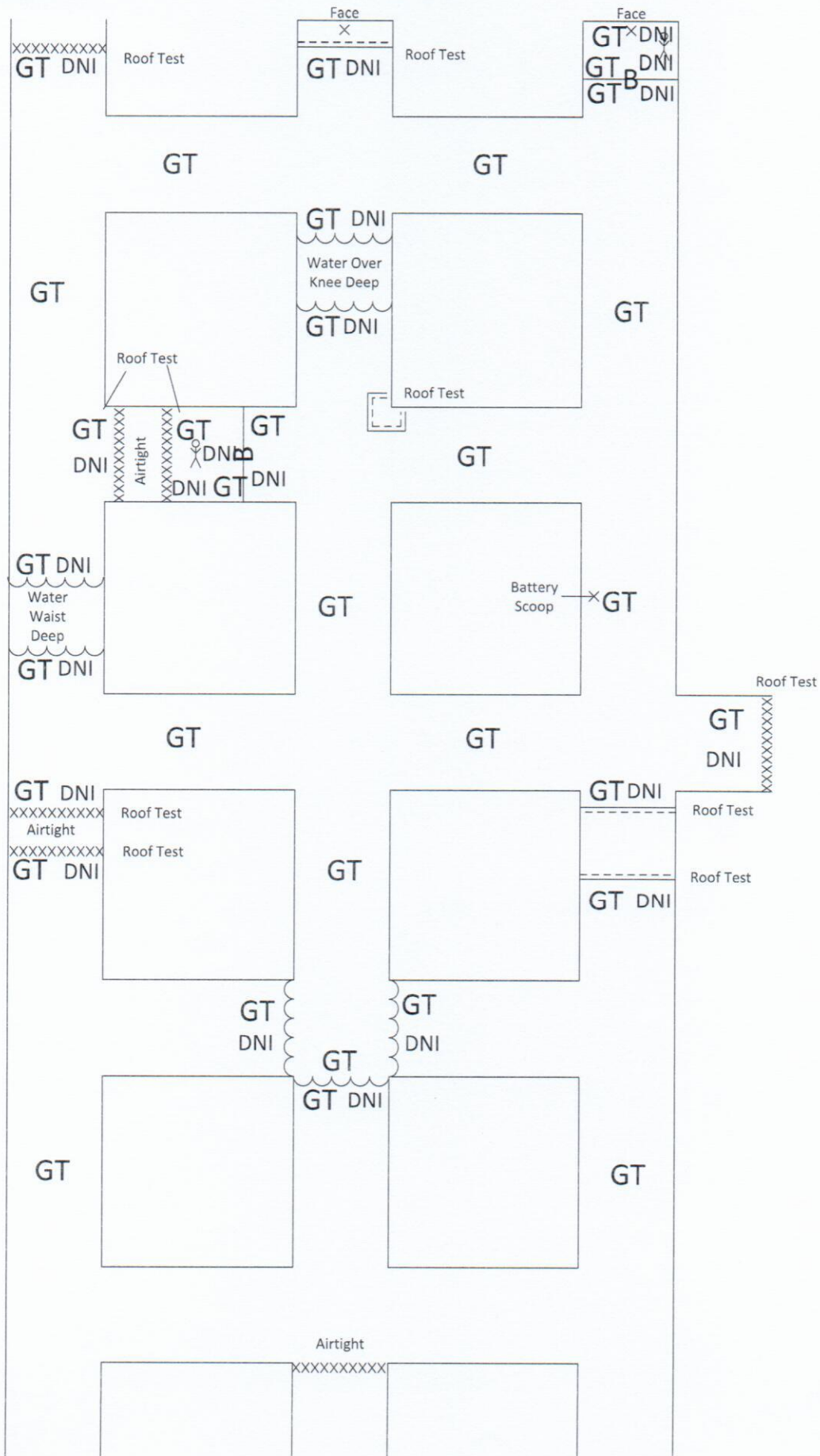

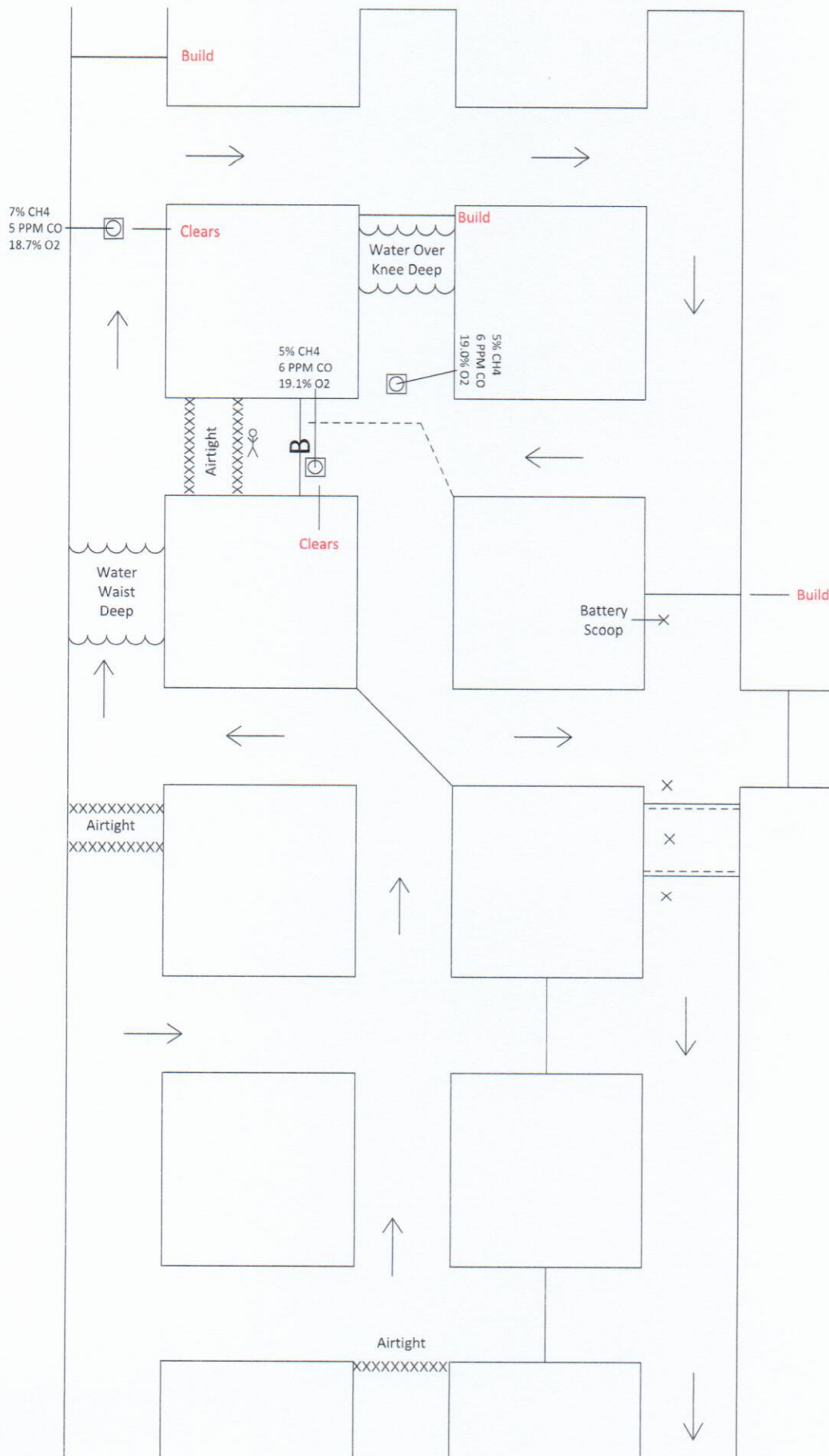

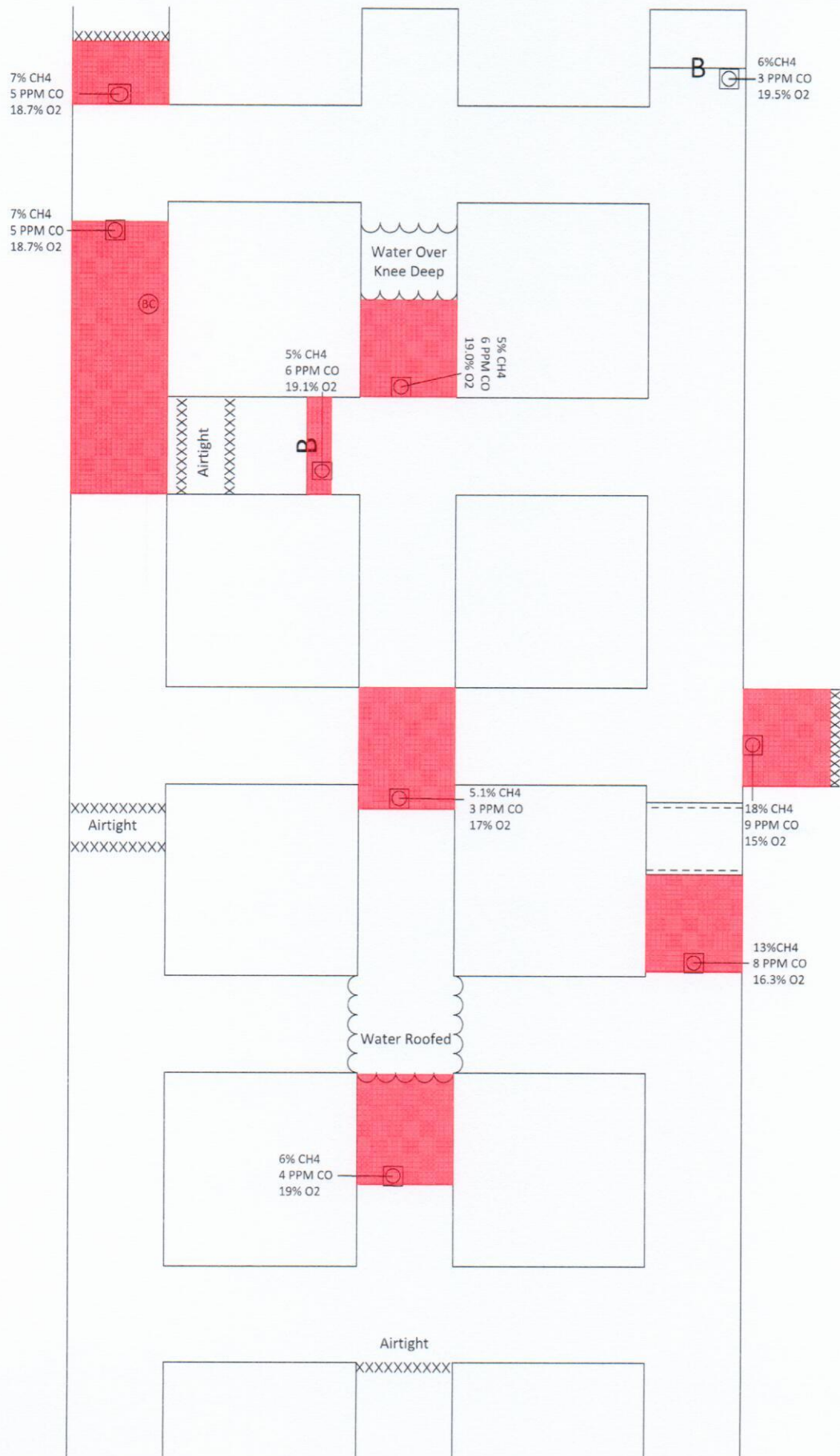

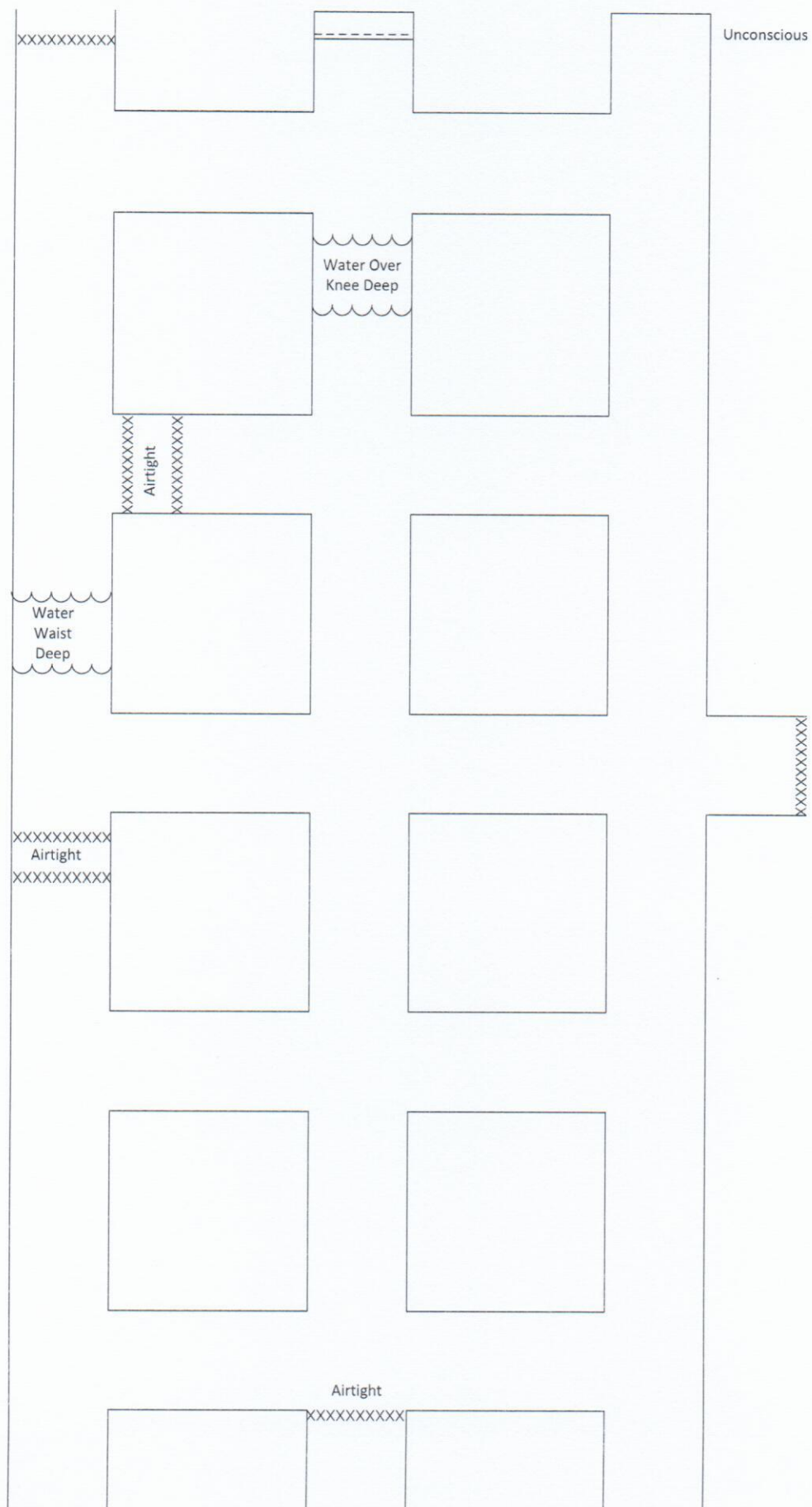

Final Vent

