

RON

**Welcome to the 49th Consecutive Virginia Mining Institute  
Safety Day Contest  
2015**

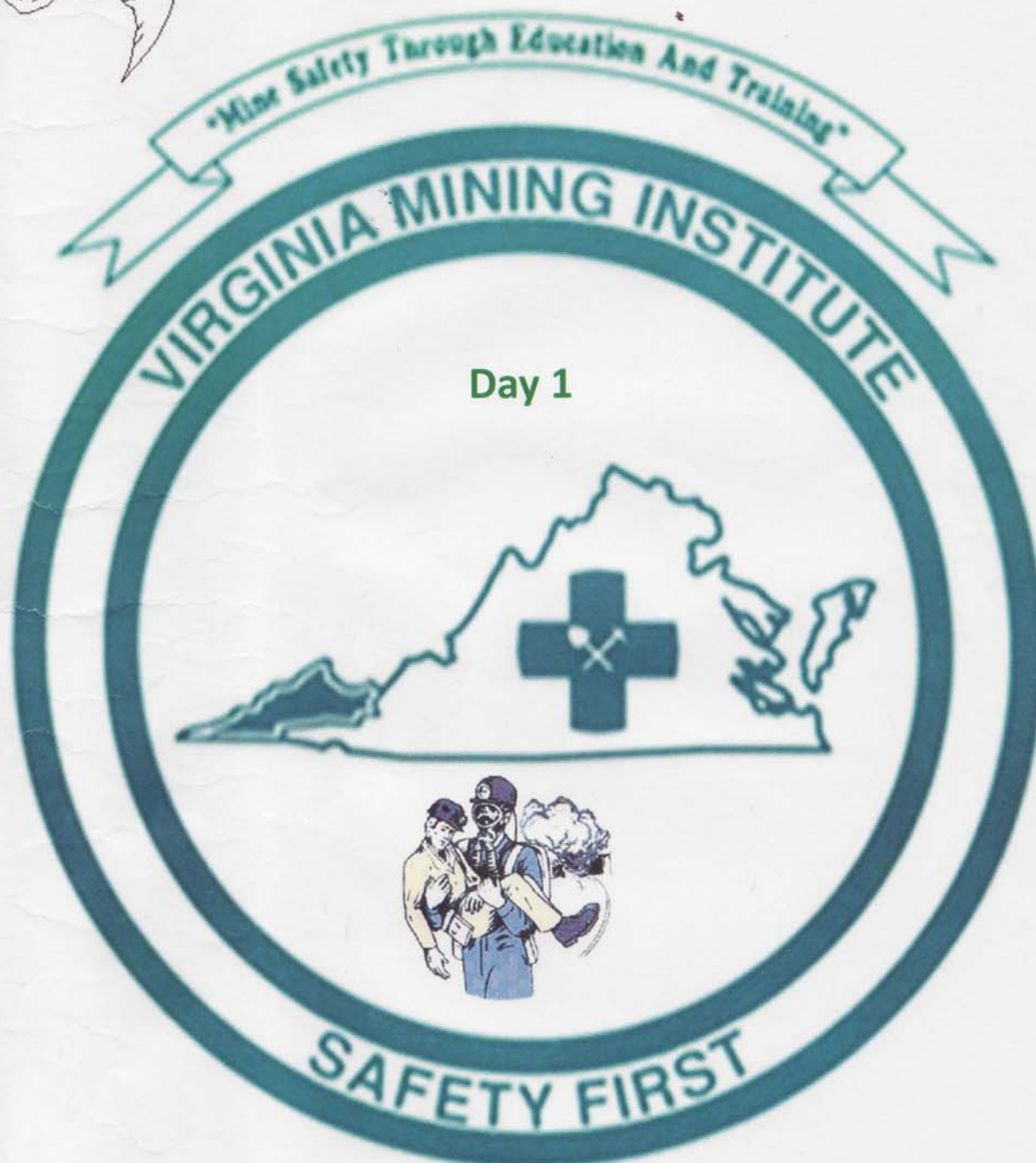

**Day 1**

**Virginia Mining Institute**  
**V-1-15**  
**Statement**

Thank you for answering Virginia Mining Company's call for help. We have had a problem at the No. 49 mine and your assistance is urgently needed. You are located on the surface near the mine portals. The mine is being ventilated by an exhaust fan installed in the no. 1 entry. The fan is presently off and can be started by turning the switch on, in the command center. When started, it cannot be turned off or reversed.

Last night at 12:01am 7 men entered the mine to conduct clean up and maintenance work on the section. At 3:00 am one man exited the mine reporting that low oxygen had been detected on the section and the crew was feeling light headed. Several attempts to contact the missing miners have been unsuccessful.

The mine does liberate methane gas. Poor roof conditions have been encountered at times and some water accumulation has occurred from time to time.

All electrical power to the underground area of the mine has been de-energized and locked out, power is supplied to the fan and pump switches located on the surface in the command center.

If the team needs to turn on the fan and/or pump doing the working of the problem, the team needs to instruct the command center to do so.

**Virginia Mining Institute**  
**V-1-15**  
**Statement**

**The mine map is not up to date; when more information is obtained you will be notified.**

**Both agencies have been notified and are present.**

**A backup mine rescue team is present to act as your back up**

**We have a competent life line judge available (point out). Two blank maps and the team's written instruction will be provided when you are ready to begin work.**



**Virginia Mining Institute**  
**V-1-15**  
**Team Instructions**  
**Problem**

- Rescue all live persons and bring them to the surface.
- Account for all missing miners.
- After the team starts the mine fan they cannot stop or reverse the fan.
- The team cannot move any ventilation control that's anchored to the ground.
- Team must identify all missing persons by recording their name on the team map after captain examine the missing person.
- A time limit of 95 minutes has been established for this problem. The team will be advised 10 minutes prior to this time limit expiring

Virginia Mining Institute  
August 4, 2015  
V-1-15

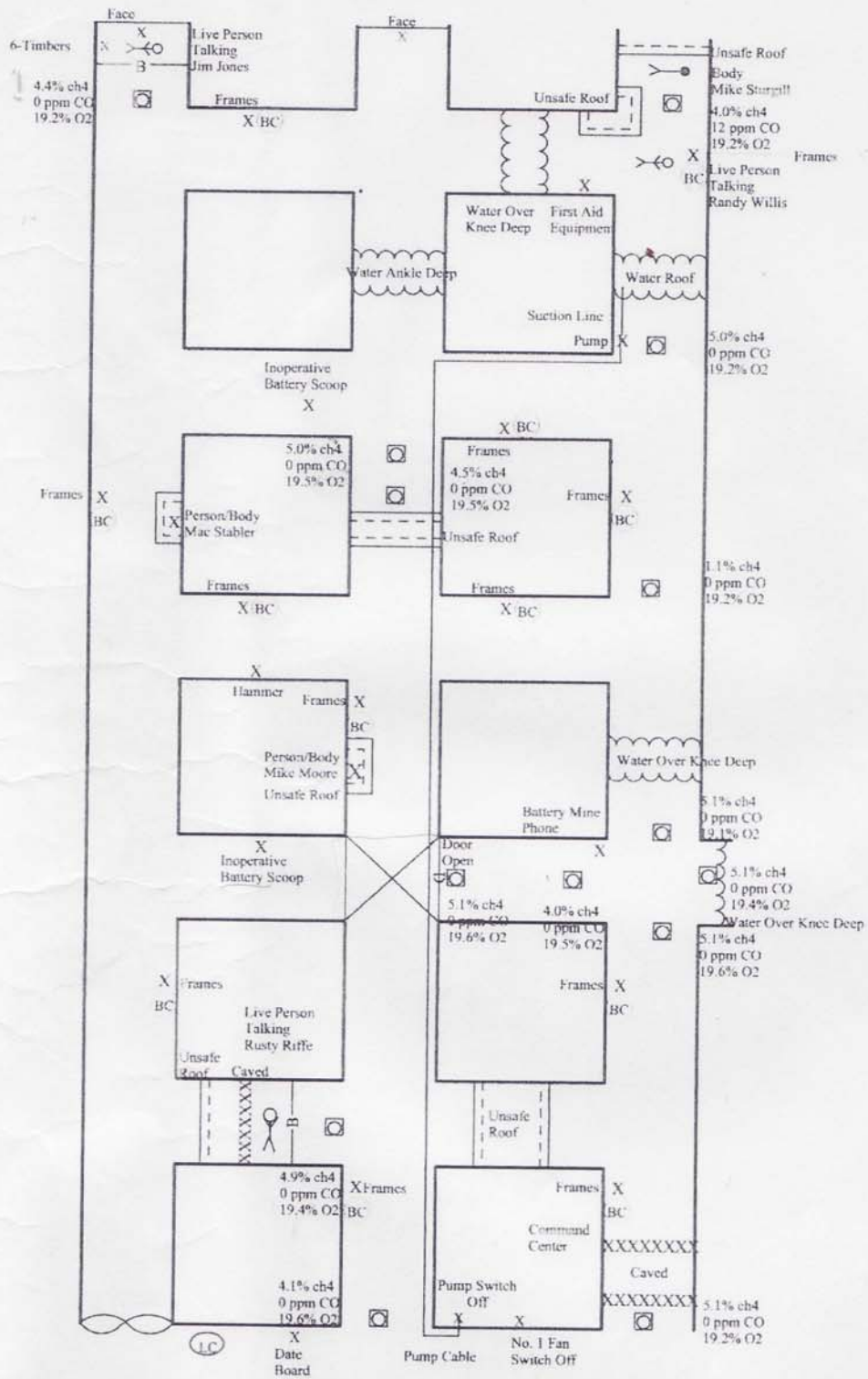

# Virginia Mining Institute

## Safety Day 2015

### GROUND RULES

- ❖ Nails are not to be used on the field. Frames anchored to the place on the field cannot be disassembled. When using these frames for ventilation control will require the connection of all straps. Four (4) straps on top and two (2) on each side must be completed.
- ❖ When removing curtain from the frames, each Velcro strap must be disconnected individually. Do not pull on the curtain to disconnect the Velcro strap. This may result in broken straps.
- ❖ 2-cone type frames and a curtain type ribbon with Velcro straps will be available for teams to use as ventilation structures. For an airtight structure, teams will be required to fasten both Velcro straps to (eyes) atop of each cone. When disassembling the structure, the curtain must be removed from both cones. For mapping purposes, the team will be required to use the symbol  for the curtain and an X for the Frame.
- ❖ Working time for the problems will be stipulated each day. If teams do not complete problem in time allowed, they will be discounted as stipulated in rule 3 A card of the mine rescue rules.
- ❖ 2 set of frames (One wood and one Cone type) and ventilation curtain will be located in the lockup area so teams can become familiar with erecting ventilation controls before they work the problem

Thanks for participating in the Contest, Enjoy your time in Blacksburgs.

Team Map  
Team No. \_\_\_\_\_

Virginia Mining Institute  
August 4, 2015  
V -1- 15

Scale: 1" = 10'

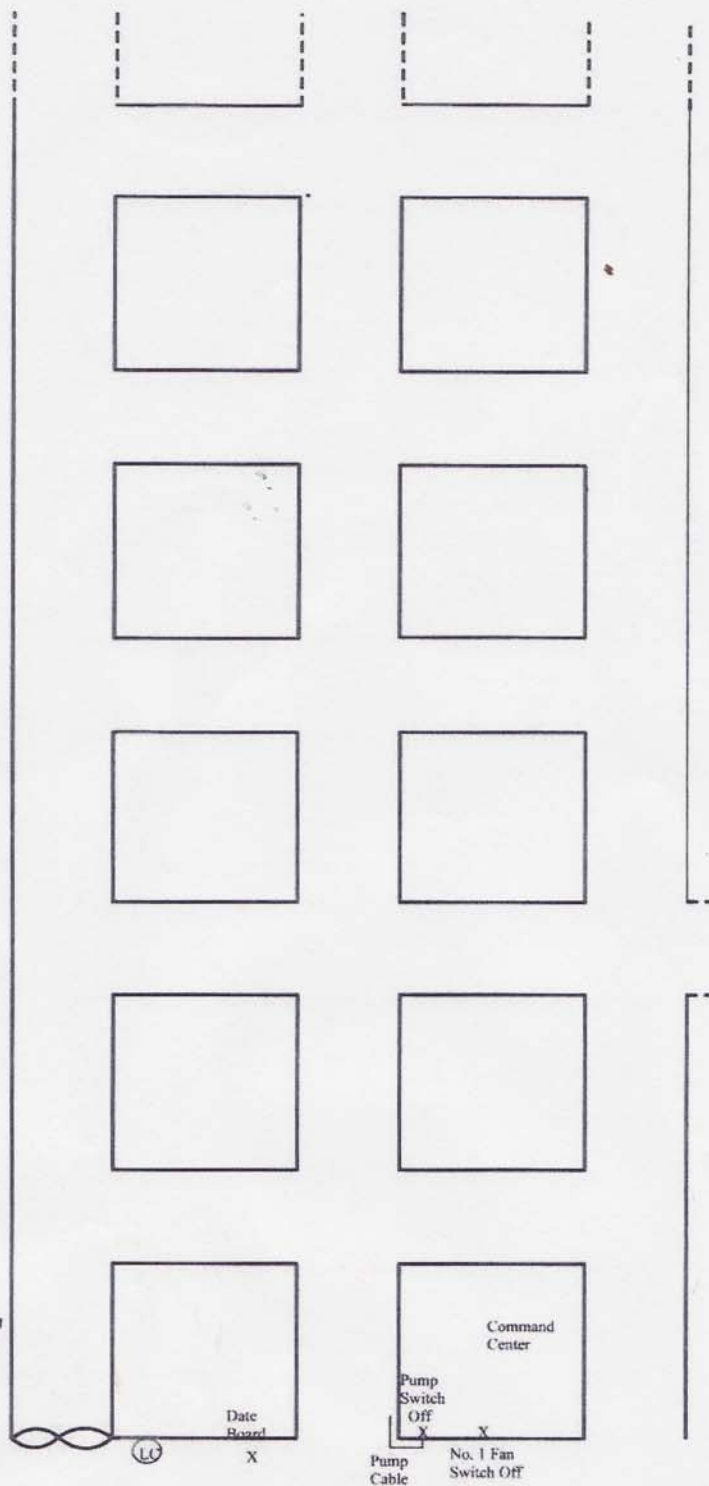



V -1- 15

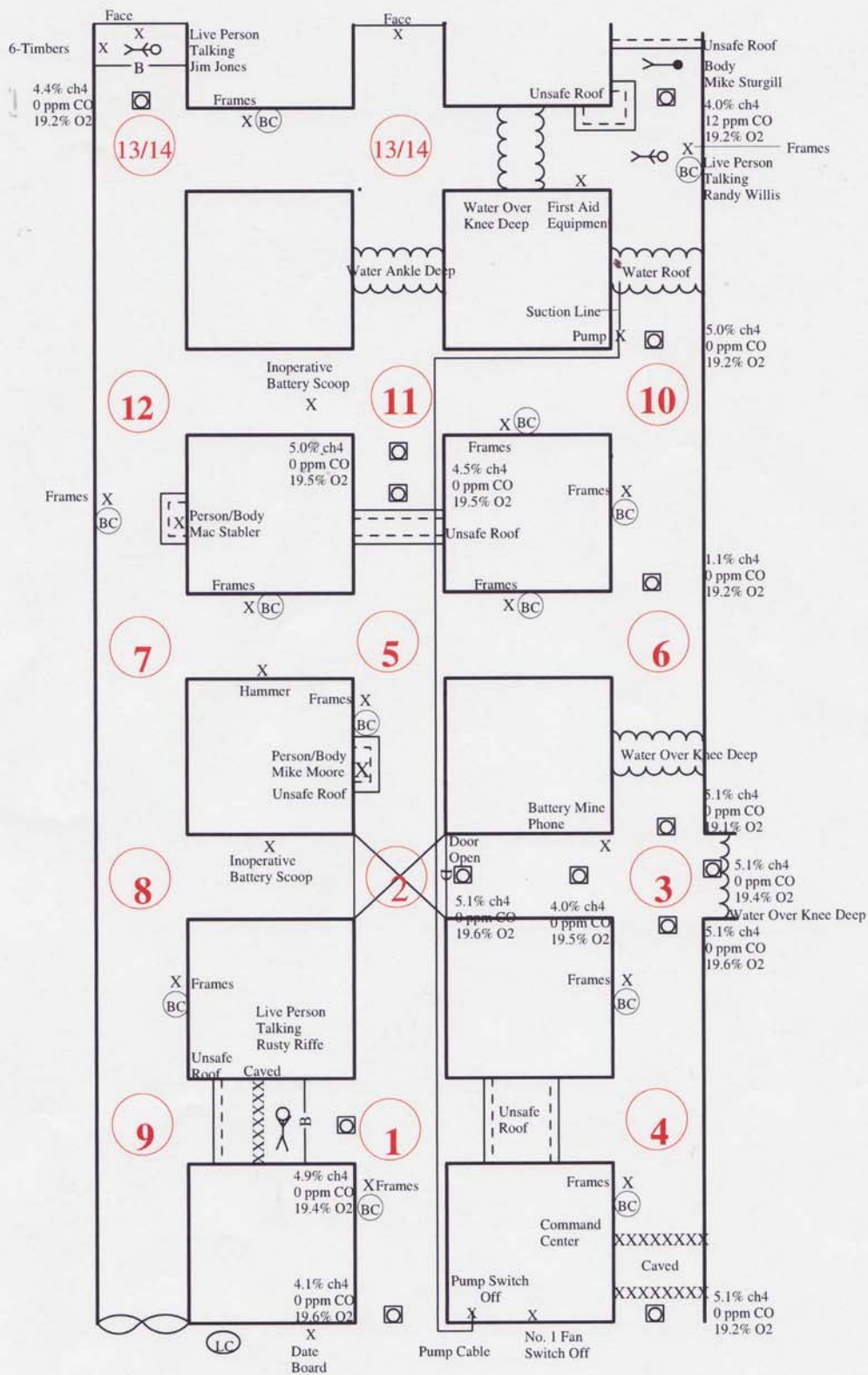



**Virginia Mining Institute**

**V- 1 – 15**

**Patient Note #1**

**(Patient "Rusty Riffe "Behind barricade at Caved area  
between No. 1 and 2 entry)**

**" Help, Help, get me out..... I have a  
Caved Area Behind me"**

**Virginia Mining Institute**

**V- 1 – 15**

**Patient Note #2**

**(Patient "Randy Willis" Behind water over knee deep - Last  
open crosscut)**

**" Help, Help, get me out.....Myself and  
one other man are located inby the water  
over knee deep"**

**Virginia Mining Institute**

**V- 1 – 15**

**Patient Note #3**

**(Patient "Jim Jones" Behind Barricade in # 1 Entry)**

**“ Help, Help, get me out..... It is  
Airtight Behind me”**



# Virginia Mining Institute

August 4, 2015

V-1-15

## First Ventilation

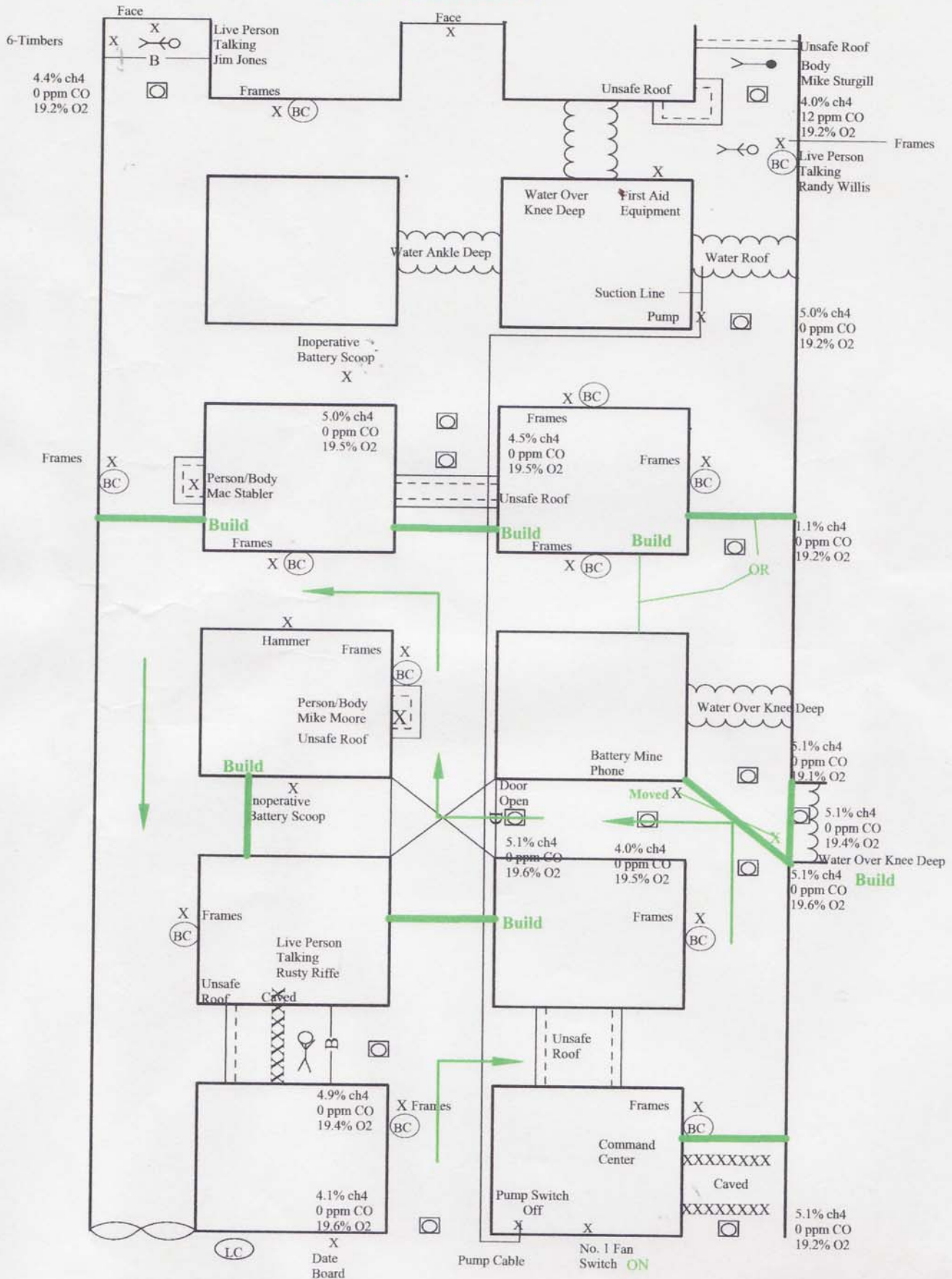

## Second Ventilation

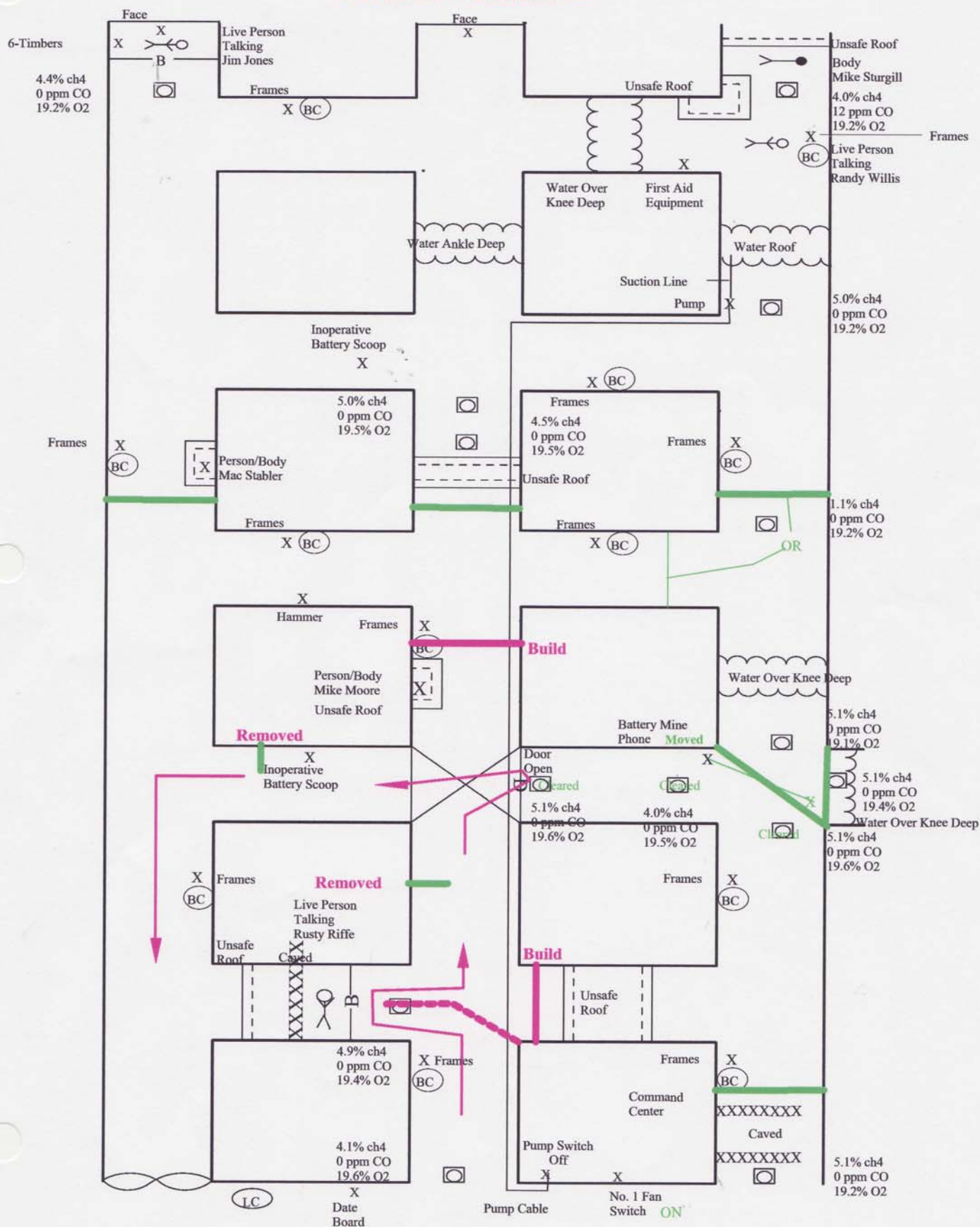

# Third Ventilation

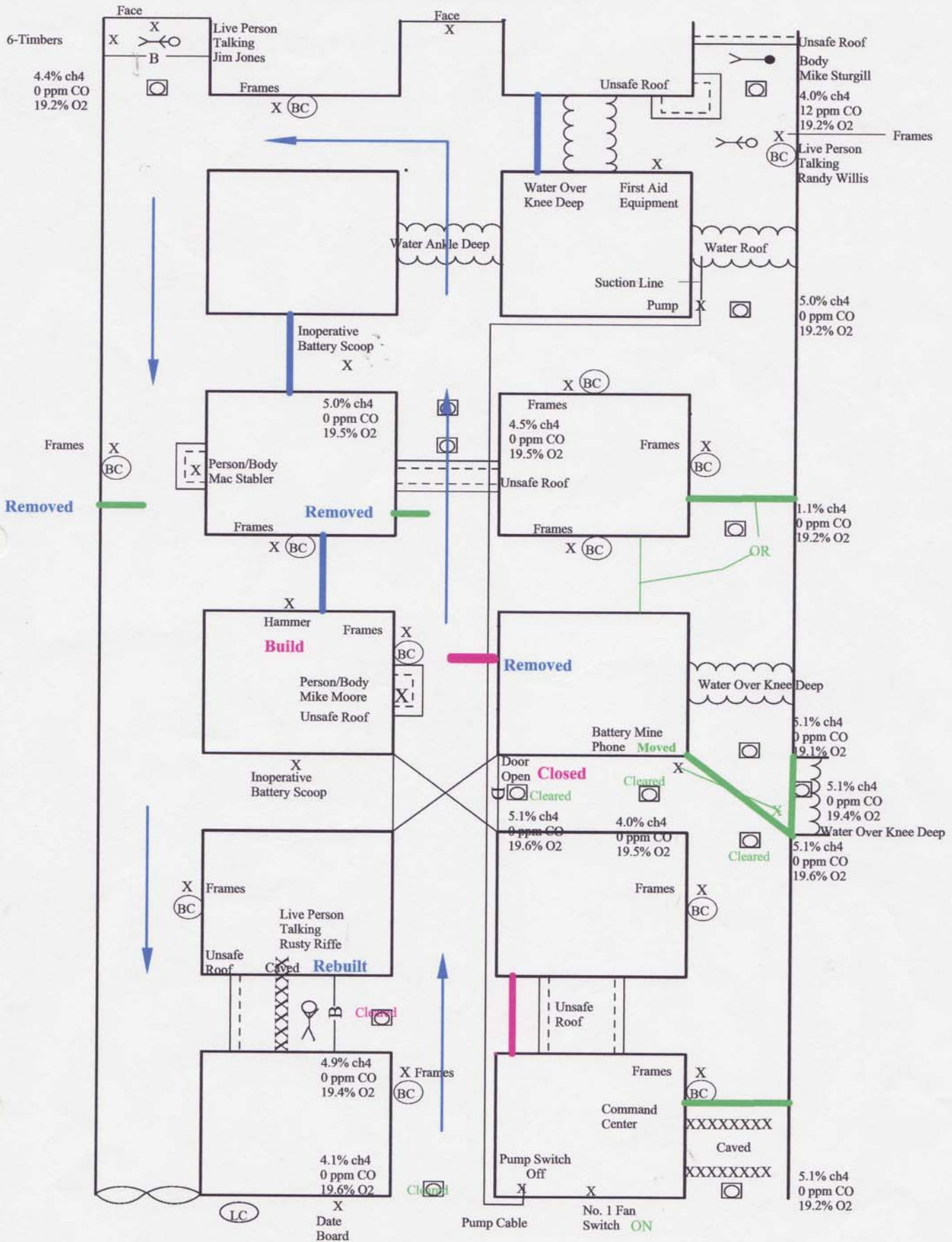



## Fourth Ventilation

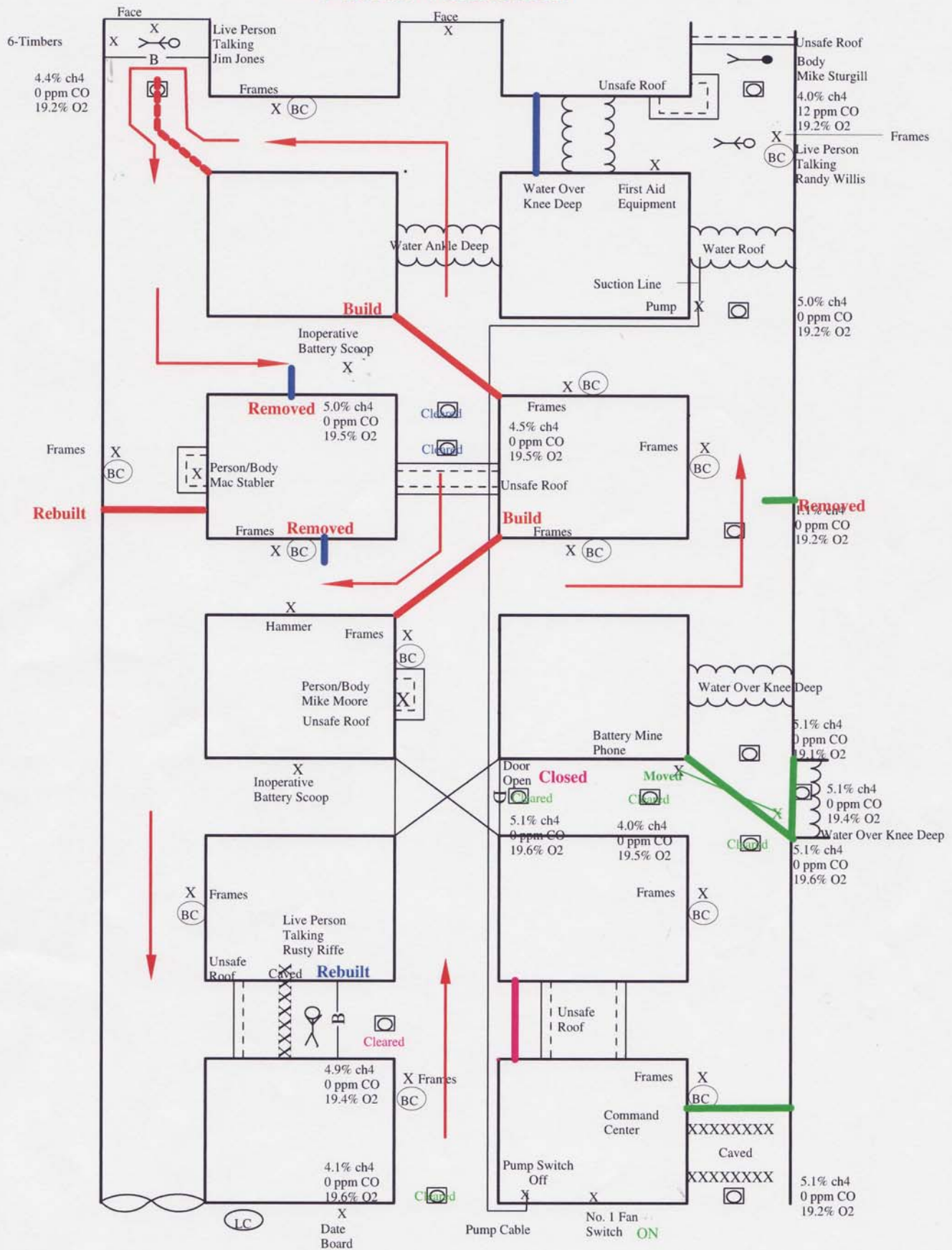

## Fifth Ventilation

