

Adam's Problem

Thanks for answering our call for assistance here at the Rotten Top #3 mine. We are currently in the process of moving our section from the last southwest right panel back up to the southwest mains. This morning an 8 man crew went to finish moving the rest of the equipment from the old panel to the new set up. Around 8 am the foreman called out and said that one of the bolt men and the electrician were making some repairs to the bolter and he doesn't know what happened but he started to smell smoke and when he walked toward the face he saw the roof bolter on fire. He yelled for the bolt man and electrician but got no response. He said he would've tried to fight the fire, but he didn't really pay attention to the mine rescue team the last time they did a fire drill and didn't know what to do. He said he was going back to try to locate the other 5 miners and we haven't heard from him since that time. Although, around 10 o'clock one of the miner men called from a mine phone on the old panel and said he and two other men were tramming a shuttle car to the new set up when they started to smell smoke. They immediately started to yell for the others but got no response and were going to the intake to come outside. The 3 men made it to the surface around 11:30 and said they had not seen any signs of the others. The RA has already been moved to the new set up, so we're hoping that maybe they deployed it and got into the shelter(if they paid attention to mine rescue during shelter training). The map we will be providing you of the new set up is up to date due to fact we have not yet started mining. This mine is hotter than the 4th of July, and has terrible roof conditions(as you can tell by its name). The mine is ventilated by a 6 ft. blowing fan that will feed fresh air to you up the #3 entry and return out the #1 entry. The fan is running and can not be stopped, stalled, or reversed. We have truck load of timbers and jacks on the way, but it's hard to tell when they will arrive. The last panel we drove off to the left has been sealed off and to my knowledge should not cause you any issues. Please help bring our miners out safely, and I promise we will pay more attention to you guys during training from now on!

Thank You,

Superintendent: John Doe

.....PROBLEM.....

CALL OUT NAMES AND LOCATIONS OF ALL MISSING MINERS

BRING ALL SURVIVORS TO THE FAB

ONLY CARRY 2 BRATTICE AT A TIME

EXPLORE ENTIRE SECTION IF YOU HAVE MEANS TO DO SO

DON'T LET YOUR MEAT LOAF

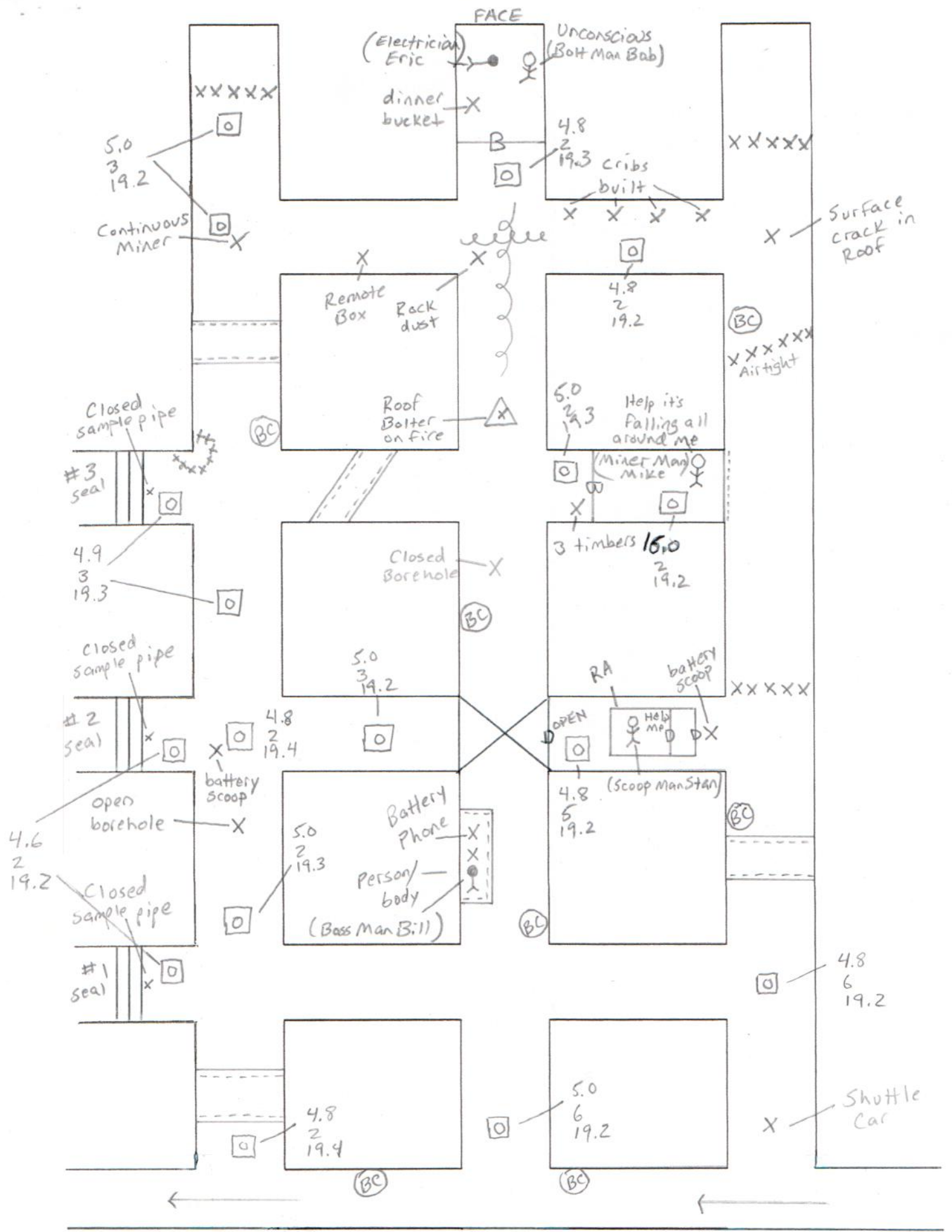

1st
Vent.

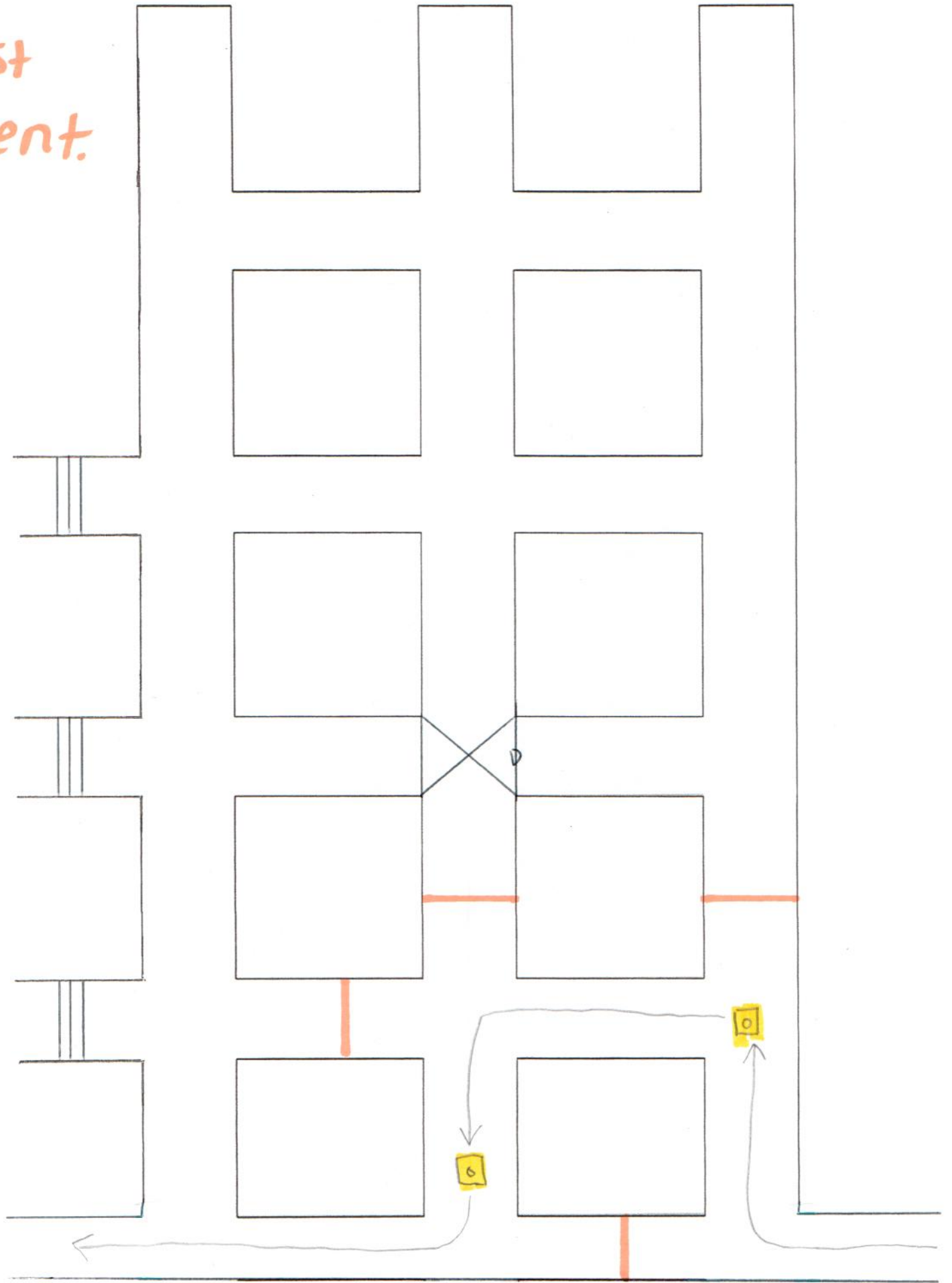

2nd
Vent.

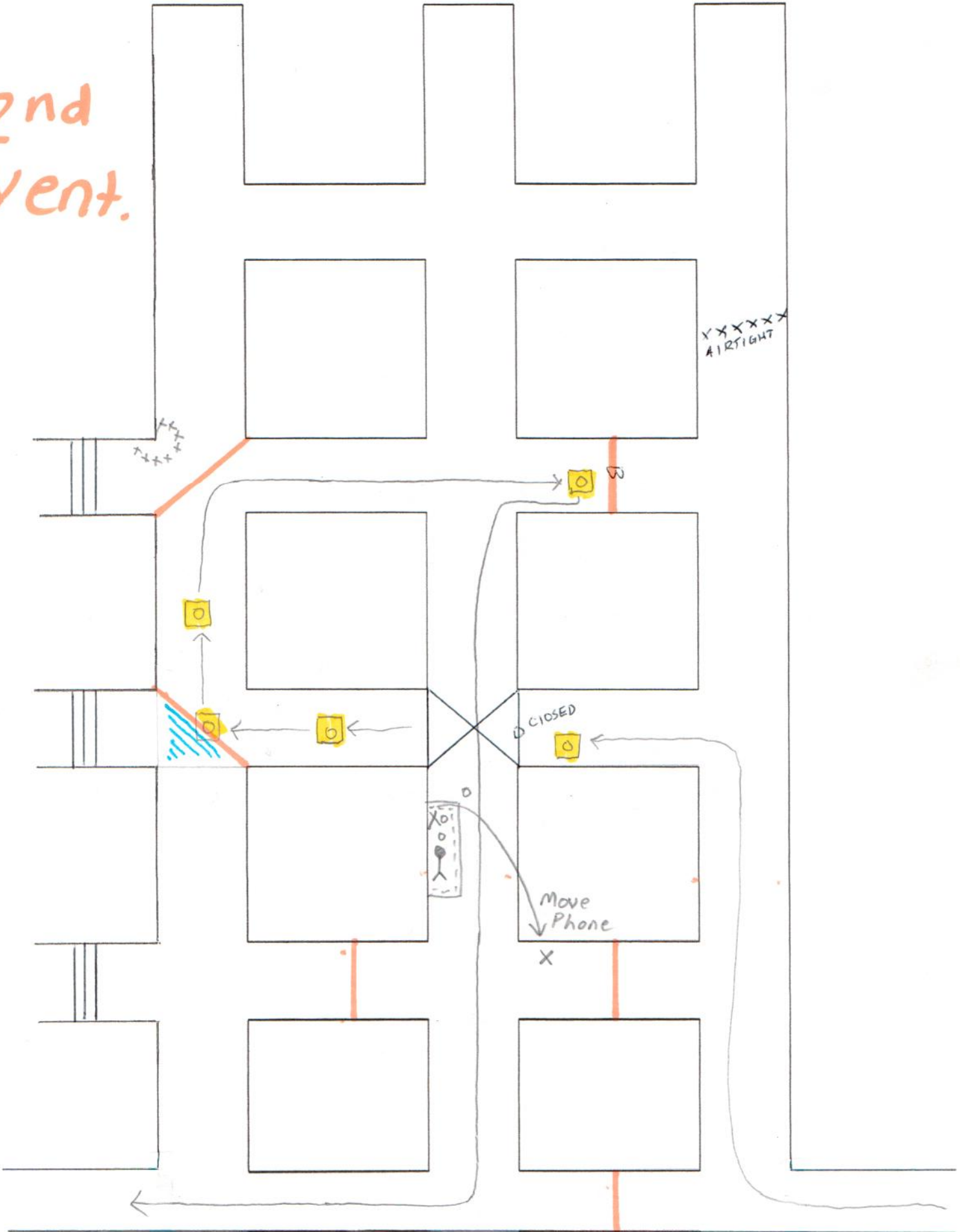

3rd
Vent.

