

PRESHIFT CONTEST

September 17, 2015



NATIONAL COMPETITION

Lexington, KY

2015 NATIONAL PRESHIFT CONTEST PRESHIFT CONTESTANT STATEMENT

The Lexington Mining Company, Wildcats #1 Mine is a single unit mine producing coal on the dayshift from the Calipari Seam and performing maintenance on the evening shift. The production unit utilizes electric and battery face equipment consisting of 1 Continuous Miner, 2 Shuttle Cars, 1 Dual Head Roof Bolting Machine, 1 Battery Powered Scoop, Auger Drill, and Maintenance Scoop.

The #1 Section, MMU 001-0, is a 3 entry section which is currently mining toward the abandoned and sealed Cardinal #1 mine. Boreholes shall be drilled in compliance with 30CFR 75.388 when mining within a 200 ft. boundary as depicted on the map by a test drill line.

The Roof Control Plan, Ventilation Plan, Emergency Response Plan, and Mine Emergency Evacuation & Firefighting Plan have been approved by MSHA and the State and are available to you for review. A copy of the mine safeguards will also be available for your review, if needed.

The previous maintenance shift was scheduled to make a belt move and start production if time permits. A message from the previous shift foreman stated, "Belt move completed, but when in the first sump in 2 right crosscut the continuous miner pump motor went down. A motor should be delivered sometime later this morning."

Our usual Preshift Examiner has examined all areas of the mine except the #1 Section from the Section Loading Point (Feeder) crosscut inby to the faces. When he arrived at the #1 Section Loading Point (Feeder) the Responsible Person on the surface contacted him via the Mine Phone to tell him that he needed to leave the mine and go to a situation at home.

You will be the only person underground during the examination. The "Responsible Person" as required by Part 75.1600-1 and Part 75.1501(a) of 30 CFR is located in the Mine Office.

You will travel via battery powered mantip to the Section Loading Point (Feeder) on the #1 Section where you are to continue the Preshift Examination until all areas that are required to be examined, have been examined and any hazards or violations of the regulations have been corrected and/or reported.

2015 NATIONAL PRESHIFT CONTEST PROBLEM MAP

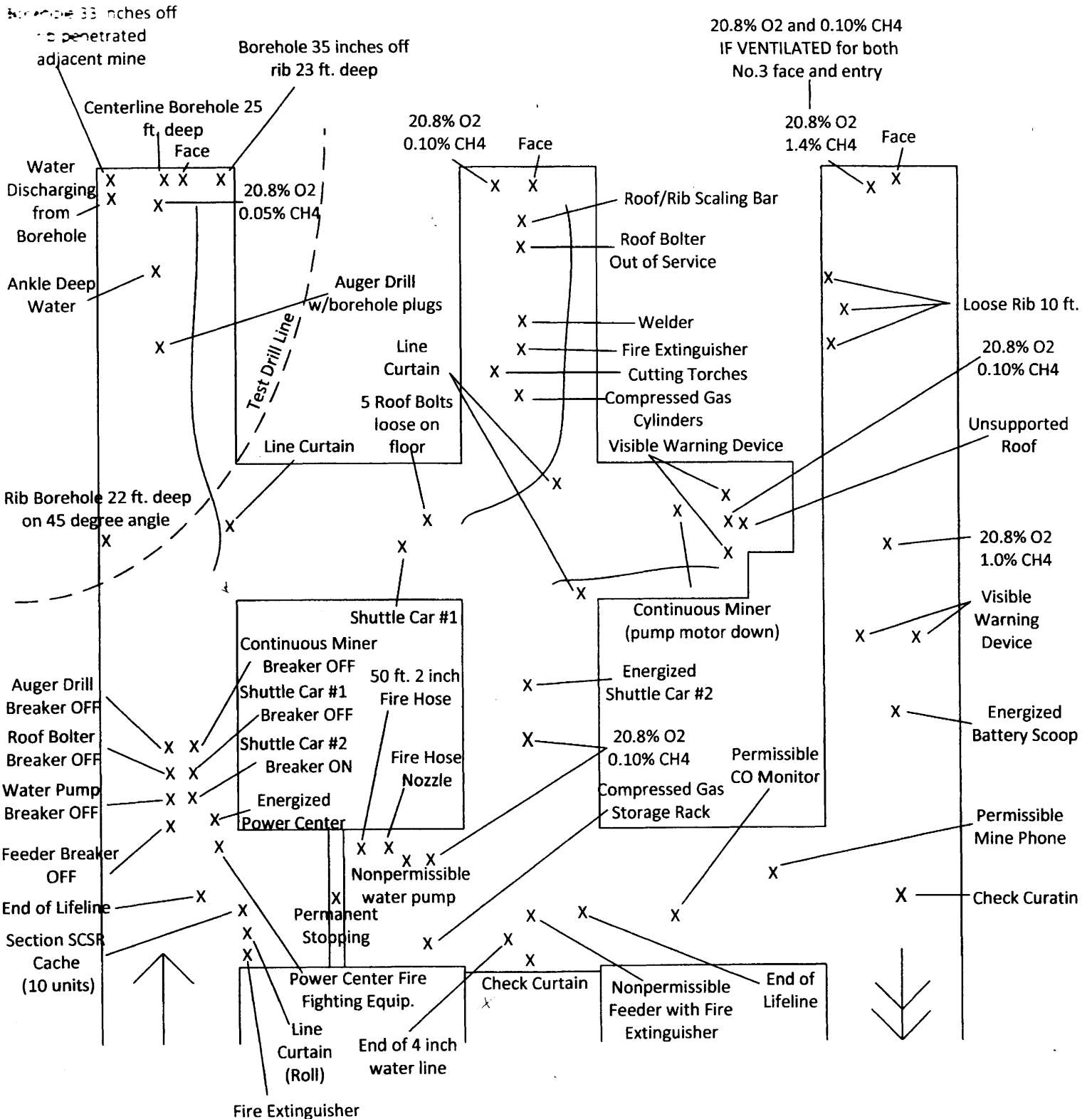

MMU 001-0

Roof Control Plan

- Minimum bolt length – 60” resin grouted rebar bolt.
- The roof bolt installation pattern is 4 feet by 4 feet.
- The maximum entry and crosscut widths are 20 feet.
- The maximum cut depth is 20 feet.
- Test holes shall be drilled in all intersections at least 24” deeper than the length of roof bolts used.
- When an unbolted crosscut is present, the preshift examiner may travel inby the crosscut to examine the working places.
- In case of emergency timbers or steel jacks may be set on a maximum of 2’ X 2’ centers in unsupported roof in order to access equipment.
- Minimum 70’ X70’ Heading and Crosscut Centers

MMU 001-0 Ventilation Plan

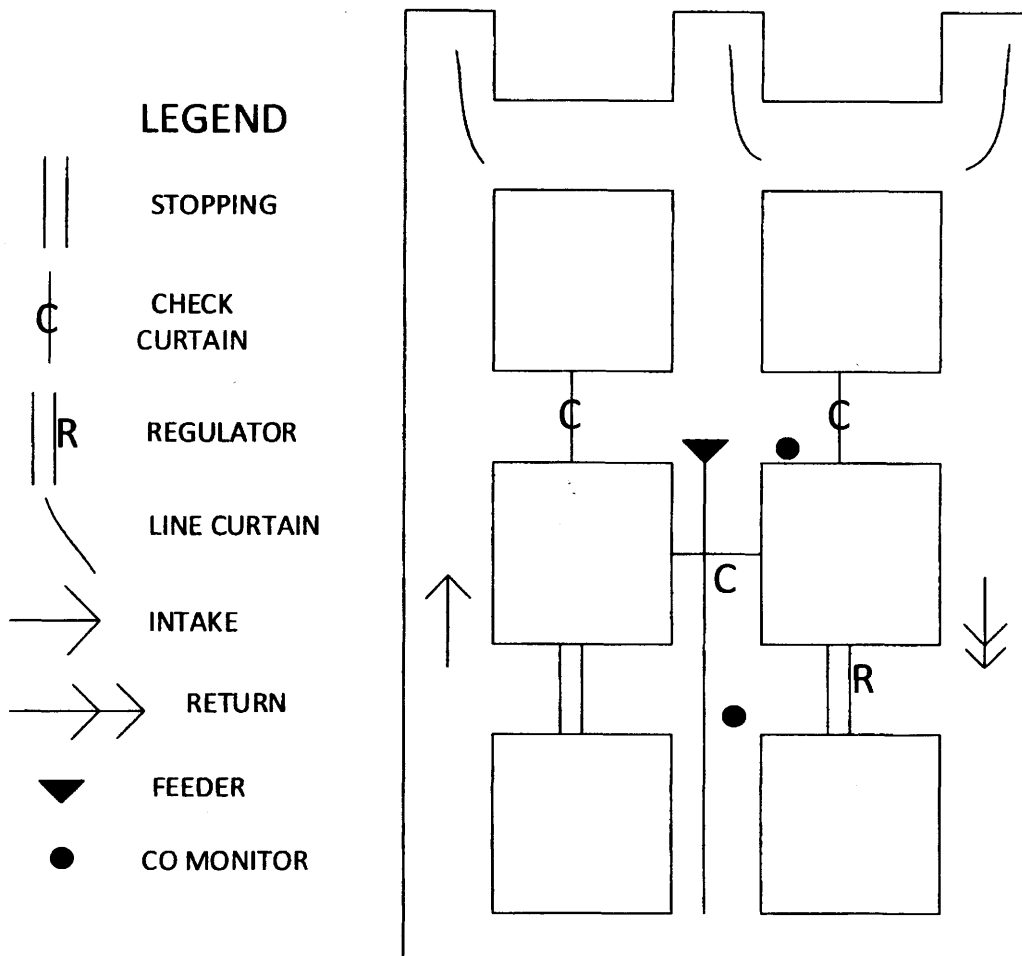

EXHAUSTING MAIN MINE FAN MUST BE OPERATED CONTINUOUSLY

20,000 CFM MUST BE PROVIDED IN THE LAST OPEN CROSSCUT

7,000 CFM MUST BE PROVIDED AT END OF LINE CURTAIN WHERE
COAL IS BEING CUT, MINED OR LOADED

LINE CURTAIN MUST BE INSTALLED WITHIN 10 FT. OF FACE FOR
BOLTED PLACES AND NEXT TO THE LAST ROW OF PERMANENT ROOF
SUPPORT FOR UNBOLTED PLACES

MMU 001-0

20 foot cut plan

not to scale

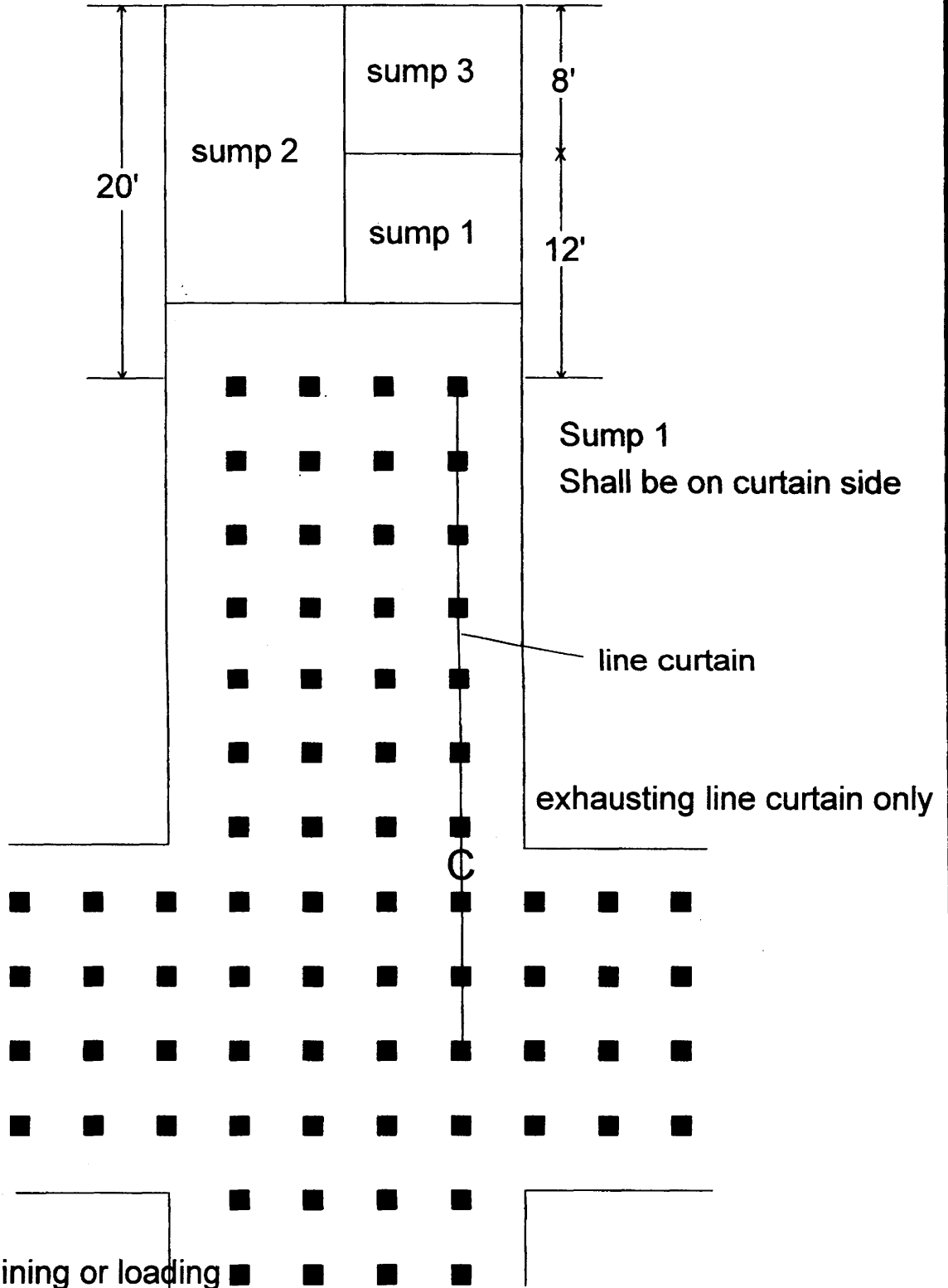

While cutting, mining or loading Inby end of line curtain will be maintained within 20' of the deepest penetration

EMERGENCY RESPONSE PLAN

MMU 001-0

Refuge Alternative shall be within 1000 ft. of working faces.

Refuge Alternative shall not be positioned in direct line of sight of working face

Refuge Alternative shall be a minimum of 12 person capacity

Minimum of 12 SCSR's shall be stored in section cache.

Summary of Safeguards

Section	Number	Description
75.1403	0000001	Notice of safeguard to maintain water below the ball of the mine track used to transport men to and from work areas.
75.1403	0000002	Notice of safeguard to maintain stop blocks on all end of track locations.
75.1403	0000003	Notice of safeguard to maintain all travelways and haulageways free of extraneous materials to facilitate safe travel of men and materials.
75.1403	0000004	Notice of safeguard requiring all scoops at this mine to be provided with a remote means to energize and de-energize the main breaker without persons entering the articulation area of the scoop.

MMU 001-0 BOREHOLE PLAN

Face Boreholes (test drilling) shall be drilled per 30 CFR 75.388 (b) and (c) in by test drill line shown on plan.

Face Boreholes shall be drilled as follows:

- 1. Parallel to the working face, parallel to the rib, and within 3 feet of each rib.
- 2. Parallel to the working face, parallel to the rib, and at intervals across the face not to exceed 8 feet.
- 3. At least 20 feet in depth in advance of the working face, and always maintained to a distance of 10 feet in advance of the working face.

Rib Boreholes shall be drilled in both ribs of advancing working places. These boreholes shall be drilled:

- 1. At an angle of 45 degrees to the direction of advance;
- 2. At least 20 feet in depth; and
- 3. At intervals not to exceed 8 feet.

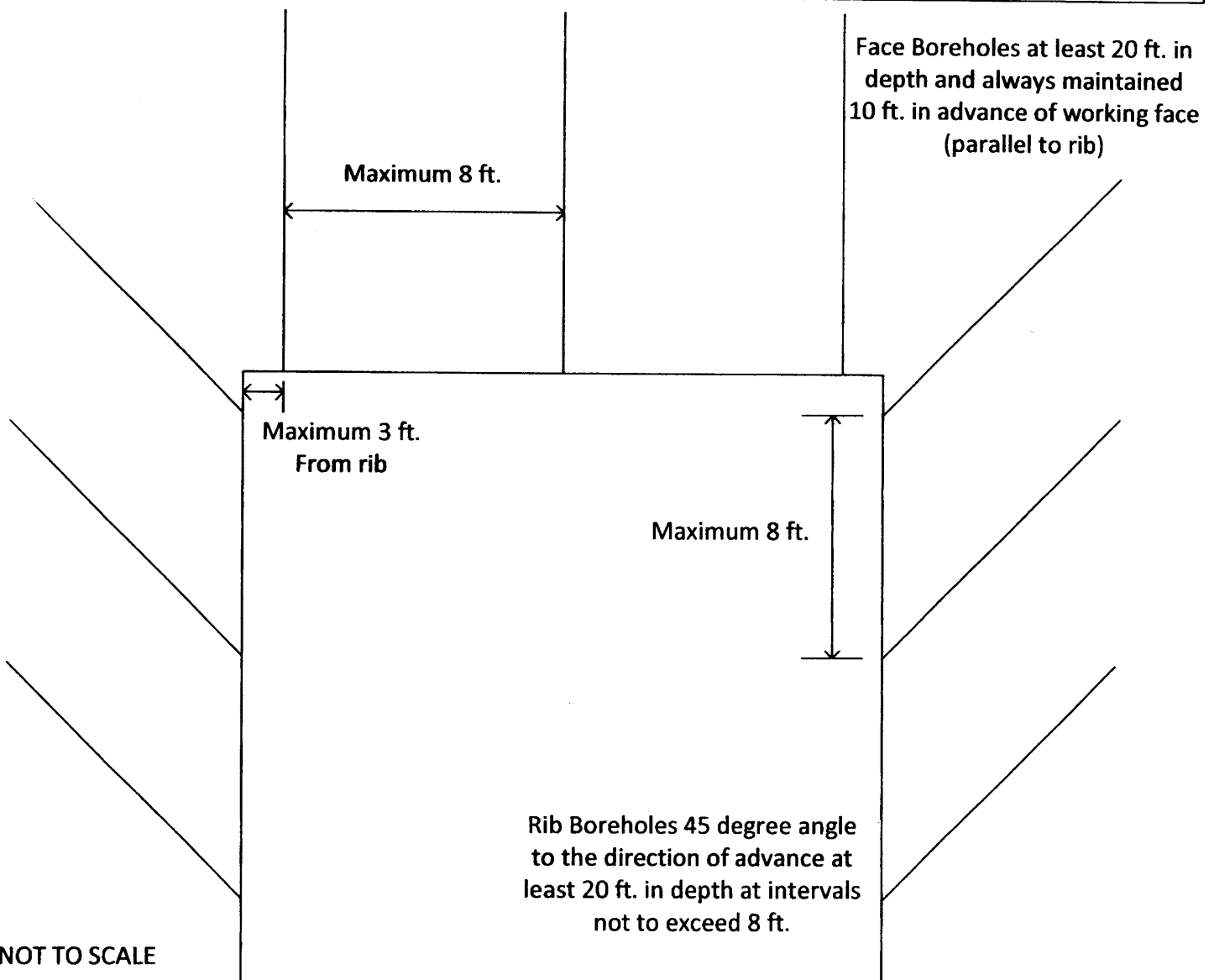

JUDGE'S MAP

#2 Entry

#3 Entry

Test Drill Line

Check In
Station

4 1 Cut

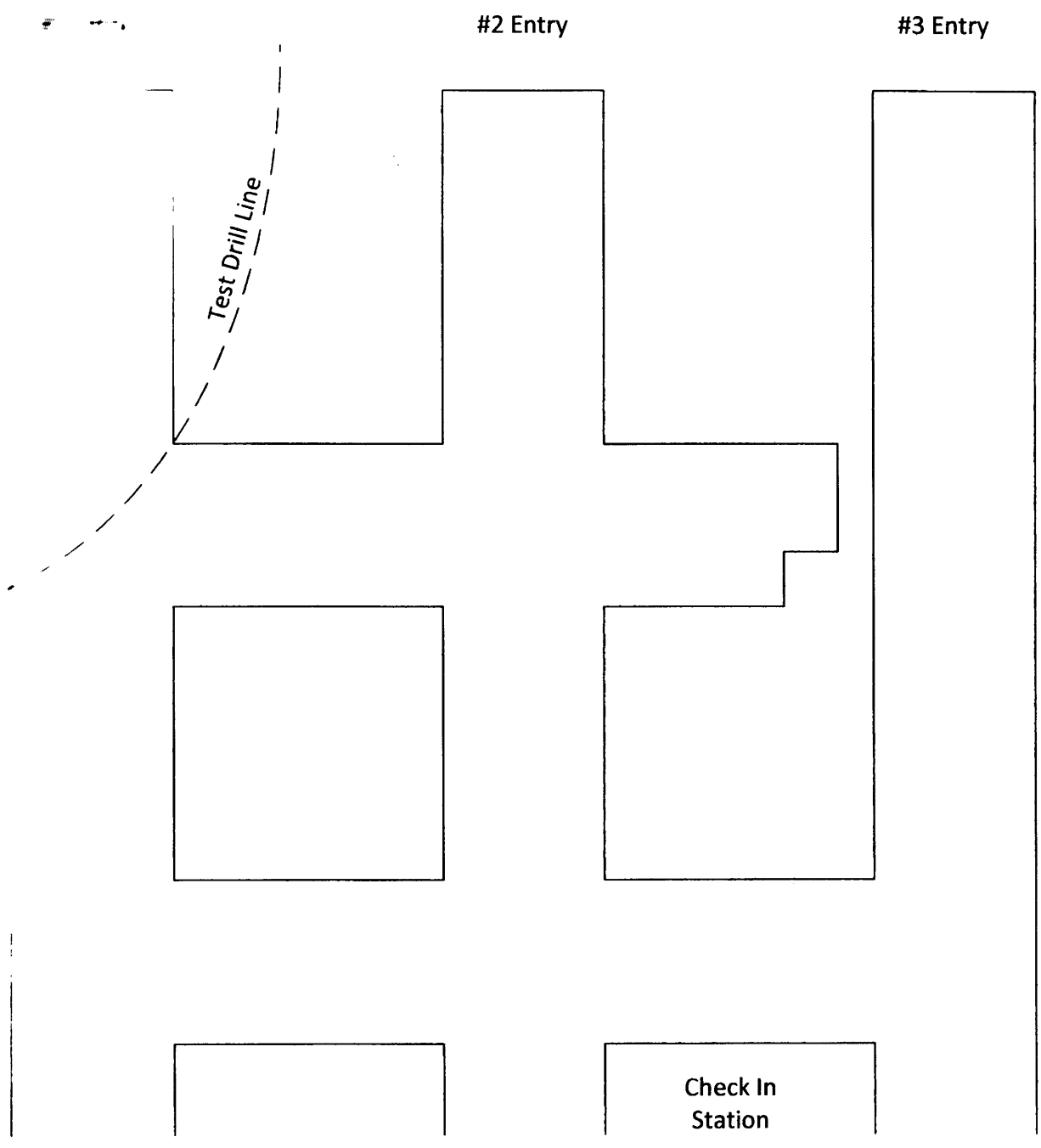

LAST OPEN CROSSCUT AIR READINGS

ENTRY WIDTH → 20 FEET

ENTRY HEIGHT → 6.5 FEET

VENTILATION AS SHOWN

Velocity - 175 fpm

$$20 \times 6.5 \times 175 = 22,750 \text{ cfm}$$

VENTILATION IF RETURN RESTRICTED
WITH CURTAIN

Velocity - 50 fpm

$$20 \times 6.5 \times 50 = 6,500 \text{ cfm}$$

ANEMOMETER TURNED BACKWARDS

Velocity - 825 fpm

$$20 \times 6.5 \times 825 = 107,250 \text{ cfm}$$

PRE-SHIFT - CERTIFIED EXAMINER'S REPORT

Use Indelible Pencil or Ink

Report Shall Be Signed by _____

Date of Examination: _____ Time From: _____ AM/PM To: _____ AM/PM

Section/ Area: _____ Reported Outside? Yes ___ No ___ Time: _____ AM/PM

Reported By: _____ Received By: _____ INITIALS

(AUTHORIZED PERSON)

Pre-shift required within 3 hours prior to any 8 hour interval.

Location	Hazardous Condition	Action Taken	
No. 1 Face	Borehole Discharging Water	Plugged	
No. 1 Entry	Insufficient SCSR's	Dangered off	
No. 1 Entry	No Rib boreholes drilled inby test drill line	Dangered off	
No. 1 Entry and Power Center			0.05%
No. 1 Face			0.05%
A Cross-cut between 1 and 2 Entries	Insufficient length of fire hose to reach faces	Dangered off	
A Cross-cut between 1 and 2 Entries	No fire extinguisher at water pump electrical installation	Placed fire extinguisher at pump installation	0.10%
A Cross-cut between 1 and 2 Entries	Nonpermissible water pump in return	Dangered off	
B Cross-cut between 1 and 2 Entries	Loose roof bolts in travelway	Moved	
No. 2 Entry			0.10%
No. 2 Entry	Compressed gas cylinders inby last open cross-cut	Moved to storage rack	
No. 2 Face			0.10%
No. 2 Entry	Energized #2 Shuttle Car	De-energized Shuttle Car	

Air Measurements

Location	CFM	Location	CFM
LOCC	22,750 CFM		

Remarks:

Signed by Pre-shift Certified Examiner

Date

Certification Number

PRE-SHIFT - CERTIFIED EXAMINER'S REPORT

Use Indelible Pencil or Ink

Report Shall Be Signed When Finished

Date of Examination: _____ Time From: _____ AM/PM To: _____ AM/PM

Section/ Area: _____ Reported Outside? Yes ___ No ___ Time: _____ AM/PM

Reported By: _____ Received By: _____ (INITIALS)
(AUTHORIZED PERSON)

Pre-shift required within 3 hours prior to any 8 hour interval.

Location	Hazardous Condition	Action Taken	CH4
No. 2 Entry	Nonpermissible feeder in return	Dangered off	
No. 2 Right Face			0.10%
No. 2 Right Face	Cut/Sump Sequence - not per approved vent plan	Dangered off	
No. 3 Entry			1.0%
No. 3 Face	No line curtain 1.4% CH4	Installed line curtain	1.4%
No. 3 Entry/Face		Retest for CH4	0.10%
No. 3 Entry	Scoop breaker energized in 1.0% CH4	Knocked breaker	
No. 3 Entry inby LOCC	Loose Rib 10 ft.	Scaled/Pulled down	

Air Measurements

Location	CFM	Location	CFM

Remarks:

Signed by Pre-shift Certified Examiner

Date

Certification Number