

JUDGES BRIEFING

- Team must continue to explore after encountering the barricade in #2.
- Once team explores to the overcast in #3, 2nd crosscut, the patient talks to the team once team enters the intersection. Team must airlock and remove patient to the F-A-B. He must be under air and the team must airlock between #1 and #2 to get to the F-A-B. The timbers found at this stop allow the team to ventilate the barricade in #2.
- The first ventilation should be done in this order: Build at the over knee deep water and timber the unsafe roof, prior removing stopping in the crosscut.
- The second ventilation should be done in this order to keep from stalling the fan. Open the door in overcast #1 prior to closing the door in overcast in #3.
- After removing the patient in #2, if team elects to airlock at the overcast in #3 the team must open door in the overcast in #1 so team does not stall the fan.
- On the 3rd ventilation team must open the door in the overcast in #2 prior to closing the door in the overcast that has a door open at this time.

Caved
Air
Tight
X
X
X
X

Waist
Deep
Water
←
20,000CFM

←
20,000CFM

X
X
X
X
Caved
Air
Tight

Open

B.O
D

(LC)

XXXXXXXXXX — Caved Air Tight

Fresh Airbase Team Map

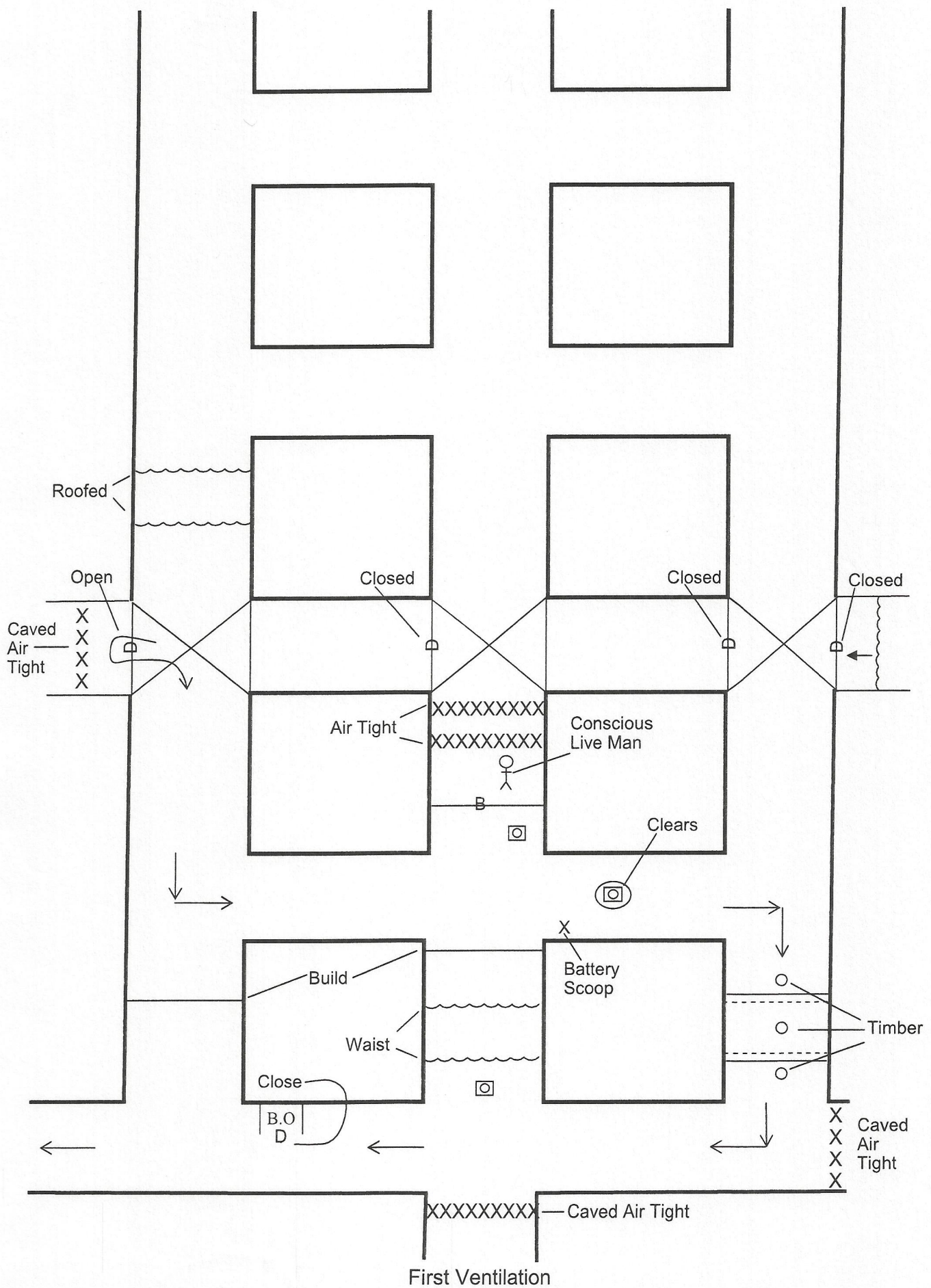

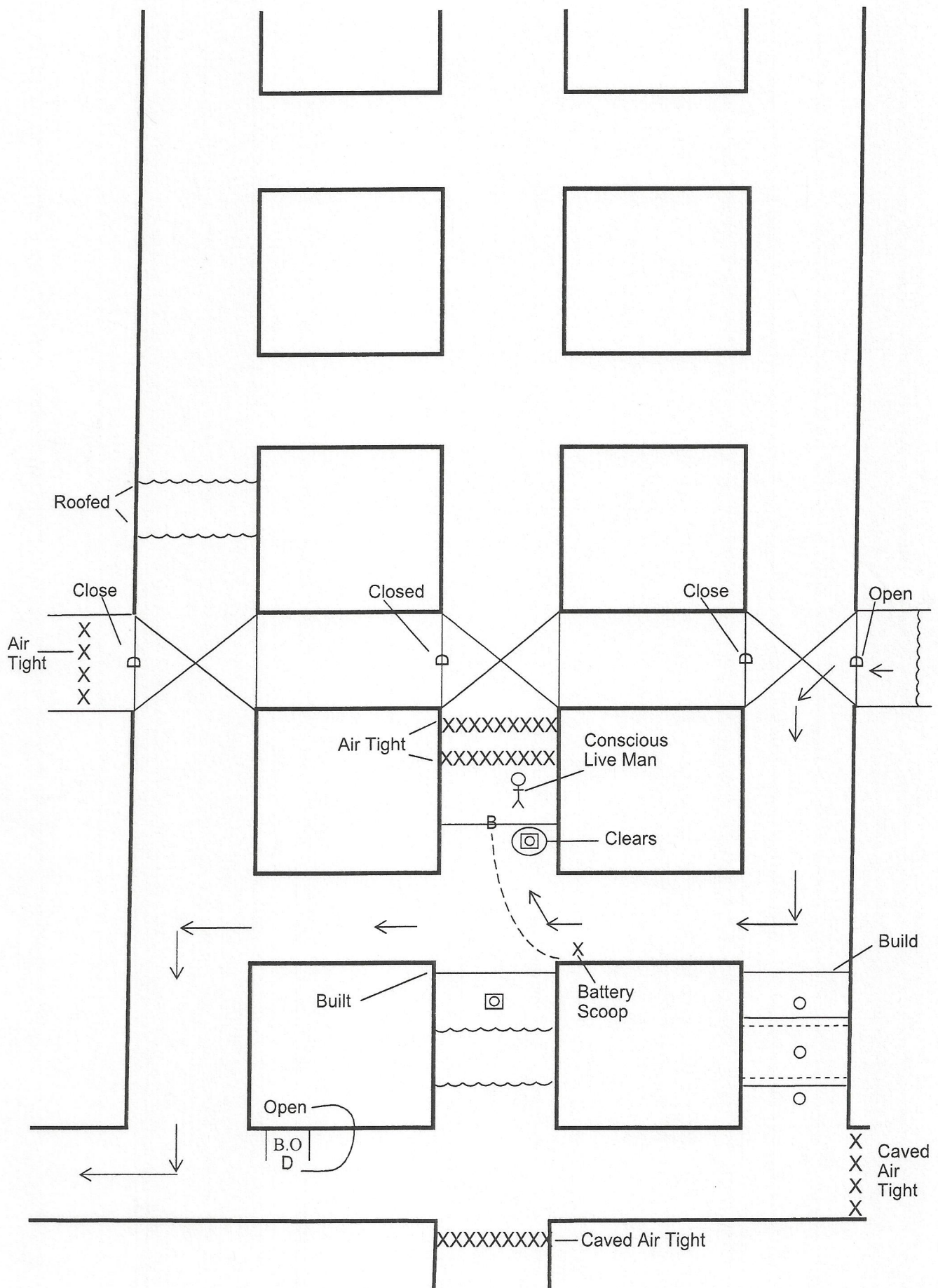

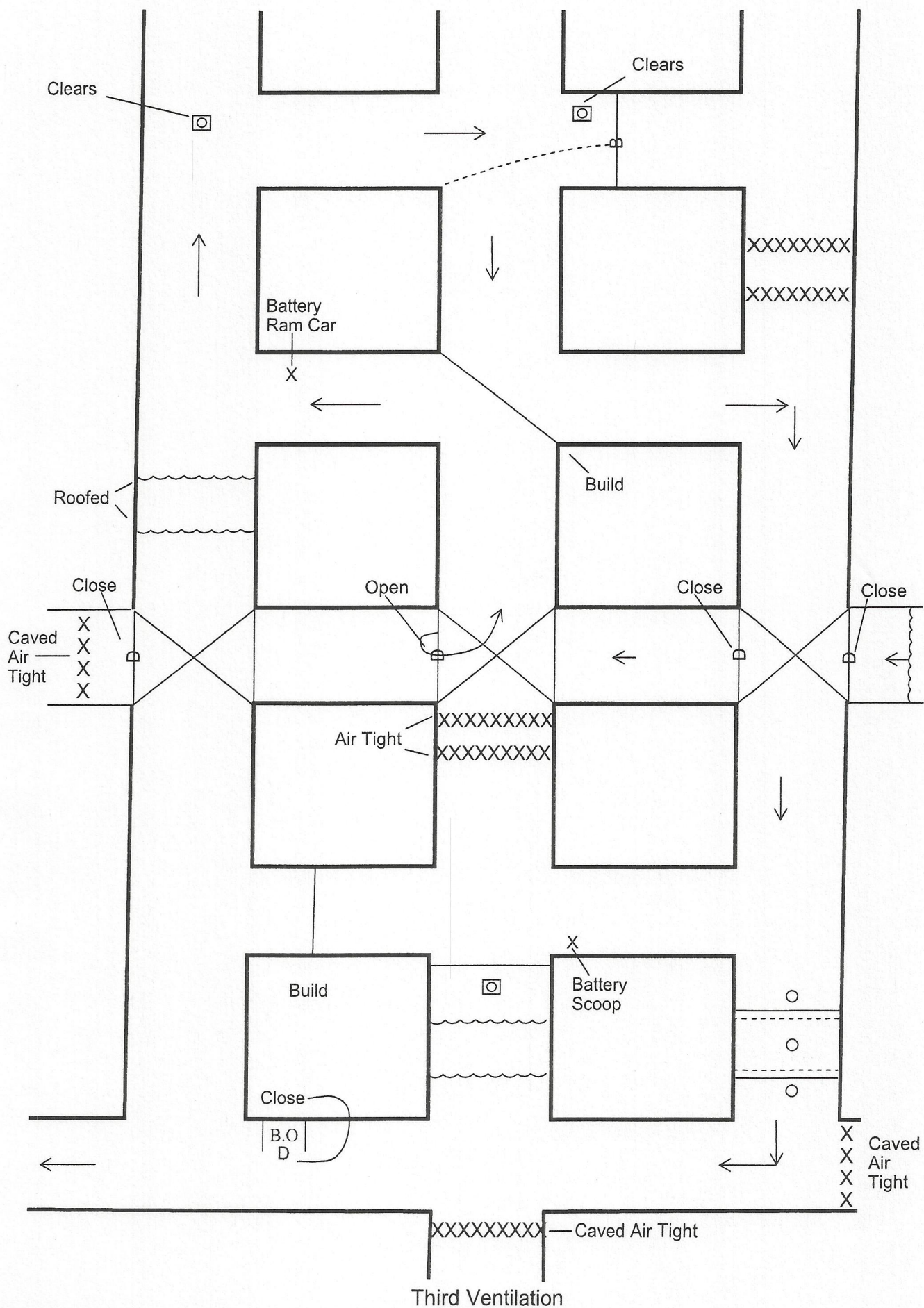

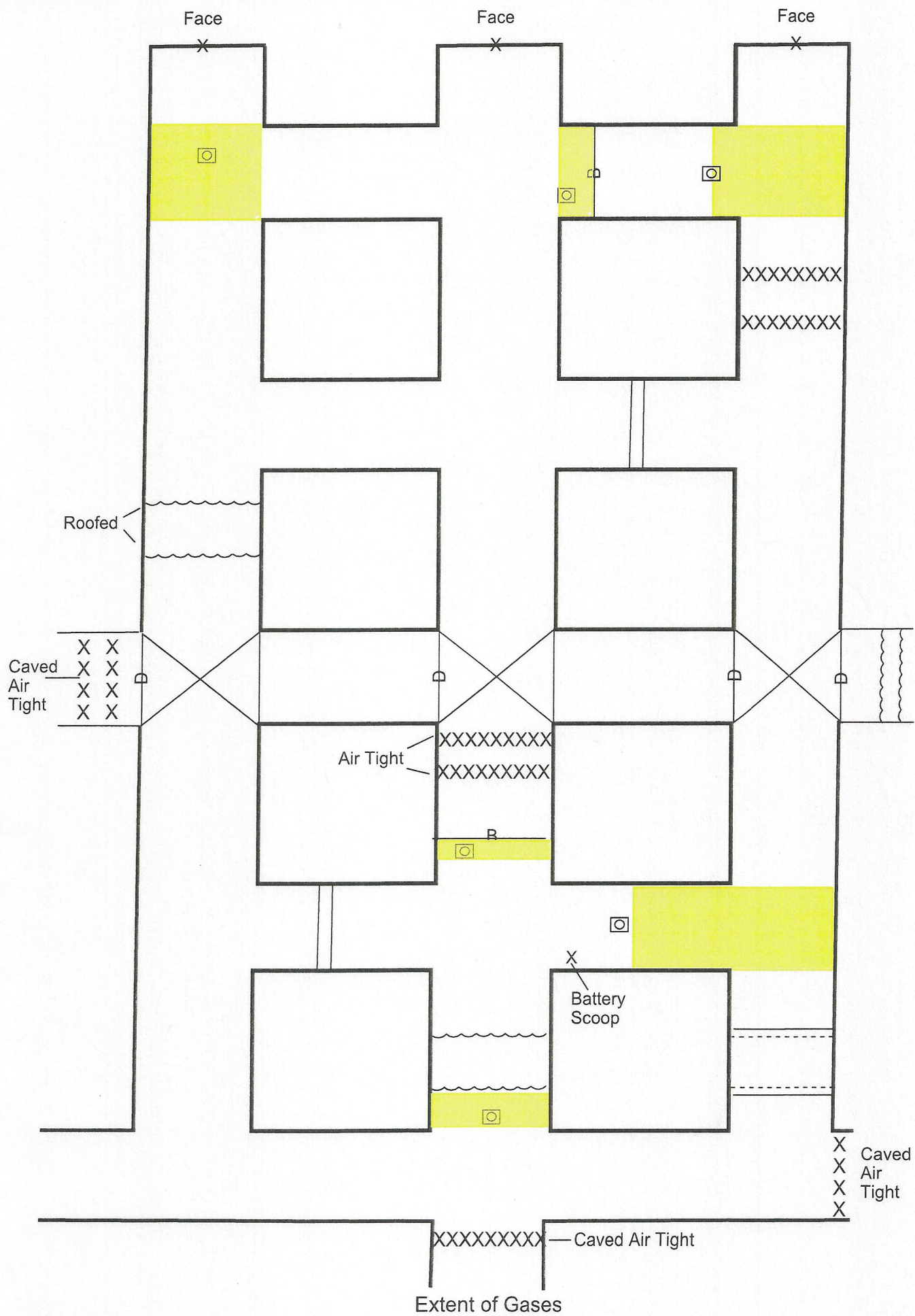

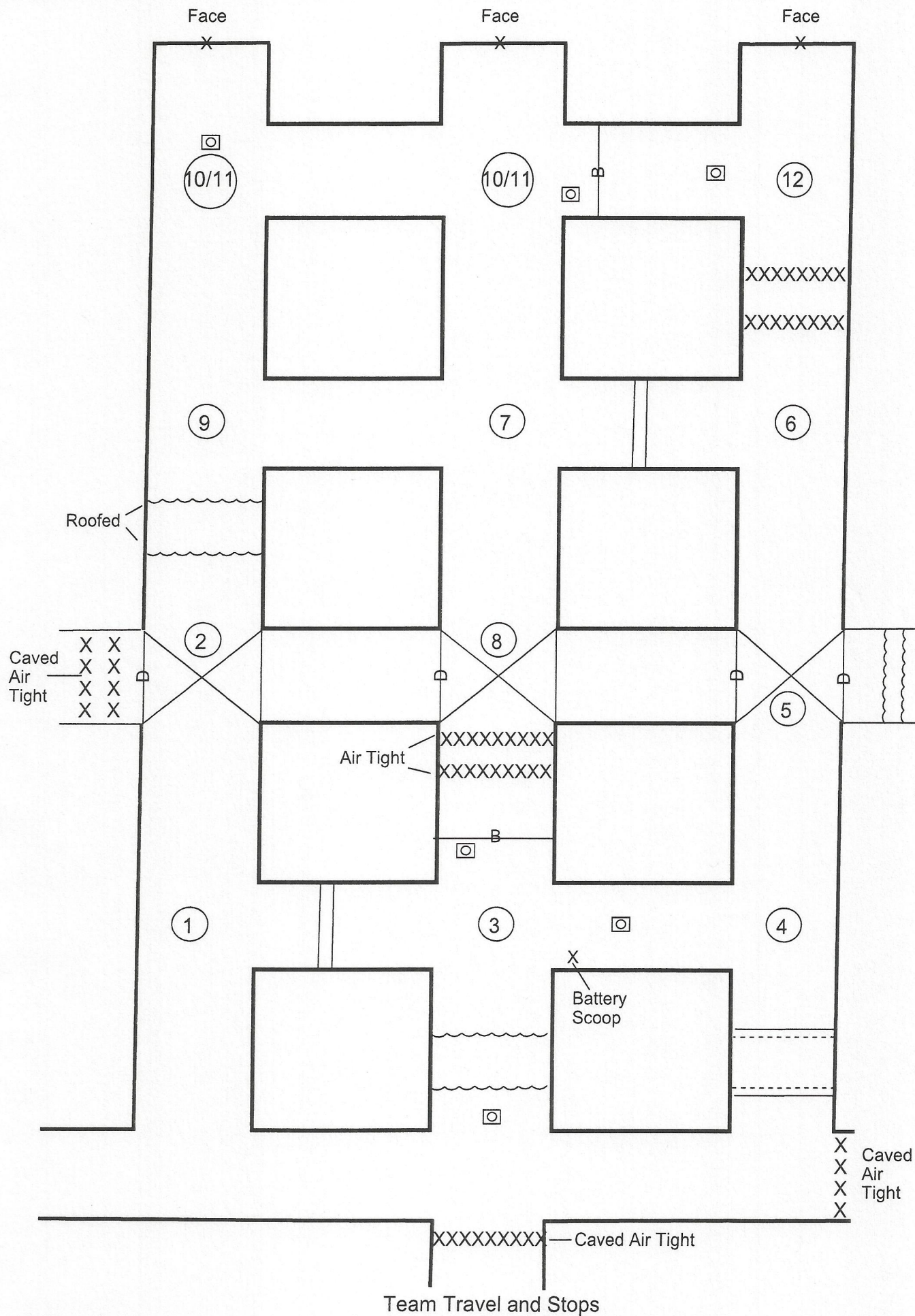

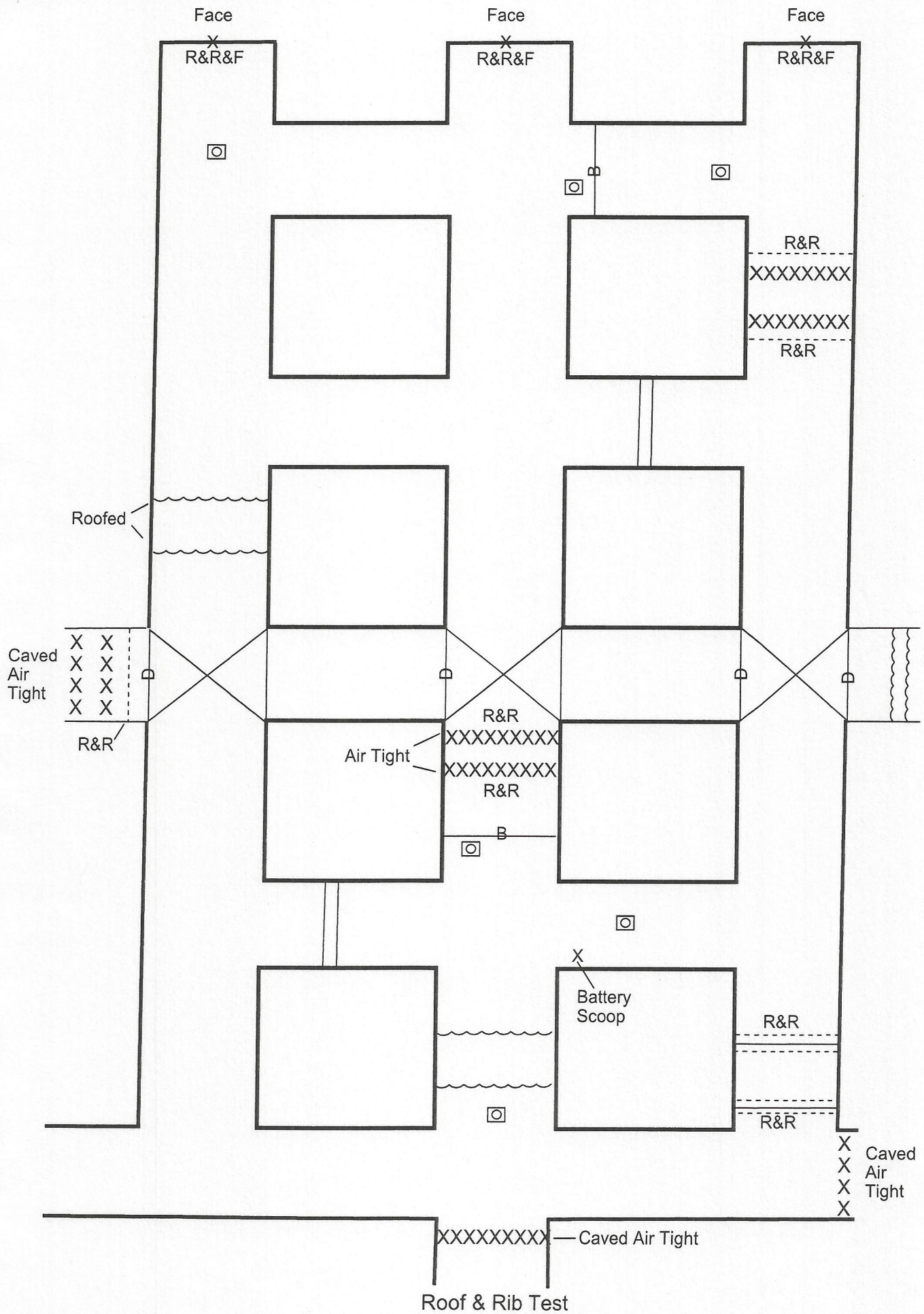

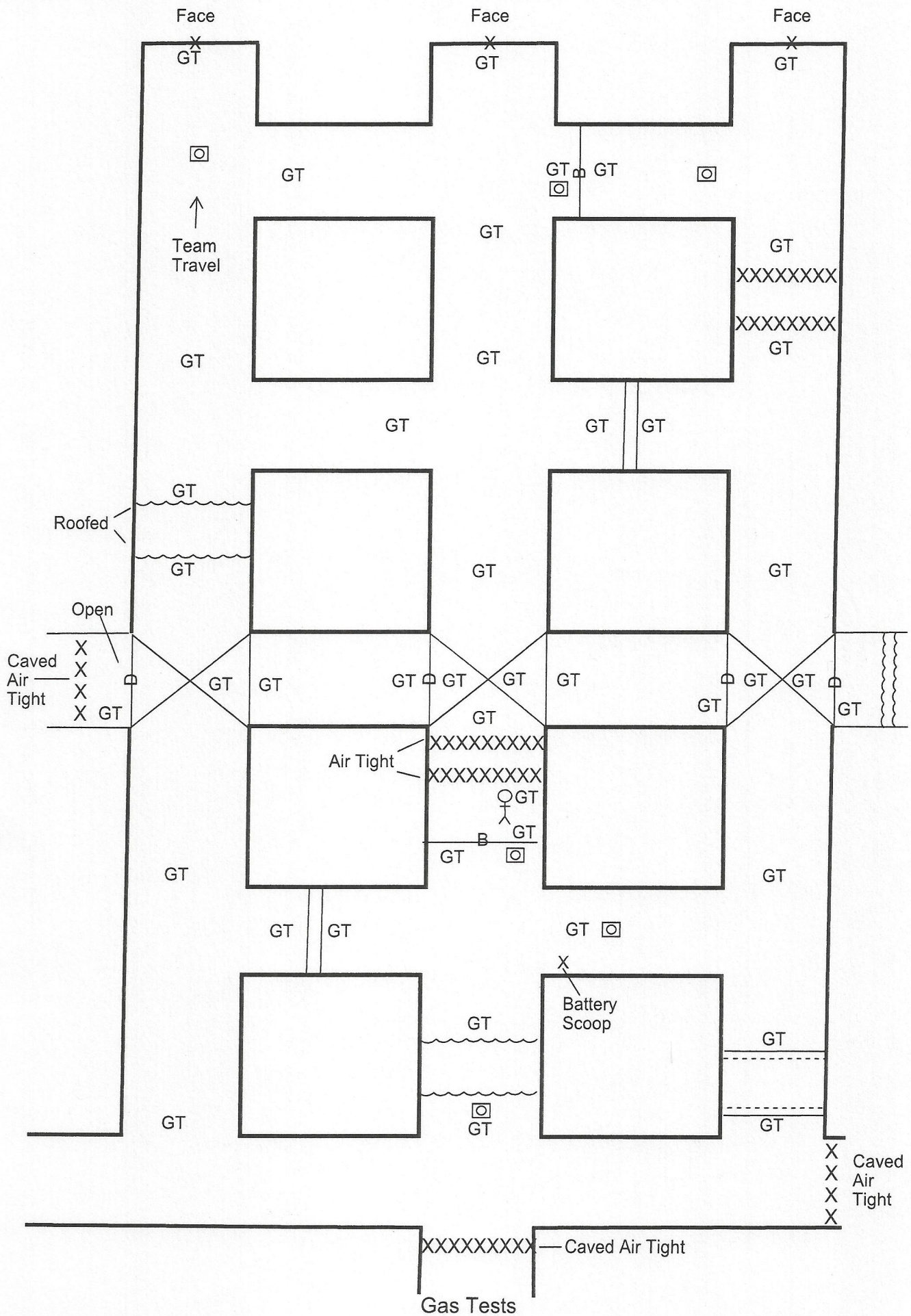

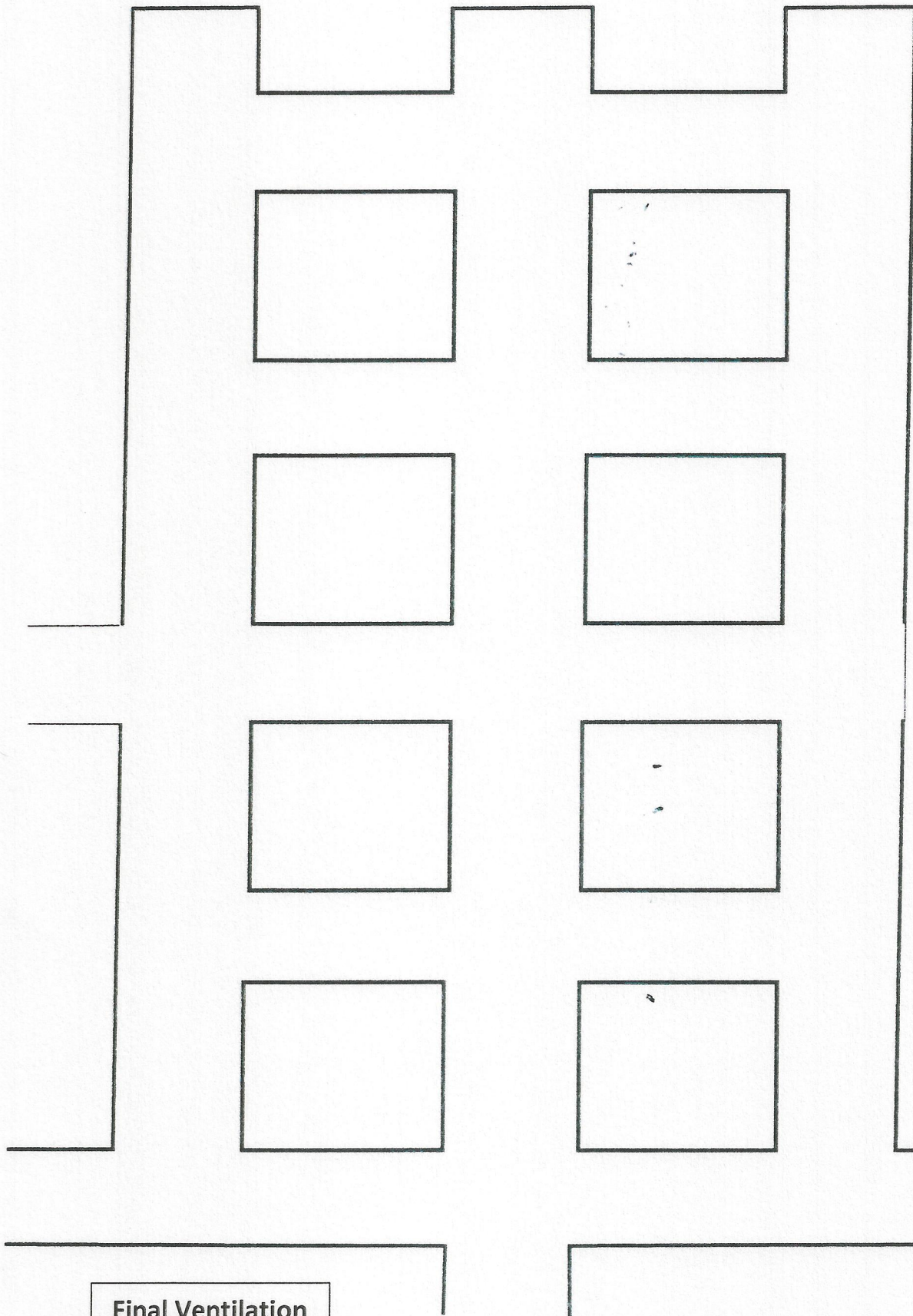

**Final Ventilation
Map**

Post 1 – 2014

Statement

Thanks for answering our call for help to the Red Devil #1 mine. We are mining a five entry Davy Mains and a three entry A-Panel section off the mains. Last Tuesday we completed overcasts which were installed across A-Panel to provide much needed additional intake air on the mains. This is a single split entry until after it crosses A-Panel and is ventilated by a newly installed #2 blowing fan. The #1 fan was damaged during the incident and is off. Last night a six person crew went to the mains and a four person crew to A-Panel, at 3.a.m. the mains crew felt a sudden rush of air and notice dust suspended in the air. The six man crew returned to the surface and are accounted for. We have not heard from the four miners on A-Panel. Previous mine rescue teams have explored all areas up to the mouth of A-Panel and found all areas safe to ventilate through. They also explored the single split from the #2 fan up to where it crossed A-Panel but were blocked by water. A roof fall blocked passage on the inby side of A-Panel where the air normally exits. Both areas are indicated on the maps provided. Mine Maps were updated 2 shifts ago. All power has been locked out and guarded. Back up teams are also present. GOOD LUCK!!

PROBLEM

*EXPLORE THE ENTIRE AREA OF A-PANEL THAT CAN BE DONE SAFELY

*ACCOUNT FOR ALL MISSING MINERS AND BRING SURVIVORS TO THE FRESH AIR BASE

*THE #2 BLOWING FAN CANNOT BE TURNED OFF, REVERSED OR STALLED

PATIENT BEHIND BARRICADE
IN #2 ENTRY

Help get me out it is airtight
behind me

PATIENT BEHIND OVERCAST WALL
WITH DOOR (OFF OF #3 ENTRY)

Help get me out!!!