

**Smoking and
the Use of All
Tobacco
Products are
Prohibited on
the Soccer
Field**

**POST 5
MINE
RESCUE
CONTEST
DAY 2**



**AUGUST 14, 2013
Mylan Park
MORGANTOWN, WEST VIRGINIA**

2013 Post 5 Mine Rescue Contest

Day 2

Statement

Welcome to the Ace-In-The-Hole Mine, and thank you for responding to our emergency. This mine is currently only a one section mine developed off a two-compartment shaft and a belt slope. We had a three man maintenance crew go in to the mine this weekend to work on the continuous miner on the 1 West Section. When I came to the mine a little while ago, the outside man said he had just heard a loud boom and saw the explosion doors open then close again. We tried to contact the miners on the 1 West Section with no success. We immediately contacted State and Federal authorities and Mine Rescue Teams. A mine rescue team began exploring the 1 West Section but only made it to the 5th break when one of their members became sick and the team returned to the surface. The team reported that there was ventilation to the 5th break with the air coming in the No. 3 entry, short-circuiting through the crosscut and returning out the No. 1 entry. We will establish a Fresh Air Base at that location, and you will begin your exploration of the 1 West Section at that point.

The fan is operating, cannot be stopped, stalled or reversed. The briefing officer's designated area is located in the fresh air base. The briefing officer's area becomes a self-contained, airtight chamber when the door is closed. To accomplish this, attach the curtain on the briefing officer's blind on both sides.

The mine is walking height, and we have encountered adverse roof conditions, water and methane. All electrical circuits have been de-energized, locked and tagged out inby the fresh air base.

You will have a maximum of 80 minutes to work the problem. Mine maps (up-to-date as of the end of the last production shift) and the written problem will be given to you when you arrive at the Fresh Air Base and are ready to begin.

Good Luck

2013 Post 5 Mine Rescue Contest
Day 2
Problem
(Written Instructions)

**EXPLORE ALL AREAS OF THE MINE THAT
CAN BE SAFELY EXPLORED**

**ACCOUNT FOR ALL MISSING MINERS
AND BRING SURVIVORS TO THE FRESH
AIR BASE**

**THE TEAM MAY NOT CARRY MORE
THAN TWO (2) BRATTICE CLOTHS AT
ANY ONE TIME**

**YOU HAVE A MAXIMUM OF 80
MINUTES TO WORK THE PROBLEM**

2013 Post 5 Mine Rescue Contest

Problem Map - Day 2

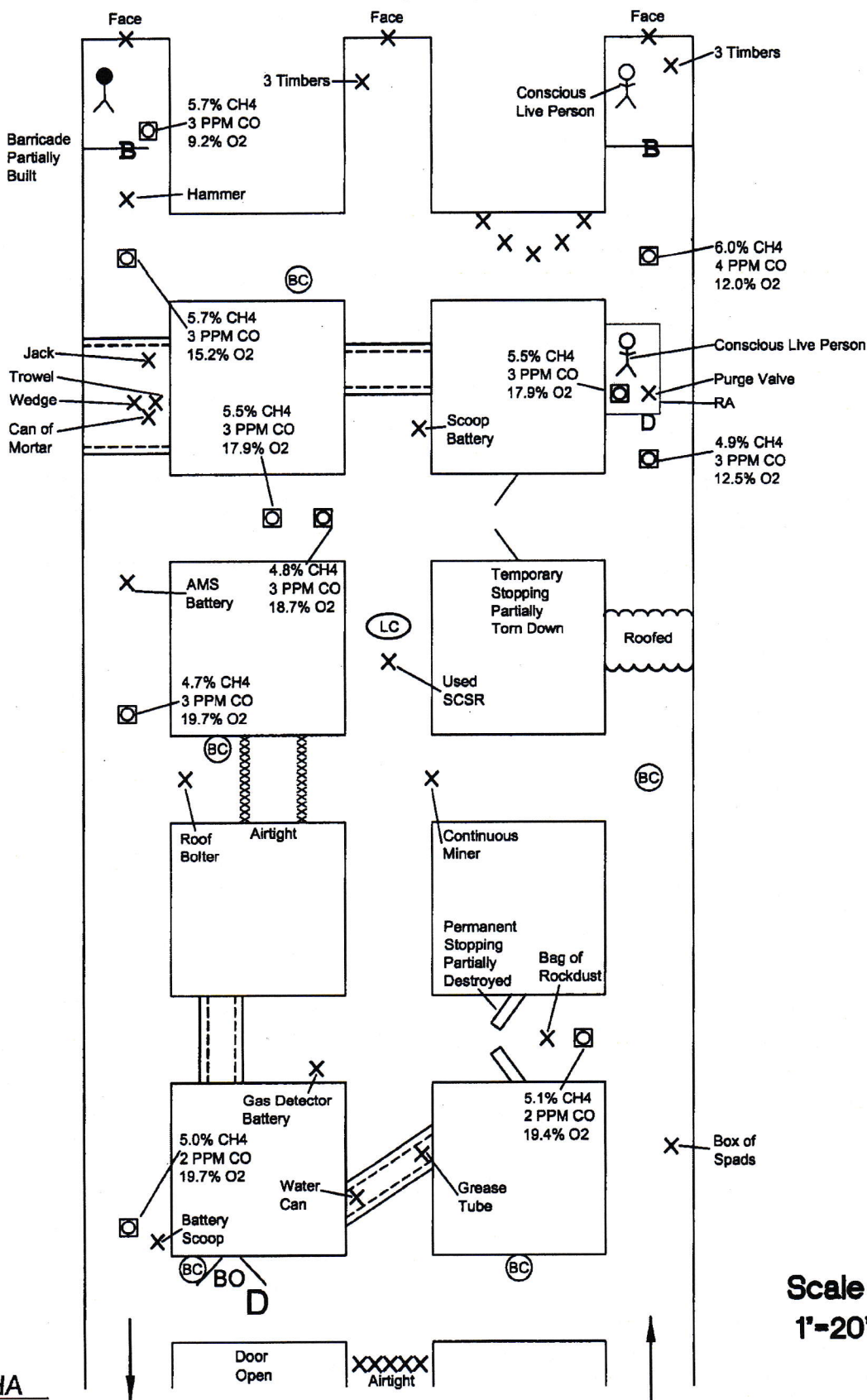

2013 Post 5 Mine Rescue Contest

Possible Team Stops - Day 2

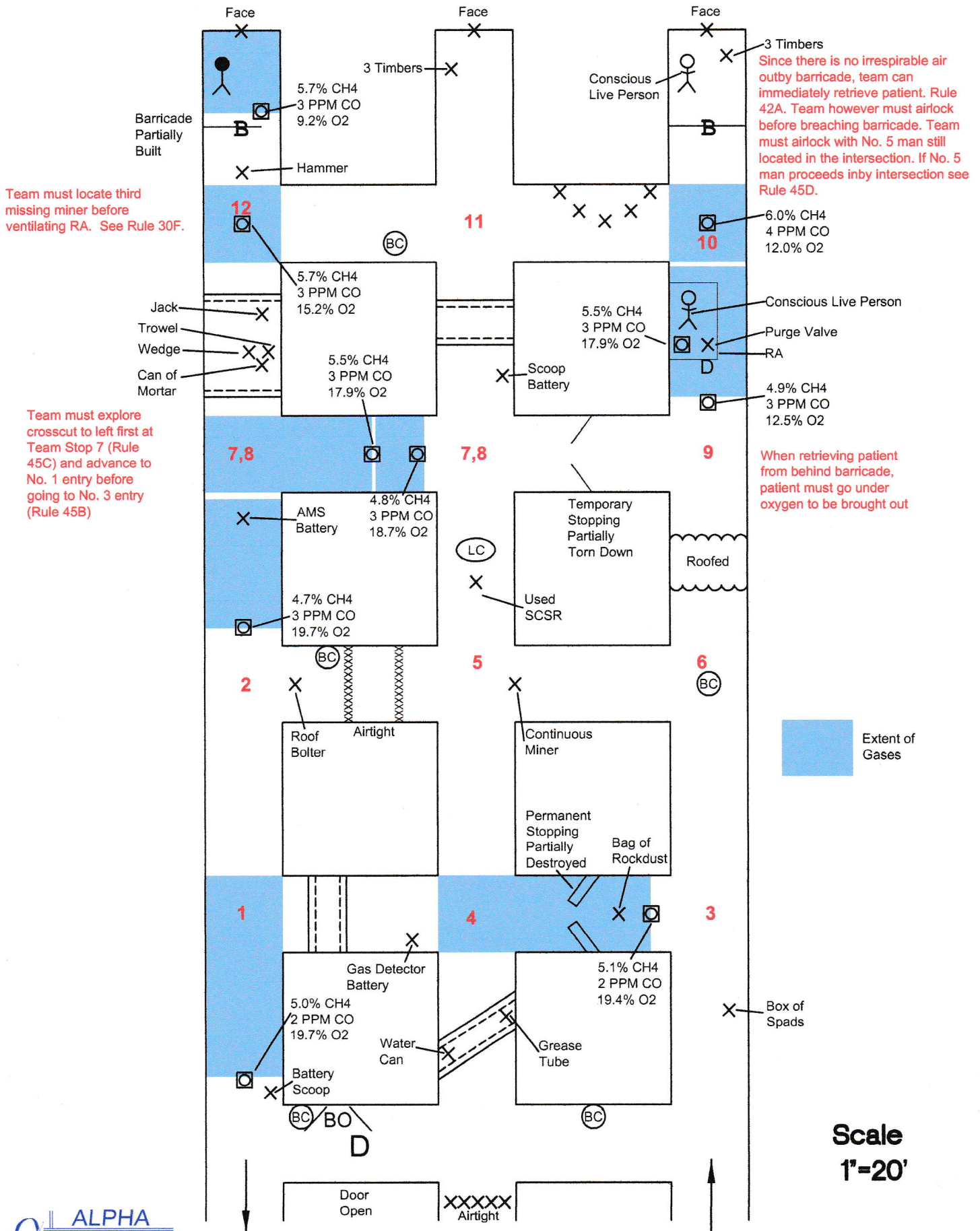

2013 Post 5 Mine Rescue Contest

07/26/2013

R&R Roof & Rib Test

GT CH4-O2-CO Test

D&I Date & Initials - Day 2

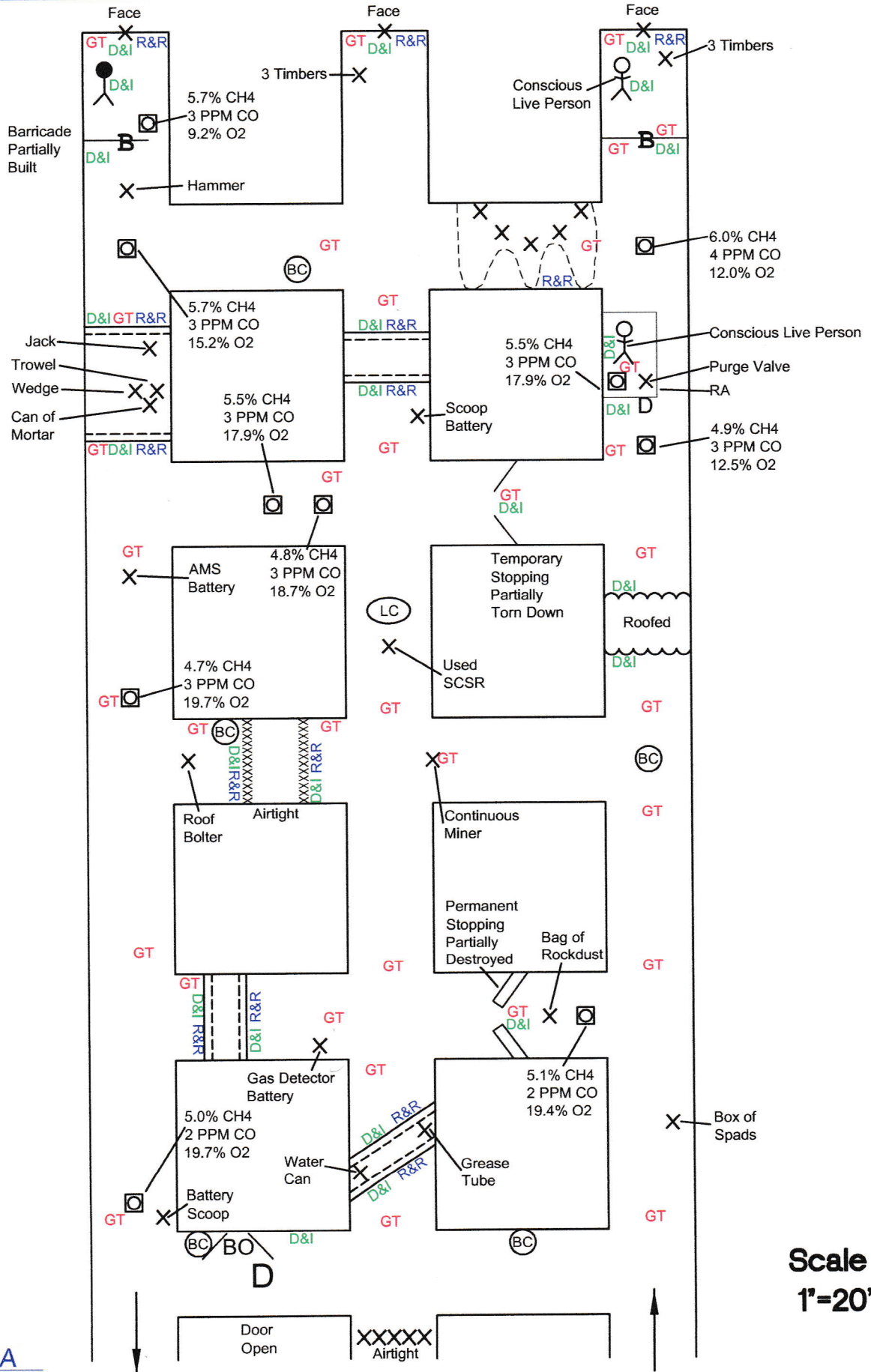

Scale
1"=20'

2013 Post 5 Mine Rescue Contest

07/26/2013

First Ventilation - Day 2

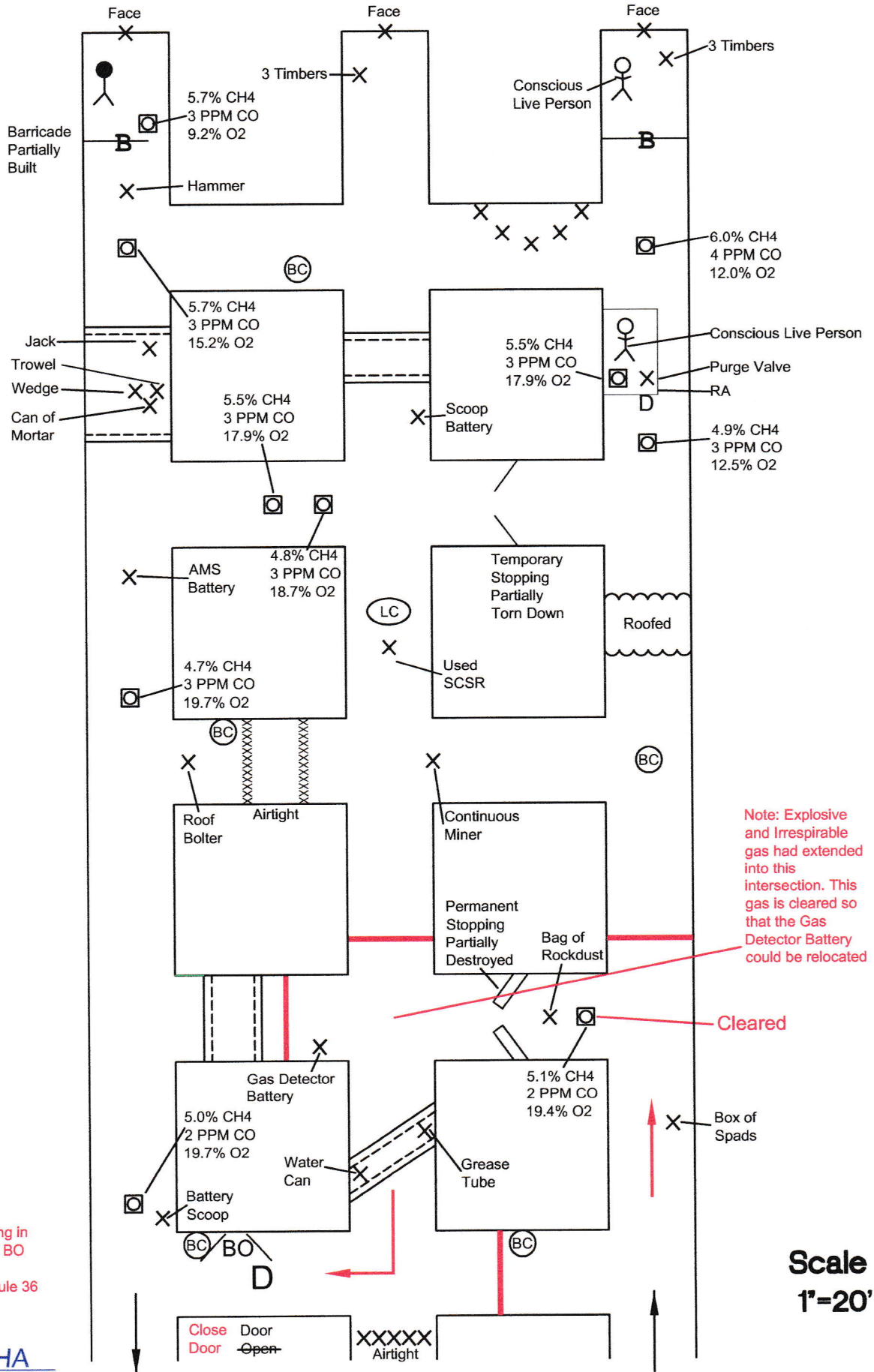

Team must build temporary stopping in Fresh Air Base. If BO builds stopping discount under Rule 36

Note: Explosive and Irrespirable gas had extended into this intersection. This gas is cleared so that the Gas Detector Battery could be relocated

Cleared

Scale
1"=20'

2013 Post 5 Mine Rescue Contest

Second Ventilation - Day 2

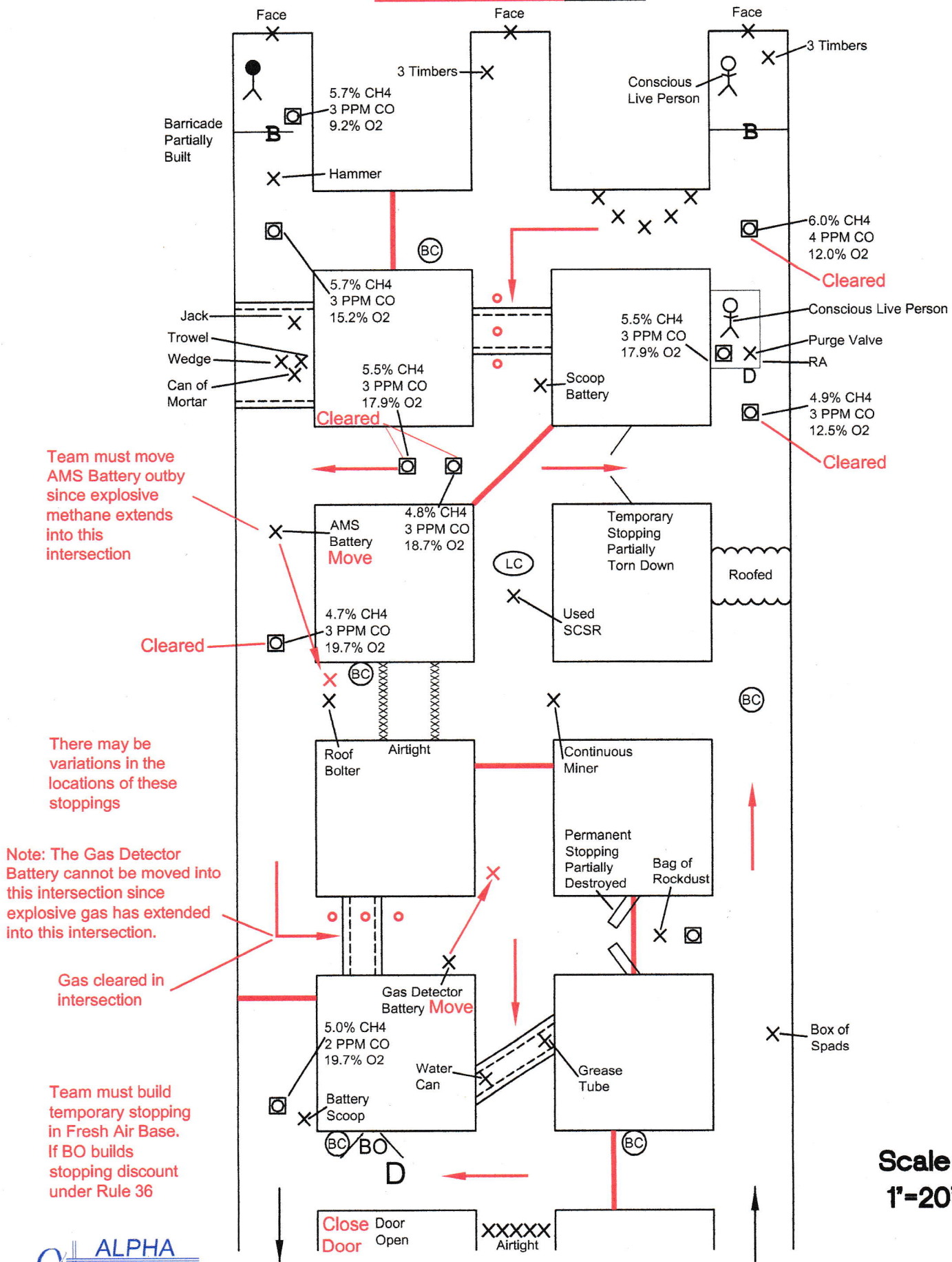

Scale
1"=20'

Day 2

Patient in RA

Statement

**Help, get me out of this
sardine can. Did you find my
other buddies yet?**

Day 2

Patient behind Barricade

**Help get me out. There is a
face behind me.**

2013 Post 5 Mine Rescue Contest

Final Ventilation Map - Day 2

Team
No. _____

Field
No. _____

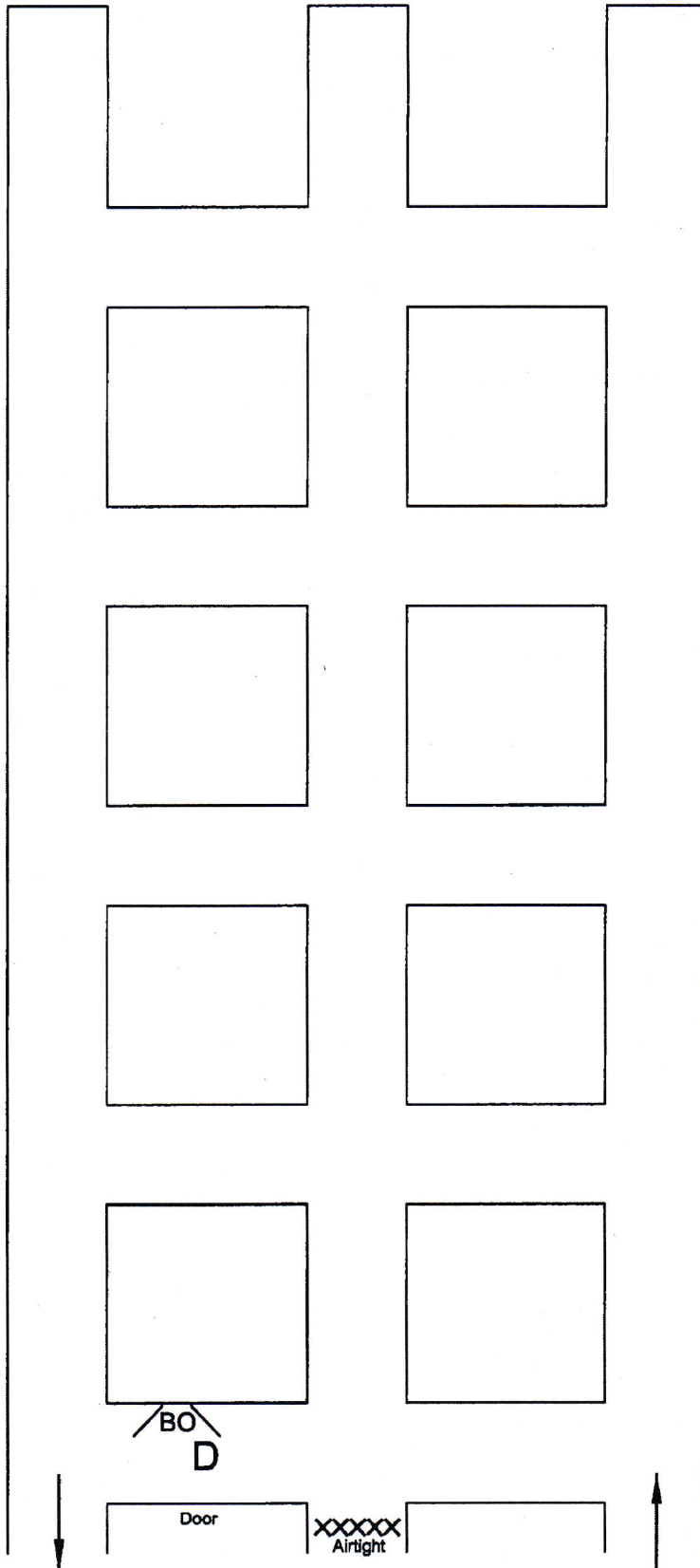

Show
Ventilation
Structures left
intact when
clock was
stopped

Captain's
Initials

Scale
1"=20'

Brattice Cloth Found in Problem

- ❖ Brattice Cloth attached on both sides of an entry or crosscut will represent: Intact permanent or temporary stoppings, or stoppings with door closed. The placard will specifically identify the structure.
- ❖ Brattice Cloth attached only on one side of entry or crosscut will represent: Permanent or temporary stoppings not intact, damaged or partially destroyed, or stoppings with doors open. The placard will specifically identify the structure.
- ❖ A brattice cloth lying across an entry or crosscut with neither end attached will represent a completely destroyed permanent or temporary stopping. The material may be used to build a temporary stopping. The placard will specifically identify the structure.
- ❖ Each Brattice Cloth is provided with a date board. ALL D&I's REQUIRED BY THE RULES FOR STOPPINGS, OVERCASTS, ETC. SHALL BE LOCATED ON THE DATE BOARDS.
- ❖ Barricades and overcasts may be constructed using the typical brattice frames and brattice cloths or new short brattice cloths. Overcasts and barricades cannot be dismantled.
- ❖ A team may only carry two Brattice Cloths at any one time.

Conditions such as caved areas, unsafe roof areas, bodies of water, will extend rib to rib, perpendicular to team travel unless otherwise indicated by ribbon.