

**2013**

**NMRA**

**POST 11 MINE**

**RESCUE**

**CONTEST**

**MAY 3, 2013**

## **NMRA POST 11 CONTEST**

### **MAY 3, 2013**

Hoop & Holler #1 Mine thanks you for answering our call for help. You are presently on the surface of this mine. We had a five man crew and a foreman who went in at midnight to do some routine repair work before beginning to run coal. According to the scales they mined a little over 500 tons. This is a new highwall operation that just started production. We currently have one section but have hopes to soon add another. This is a long term mine, mining some reserves that we have saved for a long time. The maps we have for your team were updated yesterday, but does not show anything mined on 3<sup>rd</sup> shift. We have been unable to contact anyone since arriving this morning when we found the explosion door open. The fan is located around the corner in the pit and has been examined on the surface side. It will not be necessary for your team to examine the surface side of the fan. The fan is currently off but can be operated in either the blowing or exhausting mode by utilizing the switch. Since starting here we have had bad roof conditions and methane liberation has been very erratic. We have a trained mine rescue team here to serve as your back up. We have a lifeline man here to assist you if you need him. This is all the information I have at the present time, but if more information becomes available, your team will be contacted.

Good Luck!

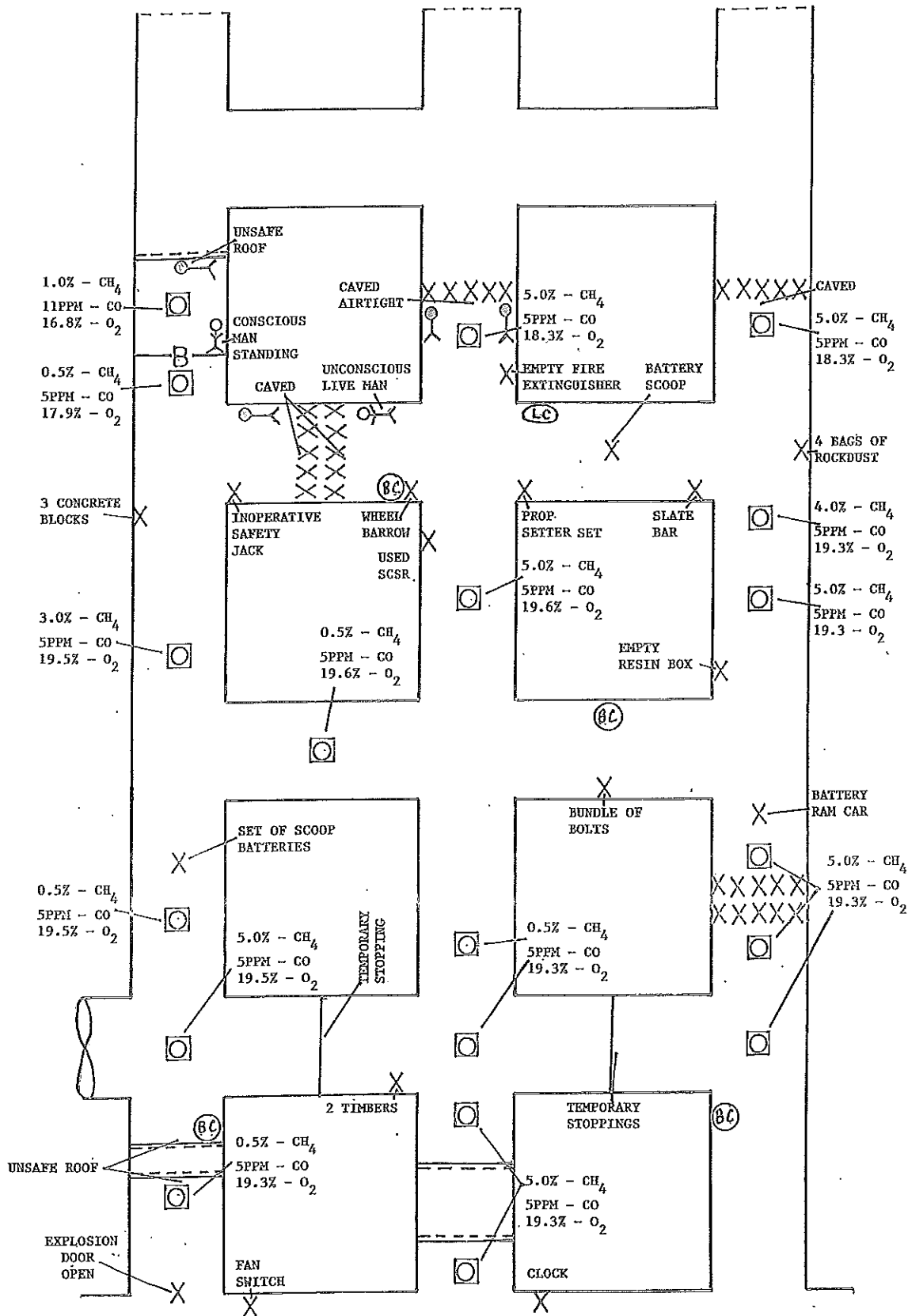

NATIONAL MINE RESCUE ASSOCIATION  
POST 11 MINE RESCUE CONTEST  
MAY 3, 2013  
JUDGES BRIEFING

When the team enters the Fresh Air Base, the Supt. will introduce himself to the team captain and Briefing Office. The team will have 4 minutes to arrange their equipment, lay out life line Etc.. If the team captain does not start the clock within that four minutes the Supt. will start the clock. The team does not have to unload and test stretchers. They must however check their gas detectors after the clock has started as well as their communications between the team and the B.O. Teams must go over standard lifeline signals with the lifeline judge unless wireless communications are used.

**WORKING PROCEDURES:**

The team is located on the surface. The captain should make the portals prior to the entire team going underground. He will find the explosion door open in the #1 entry. The team has been told in the statement that the fan has been made on the surface and they will not have to make the surface side of the fan. The captain will find unsafe roof across the entry and a contaminate (Low Oxygen). He must make a roof and rib test and D&I at the unsafe roof. He must make a gas test in the opening. In #2 entry he will find unsafe roof across the entry. He will make a gas test and find an explosive and irrespirable mixture. He will date and initial at the unsafe roof and must make a roof and rib test and D&I. In #3 entry he may travel to the out by corner of the intersection. He must make a gas test somewhere in the opening. Since #1 and #2 entries are blocked the team must advance in #3 entry to **TEAM STOP #1**. At team stop #1 an apparatus check must be made at the first team stop with all team members underground. The team will find 5.0% CH<sub>4</sub>, 5ppm CO and 19.3% O<sub>2</sub> in the intersection. The captain will examine the left xcut over to the temporary stopping, making a gas check and dating and initialing the stopping. He will also make up the straight and find a caved area that requires a roof and rib test and a D&I. He will also find an explosive and irrespirable mixture there. The team must use the brattice cloth found there to build and go thru the temporary stopping to **TEAM STOP #2**. The captain will find .5% CH<sub>4</sub> 5ppm CO and 19.3% O<sub>2</sub> in the intersection. Outby He will find the inby side of the unsafe roof and will make a roof and rib test and D&I. He will discover 5.0% CH<sub>4</sub>, 5ppm CO and 19.3% O<sub>2</sub> extending back into the unsafe roof. Up the straight the team will find an extension of the gases found in the intersection and must make a gas test in the area. To the left the team will find a temporary stopping in the xcut between #1 and #2. A gas test must be made in the opening and the stopping must be D&I. The team may build to examine over to **TEAM**

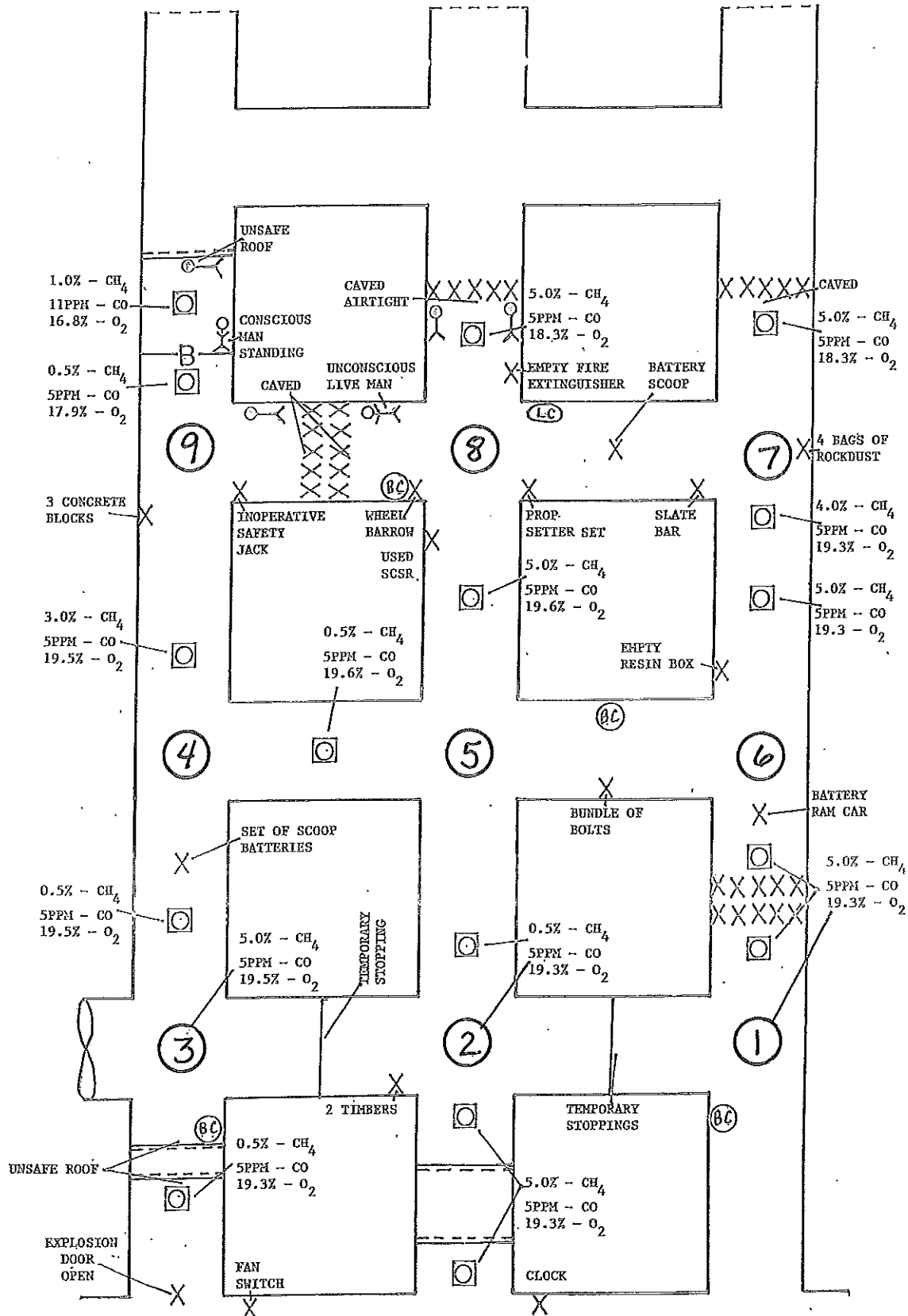

**STOP #3.** Here the captain will explore to the fan where a gas test and D&I must be made. He will find an explosive but respirable mixture in the intersection and will examine outby to tie unsafe roof making a roof and rib test, D&I and a gas test. Up the straight the team will find a non-explosive mixture and a set of scoop batteries. A gas test must be made in the opening before advancing to **TEAM STOP #4.** Here the team may examine all the way to the outby corner of the next xcut making a gas test somewhere in the opening and will make the xcut to the right making a gas test in that opening before advancing to **TEAM STOP #5.** Here the team explores up the straight and finds an explosive but respirable mixture and must make a gas test in the area. The team will explore to the right making a gas test in the opening before advancing to **TEAM STOP #6.** The team will explore back to the caved area, make a gas test and a roof and rib test and D&I at the caved area. Notice the explosive mixture extends into the caved area. Up the straight the team will find an explosive and irrespirable mixture changing to a non-explosive, irrespirable mixture inby. A gas test must be made in the opening before the team advances to **TEAM STOP #7.** Here the team will find a caved area inby with an explosive, irrespirable mixture going into the caved area. A roof and rib and D&I must be made at the caved area and a gas test must be made in the opening. To the left the team will make a gas test in the opening before advancing to **TEAM STOP #8.** The captain will examine inby and find the caved airtight and the two bodies that he must touch and D&I. He must make a roof and rib test and D&I at the caved airtight and a gas test must be made in the area. To the left the captain will find an unconscious man that must be assessed and D&I. While the team readies the patient (must have respiratory protection with a full facepiece) the captain can make the caved area doing a roof and rib test, D&I and a gas test in the area. The unconscious man must be removed to the surface to avoid delay. When the team returns they will travel to **TEAM STOP #9,** Here the captain will examine to the right finding a body that must be touched and D&I and the caved area where a roof and rib test and D&I is required. A gas test must be made in the opening. Up the straight the team will find a barricade with an irrespirable mixture in front of it. A gas test must be made and the captain will D&I the barricade. A conscious live man will respond to the captain's presence and tell the team to get him out. He will give no other info. At this point the team can ventilate to remove the conscious live man. (See Vent Maps) It will take 3 steps to ventilate the barricade. Once ventilated the captain will breach the barricade, immediately making a gas test, he must D&I and touch the conscious man. The captain will find the gas placard with 11ppm CO (Indication of Fire) and since there was an explosive mixture going into the caved area in #3 entry there is not a known separation. The team should FPA at the gas placard leaving the body and the unsafe roof area not found. Upon exiting the mine, the problem is complete and the team will stop the clock.

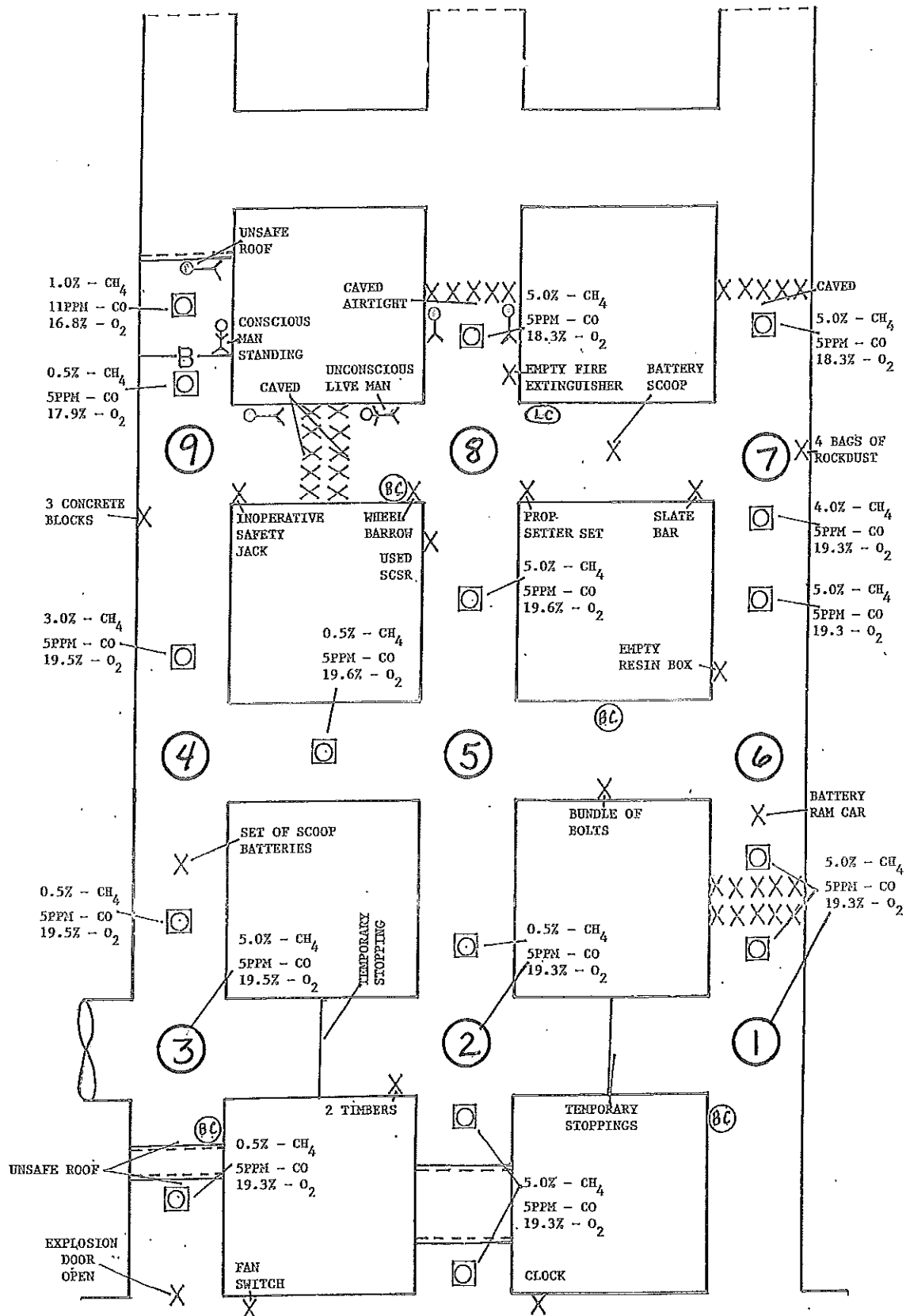

# 1ST VENTILATION

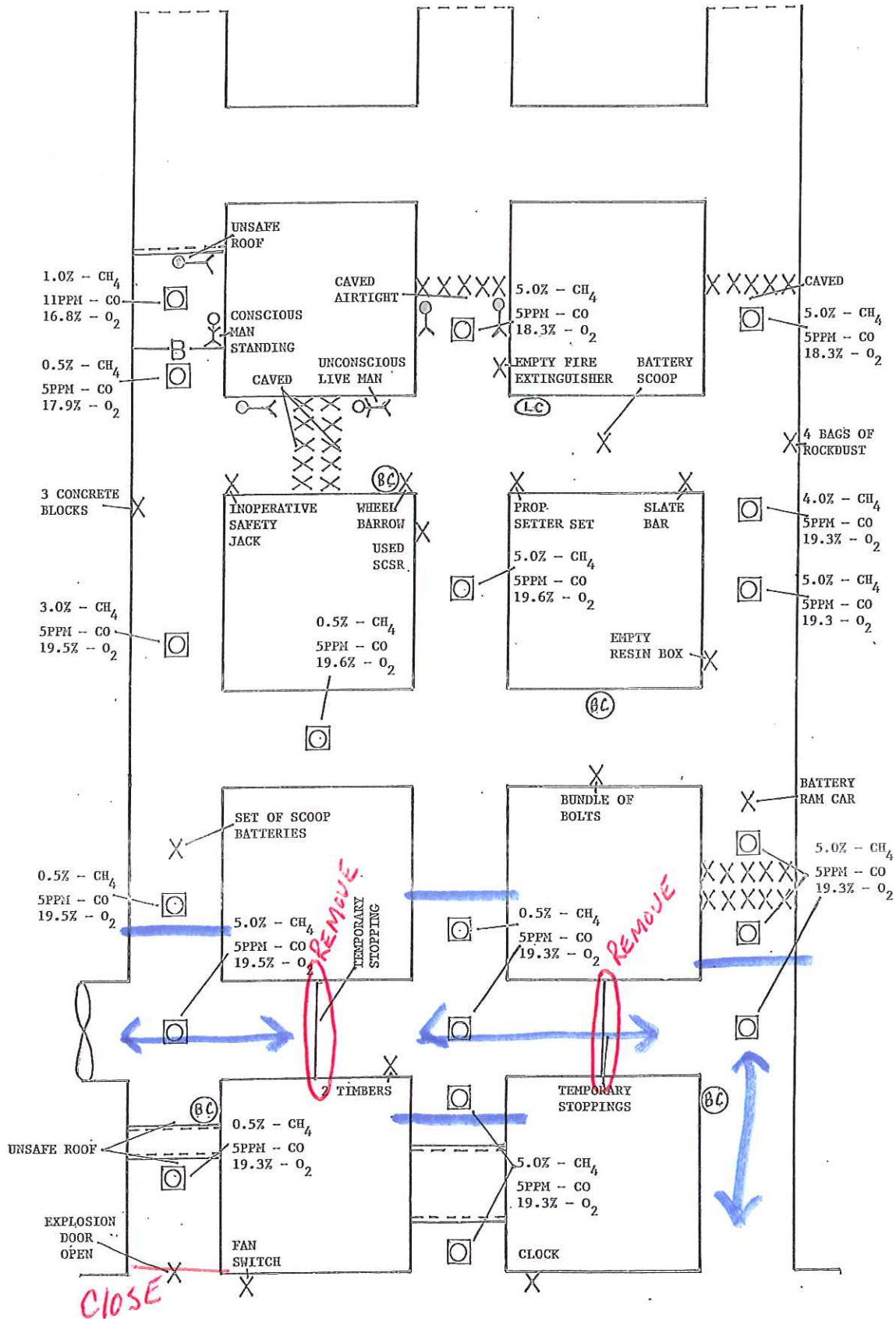



# 2<sup>ND</sup> VENTILATION

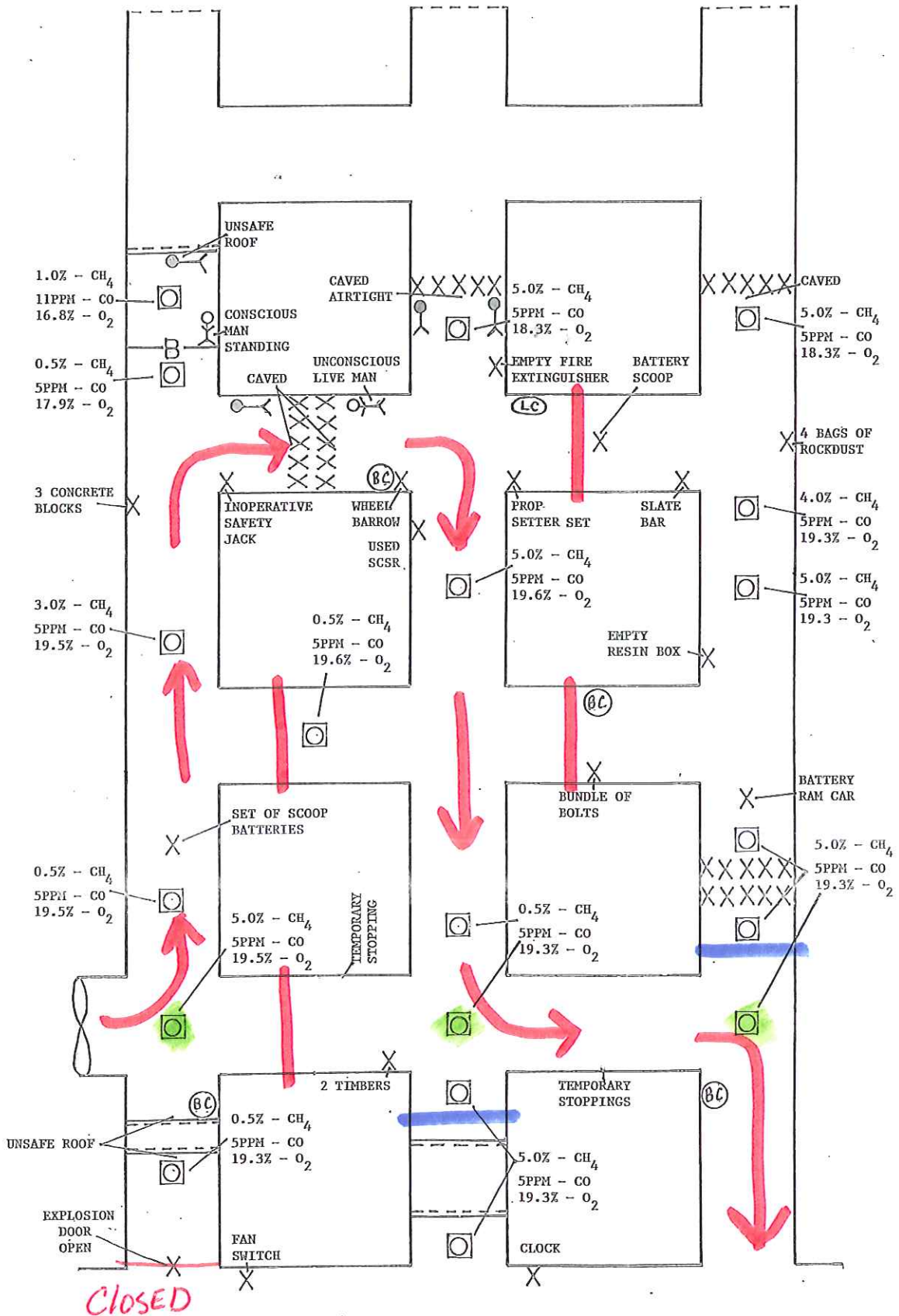

# 3<sup>RD</sup> VENTILATION

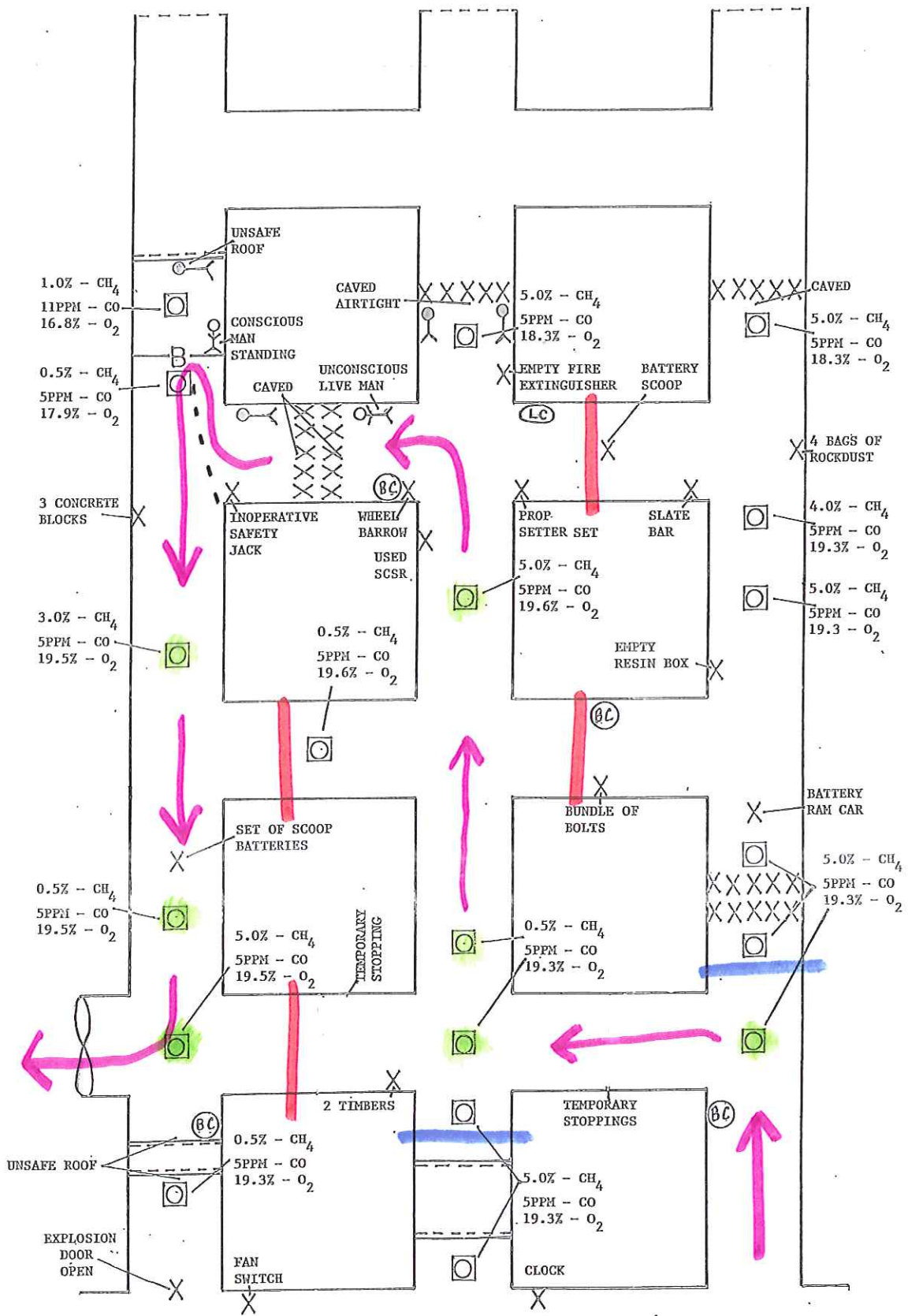

ONMRA POST 11  
MAY 3, 2013

## WRITTEN INSTRUCTIONS

IF IT CAN BE DONE SAFELY:

- EXPLORE THE ENTIRE MINE
- ACCOUNT FOR ALL MISSING MINERS.
- BRING ALL SURVIVORS TO THE FRESH AIR BASE

PLEASE NOTE:

- TO OPEN OR CLOSE DOORS YOU MUST TURN THE PLACARD OVER TO THE APPROPRIATE SIDE.
- TEAM BUILT AIRTIGHT STRUCTURES MUST BE PROPERLY HOOKED ON BOTH SIDES.
- THE BRIEFING OFFICER'S ISOLATION AREA WILL REMAIN AIRTIGHT WHILE THE BRIEFING OFFICER IS INSIDE.

NMRA

POST 11

CONSCIOUS LIVE MAN STATEMENT

HELP!! DO YOU THINK YOU COULD GET  
ME OUT OF HERE - TODAY MAYBE??