

**2013
OMSL
COMPLIANCE
CONTEST
DAY 1
APRIL 24, 2013**

OMSL COMPLIANCE CONTEST

APRIL 24, 2013

Day 1

The Jenny Wiley #1 Mine thanks you for answering our call for help. We had a four man crew and a foreman who went in at midnight to do routine idle shift work. They were supposed to clean and rock dust the section, check permissibility on the equipment and if they had time, run a little early coal before the day shift crew entered the mine. This is a new highwall operation that just started production last week. We currently have one section but have completed an overcast to get ready to add another. This is a short term mine, mining toward some old works to our North, but we have the maps from the old mine and should be several hundred feet away from them. The maps we have for your team were updated yesterday, but does not show anything mined on 2nd shift. We have been unable to contact anyone since arriving this morning. The mine foreman started to go in but found smoke just inby the 1st crosscut in #2entry. Since we started here, the mining has been hampered by Methane and bad roof. You are located on the surface of this highwall mine. The exhaust fan located in #1 entry is currently off but can be started if necessary by utilizing the switch on the surface, but once started it cannot be reversed, stalled or stopped. We have a trained mine rescue team here to serve as your back up. We have a lifeline man here to assist you if you need him. This is all the information I have at the present time.

Good Luck!

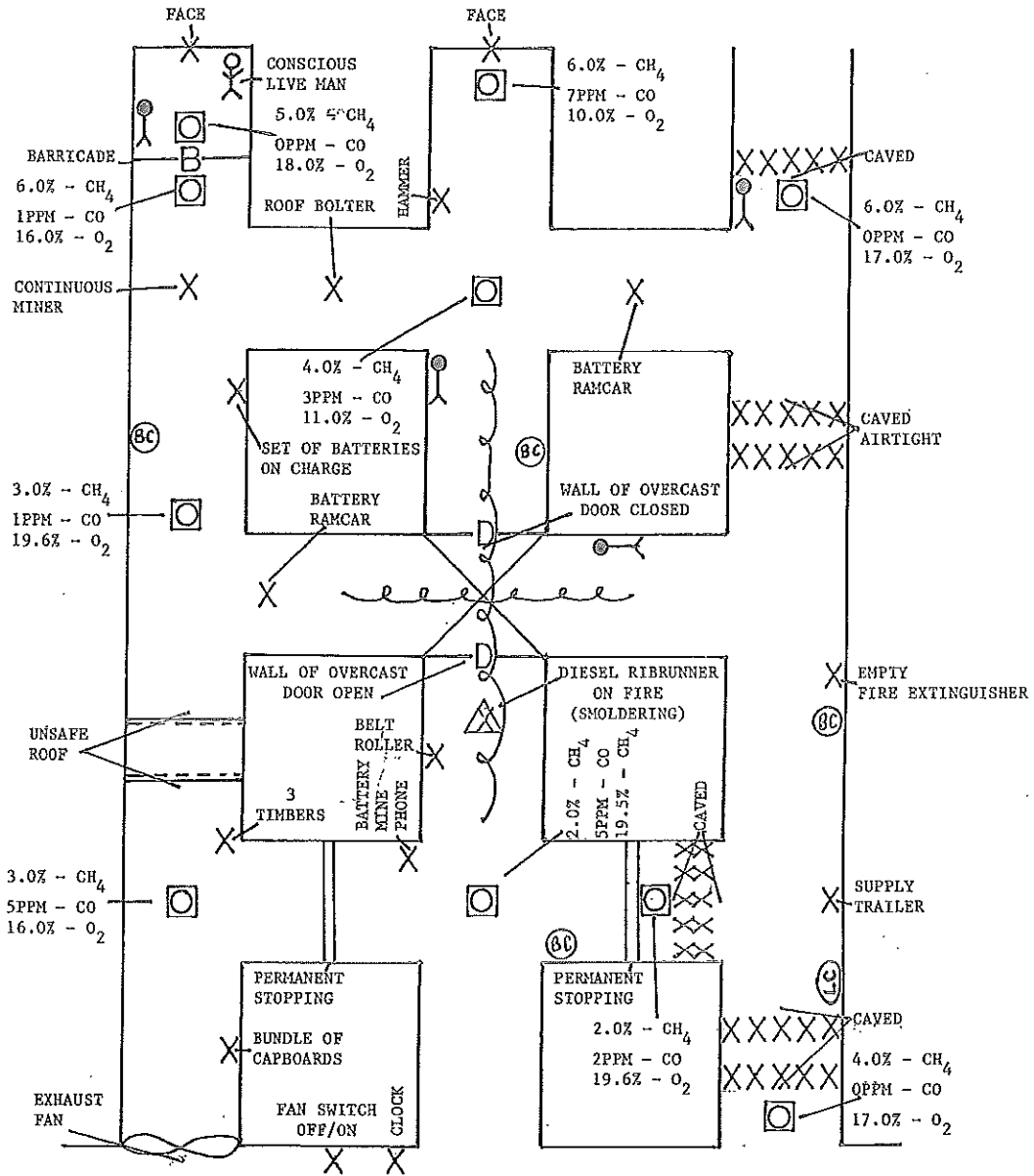

OMSL CONTEST
 DAY 1
 APRIL 24, 2013
 PRESTONBURG, KY

OMSL INTER-AGENCY MINE RESCUE CONTEST
PROBLEM # 1
APRIL 24, 2013
JUDGES BRIEFING

After the clock is started, all required equipment checks must be made in the presence of the judges. These checks includes: detectors, fire extinguishers, and stretchers. Communication must be established between the briefing officer and the team. The #5 man must go over standard lifeline signals with the lifeline judge unless wireless communications are used.

WORKING PROCEDURES:

The captain should make the portals prior to the entire team going underground. He will find the exhaust fan off in the #1 entry that blocks access into the mine. He will make a gas test and date and initial at the fan. In #2 entry he may travel to the out by corner of the intersection. He must make a gas test somewhere in the opening. In #3 entry he finds a caved area from rib to rib. He must make a gas test a roof and rib test and D&I the caved area. At this point the captain knows he must enter the mine traveling in NO. 2 entry. The team enters #2 entry to **TEAM STOP #1**. At team stop #1 an apparatus check must be made at the first team stop with all team members underground. The team will find 2% CH₄, 5ppm CO and 19.5% O₂ in the intersection. The captain will examine the left xcut over to the permanent stopping, making a gas check and dating and initialing the stopping. He will also make up the straight and find a diesel ribrunner on fire (smoldering) Entire team must be on lifeline or link line if #5 man remains in clear air. A roof test must be made at the fire area, the fire may be extinguished using a fire extinguisher to simulate putting out the fire. A gas test must be made and the captain may then explore to the wall of the overcast door open. The crosscut to the right must be explored to the permanent stopping, a gas test must be made and the stopping must be D&I. At this stop the team may choose to build and enter thru the stopping where they will find a caved area. A roof and rib test and a gas test will be required and The captain's D&I. The team could build and travel thru the stopping to the left at this time but will probably travel thru the door in the overcast to **TEAM STOP #2**. The captain will remain in smoke and will find the inby door in the overcast is closed and will find a body (must touch and D&I) in the crosscut to the right and the end of smoke. Exploring to the left he will find a battery ram car. Gas test will have to be made in each opening. Since

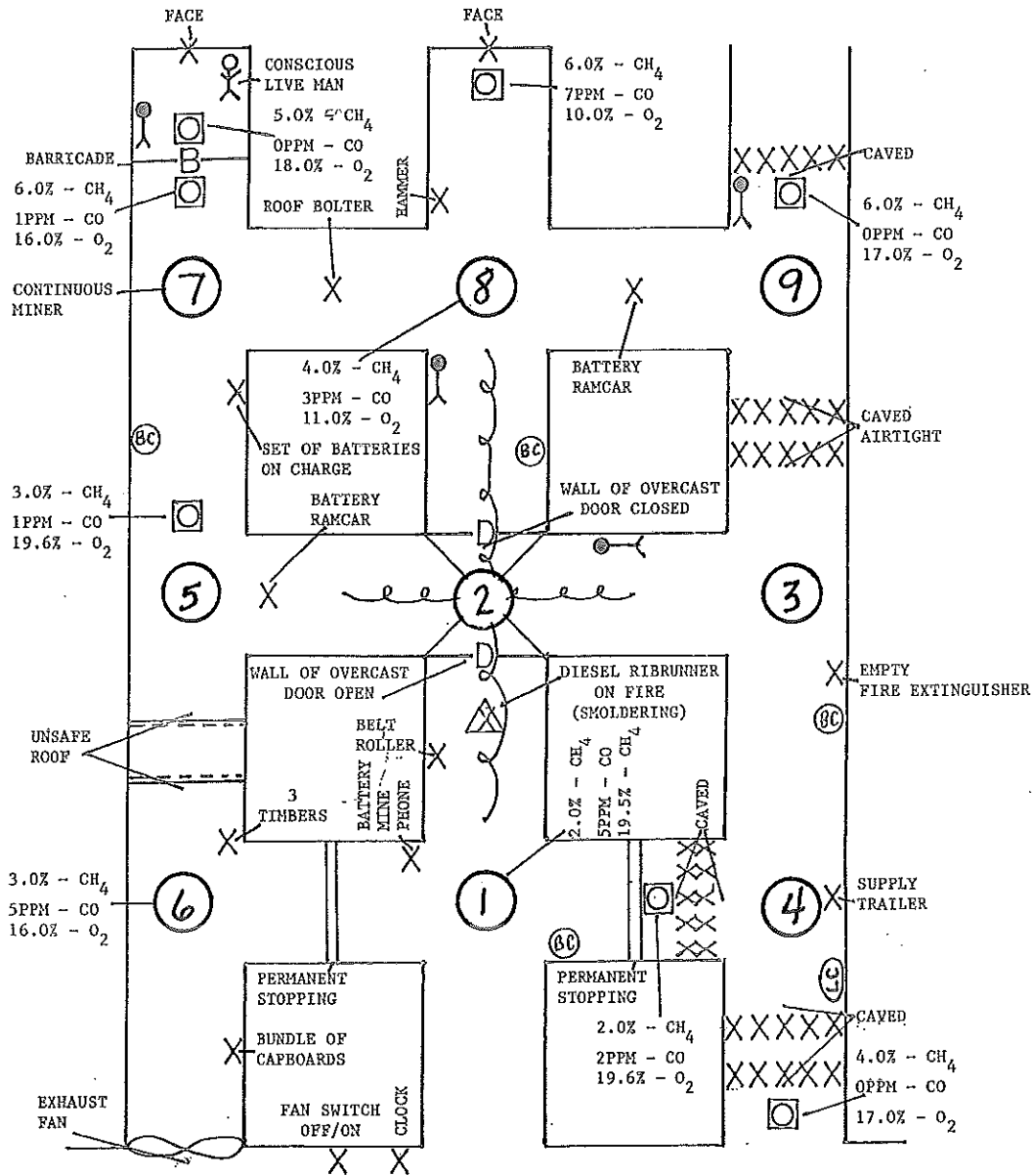

OMSL CONTEST
 DAY 1
 APRIL 24, 2013
 PRESTONBURG, KY

the team does not know the extent of the gas found outby the caved area in #3 entry they should advance to the #3 entry to **TEAM STOP #3.** Here the captain will explore to the caved airtight up the straight and make a roof and rib test, a gas test and D&I at the caved airtight. Exploring behind he will finds the area to be clear and a gas test must be made before advancing to **TEAM STOP #4.** Here the team will make the caved area in the crosscut and the caved area in the entry. Both caved areas will require roof and rib test, D&I and a gas test. If the team did not build and travel to # 1 entry from team stop #1 they will probably attempt to get to the area by traveling to **TEAM STOP #5.** Here the team explores back to the unsafe roof making a roof and rib test and D&I at the unsafe roof. The captain may explore upto the outby corner of the next crosscut where he will find a set of scoop batteries on charge. The #5 man cannot travel inby the corner of the 2nd crosscut(unless team has already explored the 1st crosscut completely. If they previously did not explore the area back to the fan, they must retreat to stop #1 to build and explore through the stopping to **TEAM STOP #6.** The team will explore to the unsafe roof, make a gas test and a roof and rib test and D&I at the unsafe roof. The team will explore back to the exhaust fan, D&I the fan, and make a gas test. The team found 3 timbers near the unsafe roof and may timber thru the unsafe roof at this time, but may save the timbers and travel back thru the door of the overcast and up to **TEAM STOP #7.** Here the team will find a barricade in the straight with an explosive mixture and an irrespirable mixture in front of it. The person behind the barricade will respond saying: Help get me out of here it is hard to breathe in here. A gas test must be made and the captain will D&I the barricade. Since the team cannot ventilate the barricade at this point they must proceed to **TEAM STOP #8.** The captain will examine the face of #2 entry do a roof, face and rib test, a gas test and D&I the face. The captain can explore the crosscut to the right to the corner and if he steps into the smoke in #2 entry team must be on line. At this oint the barricade can be ventilated. See Ventilation Map. Once the barricade is cleared the team must build an airlock to enter the barricade. The captain must immediately make a gas test once the barricade is breached. A body is located on the left rib and must be touched and D&I. The conscious man is found and must be assessed and D&I. Since he is found in an irrespirable atmosphere he must be provided with respiratory protection before bringing him to the surface. After bringing the conscious live man to the surface one person is still unaccounted for and the team must travel back in the mine to **TEAM STOP #9,** airlocking thru the team built stopping in the crosscut between #2 and #3 entry due to the fact the fan is now running and the map shows a dotted line

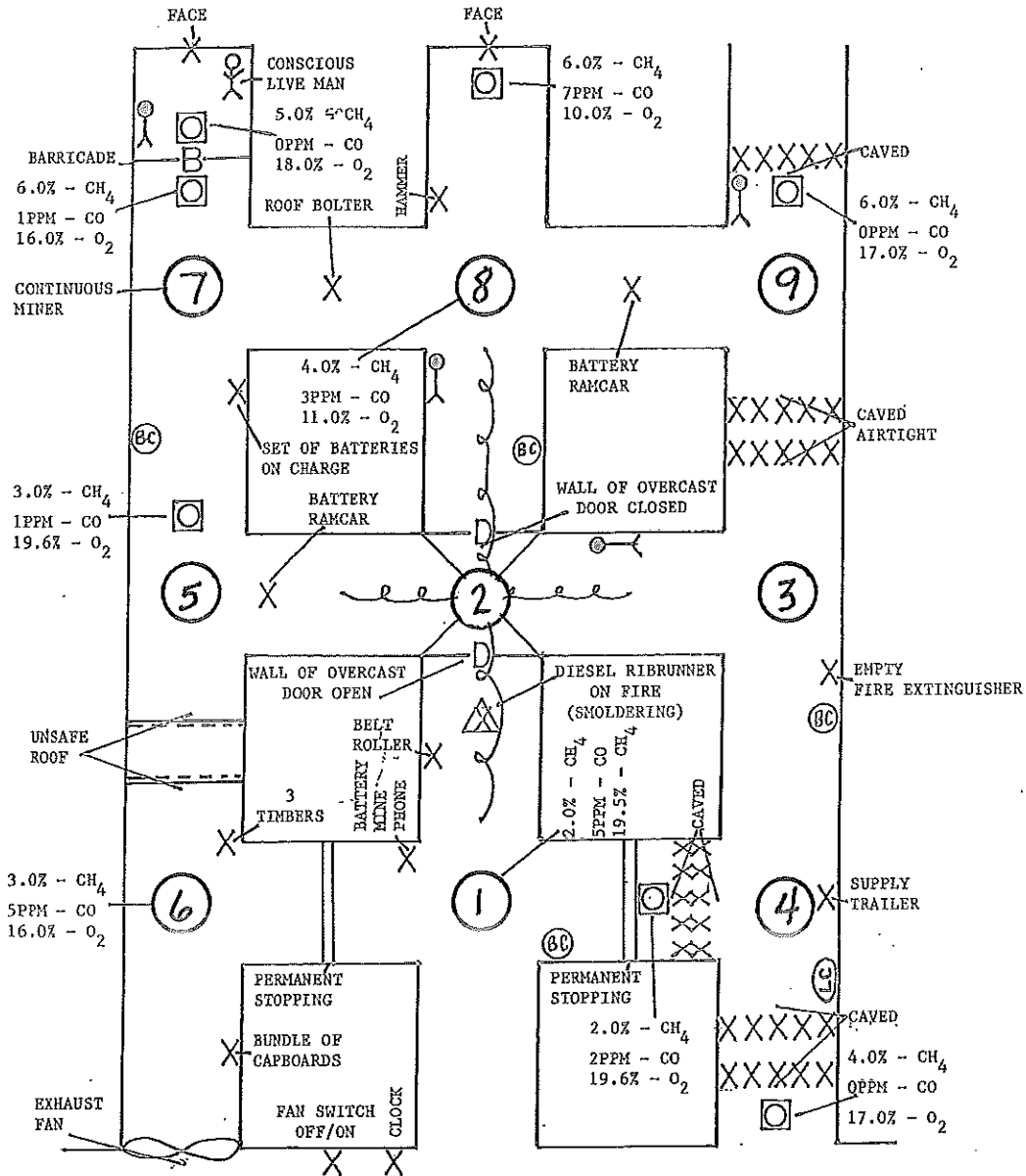

OMSL CONTEST
 DAY 1
 APRIL 24, 2013
 PRESTONBURG, KY

in the face of #3 which at this point is unexplored. The team will examine back to the caved airtight and make a roof and rib test a gas test and D&I. The captain will explore up the straight and find a body that he must touch and Dd&I. He will find a caved area across the entry and must make a roof and rib test and D&I and a gas test must be made in the opening. Since the condition of the face is unknown (and the fan is running) the team should rebuild the airlock as they exit the mine. Since all of the missing persons have been accounted and the team returns to the FAB the problem is completed the team will stop the clock. Maps must be turned in immediately upon stopping the clock.

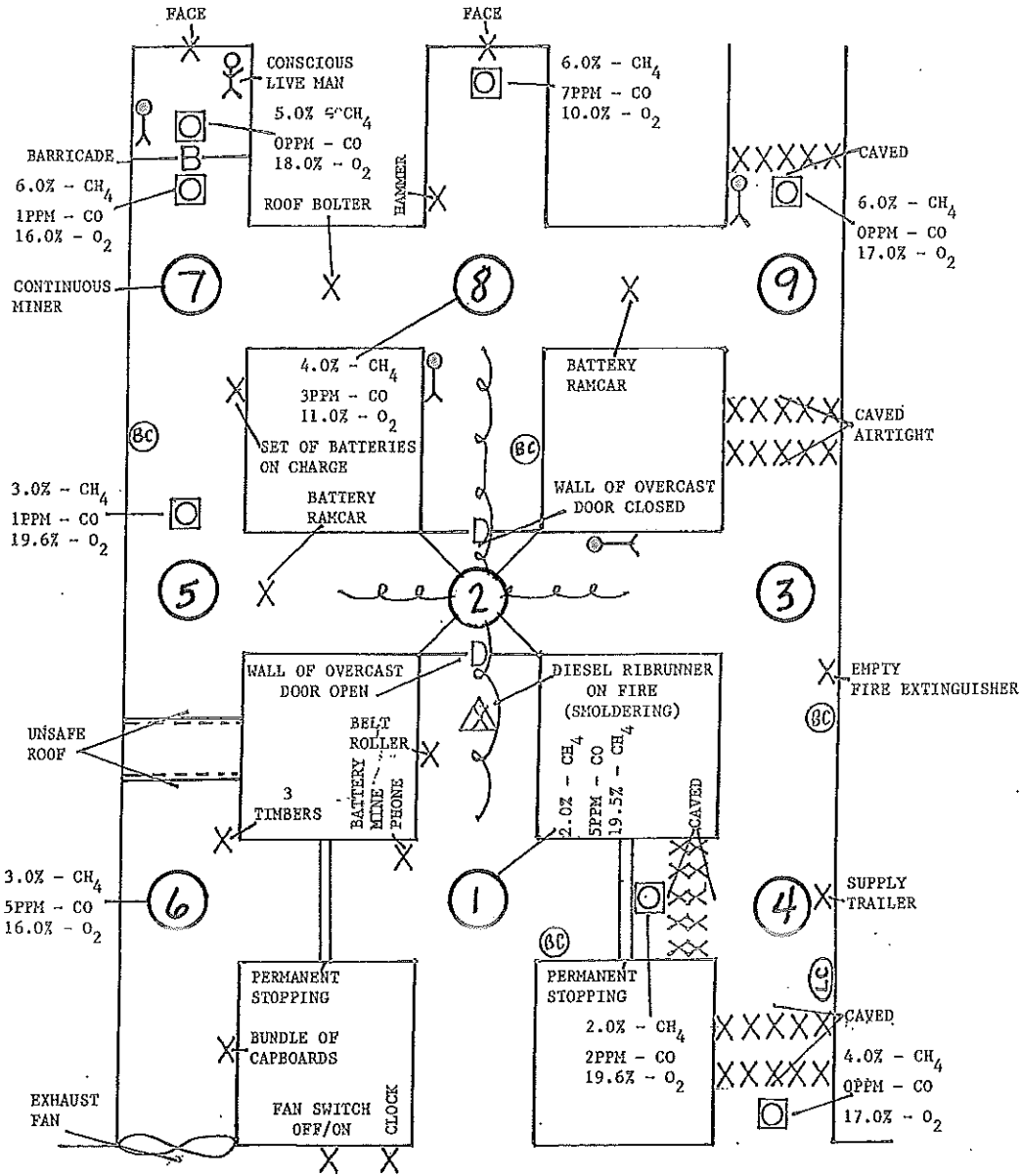

OMSL CONTEST
 DAY 1
 APRIL 24, 2013
 PRESTONBURG, KY

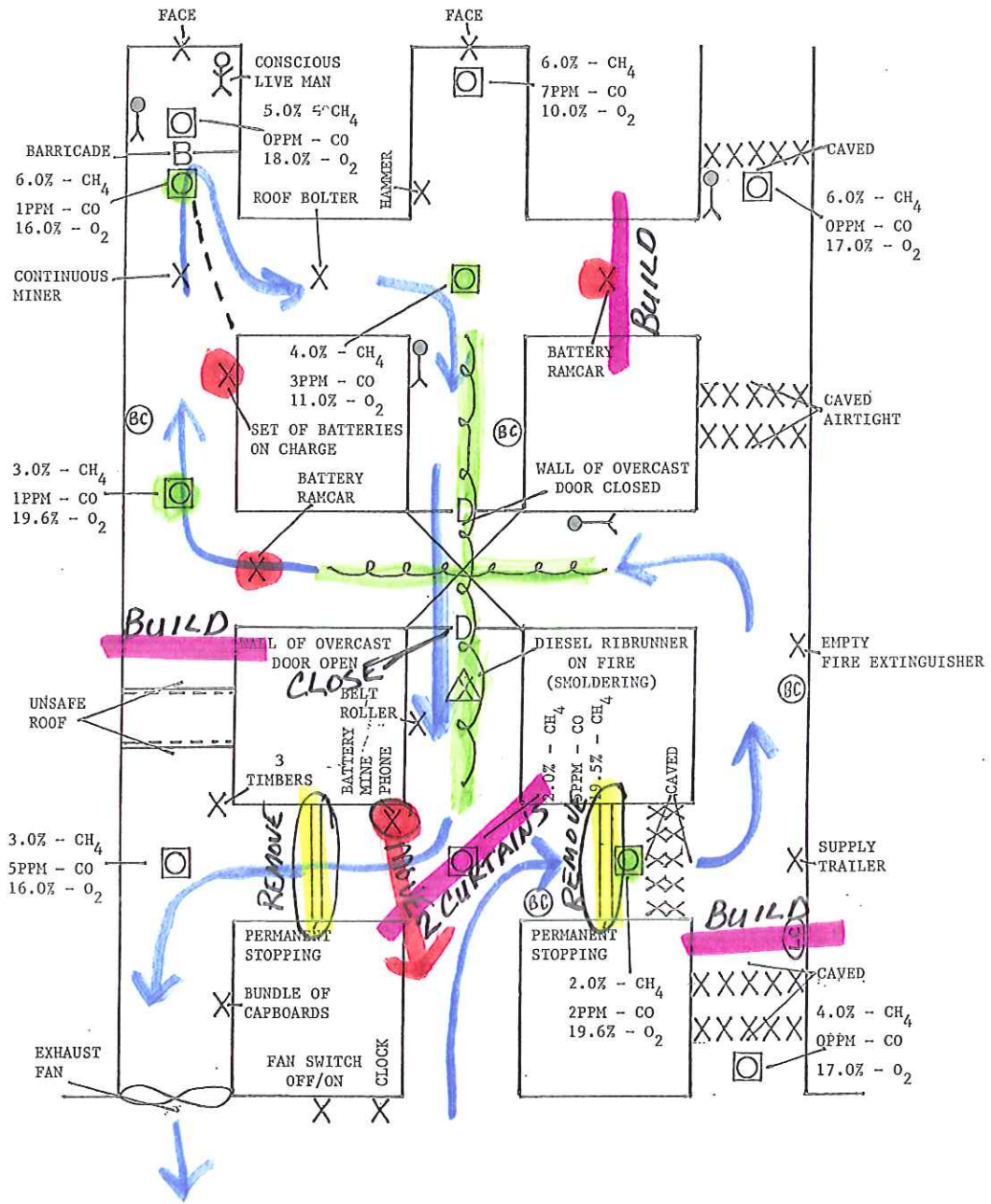

- IGNITION SOURCE
- BUILDS
- Cleared

OMSL CONTEST
 DAY 1
 APRIL 24, 2013
 PRESTONBURG, KY

CONSCIOUS LIVE MAN STATEMENT

(BEHIND BARRICADE IN #1 ENTRY)

HELP GET US OUT OF HERE!

HELP GET US OUT OF HERE!

IT IS HARD TO BREATHE IN HERE!

OMSL DAY 1 APRIL 24TH, 2013

WRITTEN INSTRUCTIONS

ACCOUNT FOR ALL MISSING MINERS.

BRING ALL SURVIVORS TO THE SURFACE.

TO OPEN OR CLOSE DOORS YOU MUST TURN THE
PLACARD OVER TO THE APPROPRIATE SIDE.

TEAM BUILT AIRTIGHT STRUCTURES MUST BE
PROPERLY HOOKED ON BOTH SIDES.

ONCE THE FAN IS STARTED IT CANNOT BE TURNED
OFF, REVERSED OR STALLED.

