

Hello my name is _____ Superintendant of the spanker branch # 2 mine
.Thanks for responding ~~To~~ our call. At 10:30 last night our seven man midnight crew
headed in they were approaching the number one section switch when they felt a sudden
movement of air then the power knocked .when they returned to the surface we tried to
contact the nine man evening shift crew we had no luck. About ten minutes later two
men staggered out of the intake entry .There is a blowing fan that can be started at your
request the fan cannot be reversed or stopped once it's started. We were mining near an
old abandoned mine they was supposed to drill before cutting the map was up to date
this morning .This mine has encountered bad conditions and does liberate methane and
water explore the entire mine if can be done safely bring our men back to us safe thanks
and god bless.

PROBLEM

Call out the names and locations of persons found to the command center.

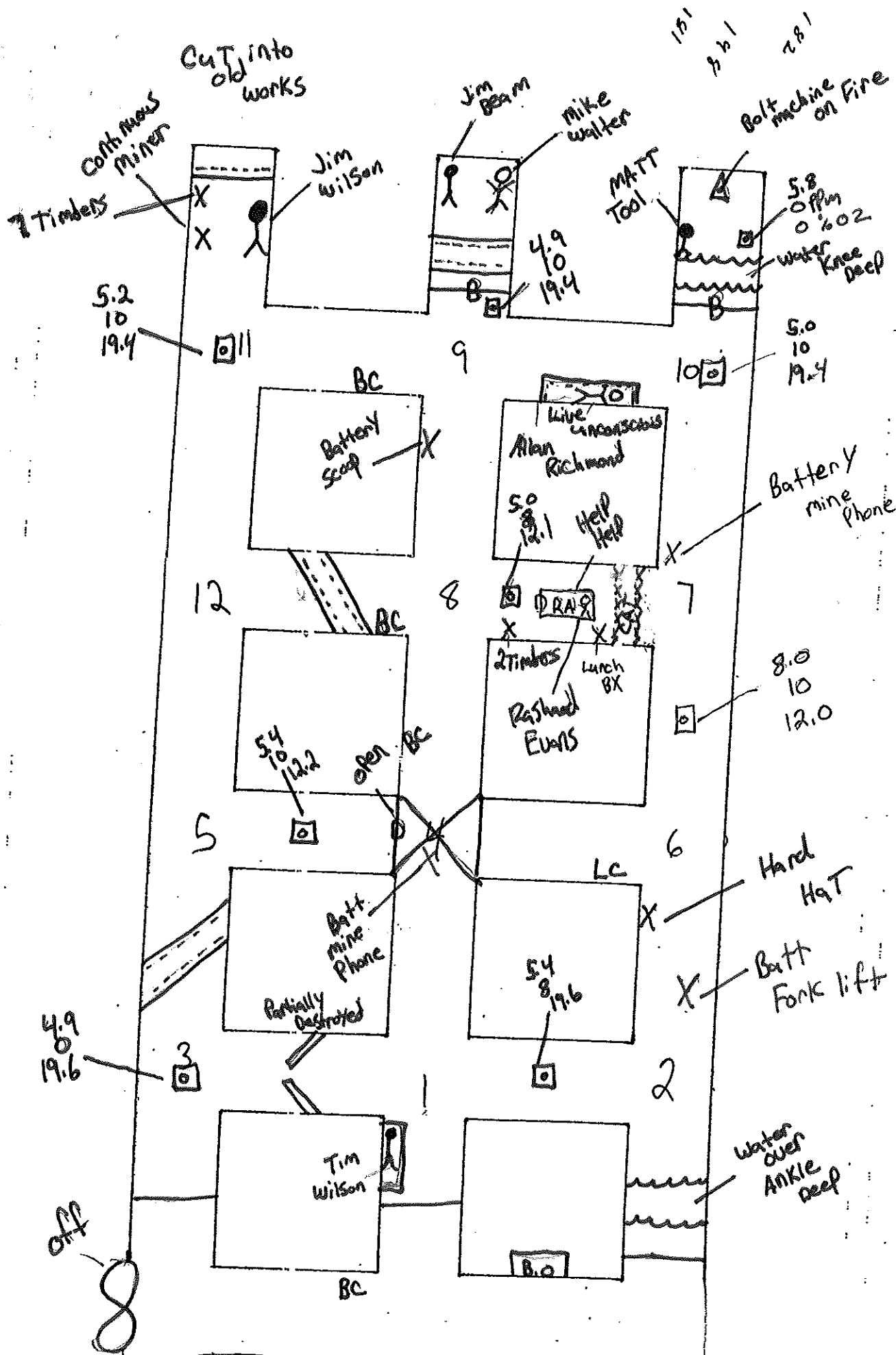

First Vent

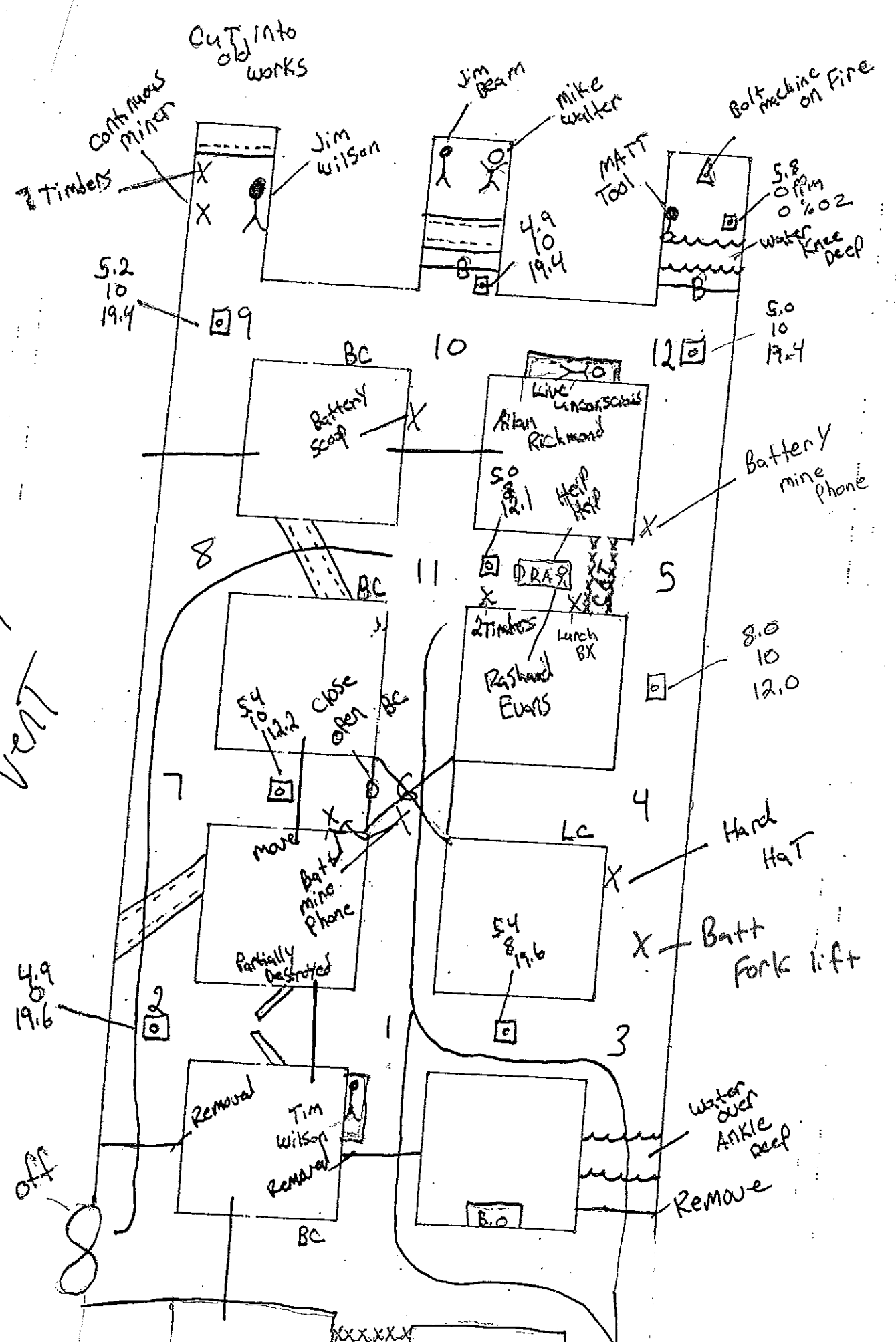

Second VENT

