

Welcome to the Duplex mining corporation. Here at our institution we do things a little backwards. Recently we installed two new air shafts, one in the number three entry and one in the number one entry, in the number two entry we have been sloping up towards the outside and were suppose to have cut thru into daylight on the evening shift but don't really know if that mission was accomplished. The air usually intakes up the number three entry and returns down the number one entry. Both shafts are completed and the intake shaft has a blowing fan installed on top of it. This unit can be used if you think you might need it. You may encounter a problem with it seeing as to how it has never been started and if it does run it will not be able to be shut off or reversed.

Last night the crew was instructed to drive the number two entry to the surface. The last cut should have only been about 20 feet or so. Shortly after I arrived home the outside man called and said the mine has encountered some sort of problem. Four men off of the seven man crew had arrived outside and told him that they thought there may be a fire underground on the section and that there also may have been a small explosion. They had no clew to as the whereabouts of their fellow workers.

This mine has a history of water accumulations, methane accumulations and adverse roof conditions. All power inby the fresh air base has been severed. All the proper agencies have been notified and are on sight. If you were to need the fan located on top of the intake shaft let me know and I will have it started for you.

Good Luck and bring my men to the surface

Problem

Bring all survivors to the surface

Call out the locations of all survivors to the superintendant

Call out the locations of all explosive mixtures to the superintendant

Flip the placards to open or close any doors located in the problem

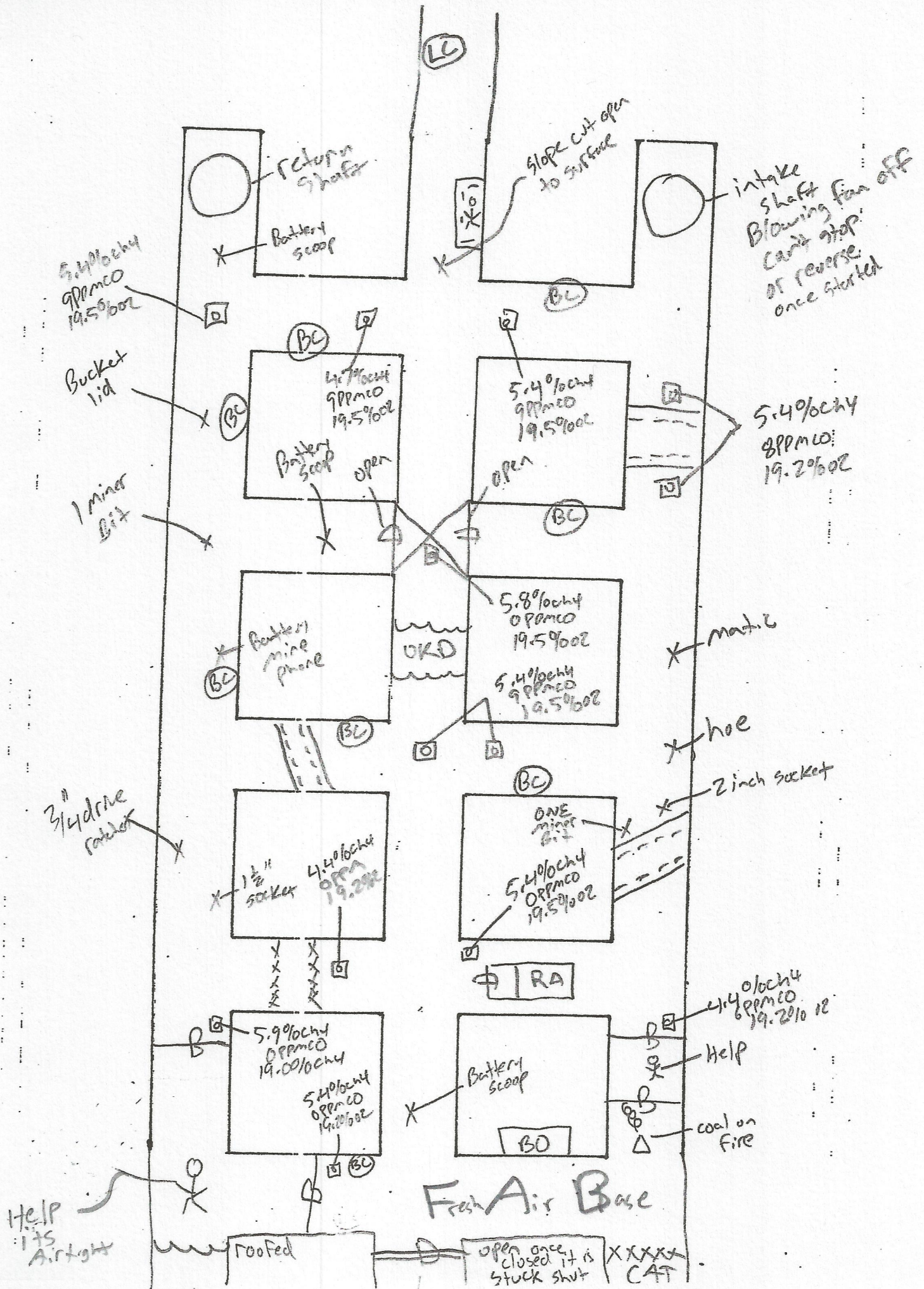

1st vent

LC

slope cut thru to surface

Return shaft

Battery scoop

Intake Blowing Fan

5.8% ch
9 PPM CO
19.5% O₂

5.4% ch
8 PPM CO
19.2% O₂

Bucket lid

1 Miner Bit

4.7% ch
9 PPM CO
19.5% O₂
Battery scoop

5.4
9
19.5
open

Battery mine phone

OKD

5.8
0
19.5
5.4
9
19.5

Matiz

hoe

zinc sacks

3/4 drive catcher

1 1/2" socket

ONE miner bit

5.4
0
19.5

5.9
0
19.0

4.4% ch
6 PPM CO
19.2% O₂

Help AT

4.4% ch
6 PPM CO
19.2% O₂

Battery scoop 2 timbers

Help

coal on fire

Roofed

open

CAT

cut thru
slope
to surface

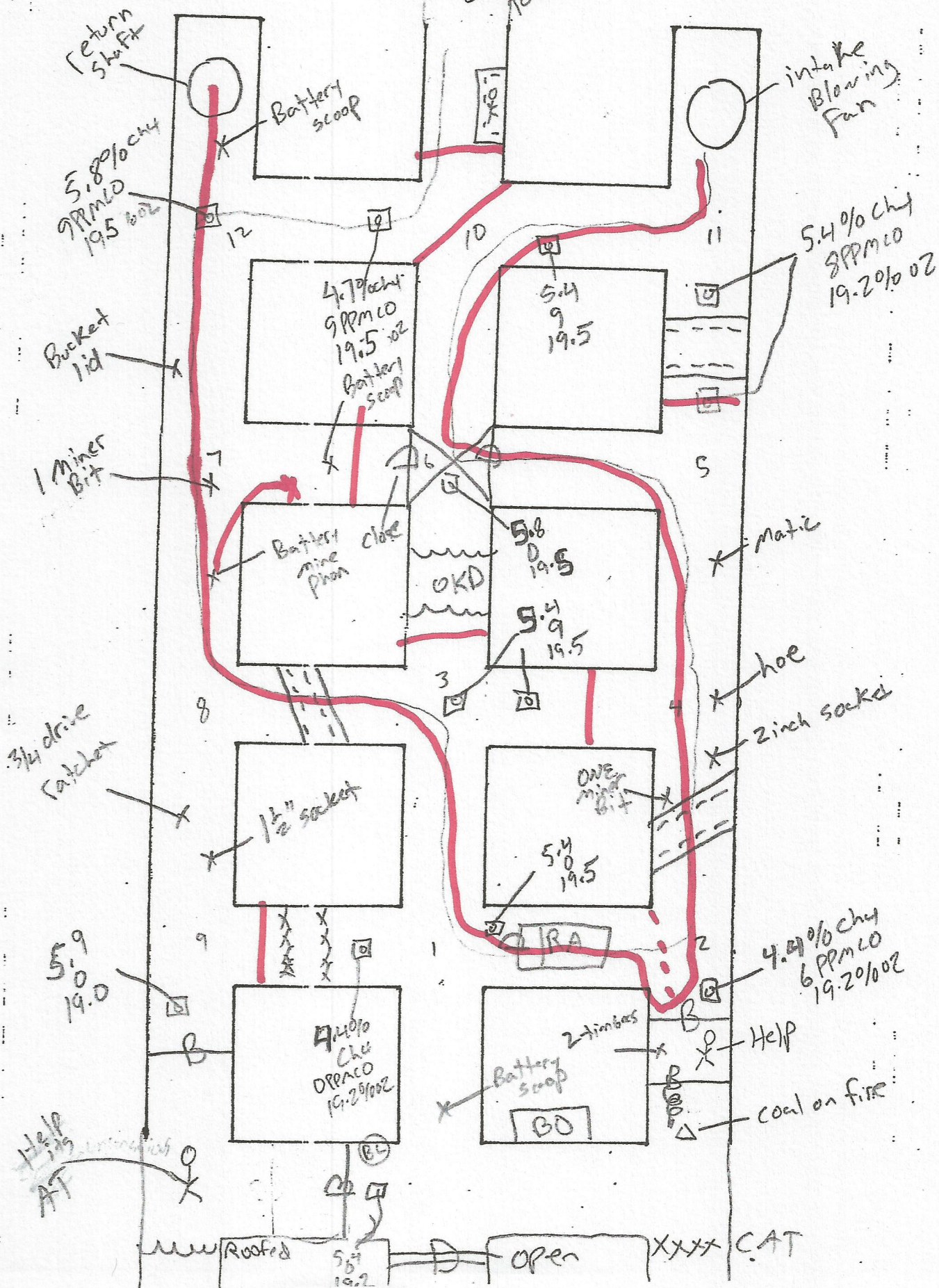

3rd vent

slope cut thru to surface

