



2018
TENNESSEE-COVE LAKE
MINE RESCUE CONTEST
DAY 2

MH

**TENNESSEE - COVE LAKE MINE RESCUE CONTEST
SUPERINTENDENT STATEMENT DAY 2
JUNE 6, 2018**

Thank you for coming to help us. You are located at the fresh air base of the Cove-Co #1 mine. This is a very large mine with multiple working sections and interconnected fans and air courses.

A mine rescue team was able to explore to the area inby the area you will be exploring. They were stopped by water in the number 1 entry, and unsafe roof in the number 2 and number 3 entries. Another team was able to setup a safe return and intake inby that you can use to ventilate through.

The number 1 fan is blowing and ventilating the fresh air base.

The mine has a history of bad roof, water and methane. The mine maps are up to date. We have a competent life line person to give and take life line signals if necessary.

Please find the 5 missing miners that were in this area of the mine that you will be exploring. Thank you and good luck.

PROBLEM DAY 2

THE NUMBER 1 FAS IS BLOWING AND CAN BE TURNED OFF AND REVERSED.

DO NOT STALL THE FAN, AS IT WILL CAUSE DAMAGE TO IT.

THE RETURN AND INTAKE OUTBY THE FAB AND INBY AREAS HAVE BEEN EXPLORED AND IS SAFE TO VENTILATE THROUGH.

ACCOUNT FOR ALL 5 MISSING MINERS THAT ARE IN THE AREA YOU ARE EXPLORING AND BRING SURVIVORS TO THE FAB.

EXPLORE ALL AREAS OF THE MINE THAT CAN BE DONE SAFELY.

WHEN THE TEAM IS TRAVELING THEY CAN ONLY CARRY 2 TIMBERS PER WORKING TEAM MEMBER AND THEY MUST CARRY THEIR OWN TIMBER IN THEIR HANDS. BRATTICE CLOTH AND LINE CURTAIN MUST BE EITHER CARRIED IN THE HAND OR ON THE STRETCHER. NO THROWING, KICKING, PITCHING ETC. OF THE TIMBERS, WATER PUMP, BRATTICE CLOTH OR LINE CURTAINS BY THE TEAM MEMBERS.

PATIENT STATEMENT

HELP GET ME OUT OF HERE.

COVE LAKE DAY 2 PROBLEM MAP

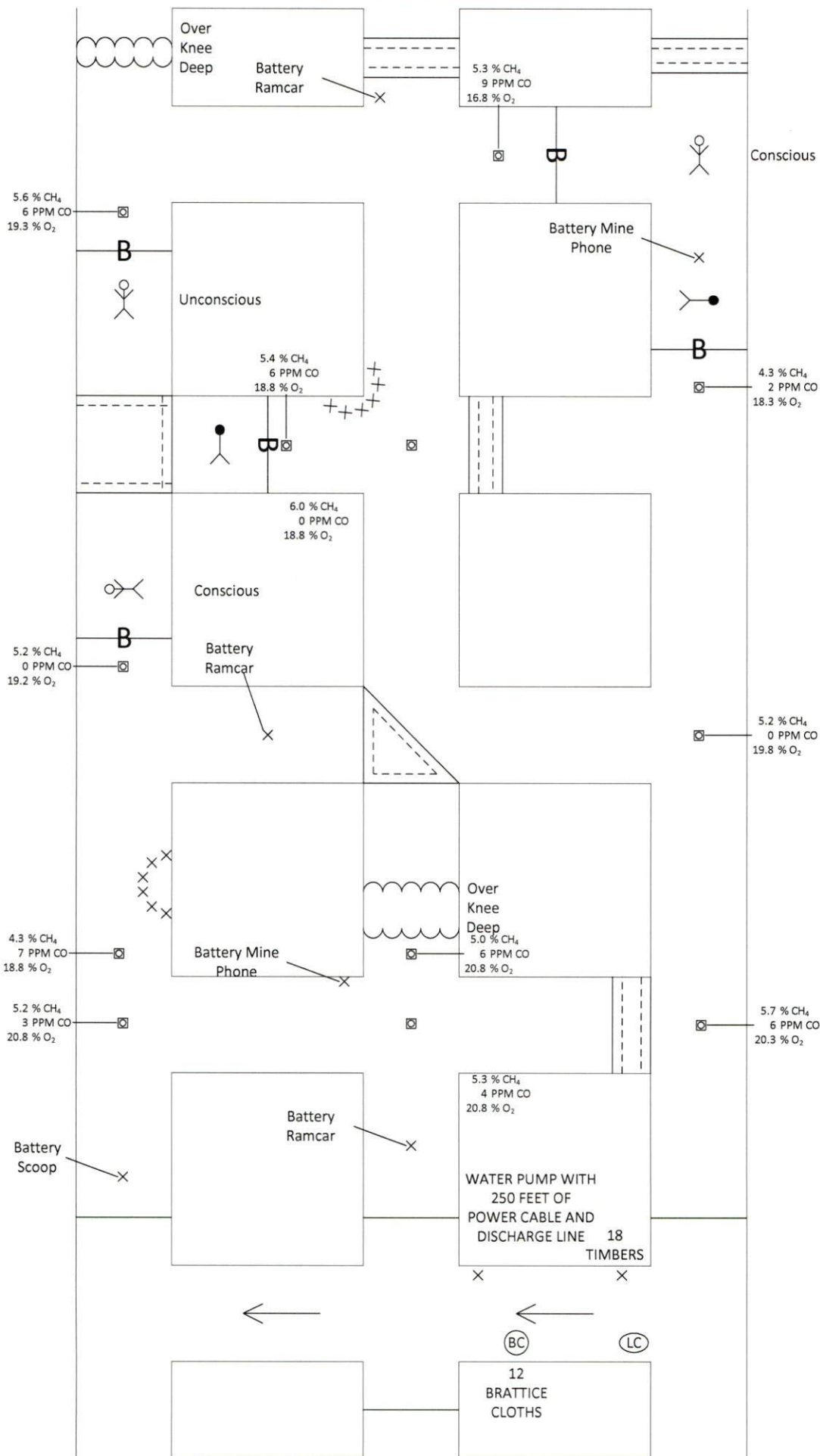

COVE LAKE DAY 2 TEAM STOP

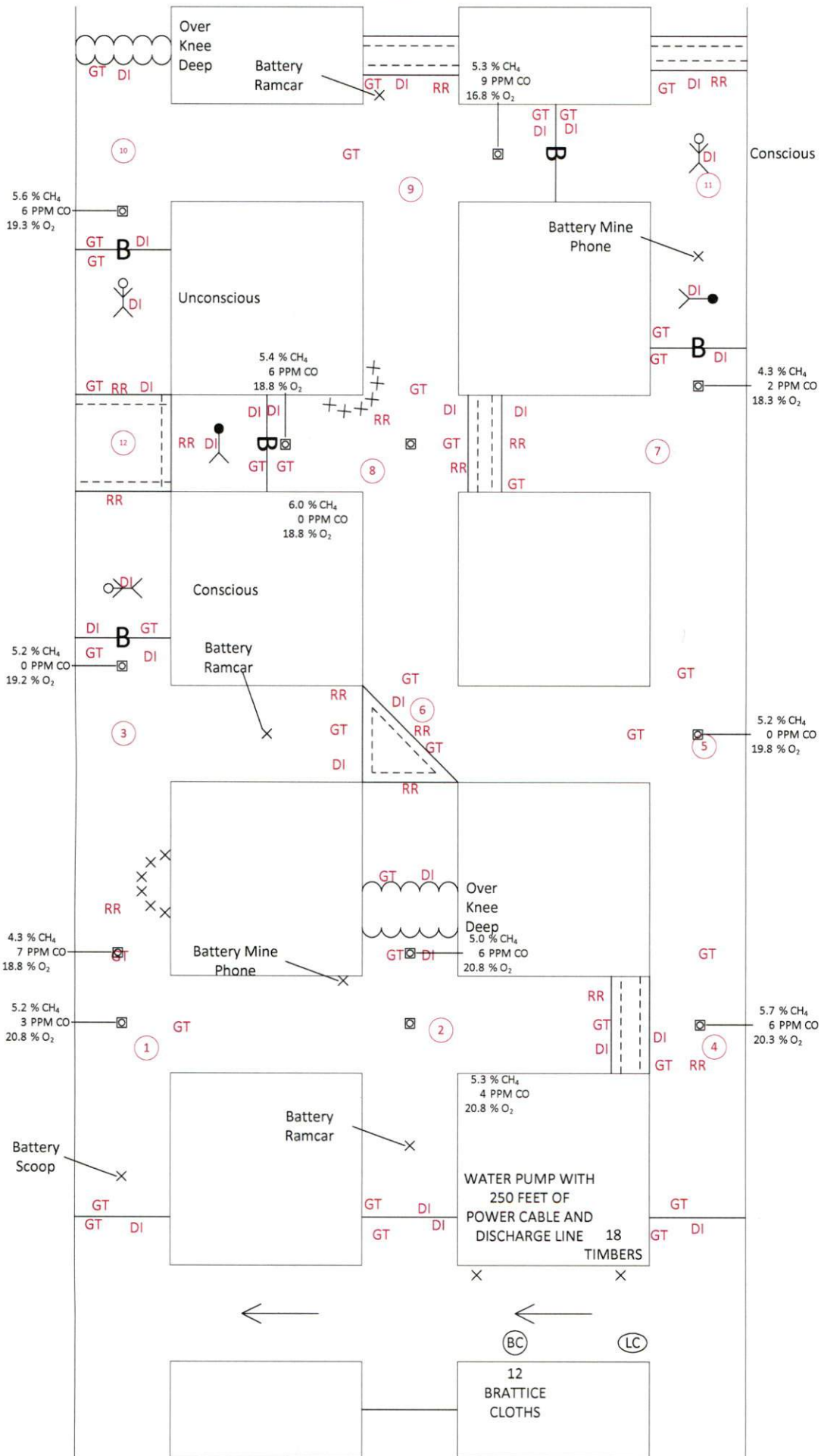

TENNESSEE - COVE LAKE MINE RESCUE CONTEST
DAY 2

JUDGES BRIEFING

Number 1 entry GT DI Airlock GT inby stopping

Number 2 entry GT DI Airlock GT inby stopping

Number 3 entry GT DI Airlock GT inby stopping

The teams can enter any entry they want to. We are setting this up as if they are entering number 1 entry first.

Team Stop 1

Crosscut between 1 & 2 GT

Inby GT RR

Team Stop 2

Inby GT DI

Crosscut between 2 & 3 GT DI RR

Outby GT DI

Team Stop 3

Patient reads statement

Crosscut between 1 & 2 GT DI RR

Inby GT DI

Team Stop 4

Inby GT

Intersection RR Zig-Zag GT DI at unsafe roof

Team Stop 5

Inby GT

Crosscut between 2 & 3 GT

Team Stop 6
Intersection GT DI RR Zig-Zag
Inby GT

Team Stop 7
Inby GT DI
Crosscut between 2 & 3 GT DI RR

Team Stop 8
RR Zig-Zag intersection
Crosscut between 2 & 3 GT DI RR
Crosscut between 1 & 2 GT DI RR
Inby GT

Team Stop 9
Crosscut between 2 & 3 GT DI
Inby GT DI RR
Crosscut between 1 & 2 GT

Team Stop 10
Inby GT DI
Outby GT DI

Now the team must explore through the diagonal unsafe
roof by setting timbers.

Outby RR
At water GT DI

Ventilation 1
Ventilation 2
Pump 1
Ventilation 3

Team Stop 11
Entering barricade GT
Body touch DI
Patient touch assess DI Take to FAB
Crosscut between 2 &3 GT DI
Inby GT DI RR

Ventilation 4

Team Stop 12
Entering barricade GT
Patient touch assess DI Take to FAB
Unsafe roof GT DI RR
Now the team timbers through crosscut to patient
RR on outby side
Patient touch assess DI Take to FAB
Now timber to crosscut
RR on inby side
Body touch DI
Crosscut between 1 &2 GT DI

Stop Clock

COVE LAKE DAY 2 VENT 1

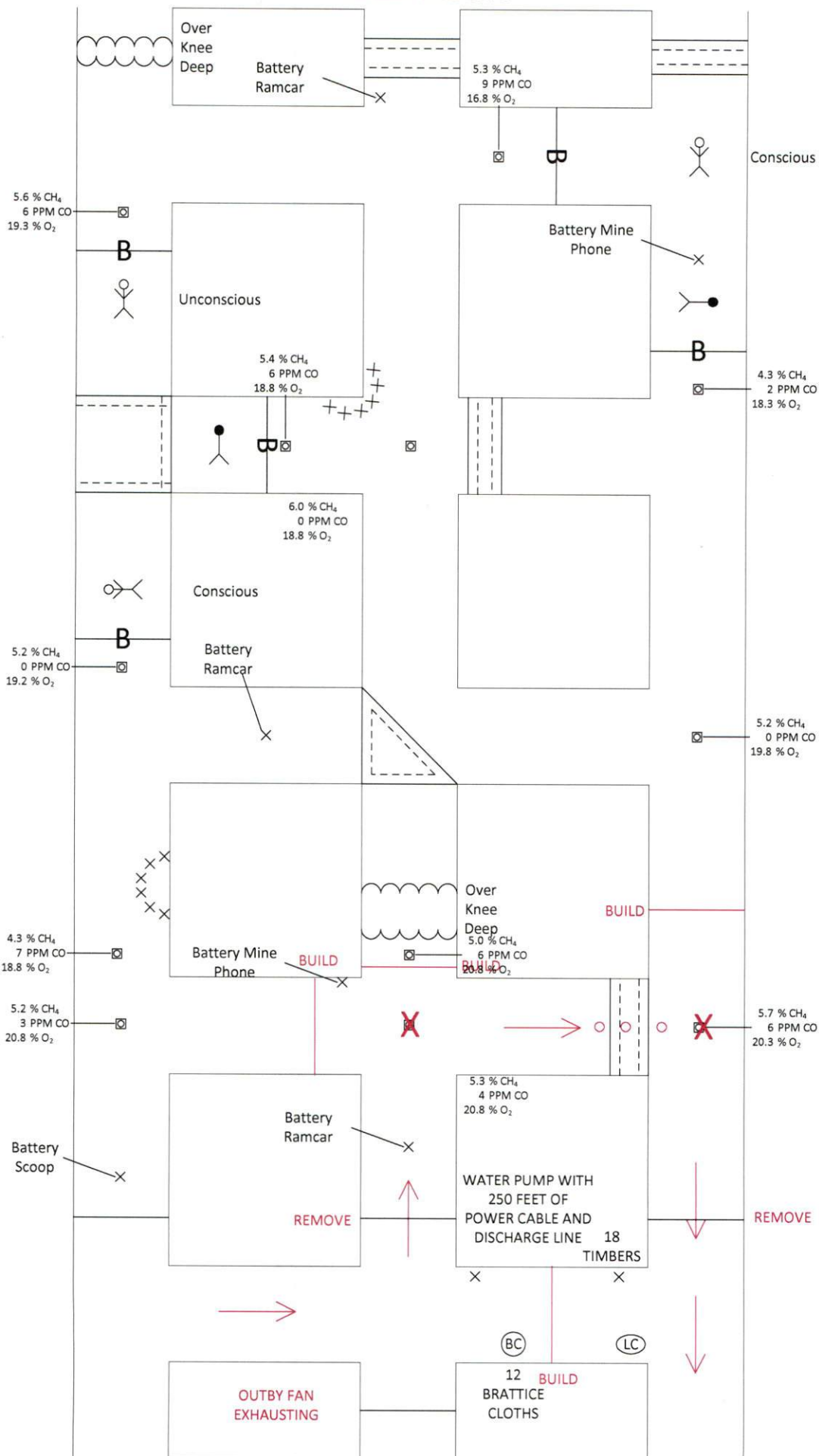

COVE LAKE DAY 2 VENT 2

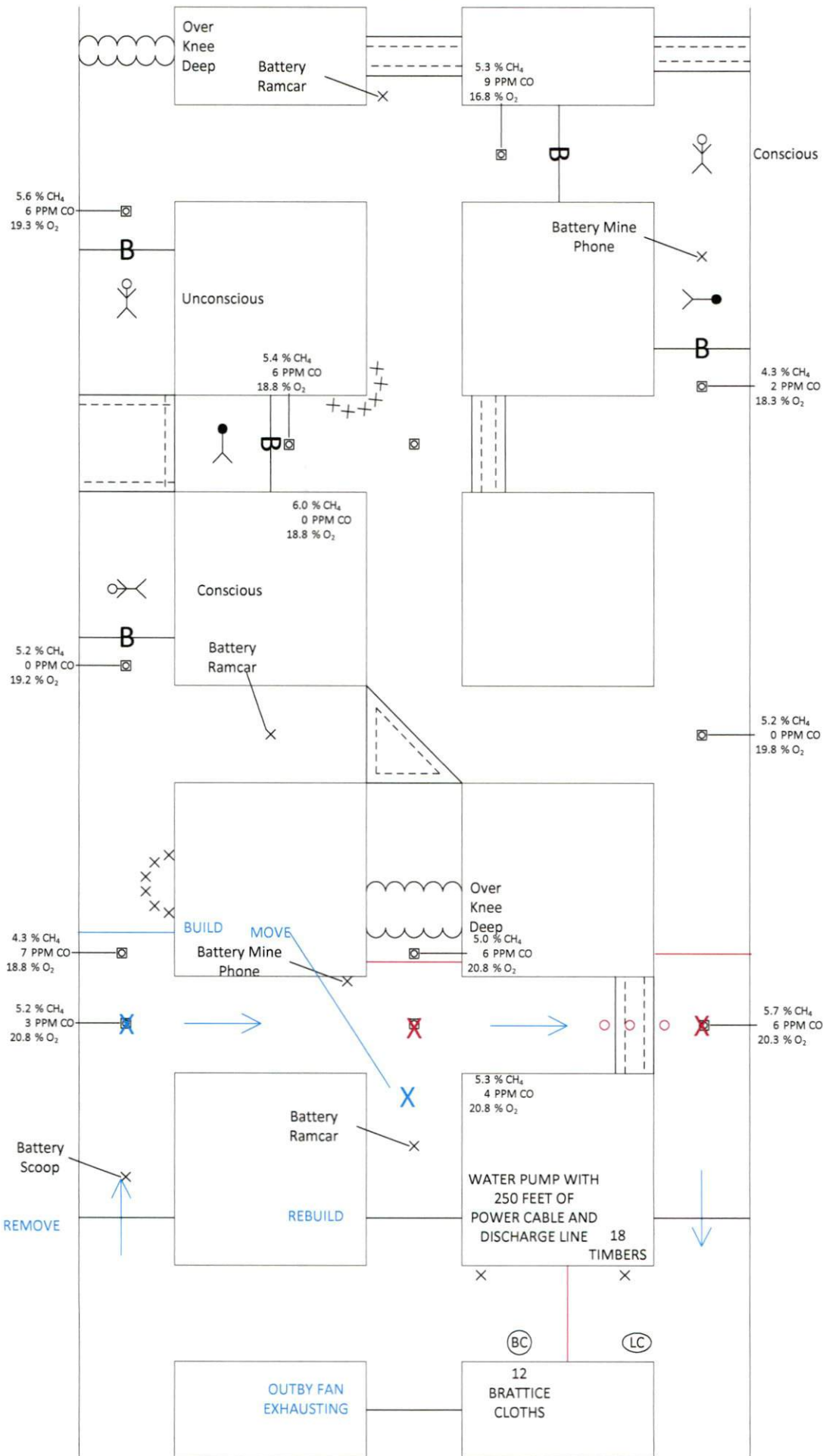

COVE LAKE DAY 2 PUMP 1

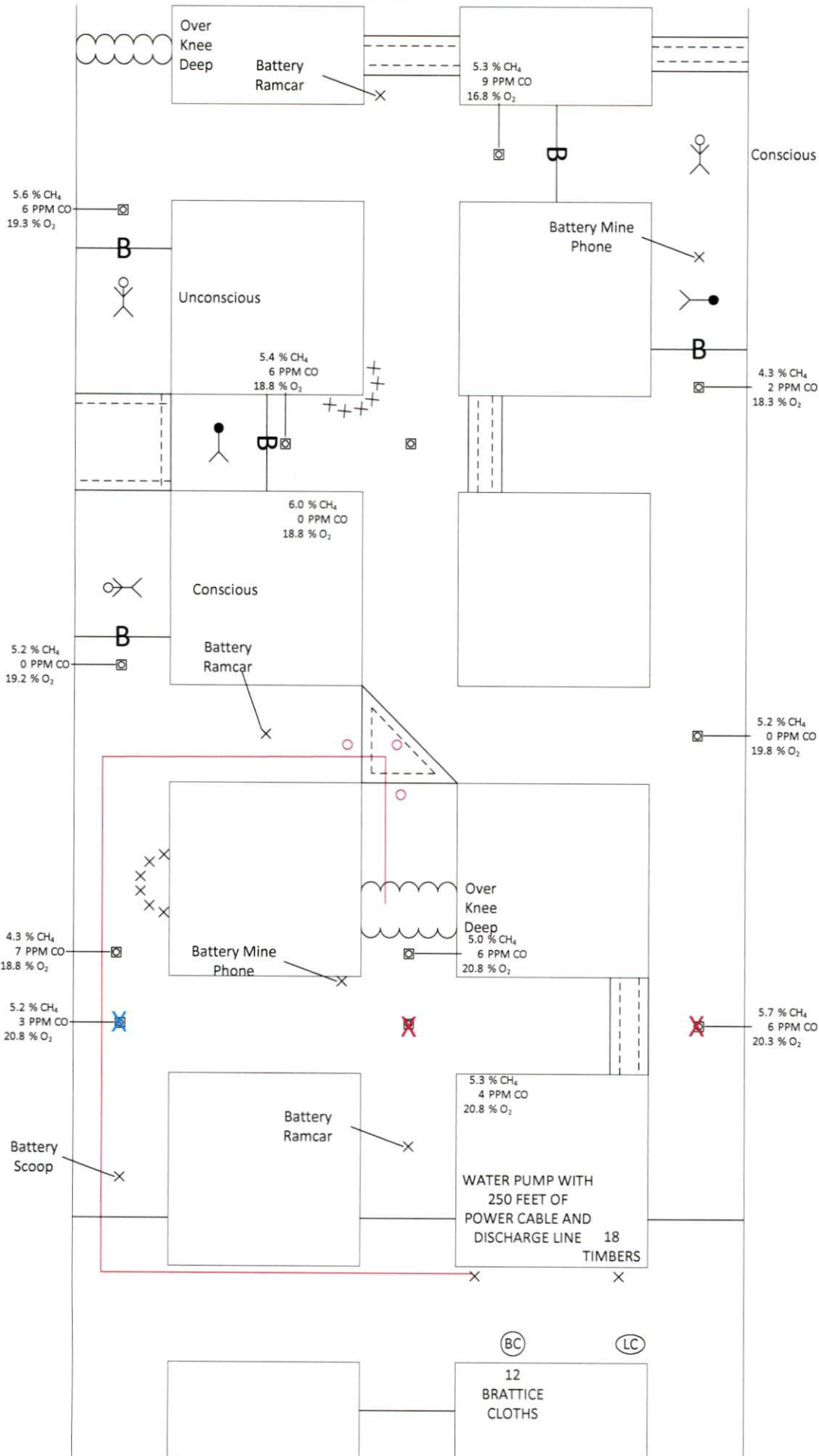

COVE LAKE DAY 2 VENT 3

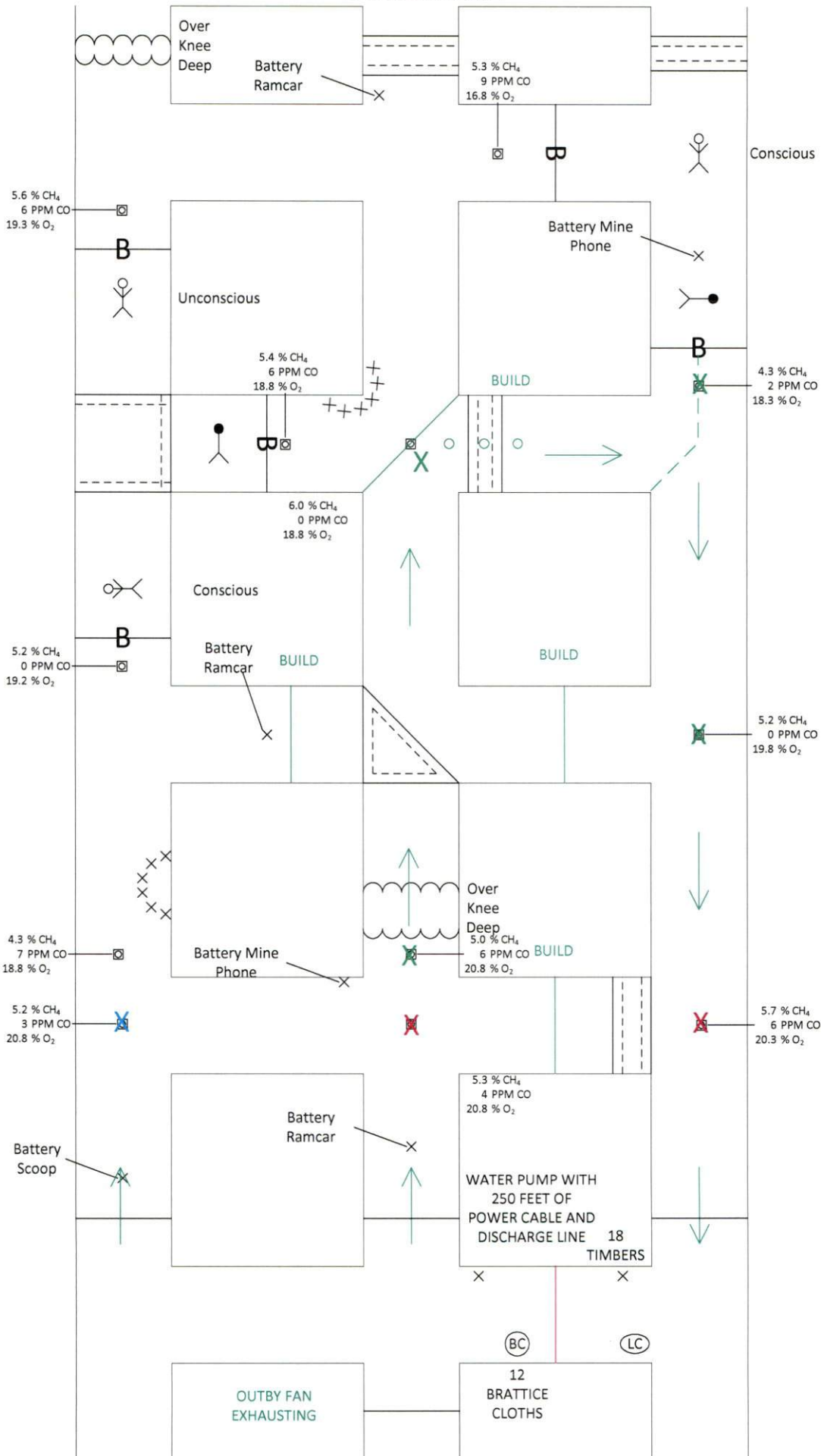

COVE LAKE DAY 2 VENT 4

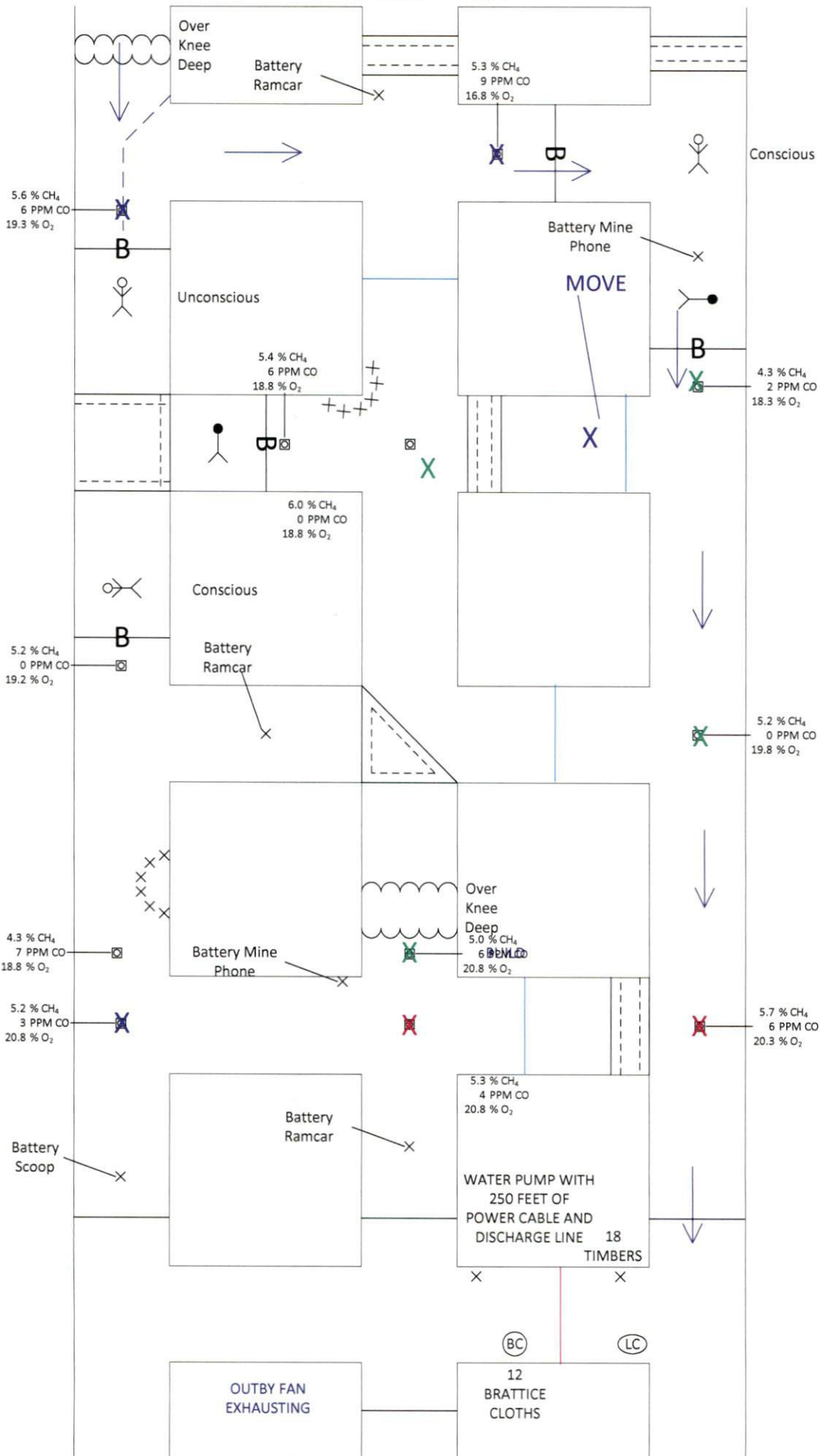

COVE LAKE DAY 2 EXTENT OF GASES

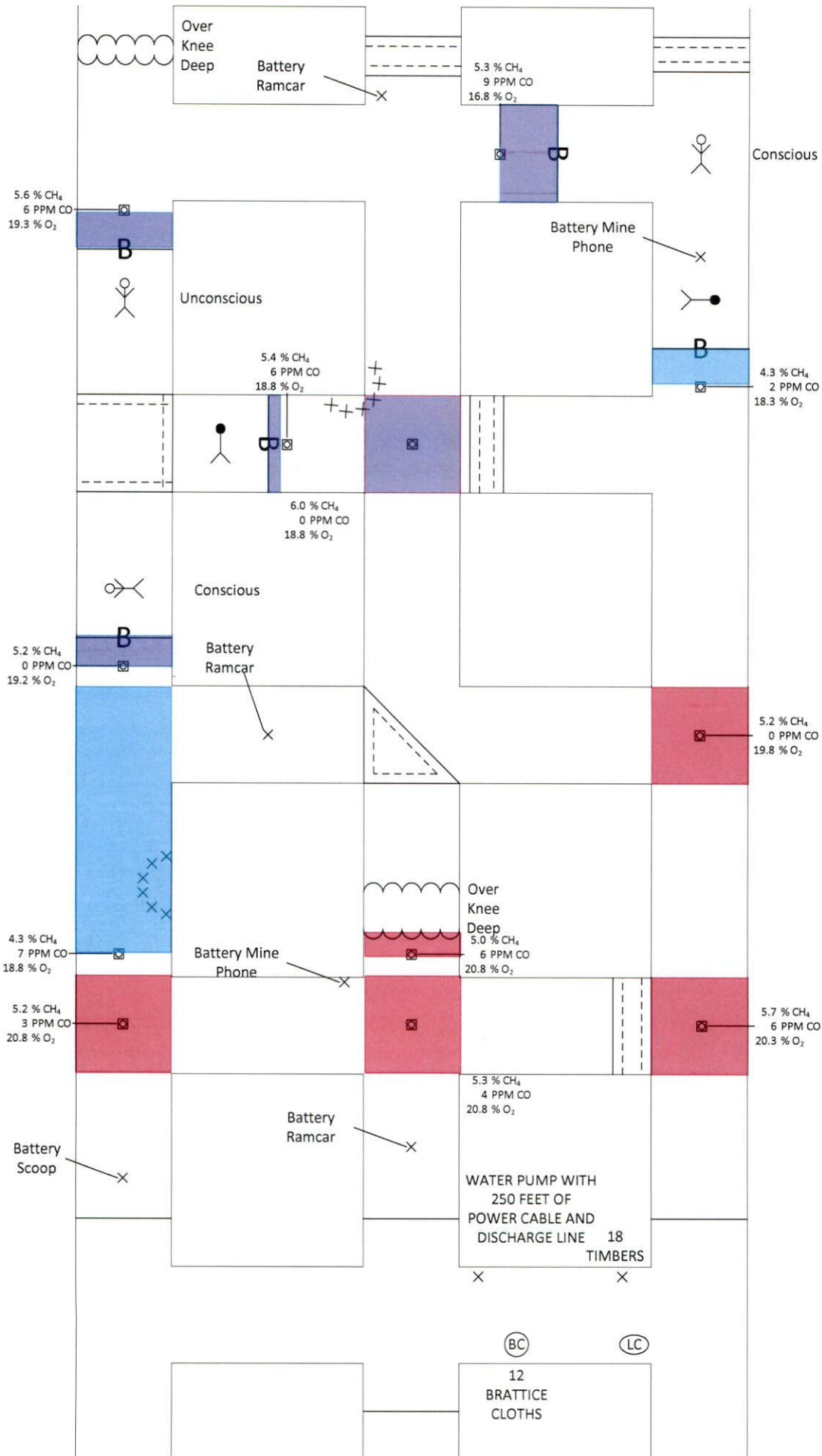

COVE LAKE DAY 2 TEAM MAP

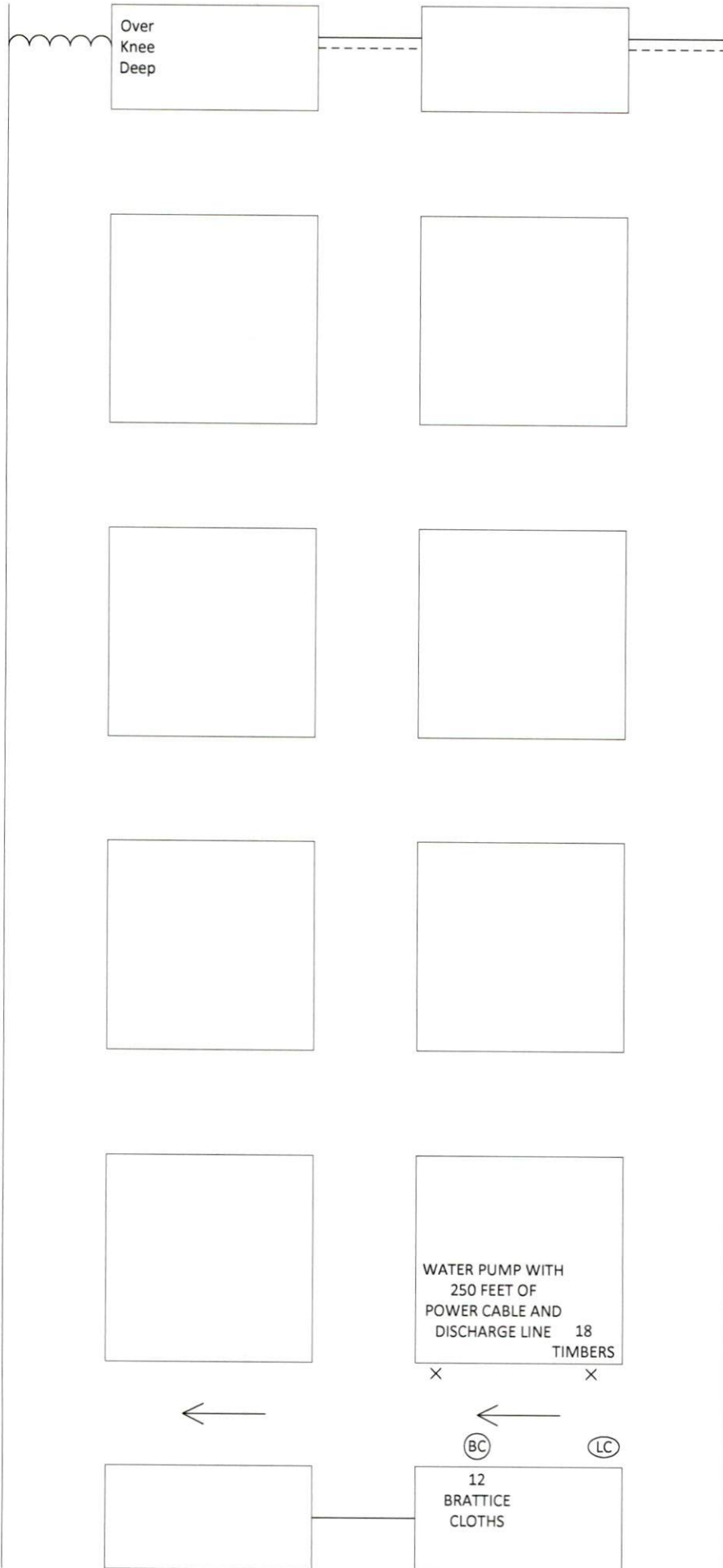

COVE LAKE DAY 2 FINAL MAP

