



2018
TENNESSEE-COVE LAKE
MINE RESCUE CONTEST
DAY 1

MH

TENNESSEE - COVE LAKE MINE RESCUE CONTEST
SUPERINTENDENT STATEMENT DAY 1
JUNE 5, 2018

Thank you for coming to help us. You are located at the fresh air base of the Cove-Co #1 mine. This is a very large mine with multiple working sections and interconnected fans and air courses.

A mine rescue team was able to explore to the area inby the area you will be exploring. They were stopped by water in the number 1 entry, and unsafe roof in the number 2 and number 3 entries. They installed temporary stoppings inby the water and both unsafe roofs. Another team was able to setup a safe return and intake inby that you can use to ventilate through.

The number 1 fan is blowing and ventilating the fresh air base up the number 3 entry and returns down number 1 and 2 entries and the entry to the left of the fresh air base.

The number 2 fan is blowing and ventilating the area to the right of the fresh air base and the air enters the fresh air base through the entry to the right and returns down the number 1 and 2 entries and the entry to the left.

The mine has a history of bad roof, water and methane. The mine maps are up to date. We have a competent life line person to give and take life line signals if necessary.

Please find the 5 missing miners that were in this area of the mine that you will be exploring. Thank you and good luck.

PROBLEM DAY 1

BOTH THE NUMBER 1 AND THE NUMBER 2 FANS ARE BLOWING AND CANNOT BE TURNED OFF OR REVERSED.

DO NOT STALL EITHER FAN, AS IT WILL CAUSE DAMAGE TO THEM.

THE RETURN AND INTAKE OUTBY THE FAB AND INBY AREAS HAVE BEEN EXPLORED AND IS SAFE TO VENTILATE THROUGH.

ACCOUNT FOR ALL 5 MISSING MINERS THAT ARE IN THE AREA YOU ARE EXPLORING AND BRING SURVIVORS TO THE FAB.

EXPLORE ALL AREAS OF THE MINE THAT CAN BE DONE SAFELY.

WHEN THE TEAM IS TRAVELING THEY CAN ONLY CARRY 2 TIMBERS PER WORKING TEAM MEMBER AND THEY MUST CARRY THEIR OWN TIMBER IN THEIR HANDS. BRATTICE CLOTH AND LINE CURTAIN MUST BE EITHER CARRIED IN THE HAND OR ON THE STRETCHER. NO THROWING, KICKING, PITCHING ETC. OF THE TIMBERS, WATER PUMP, BRATTICE CLOTH OR LINE CURTAINS BY THE TEAM MEMBERS.

PATIENT STATEMENT

HELP GET ME OUT OF HERE.

COVE LAKE DAY 1 PROBLEM

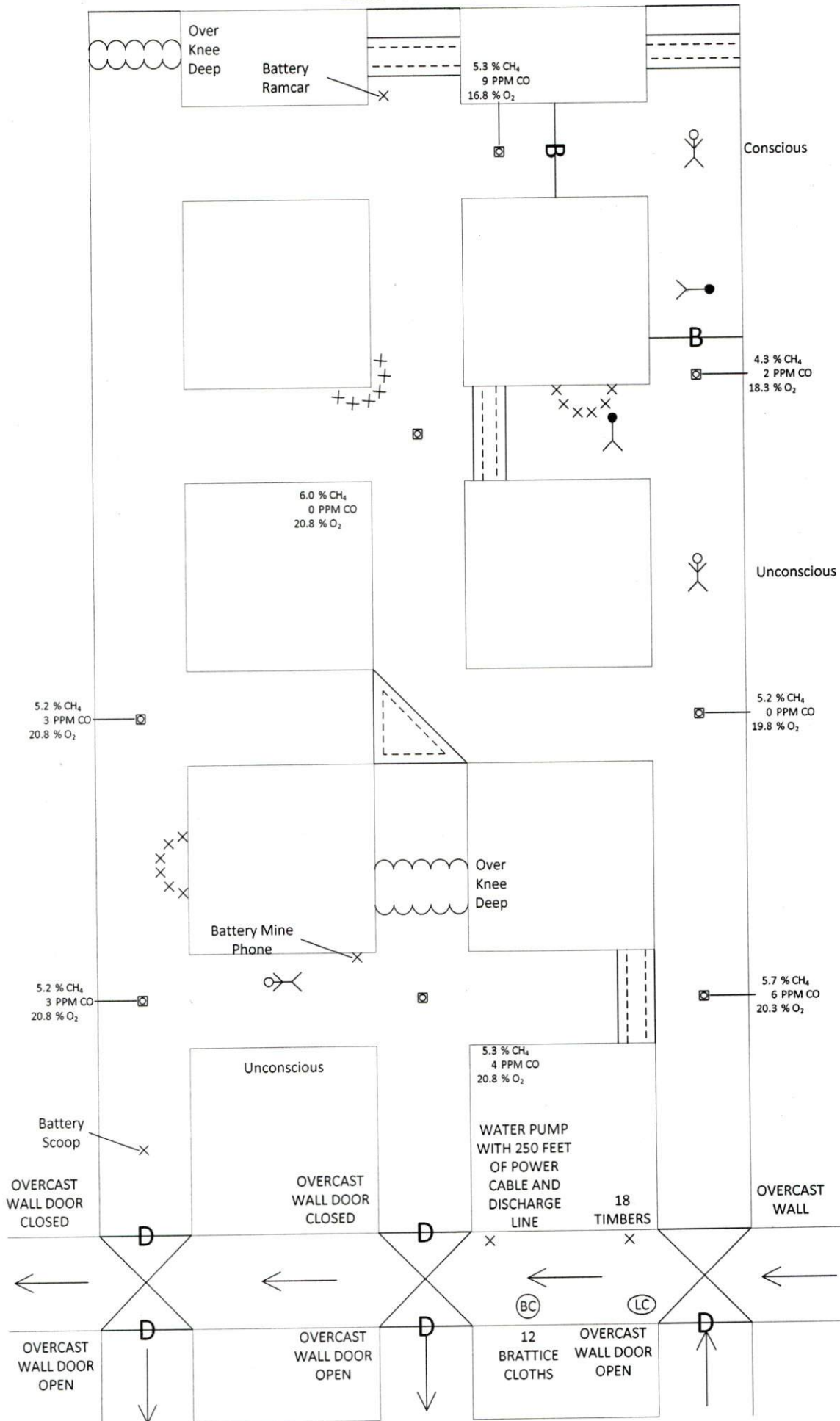

COVE LAKE DAY 1 TEAM STOP

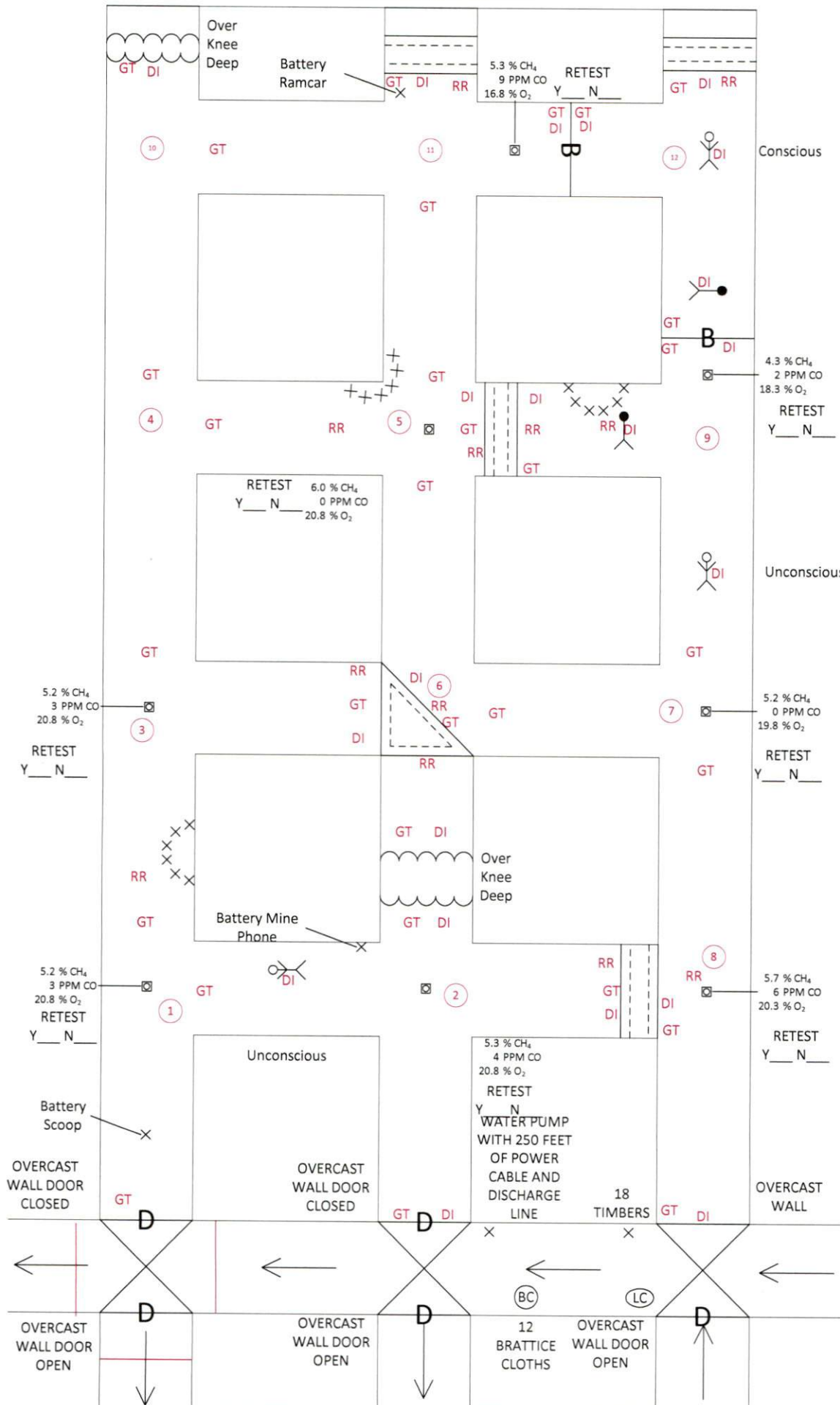

TENNESSEE - COVE LAKE MINE RESCUE CONTEST
DAY 1
JUDGES BRIEFING

The must enter through the door on the inby side of the number 1 entry overcast by building the three stoppings on the map.

Enter through door GT.

Team Stop 1

Crosscut between 1 & 2 GT Touch patient assess and DI, take patient to FAB

Inby GT RR

Team Stop 2

Inby GT DI

Crosscut between 2 & 3 GT DI RR

Outby GT DI

Team Stop 3

Crosscut between 1 & 2 GT DI RR

Inby GT

Team Stop 4

Inby GT

Crosscut between 1 & 2 GT RR Zig-Zag at caved into next intersection.

Team Stop 5

Continue RR Zig-Zag through intersection and inby

Inby GT

Outby GT

Crosscut between 2 & 3 GT DI RR

Team Stop 6

Intersection GT DI RR Zig-Zag

Crosscut between 2 & 3 GT

Team Stop 7

Inby GT Patient touch Assess DI and take to FAB

Outby GT

Team Stop 8

RR Zig-Zag intersection DI GT at unsafe roof

Outby GT DI

Team Stop 9

RR Zig-Zag at caved on rib

Body touch DI

Crosscut between 2 & 3 GT DI RR

Inby GT DI

Team Stop 10

Inby GT DI

Crosscut between 1 & 2 GT

Team Stop 11

Inby GT DI RR

Crosscut between 2 & 3 GT DI

Outby GT

Now the team must explore through the diagonal unsafe roof by setting timbers.

Outby RR

At water GT DI

Ventilation 1

Pump 1

Ventilation 2

Ventilation 3

Ventilation 4

Ventilation 5

Tem Stop 12

Entering barricade GT

Body touch DI

Patient touch assess DI Take to FAB

Crosscut between 2 &3 GT DI

Inby GT DI RR

Stop Clock

COVE LAKE DAY 1 VENT 1

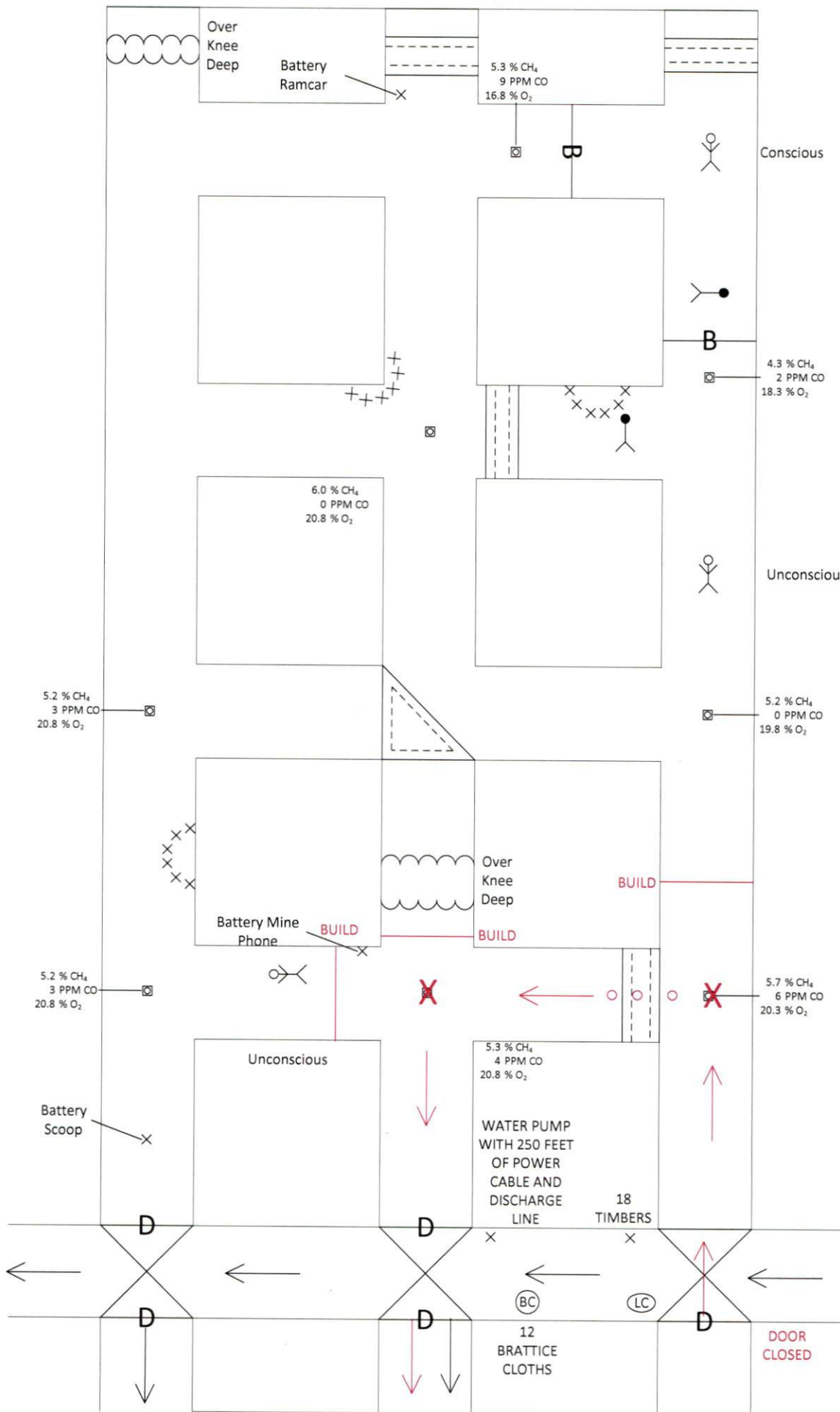

COVE LAKE DAY 1 PUMP 1

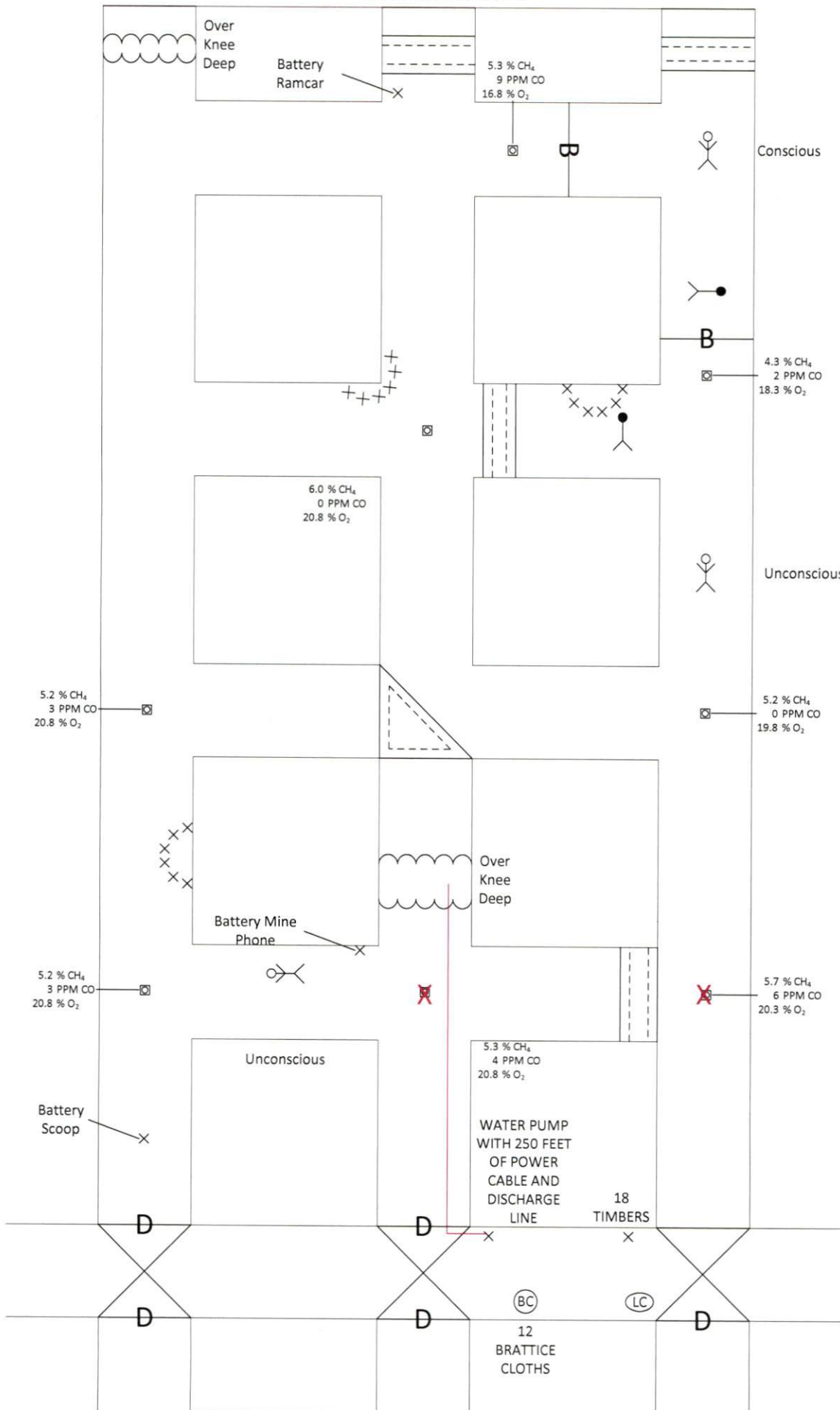

COVE LAKE DAY 1 VENT 2

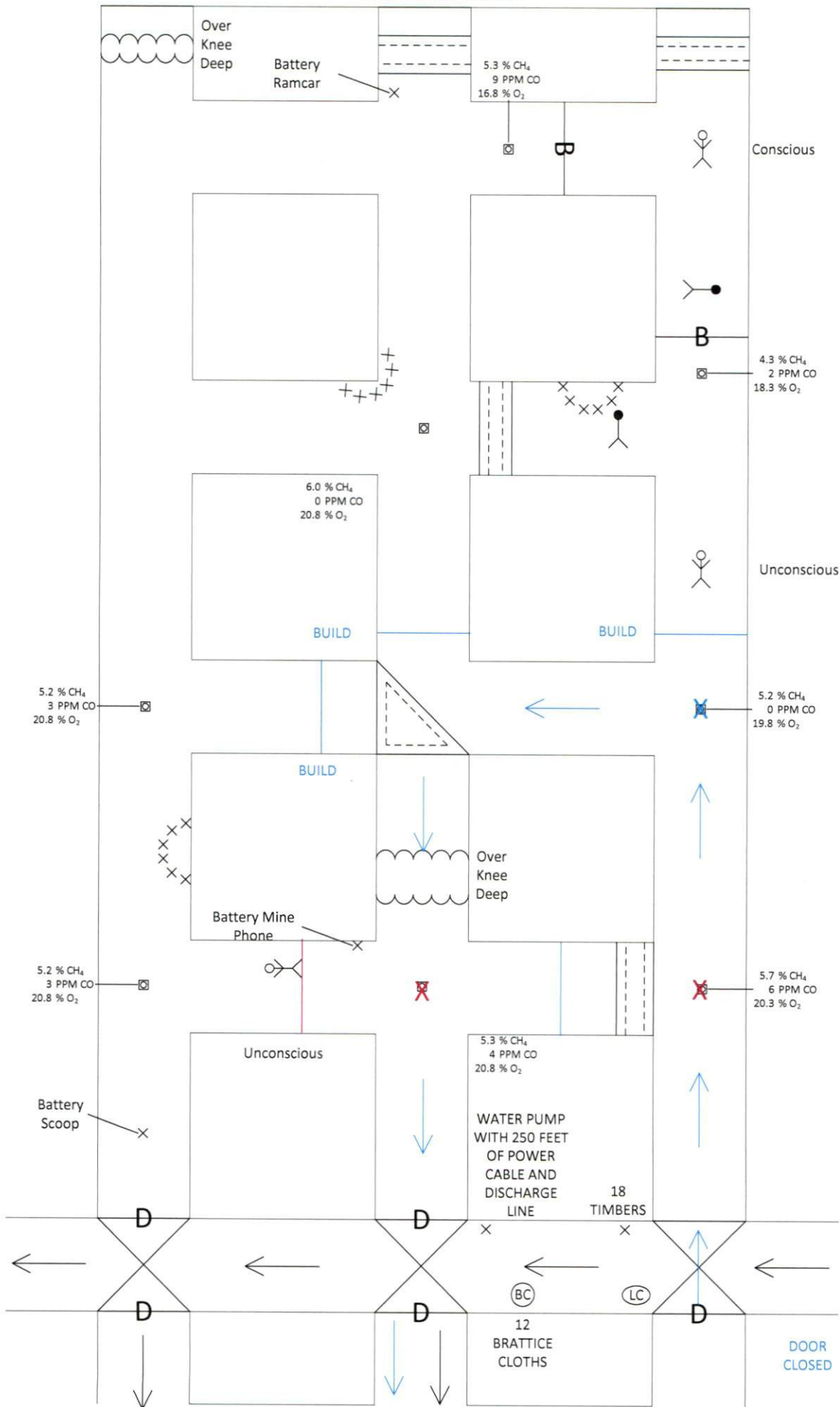

COVE LAKE DAY 1 VENT 3

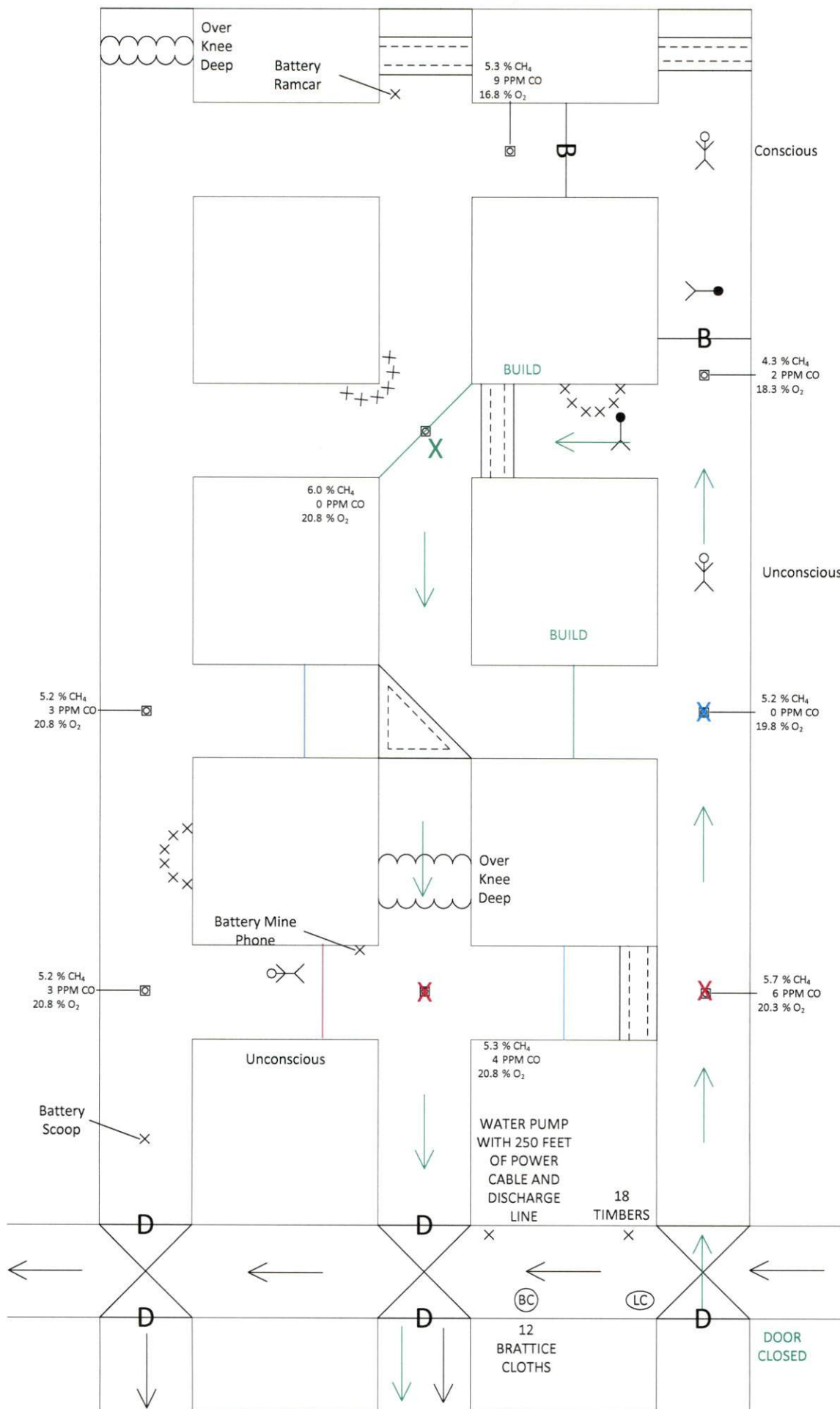

COVE LAKE DAY 1 VENT 4

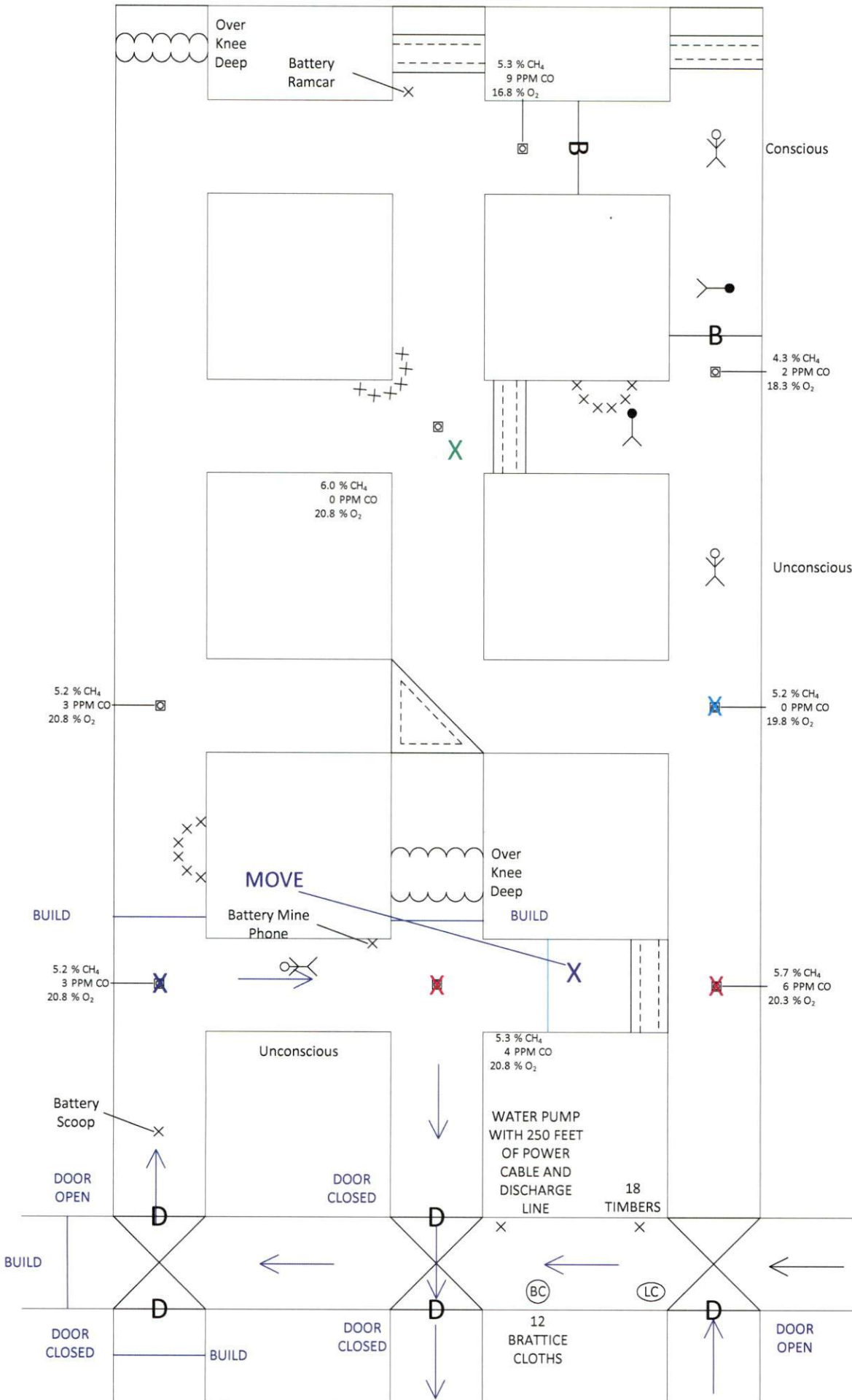

COVE LAKE DAY 1 VENT 5

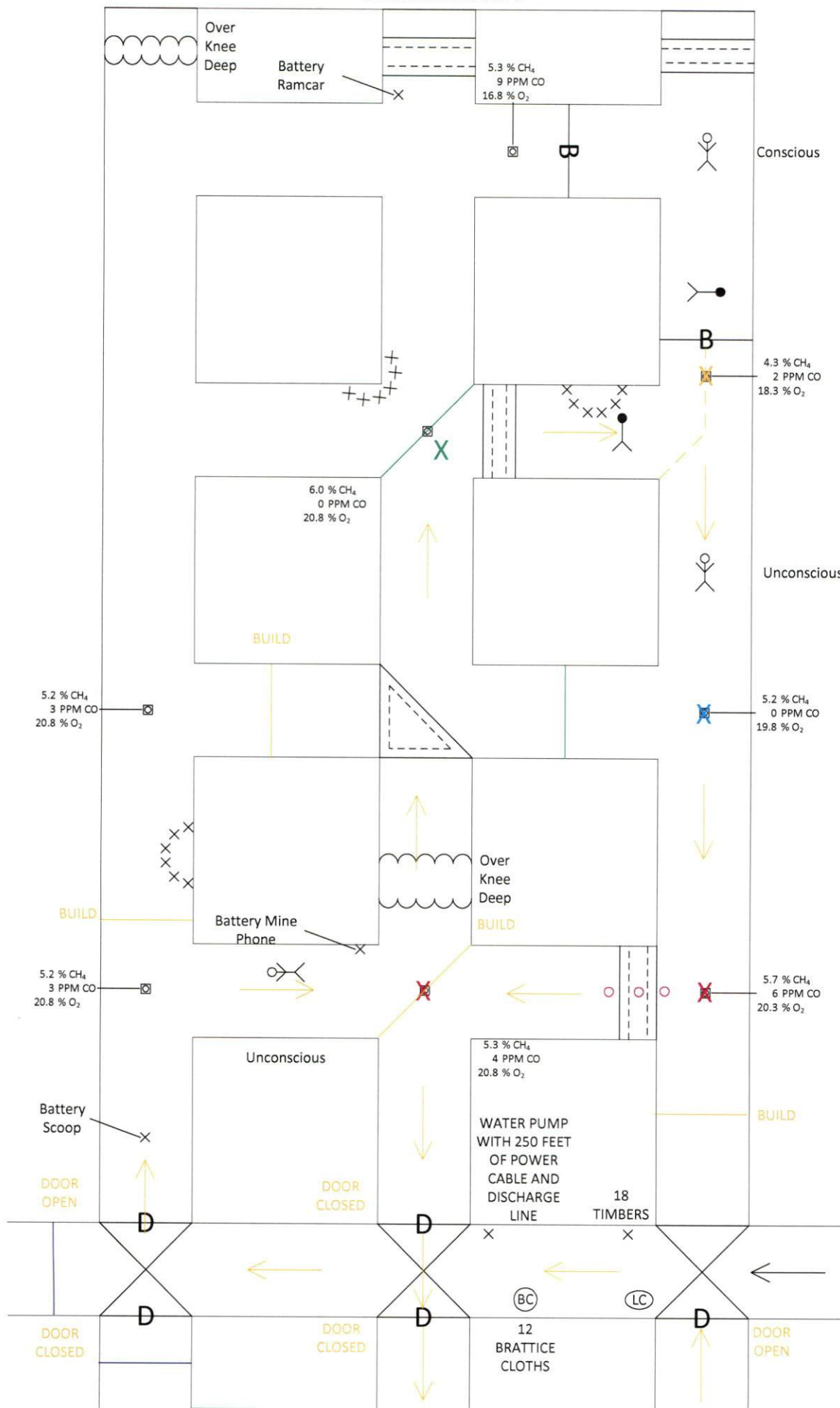

COVE LAKE DAY 1 EXTENT OF GASES

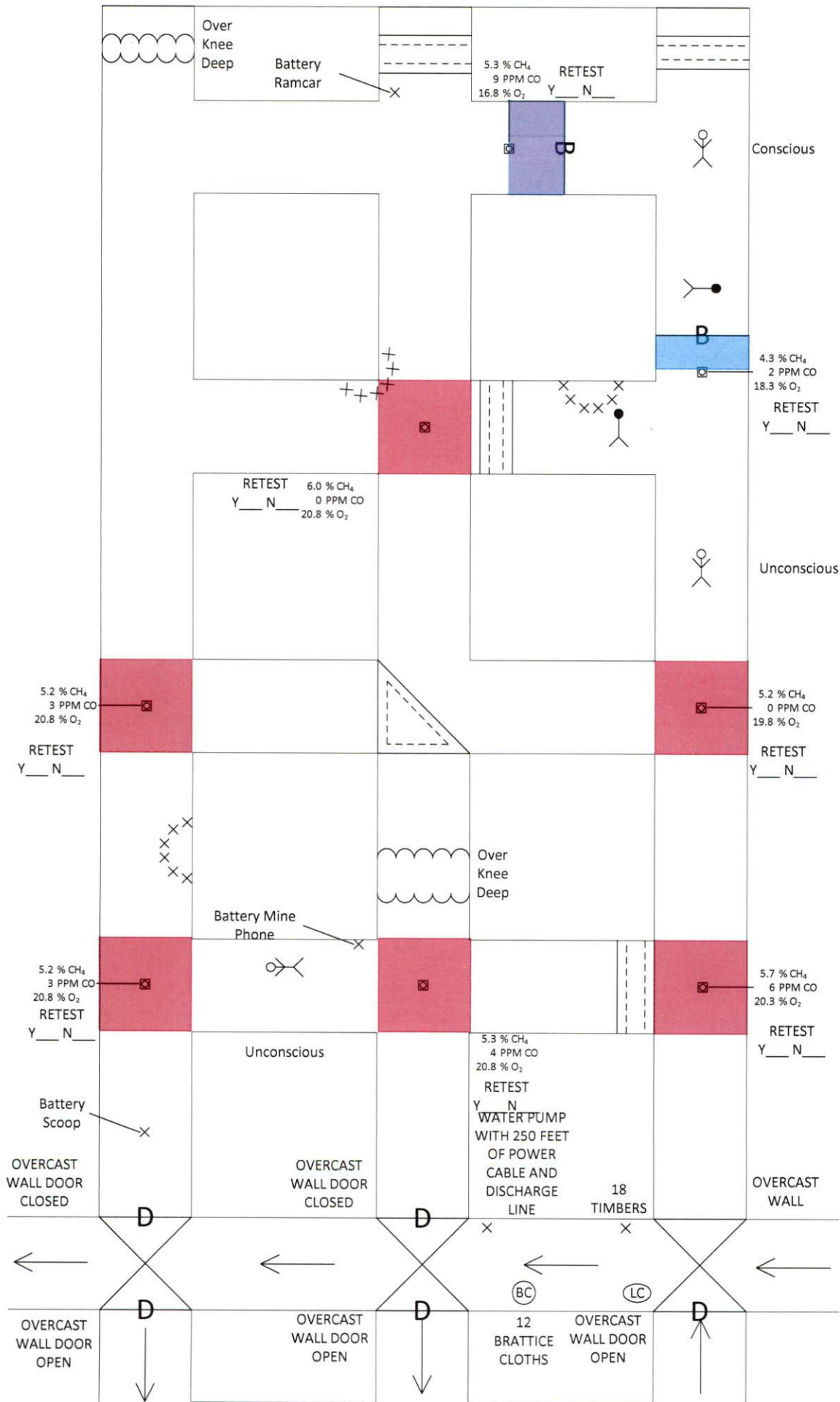

COVE LAKE DAY 1 TEAM MAP

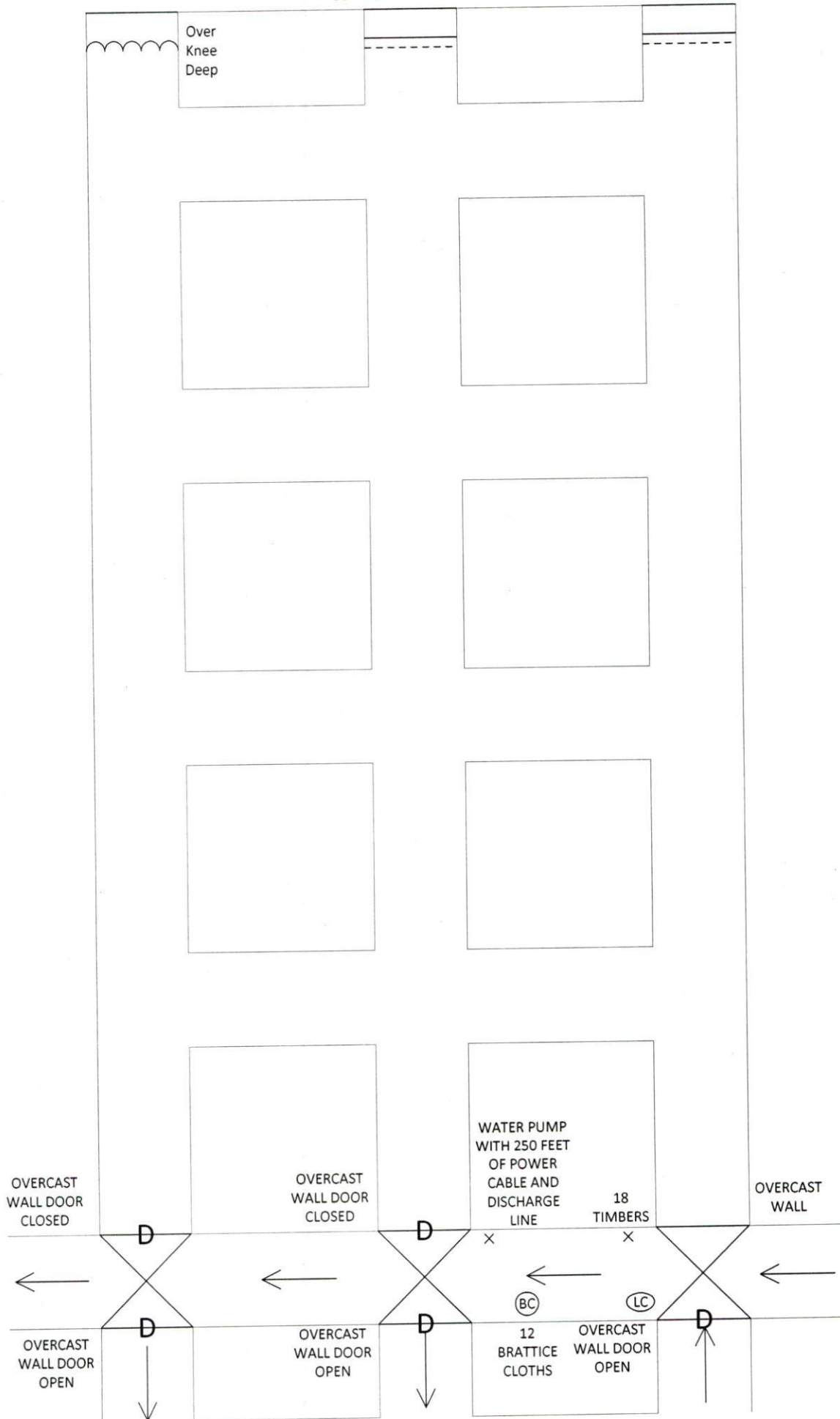

COVE LAKE DAY 1 FINAL MAP

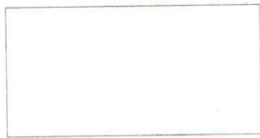

5.3 % CH₄
9 PPM CO
16.8 % O₂ RETEST
Y ___ N ___

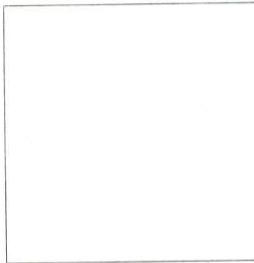
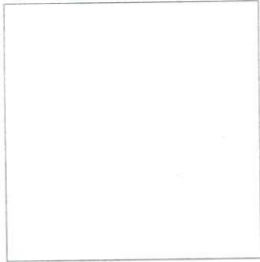

4.3 % CH₄
2 PPM CO
18.3 % O₂ RETEST
Y ___ N ___



RETEST 6.0 % CH₄
Y ___ N ___ 0 PPM CO
20.8 % O₂

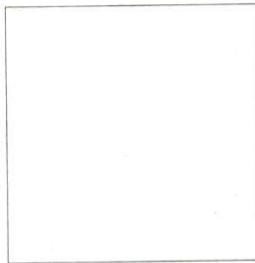

5.2 % CH₄
3 PPM CO
20.8 % O₂



RETEST
Y ___ N ___

5.2 % CH₄
0 PPM CO
19.8 % O₂



RETEST
Y ___ N ___

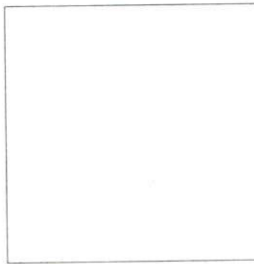
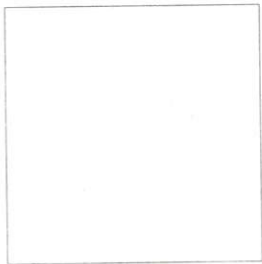

5.2 % CH₄
3 PPM CO
20.8 % O₂



RETEST
Y ___ N ___



5.7 % CH₄
6 PPM CO
20.3 % O₂



RETEST
Y ___ N ___

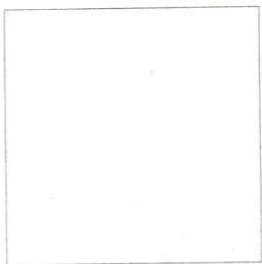

5.3 % CH₄
4 PPM CO
20.8 % O₂ RETEST
Y ___ N ___

