

STATEMENT

I am _____, Superintendent of the Deplorables Coal Company #1 mine. Thank you for responding to our emergency. This is a brand new mine started up to help Make America Great Again. Last night a 4 person crew entered the mine to perform work. When the outside person had not heard from them in a while, she tried to communicate with them and was not able to make contact so she contacted all necessary officials.

The mine is ventilated by a split intake and return shaft in the #2 entry. There is an exhaust fan on the return side and the intake side is open to the surface. There is an elevator on the intake side of the shaft. You will initially be located on the surface to enter the mine via the elevator on the intake side of the shaft. There is also a slope for hauling in supplies. The slope intersects the mine near the bottom of the elevator. It is a very long slope and has already been checked by another team. It is safe to ventilate through and you should not travel it because it will waste a lot of your oxygen.

PROBLEM

- THERE IS A 90 MINUTE TIME LIMIT AND YOU WILL RECEIVE A 10 MINUTE WARNING
- THE FAN IS OFF BUT CAN BE STARTED IF NEEDED. IT IS AN EXHAUST FAN AND ONCE STARTED IT CAN NOT BE STOPPED OR REVERSED.
- DO NOT USE THE SUPPLY SLOPE FOR TRAVEL IN AND OUT OF THE MINE

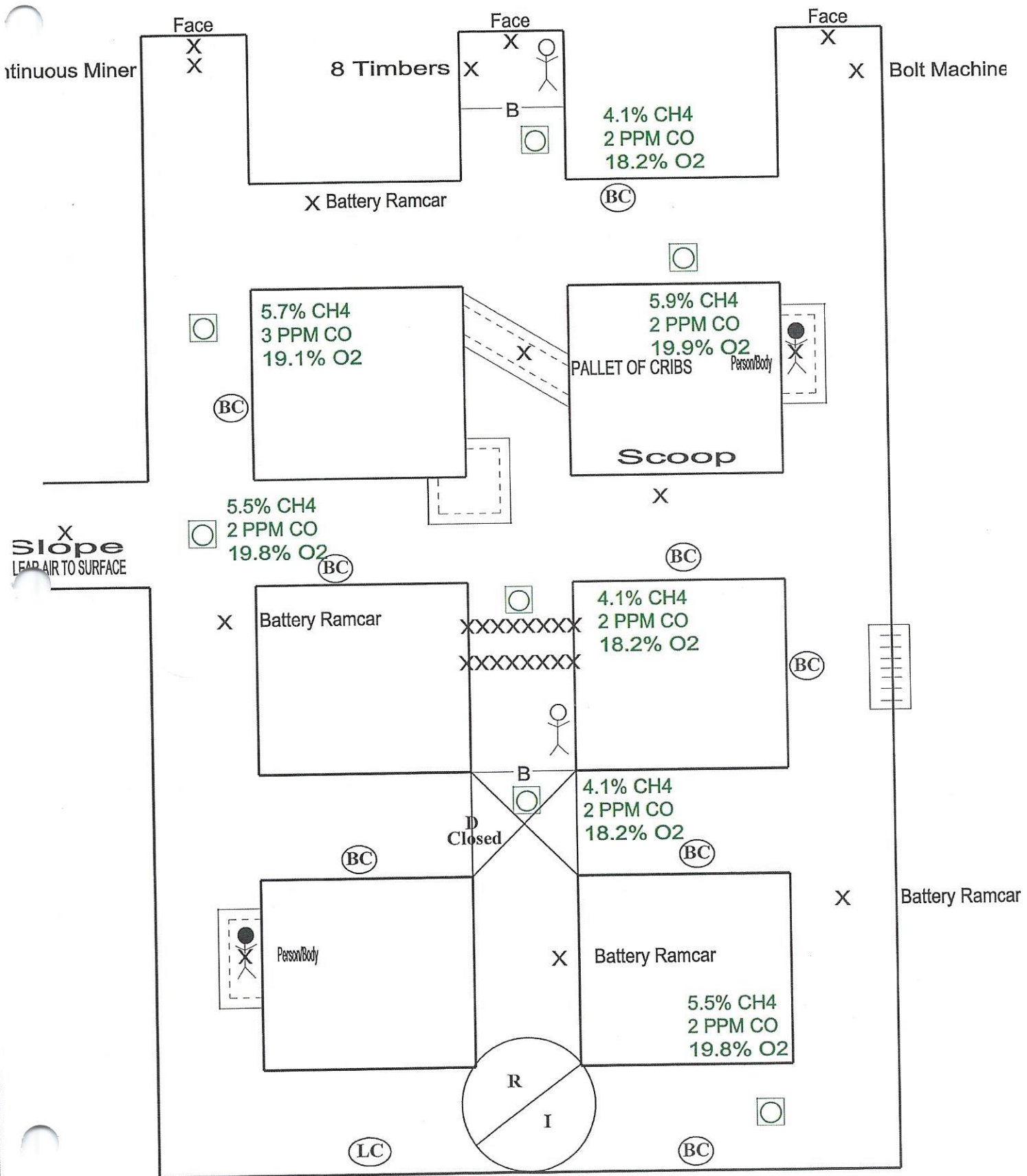

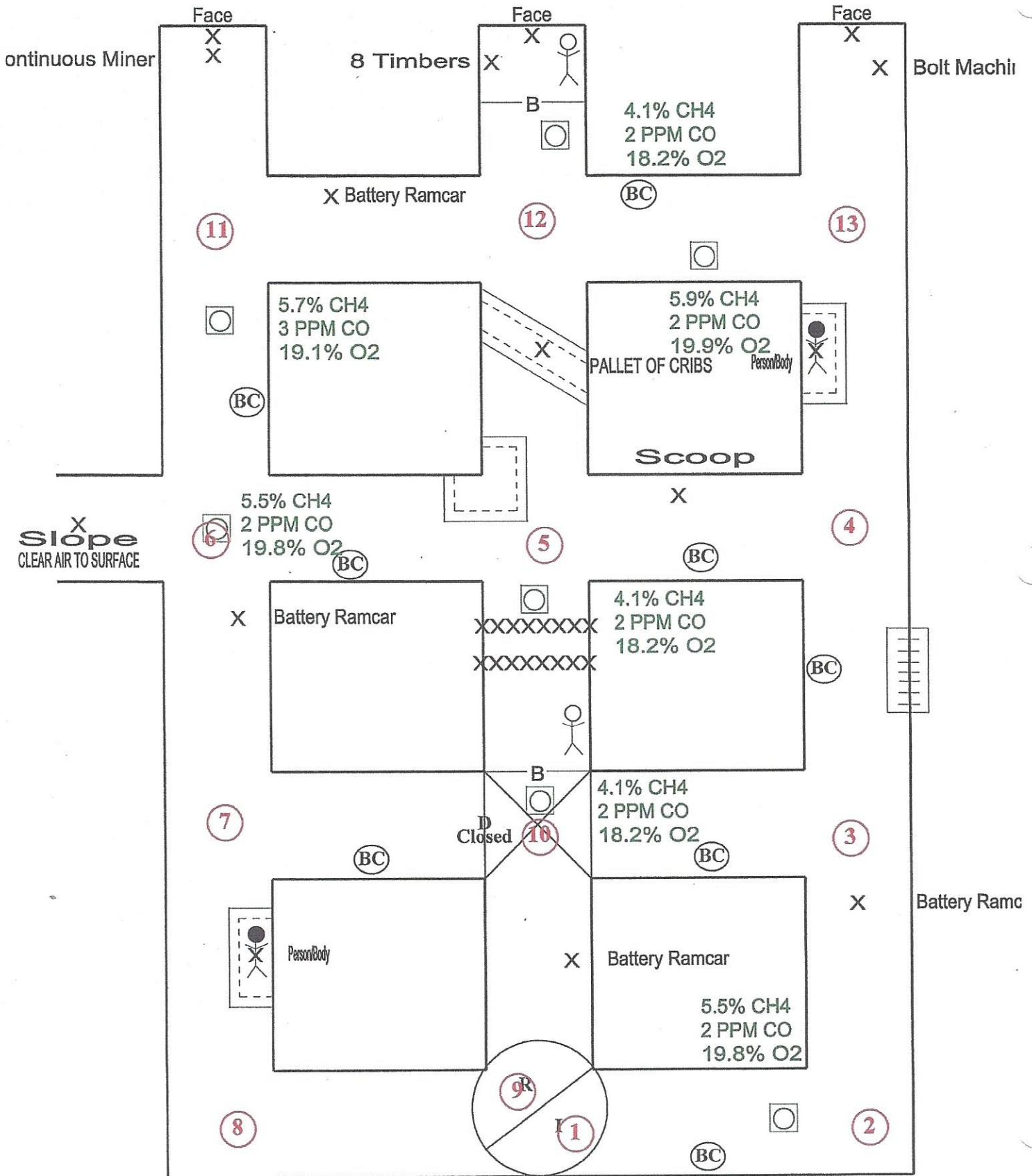

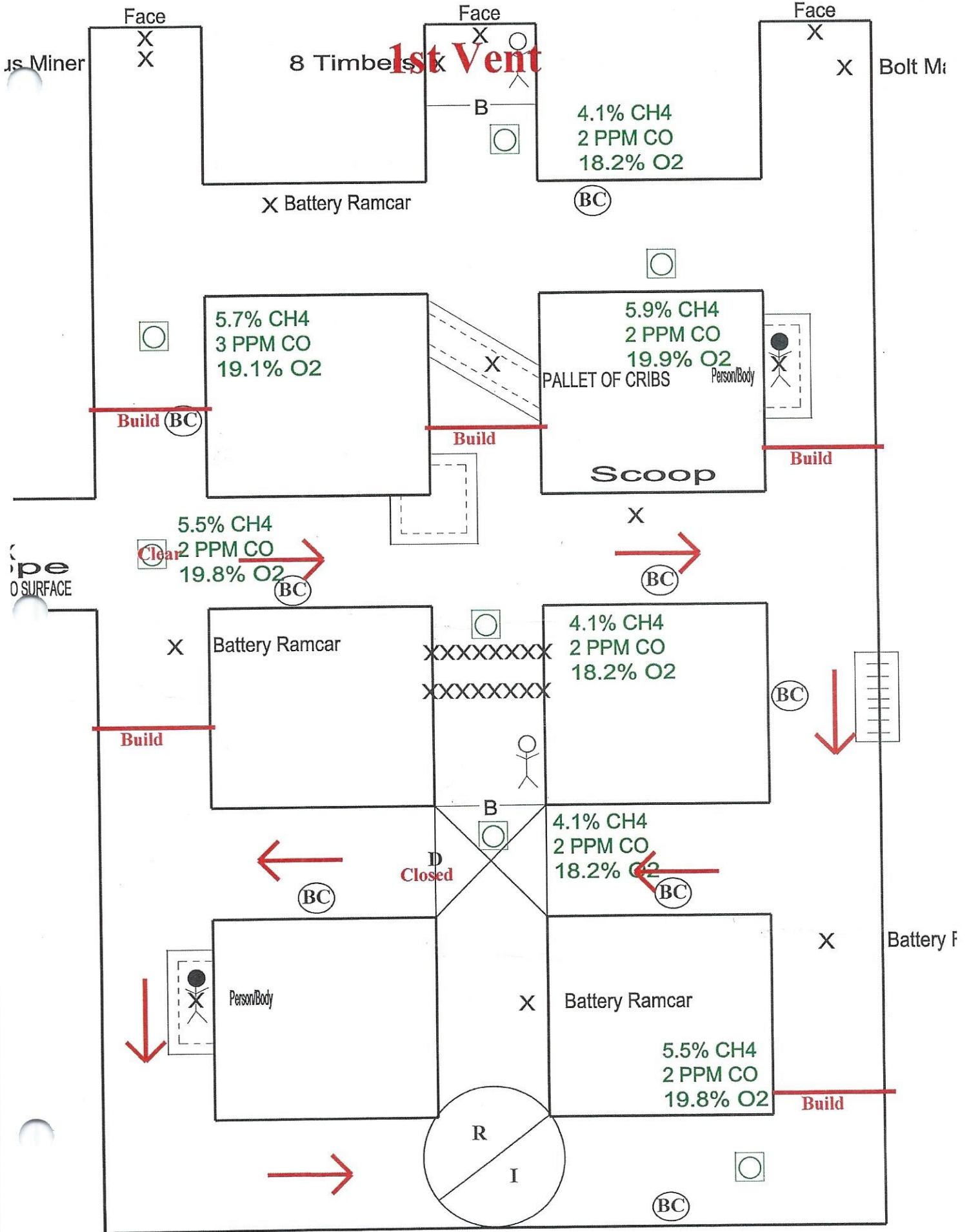

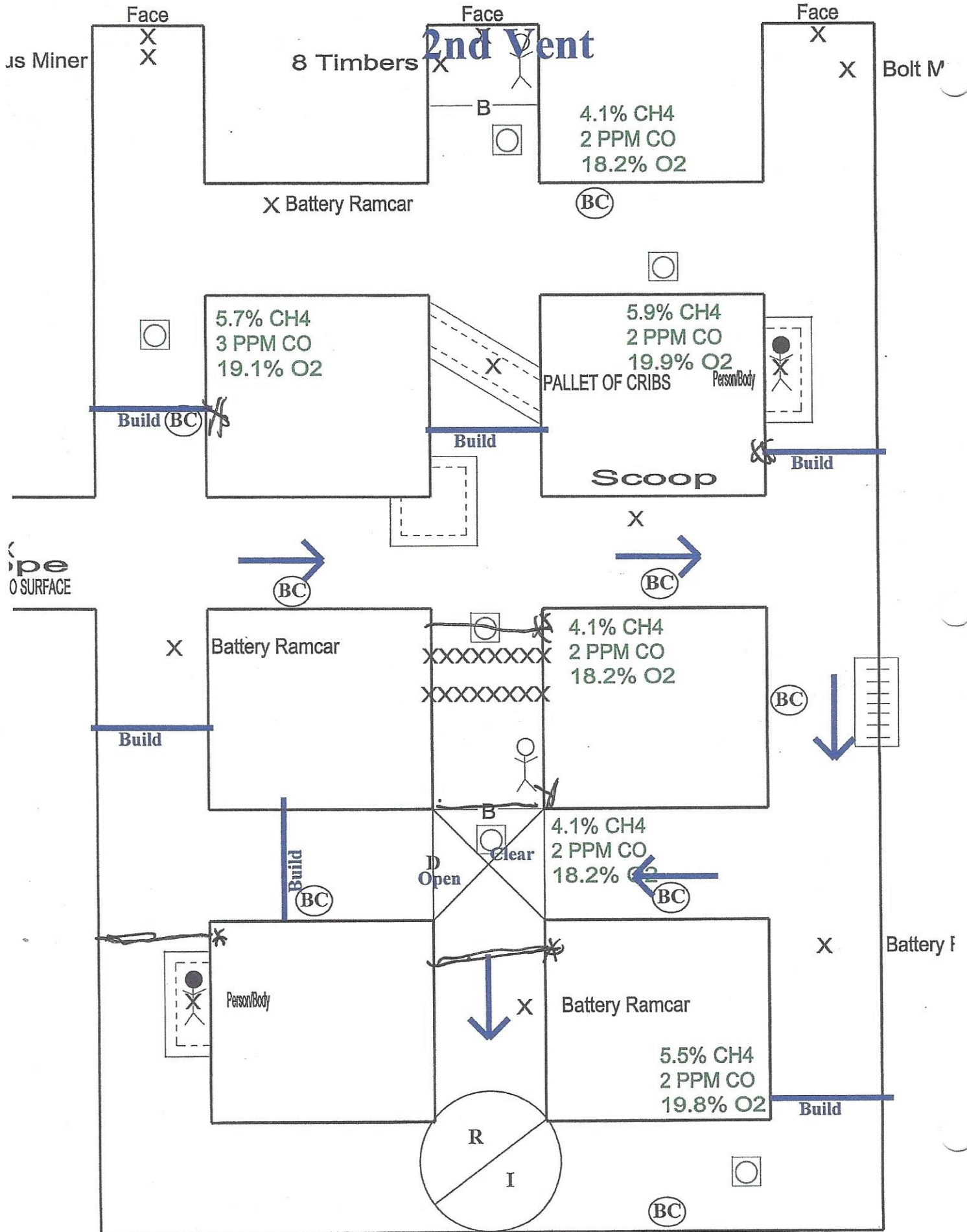

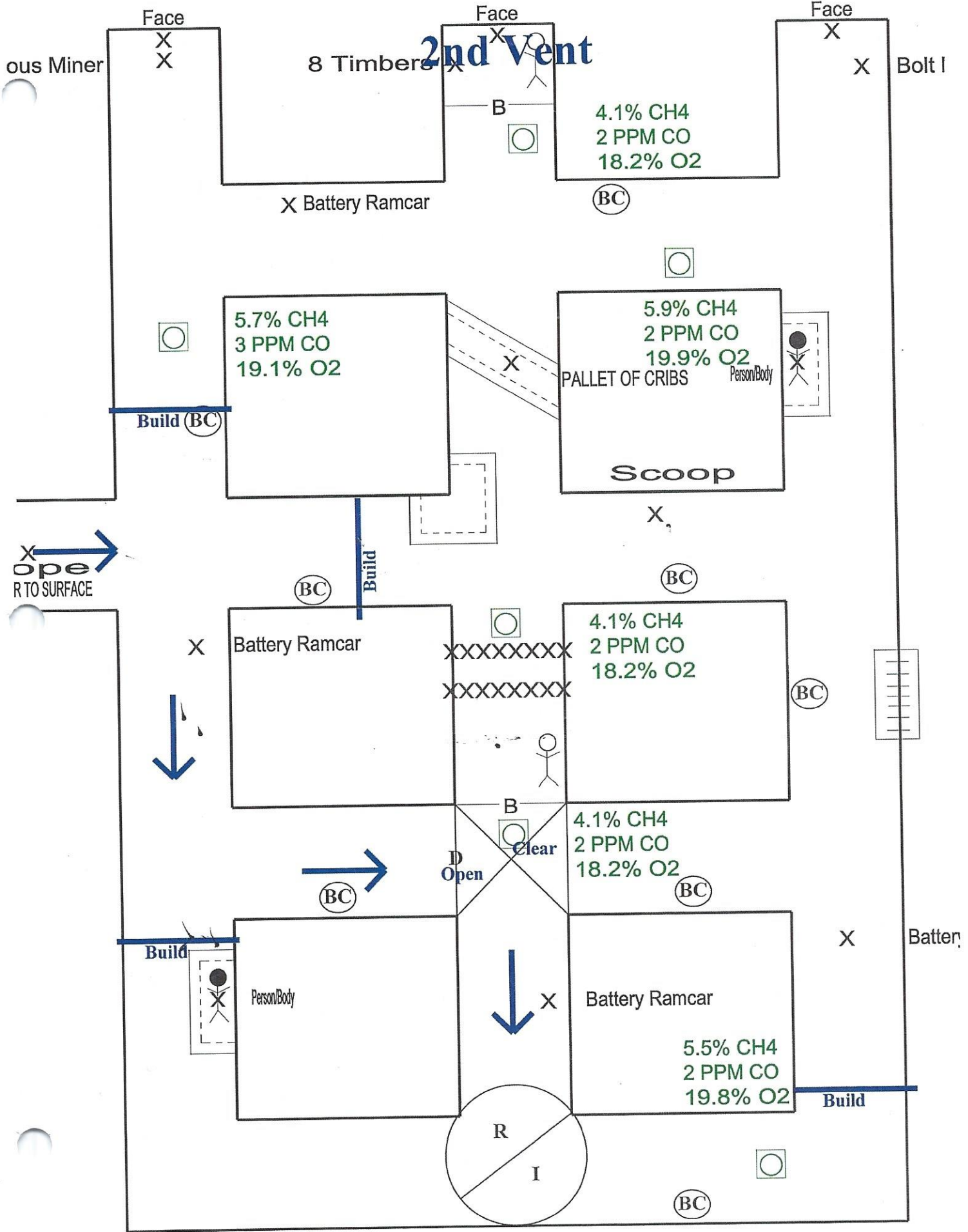

ous Miner

Face

Face

Face

8 Timbers

2nd Vent

Bolt I

4.1% CH4
2 PPM CO
18.2% O2

X Battery Ramcar

(BC)

5.7% CH4
3 PPM CO
19.1% O2

5.9% CH4
2 PPM CO
19.9% O2

PALLET OF CRIBS

Person/Body

Scoop

Build (BC)

Build

(BC)

(BC)

X
ope
R TO SURFACE

X Battery Ramcar

4.1% CH4
2 PPM CO
18.2% O2

(BC)



XXXXXXXXXX
XXXXXXXXXX



B
Clear

4.1% CH4
2 PPM CO
18.2% O2

(BC)

(BC)

D
Open

Build

Person/Body

Battery Ramcar

X Batter

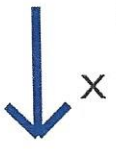

5.5% CH4
2 PPM CO
19.8% O2

Build

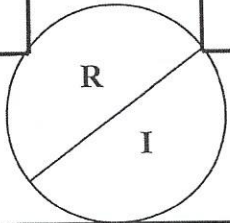

(BC)

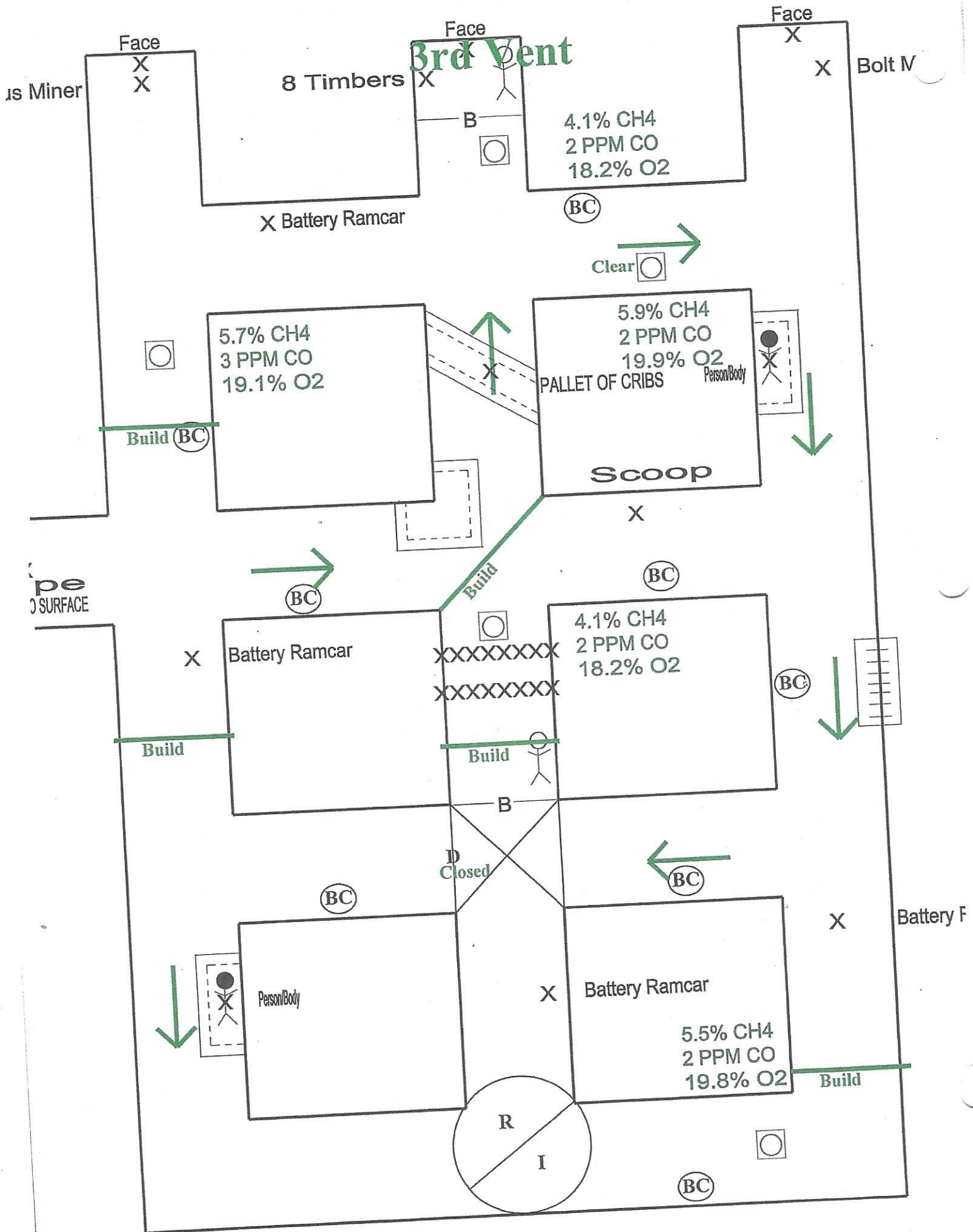

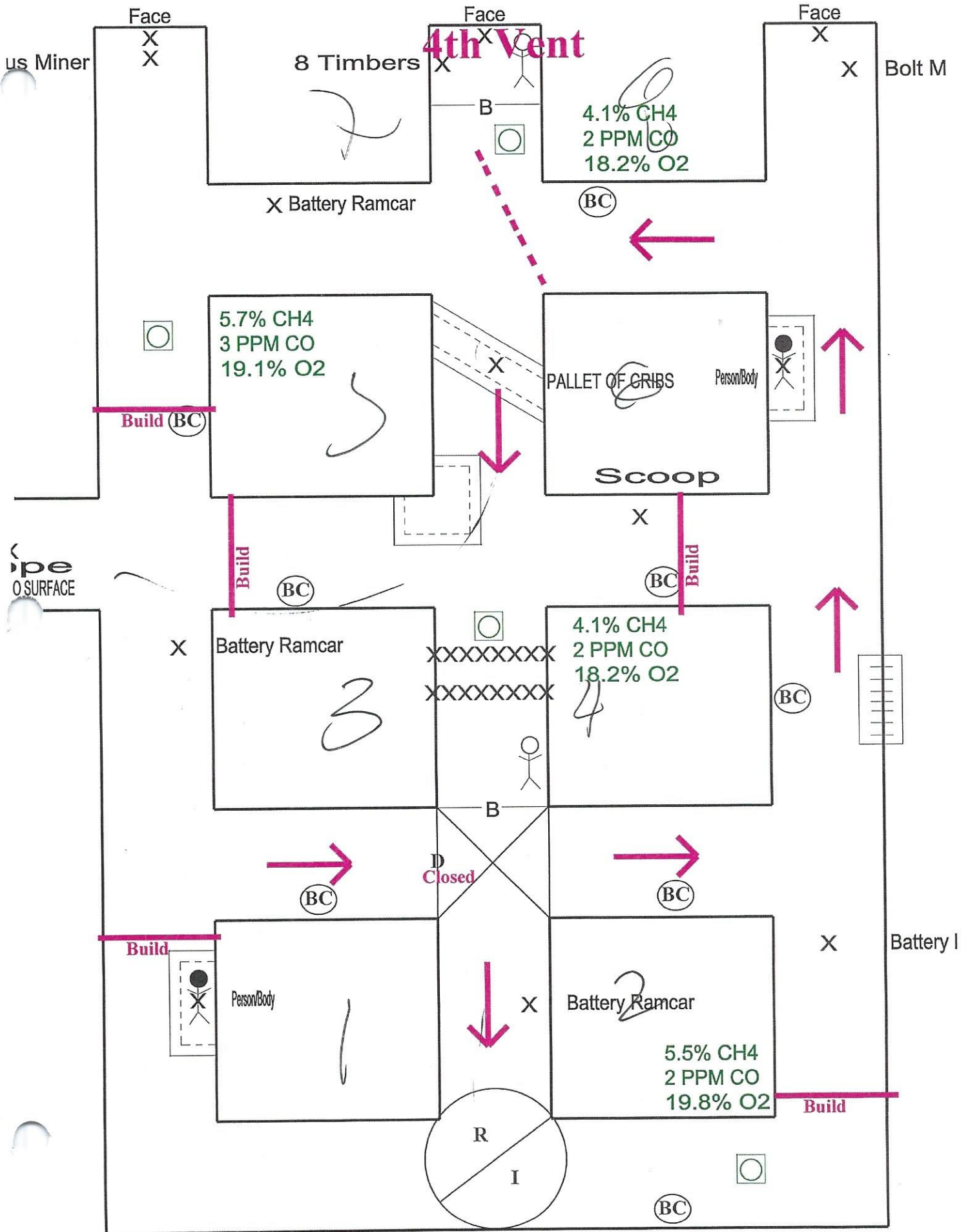

Final Vent Map

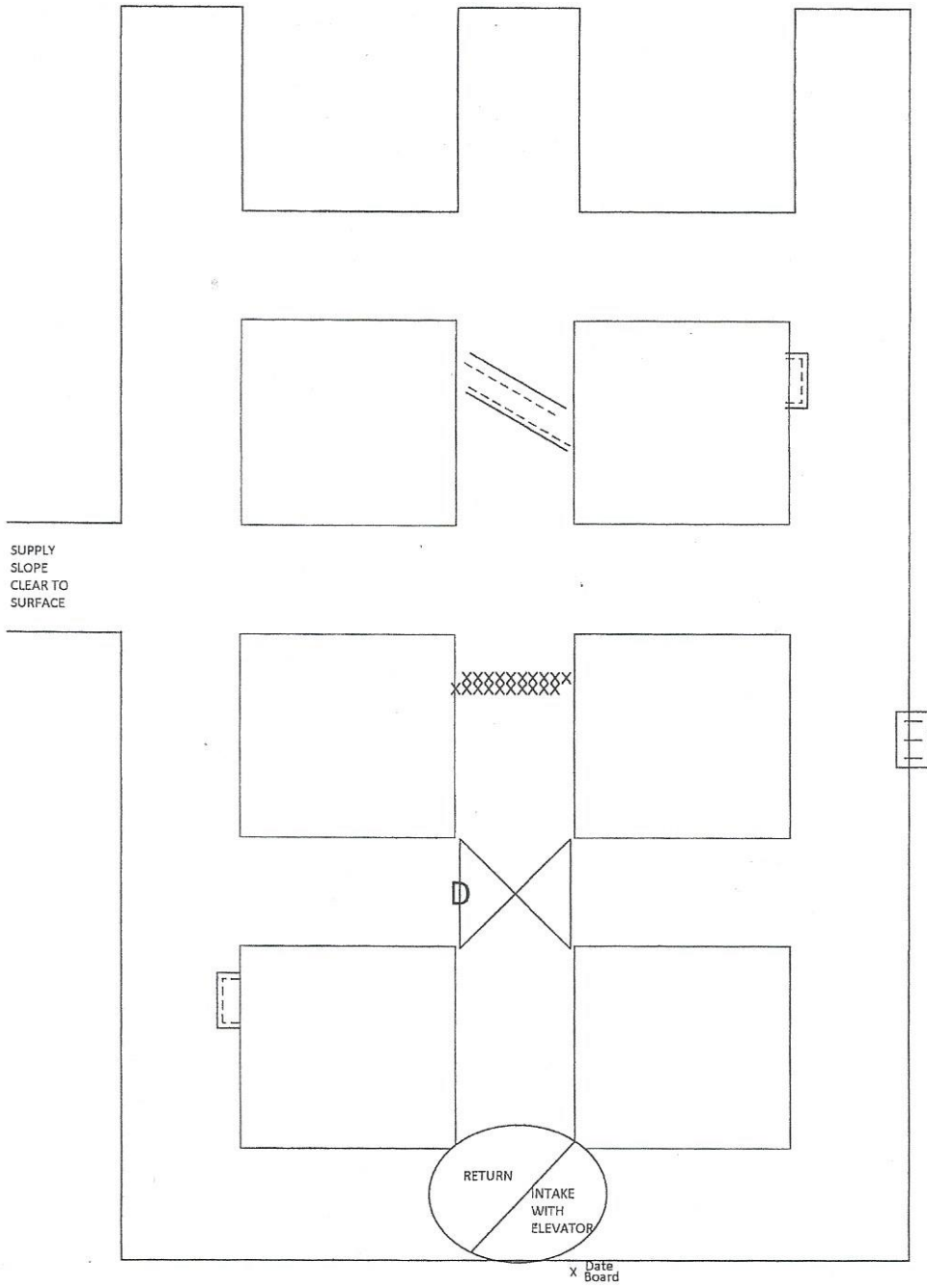

*Remember to mark overcast door open or closed

Captain's initials _____

Team # _____