

Entry 1

Entry 2

Entry 3

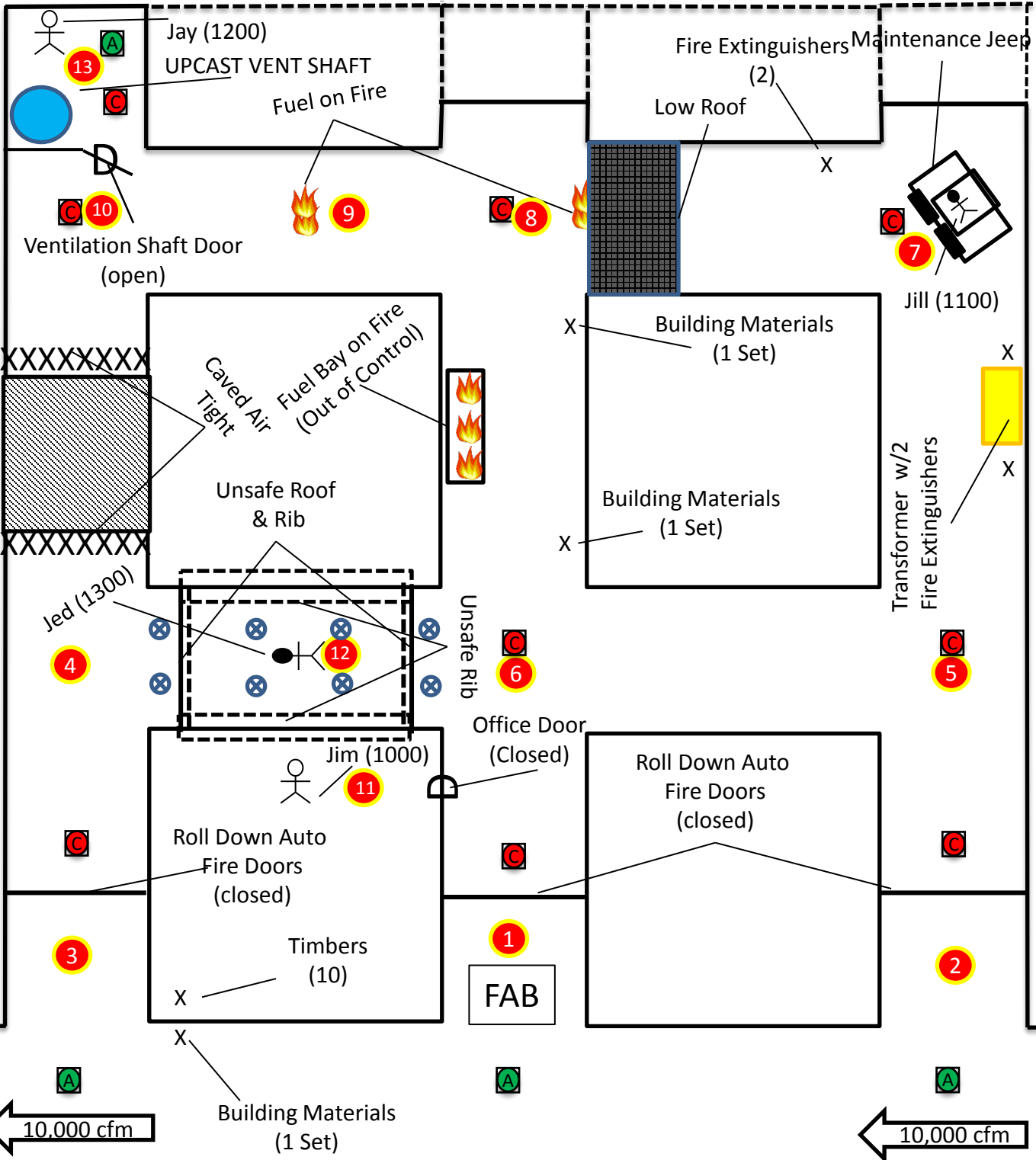

Solution Map



GAS PLACARD KEY

- A** = Clear air
- B** = 17.5 % O₂
CO - 1400 ppm
CH₄ - 0%
Light Smoke
- C** = 16 % O₂
CO - 4500 ppm
CH₄ - 0%
Heavy Smoke

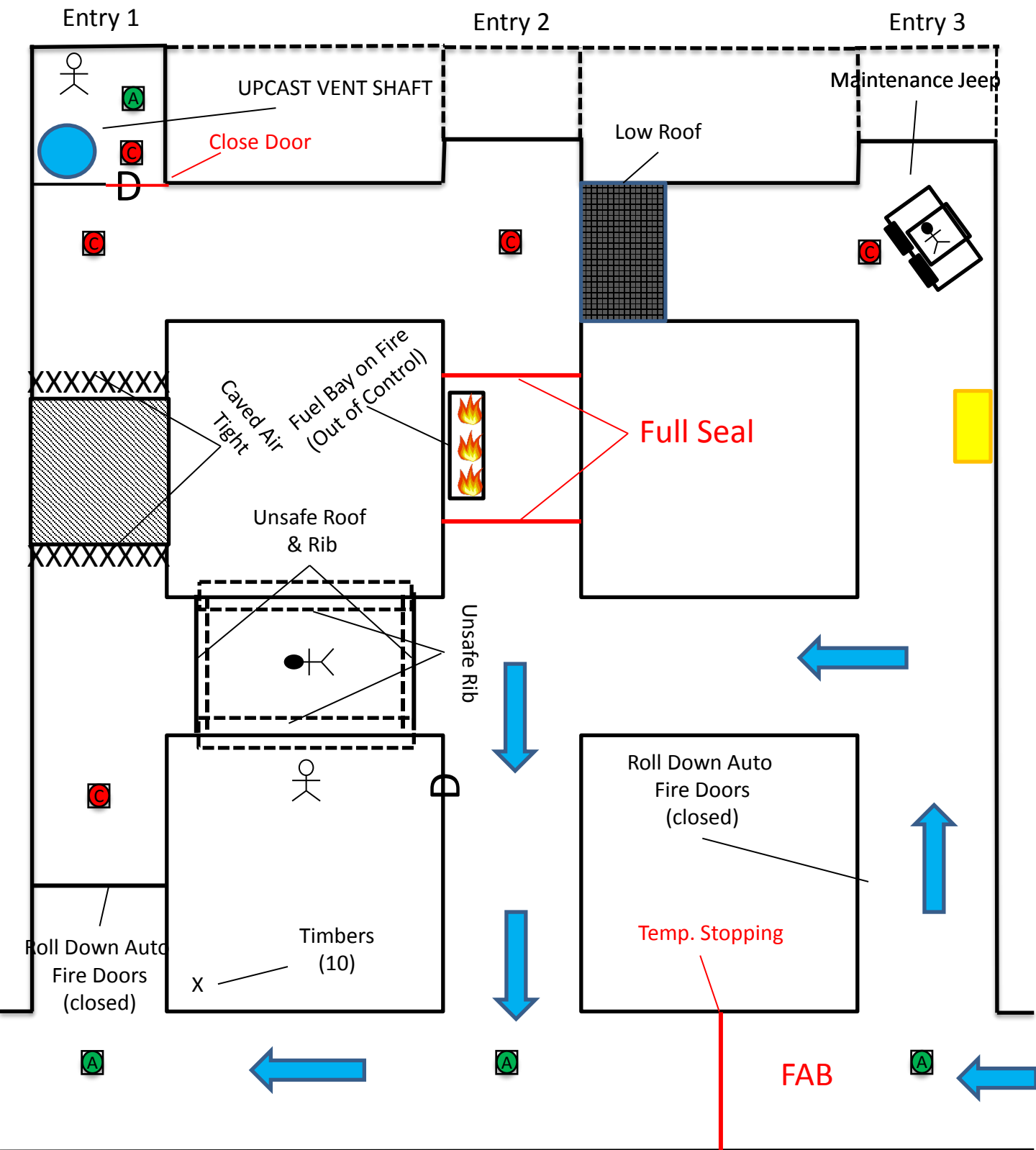

Ventilation Change to clear Office Door

- Convert ¾ seals to full seals
- Close Door at the Vent Raise in Entry #1
- Move FAB to Entry #3 or Entry #1
- Open Fire Door in Entry #2
- Build Temp. Stopping between Entry #3 & #2



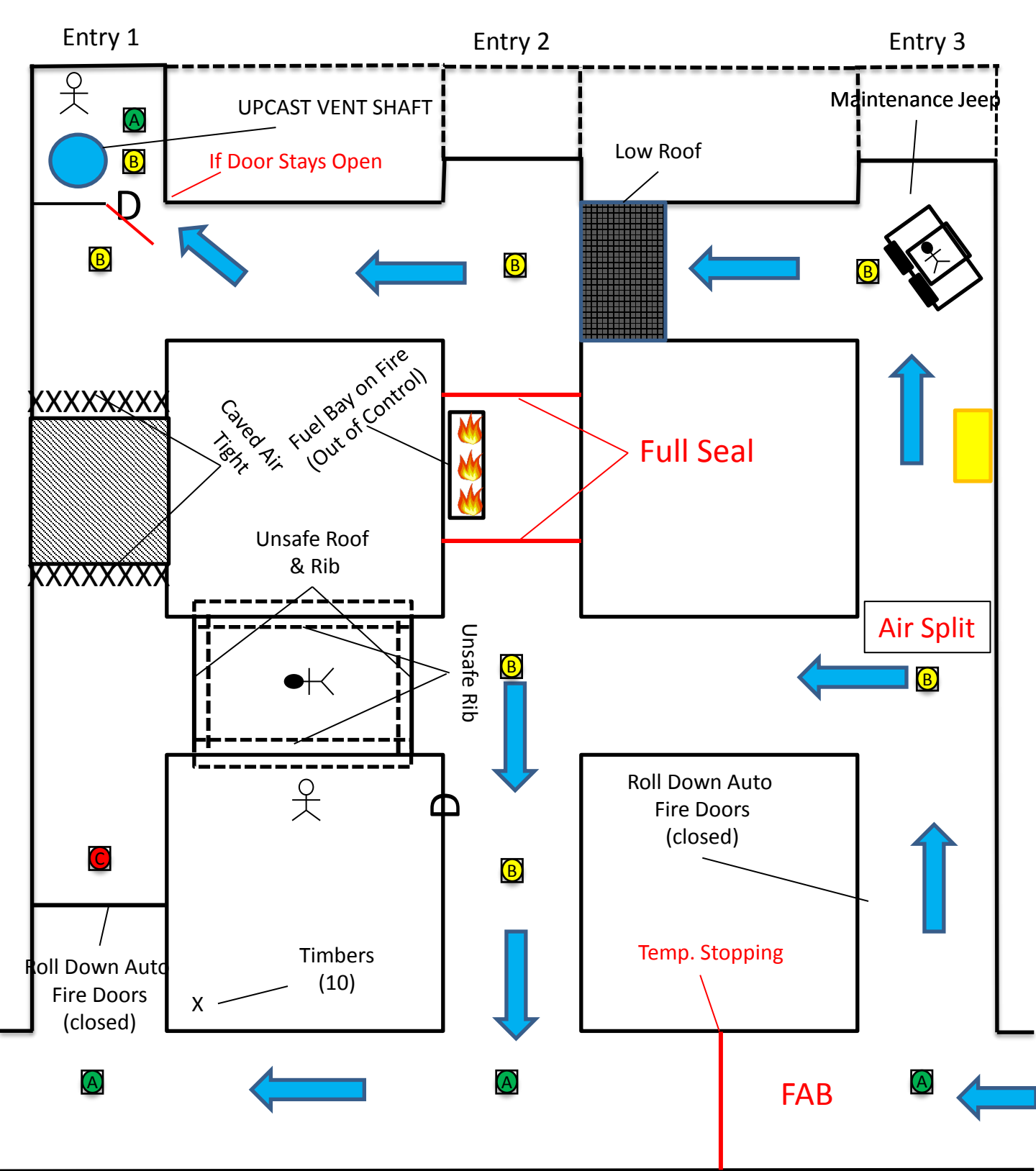

Ventilation Change If Vent Door remains open

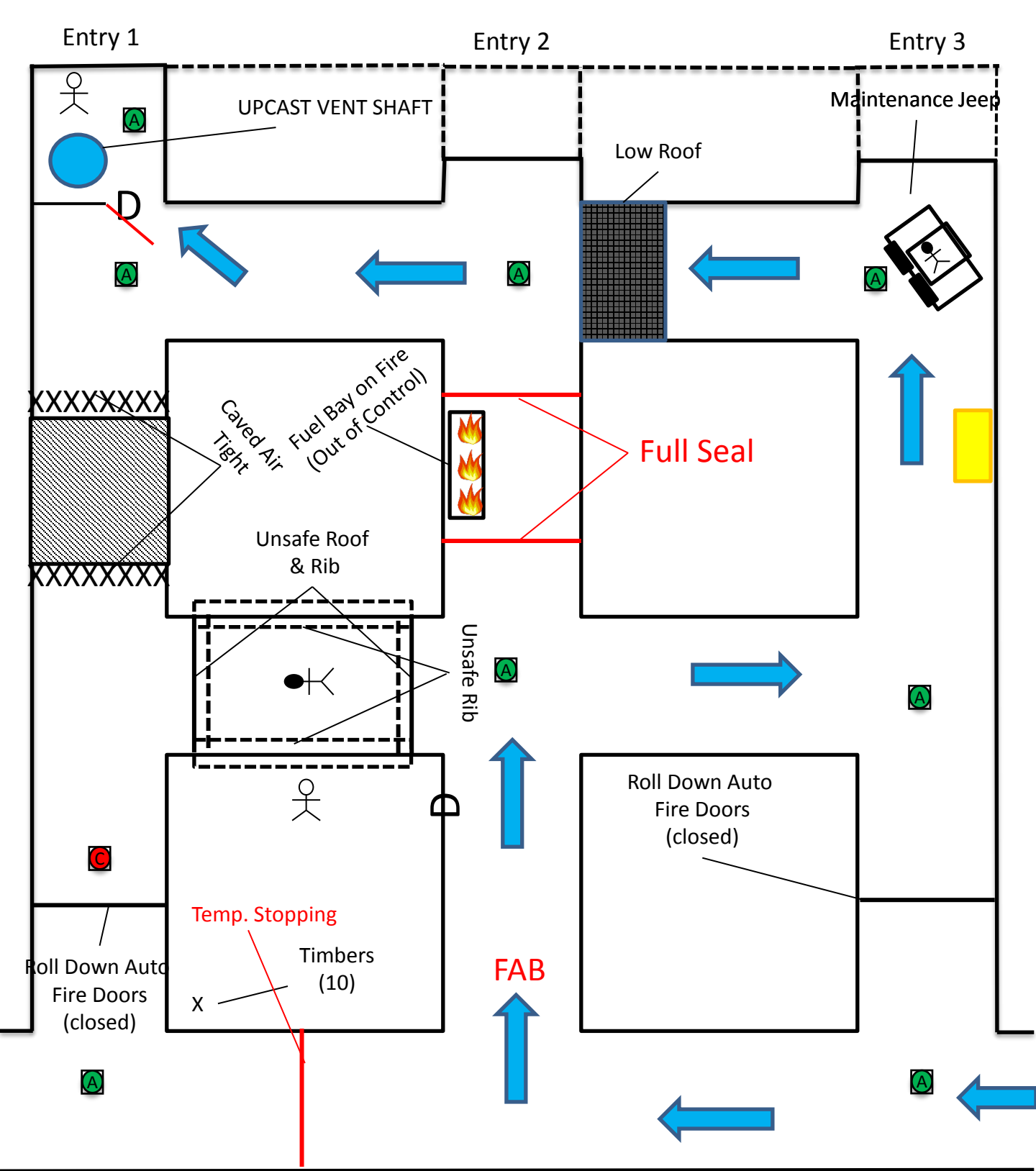

Ventilation Solution possibility #2

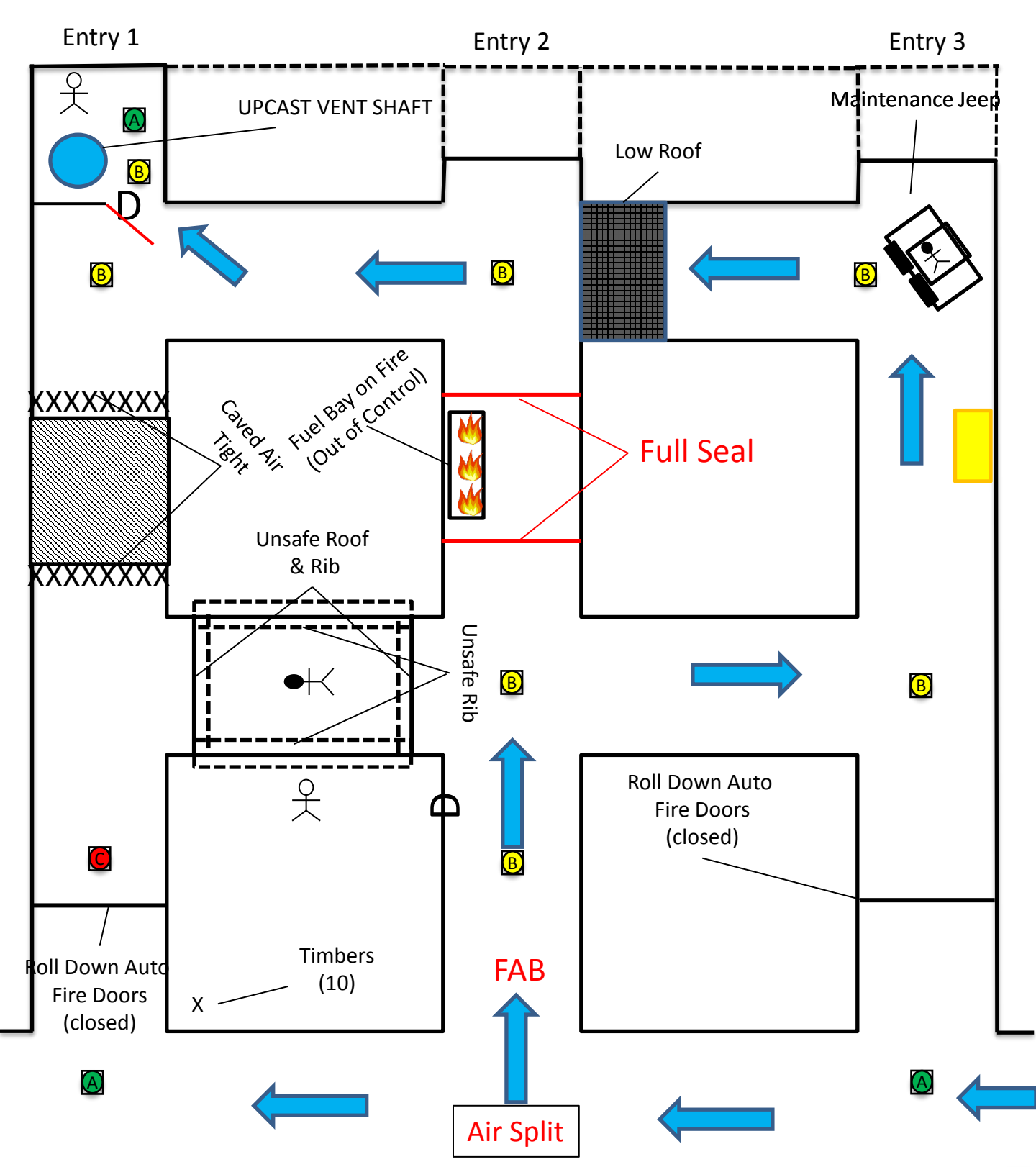

Ventilation Change (Split)

