

# **2015 ILLINOIS STATE Mine Rescue Contest Statement**

I am \_\_\_\_\_ , Superintendent of the Lucky 7 Mine. You are located in the fresh air base of the mine. Last night an eight (8) man crew entered the mine and proceeded to the Main West Unit to perform mining activities. At 6:00a.m., this morning a miner called out of the unit and said they were experiencing problems. The phone went dead soon after the call, and no contact has been established with the miners since the call. At 6:30 a.m., 3 miners came out of the mine. The miners who came out said they could not find the other miners and had no contact with them.

This Main West Section has experienced bad roof conditions, water problems, and high concentrations of methane gas. All power going into the mine has been deenergized and locked out.

The Mine is ventilated by a blowing fan that is running. The fan can be stopped, but once stopped cannot be restarted. The fan cannot be reversed, or stalled out.

The mine map is up to date.

All proper authorities have been notified, a command center has been established on the surface, and back-up mine rescue teams are standing by if needed.

This is all the information we have available at this time.

**2015 ILLINOIS STATE  
Mine Rescue Contest**

**(WRITTEN INSTRUCTIONS)**

**EXPLORE THE MINE IN ITS ENTIRETY WHERE  
SAFE TO DO SO.**

**ACCOUNT FOR ALL MISSING PERSONS AND  
BRING ALL SURVIVORS TO THE FRESH AIR  
BASE.**

**THE TEAM MAY NOT CARRY MORE THAN TWO  
(2) BRATTICE CURTAINS AT ANY ONE TIME.**

**THE MINE FAN CAN BE STOPPED, BUT ONCE  
STOPPED CANNOT BE RESTARTED. THE MINE  
FAN CANNOT BE REVERSED, OR STALLED.**

**THE MINE MAP IS UP TO DATE.**

**2015 Illinois State  
Mine Rescue Contest**

**PATIENT IN**

**RA**

**HELP, HELP, GET ME  
OUT.**

**2015 Illinois State  
Mine Rescue Contest**

**PATIENT BEHIND  
BARRICADE**

**HELP, HELP, GET ME  
OUT.**

**THE AIR IS CLEAR**

**IT IS AIRTIGHT BEHIND  
ME.**

2015 ILLINOIS STATE  
Mine Rescue Contest

Patient Statement  
Barricade No. 1 Entry

Help! Help! Get Me Out.

There is a face behind me and it is  
airtight.

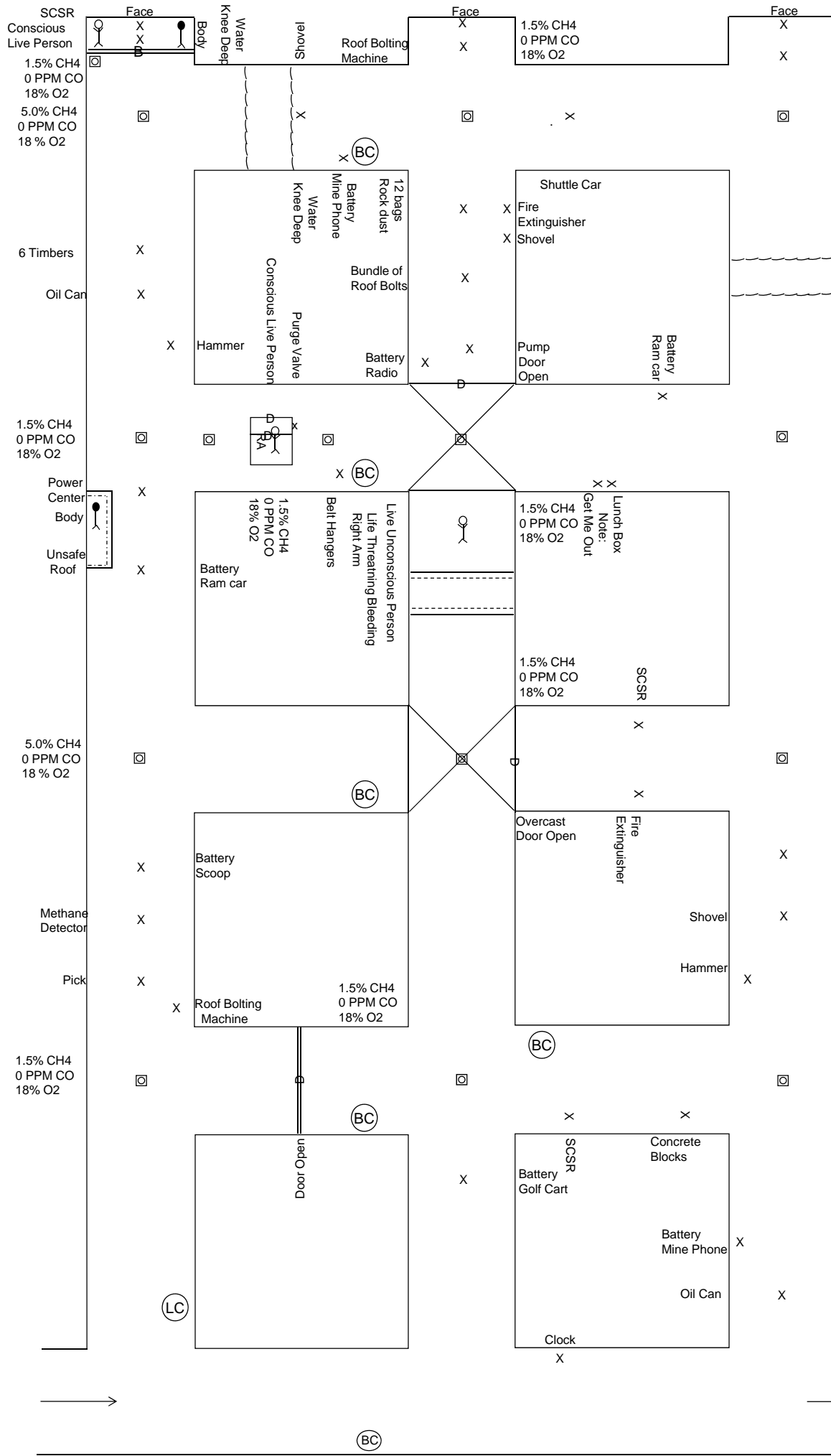

# 2015 Illinois Mine Rescue Contest

TEAM NO. \_\_\_\_\_  
 FIELD NO. \_\_\_\_\_  
 SCALE 1" = 10'

1.5% CH4  
 0 PPM CO  
 18% O2  
 Continuous Mining Machine  
 1.5% CH4  
 0 PPM CO  
 18% O2  
 Water Knee Deep  
 Water Knee Deep  
 1.5% CH4  
 0 PPM CO  
 18% O2  
 5.0% CH4  
 0 PPM CO  
 18% O2  
 Battery Ram car  
 1.5% CH4  
 0 PPM CO  
 18% O2

SCSR  
 Conscious Live Person  
 1.5% CH4  
 0 PPM CO  
 18% O2  
 5.0% CH4  
 0 PPM CO  
 18% O2  
 6 Timbers  
 Oil Can  
 1.5% CH4  
 0 PPM CO  
 18% O2  
 Power Center  
 Body  
 Unsafe Roof  
 5.0% CH4  
 0 PPM CO  
 18% O2  
 Methane Detector  
 Pick  
 1.5% CH4  
 0 PPM CO  
 18% O2

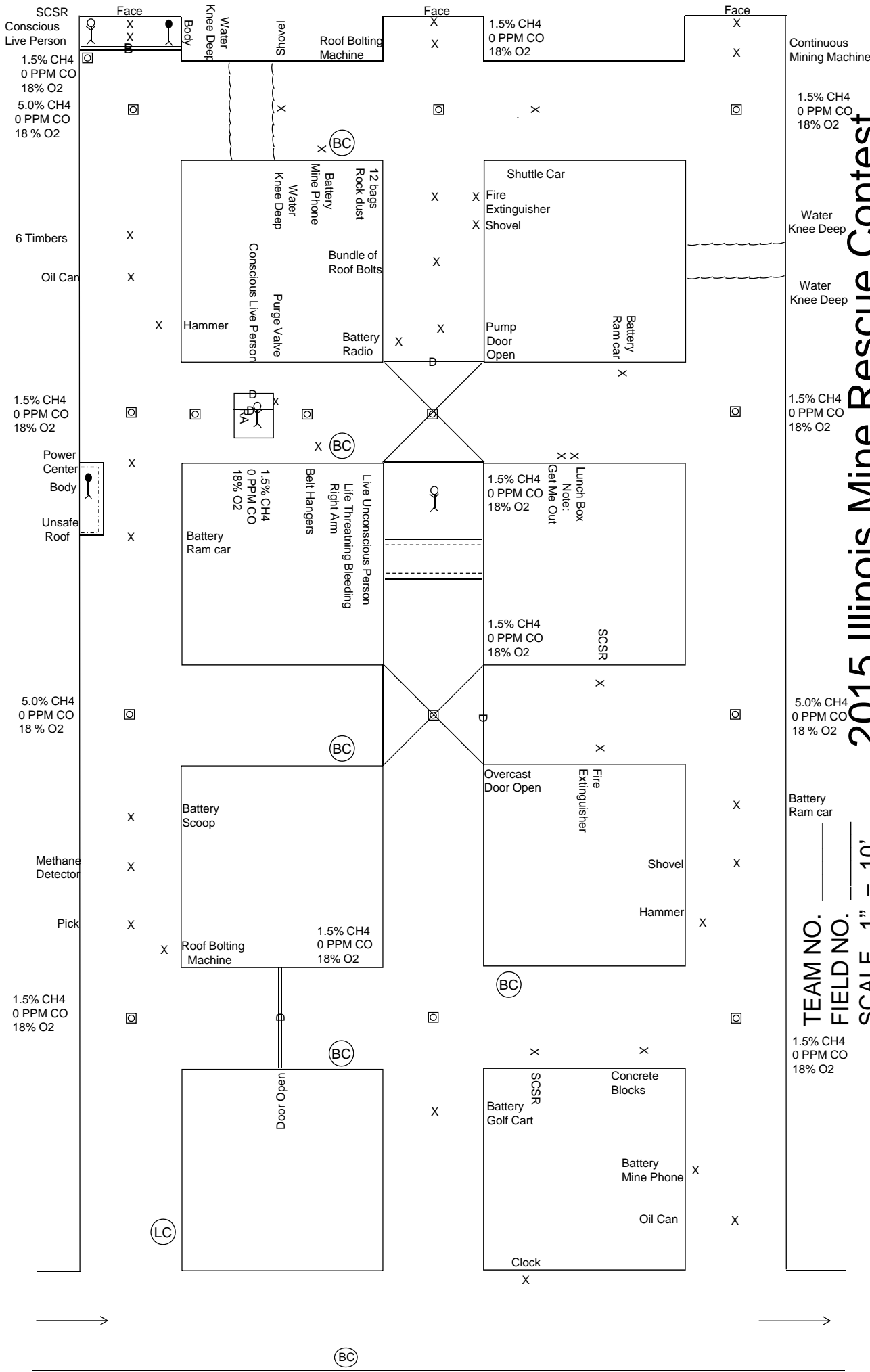

# 2015 Illinois Mine Rescue Contest

TEAM NO. \_\_\_\_\_  
 FIELD NO. \_\_\_\_\_  
 SCALE 1" = 10'

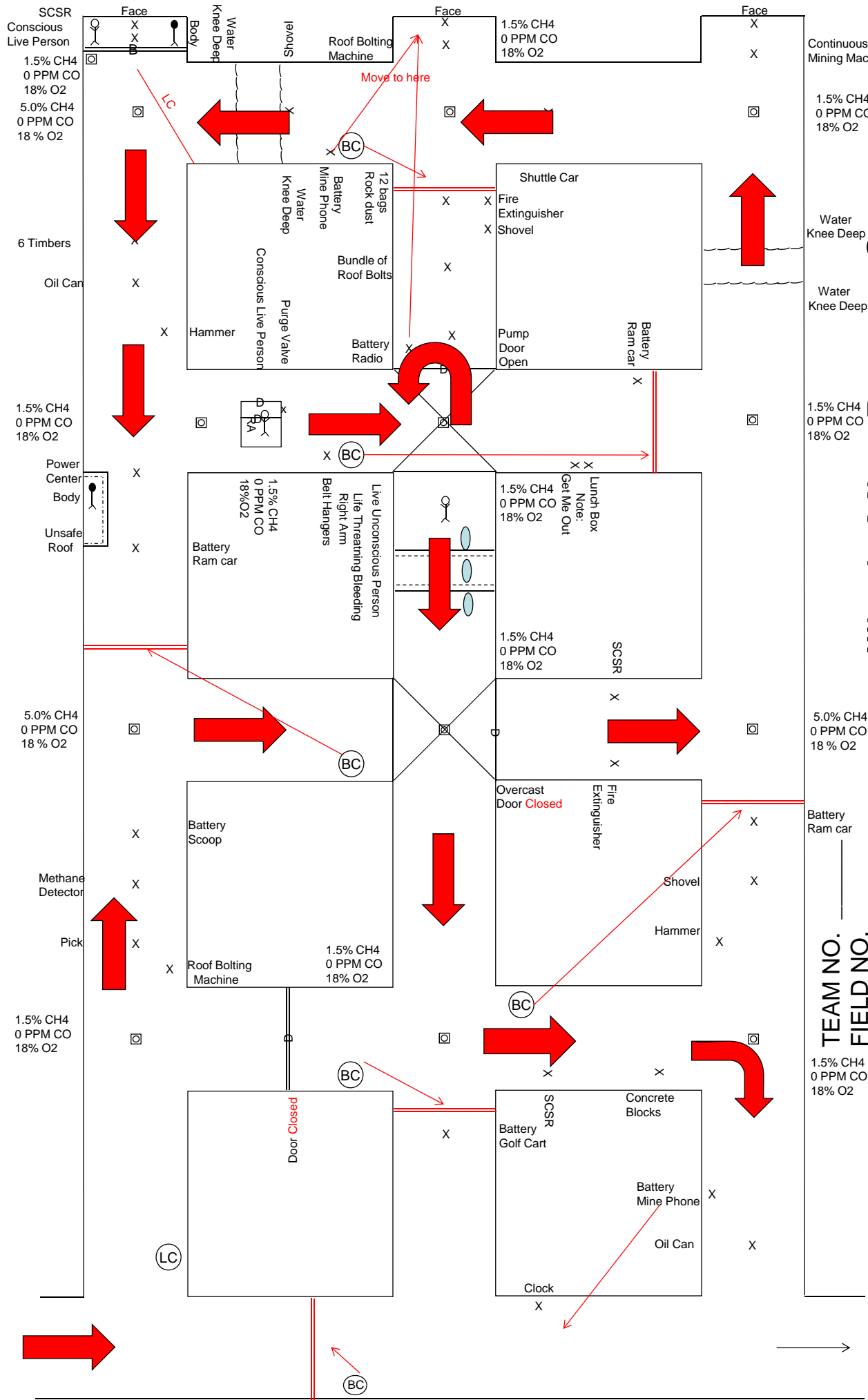

# 2015 Illinois Mine Rescue Contest

TEAM NO. \_\_\_\_\_  
 FIELD NO. \_\_\_\_\_  
 SCALE 1" = 10'





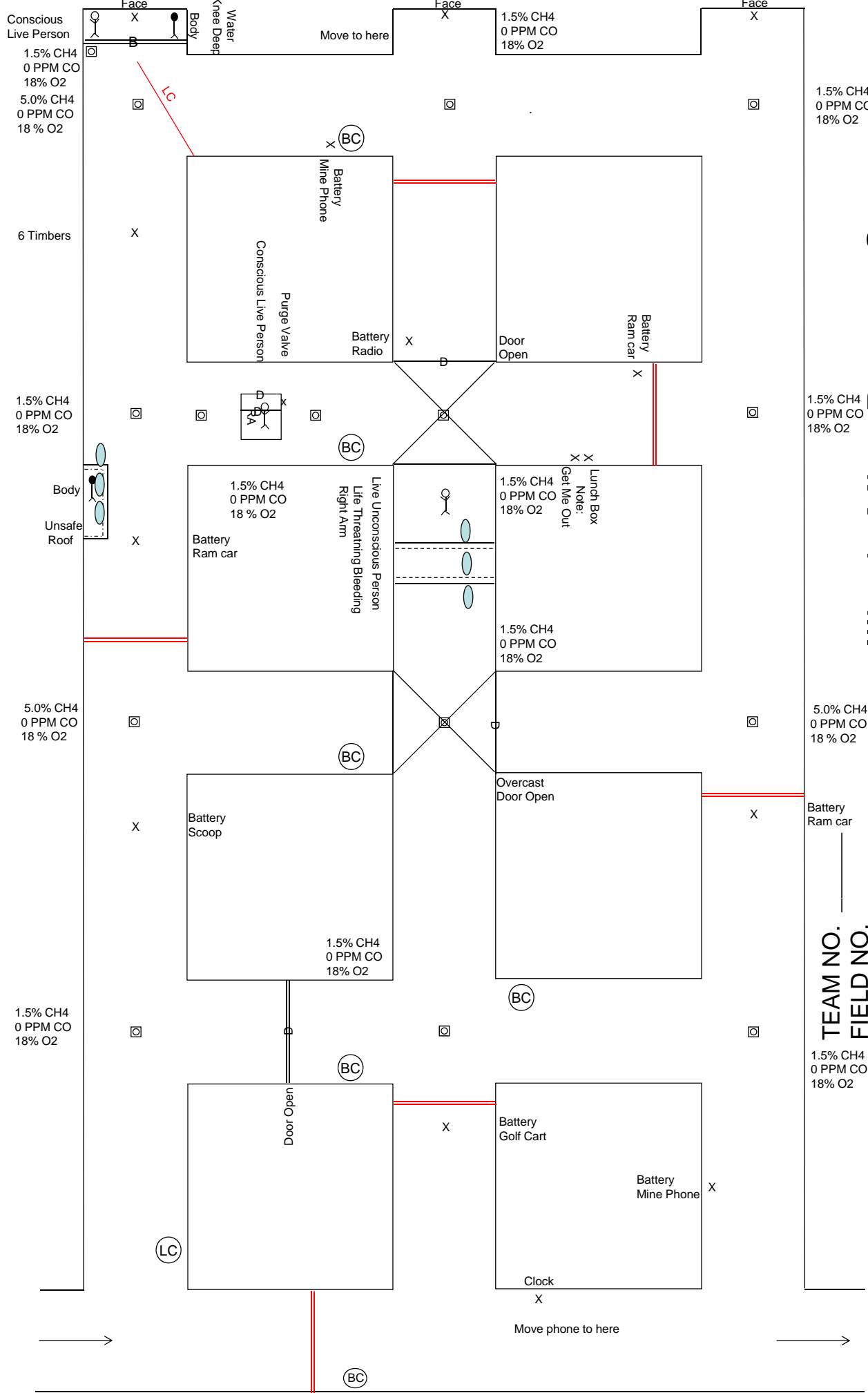

# 2015 Illinois Mine Rescue Contest

TEAM NO. \_\_\_\_\_  
 FIELD NO. \_\_\_\_\_  
 SCALE 1" = 10'

1.5% CH4  
 0 PPM CO  
 18% O2

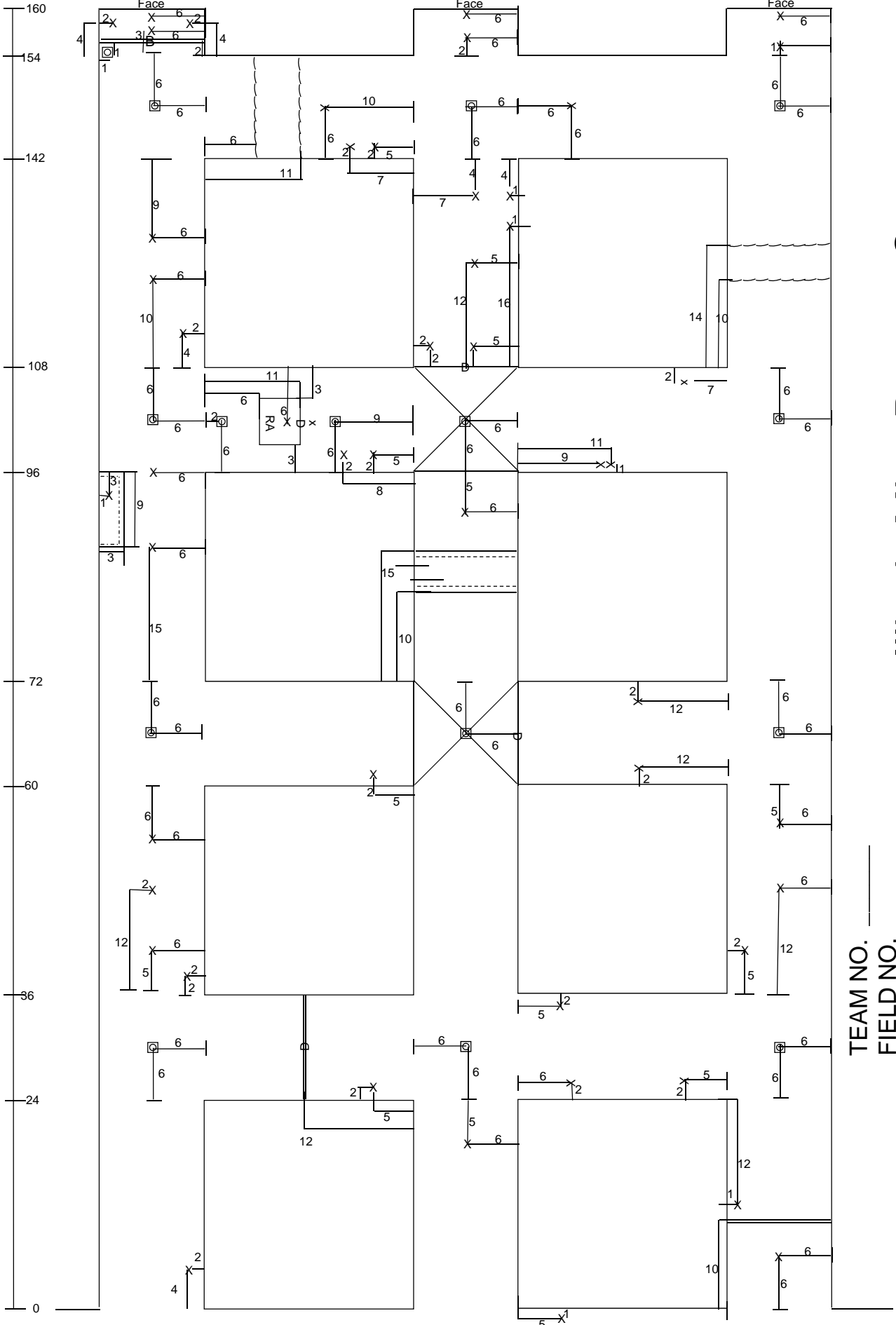

# 2015 Illinois Mine Rescue Contest

TEAM NO. \_\_\_\_\_  
 FIELD NO. \_\_\_\_\_  
 SCALE 1" = 10'

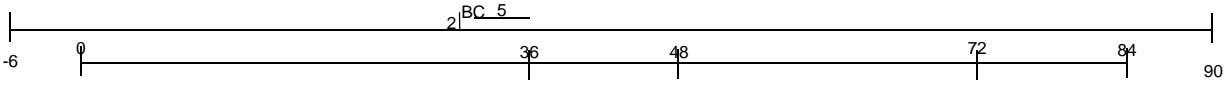

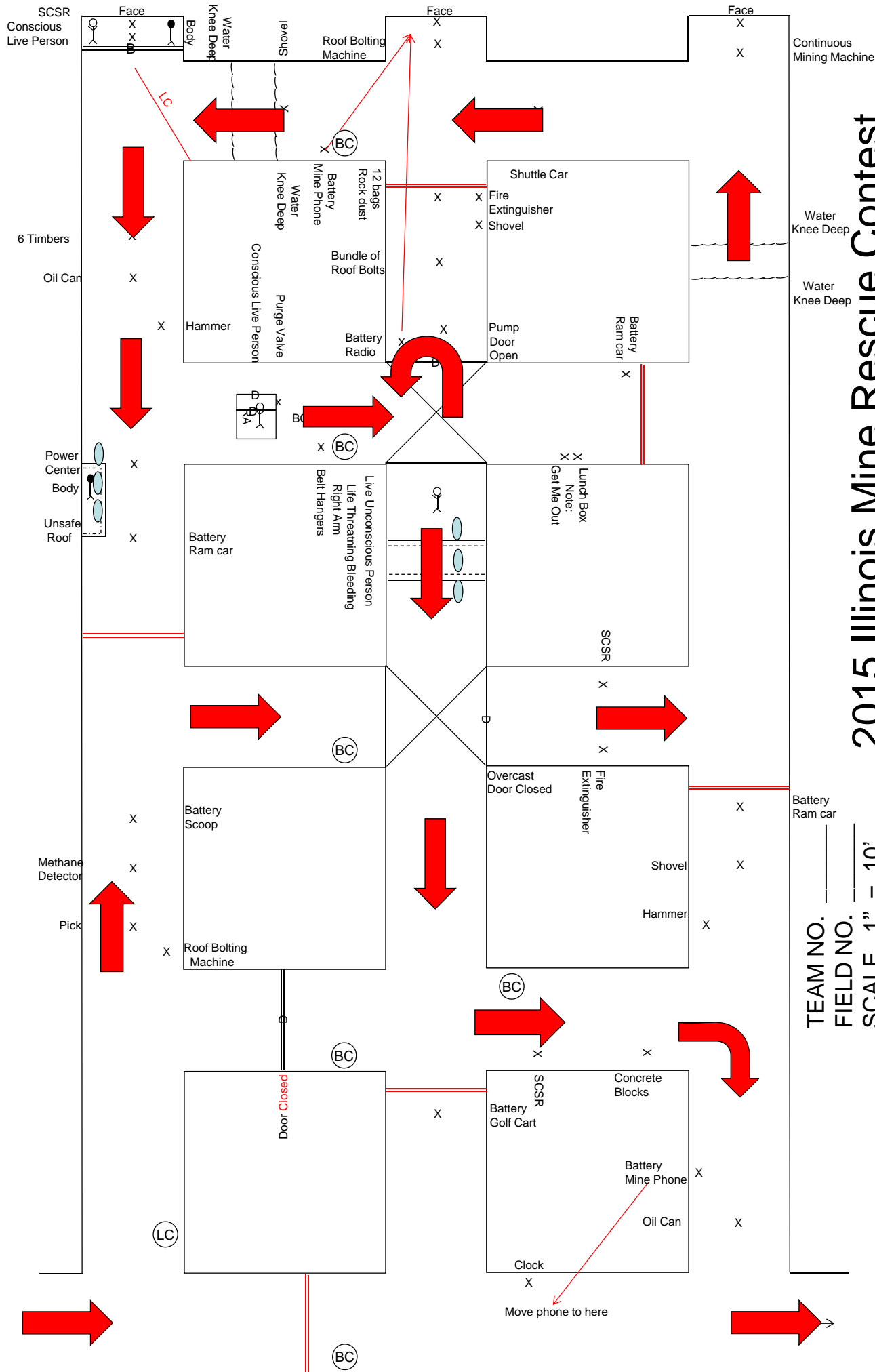

# 2015 Illinois Mine Rescue Contest

TEAM NO. \_\_\_\_\_  
 FIELD NO. \_\_\_\_\_  
 SCALE 1" = 10'

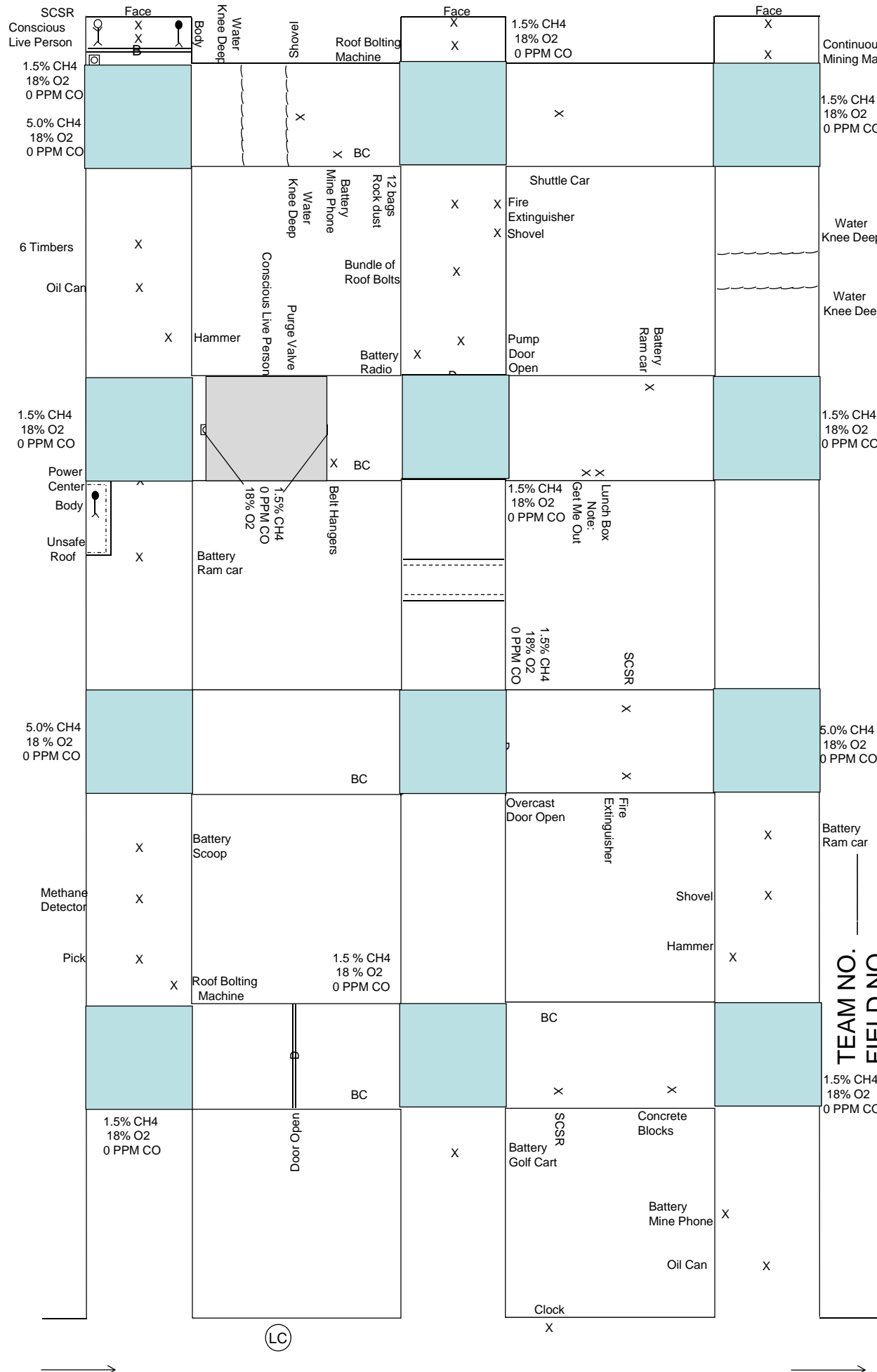

# 2015 Illinois Mine Rescue Contest

TEAM NO. \_\_\_\_\_  
 FIELD NO. \_\_\_\_\_  
 SCALE 1" = 10'

BC

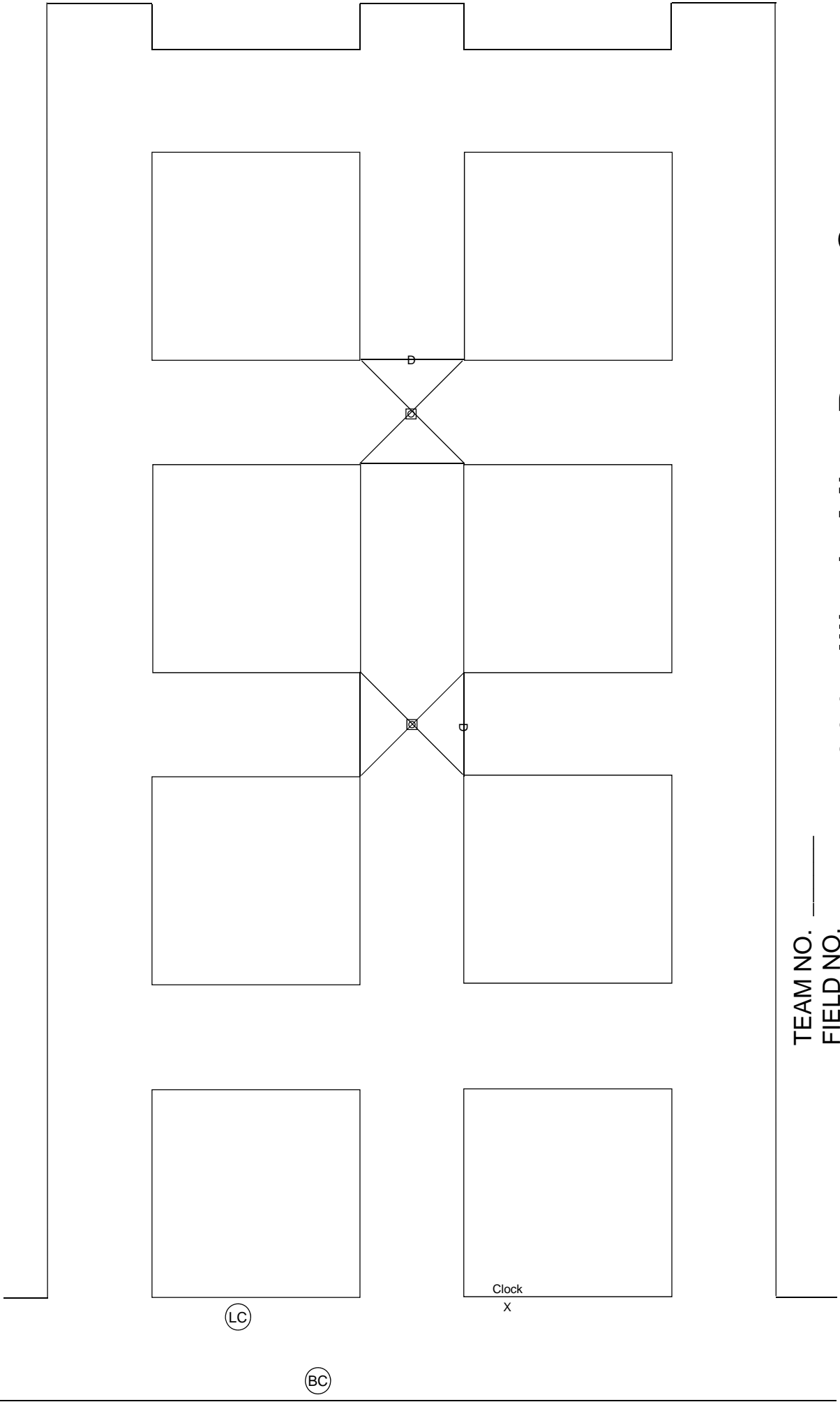

TEAM NO. \_\_\_\_\_  
 FIELD NO. \_\_\_\_\_  
 SCALE 1" = 10'

# 2015 Illinois Mine Rescue Contest

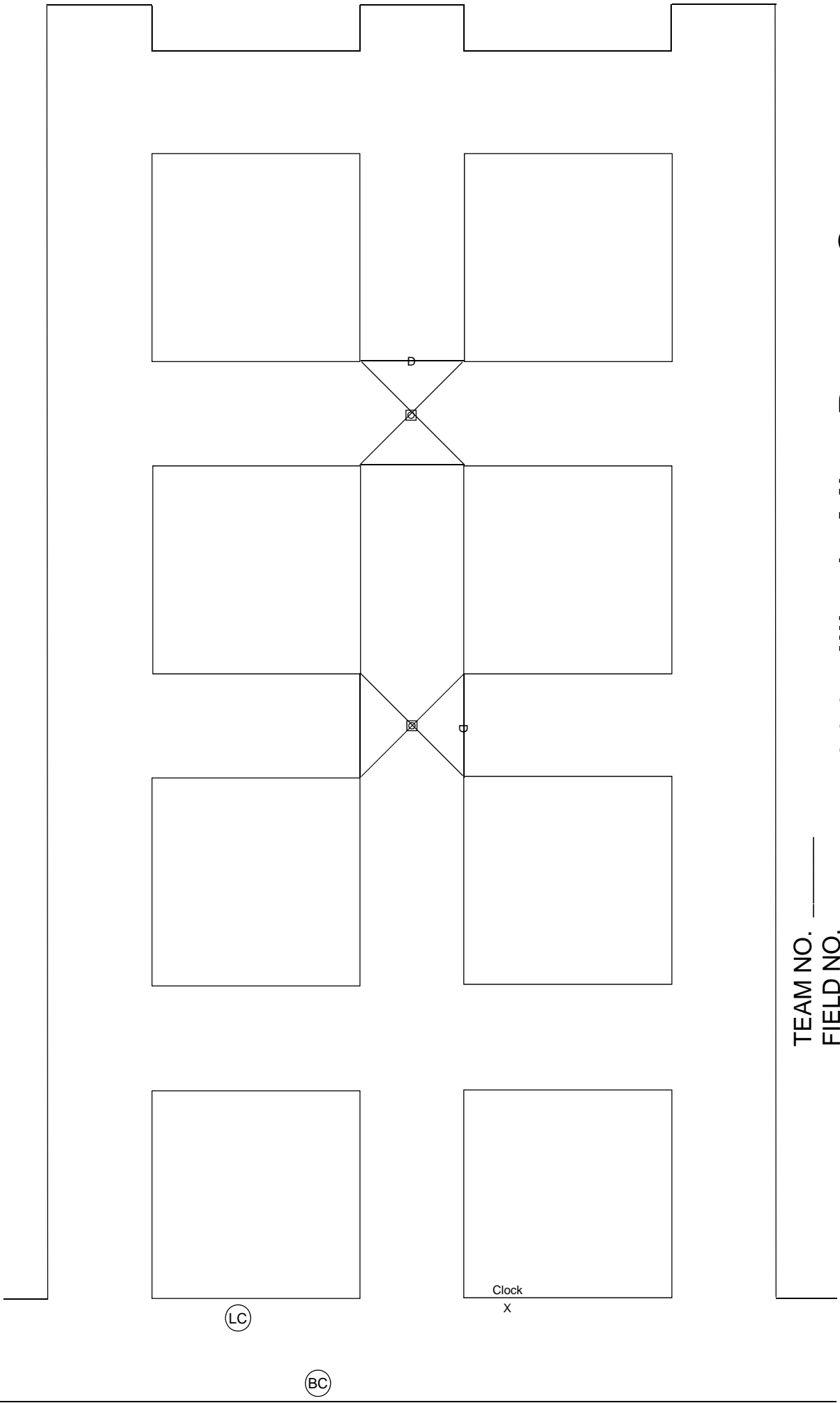

TEAM NO. \_\_\_\_\_  
FIELD NO. \_\_\_\_\_  
SCALE 1" = 10'

# 2015 Illinois Mine Rescue Contest

LC

Clock  
X

BC

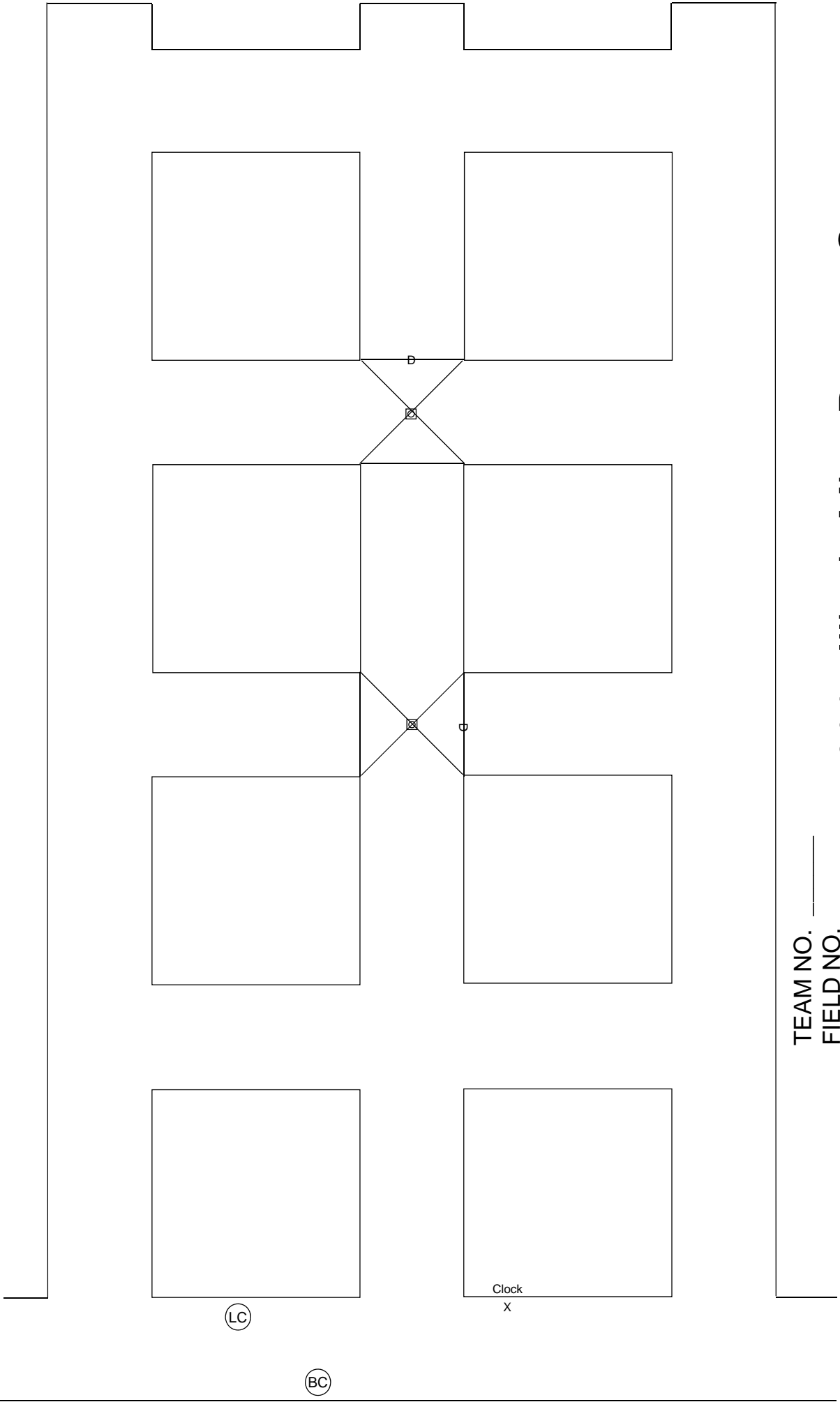

TEAM NO. \_\_\_\_\_  
FIELD NO. \_\_\_\_\_  
SCALE 1" = 10'

# 2015 Illinois Mine Rescue Contest