

**HARLAN SAFETY DAYS MINE RESCUE CONTEST**  
**SUPERINTENDENT STATEMENT DAY 1**  
**JULY 24, 2013**

Thank you for coming to help us. You are located at the fresh air base of the Harco #1 mine. This is a large mine with multiple fans.

This morning 35 miners entered the mine. Around 9:00 am this morning the incident occurred. There was a loud rush of air out the portals and the CO system alarmed. The Responsible Person tried to contact the miners underground but was not able to contact anyone. We reported this to MSHA and contacted mine rescue teams. At 10:30 am 25 miners were able to escape. The other 10 miners are unaccounted for. There are multiple mine rescue teams working different areas of the mine at the same time you will be working. Due to work being conducted on the surface around the fan area bare face, you must inform the Superintendent of any smoke and what gases and their concentrations you will be ventilating through the air shaft before you do so. If you find a miner please inform the Superintendent of their identification. There will be a paper provided for doing both of these tasks. You must write it down and hand to the Superintendent.

The area you will be exploring contains an exhaust shaft with an exhaust fan. Due to air course restriction you will only be able to use this fan to ventilate. The fan is off and once started it cannot be shut off, reversed or stalled due to damage that will be caused to the fan. You must inform the Superintendent when you want the fan started. The area is air locked and if you do not maintain the air lock, air will migrate to the exhaust shaft and could cause gases to move. If you remove the airlock you must control the air flow

direction to the exhaust shaft. Once the fan is started it will control the air flow. The out-by portion of the mine has been explored and is safe to ventilate through.

The area you are exploring contains a refuge alternative and at the time of the incident 4 miners were shown on the tracking system to be in the area also.

The mine has a history of bad roof, water and methane. The mine maps are up to date but does not have the RA location. We have a competent life line person to give and take life line signals if necessary. There are back up and standby teams ready to assist you.

Once your team goes in-by, the Briefing Officer will be stationed in an airtight isolation area and you only will be able to contact him through your communication system.

You will be given two maps you are to denote which one is the Team map and which one is the Briefing Officer map.

Please find the 4 missing miners. Thank you and good luck.

# **PROBLEM**

**ACCOUNT FOR ALL MISSING MINERS  
AND BRING SURVIVORS TO THE FAB**

**EXPLORE ALL AREAS OF THE MINE THAT  
CAN BE DONE SAFELY**

**YOU CAN ONLY CARRY TWO SETS OF  
BRATTICE CLOTH WITH YOU AT A TIME**

**YOU HAVE 80 MINUTES TO WORK BEFORE  
BEING REPLACED BY ANOTHER TEAM**

# **PATIENT STATEMENT RA**

**HELP!! GET ME OUT**

# Harlan Day #1

Scale: 1 inch = 20 feet

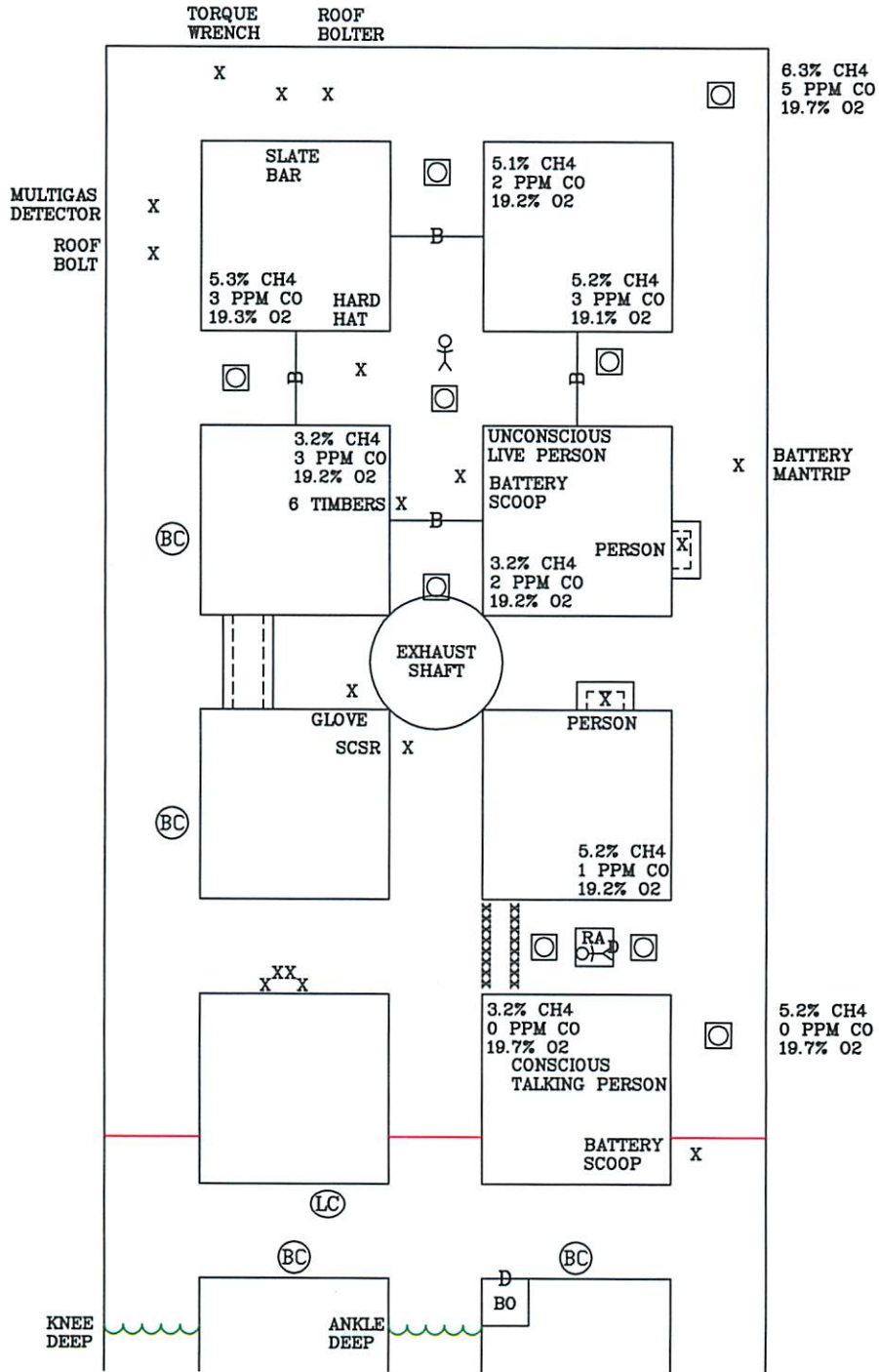



# Harlan Day #1

Scale: 1 inch = 20 feet

## Second Vent

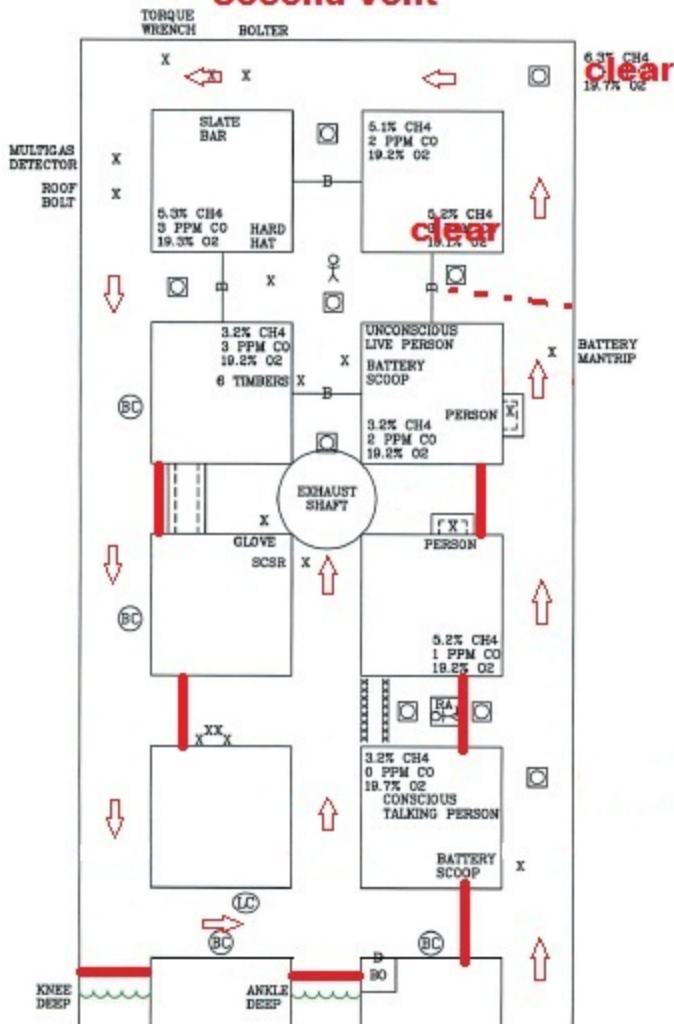

# Harlan Day #1

Scale: 1 inch = 20 feet

## Third Vent

