

Vent 1

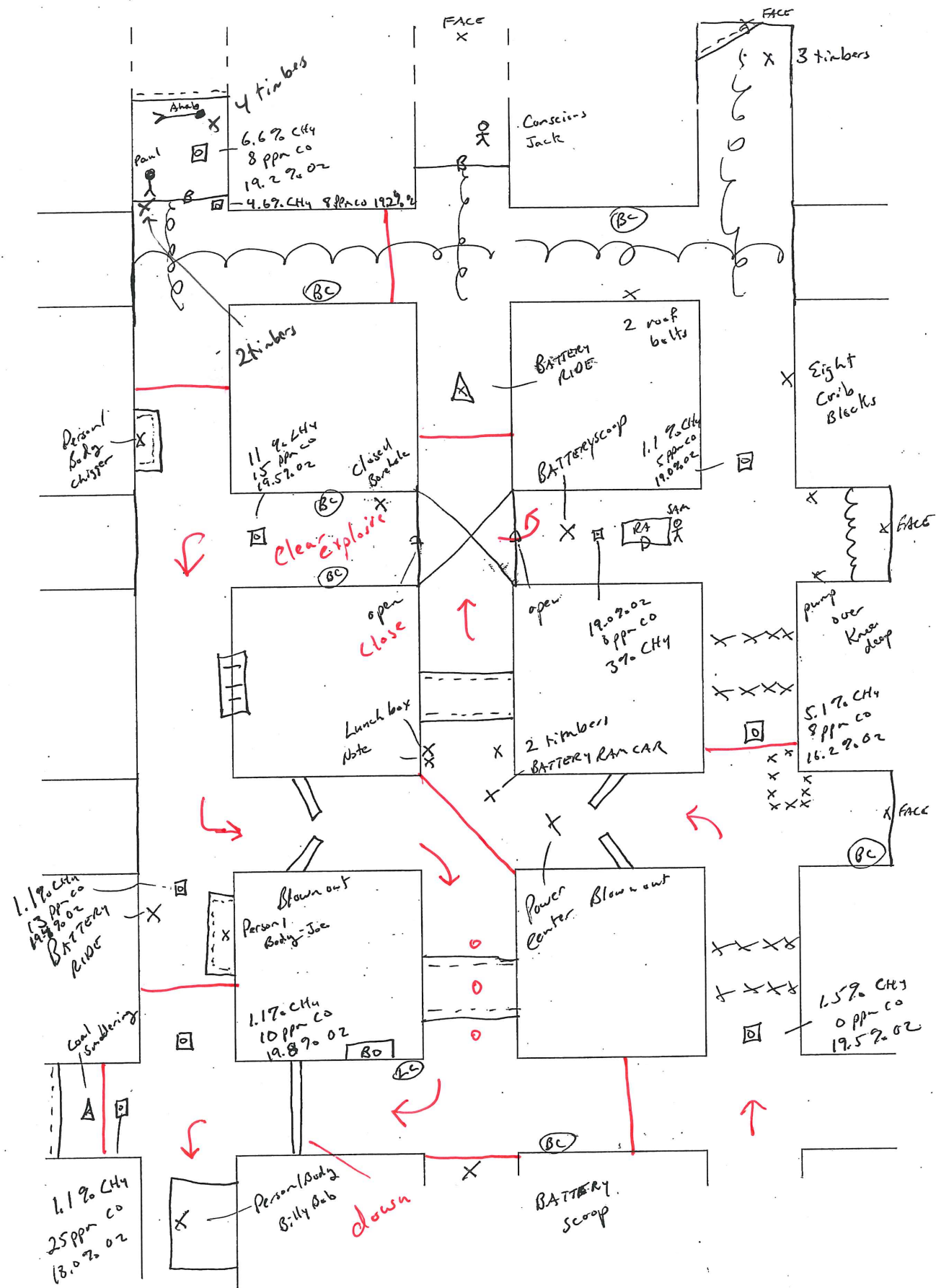

Vent 2

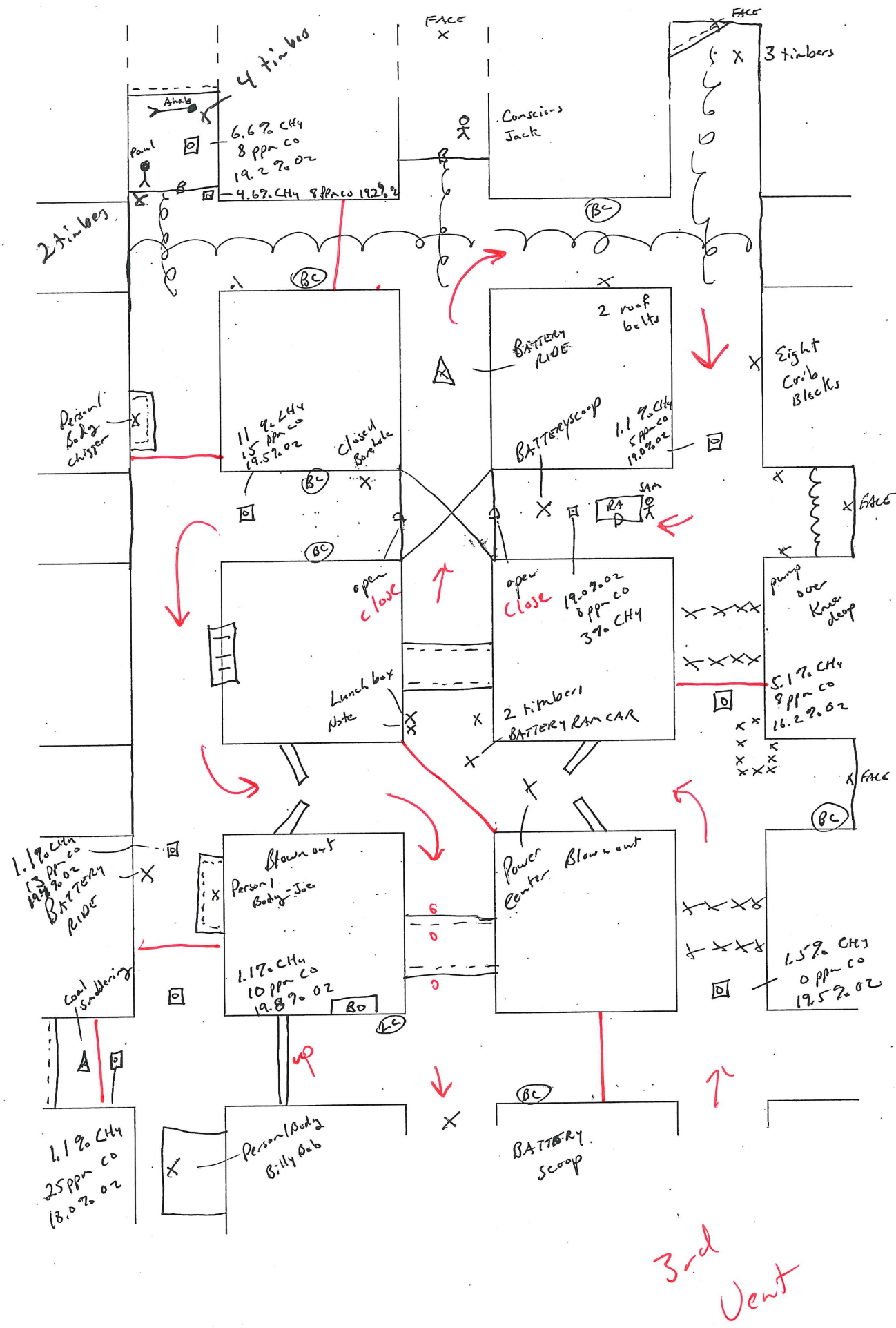

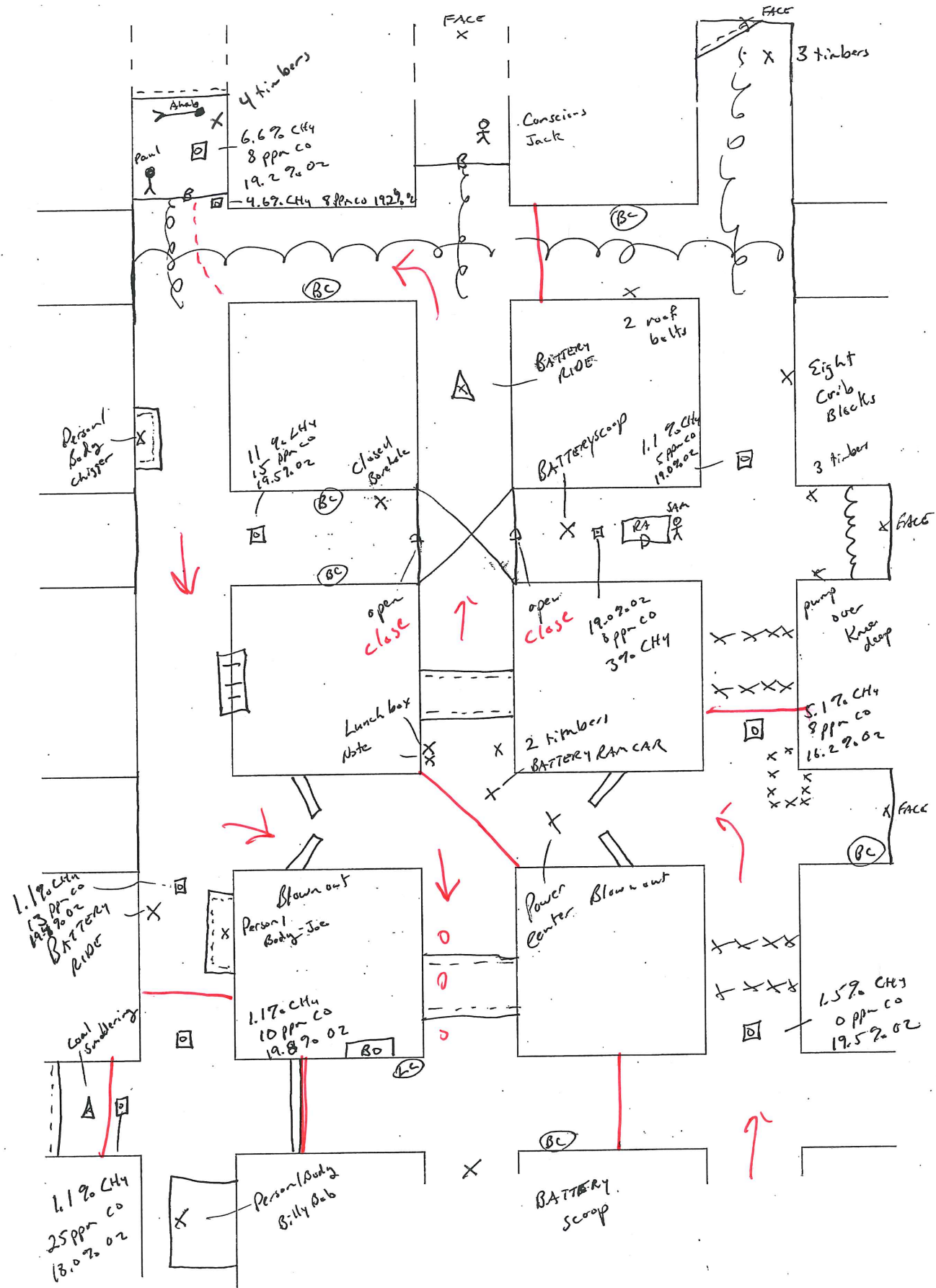

4th Vent



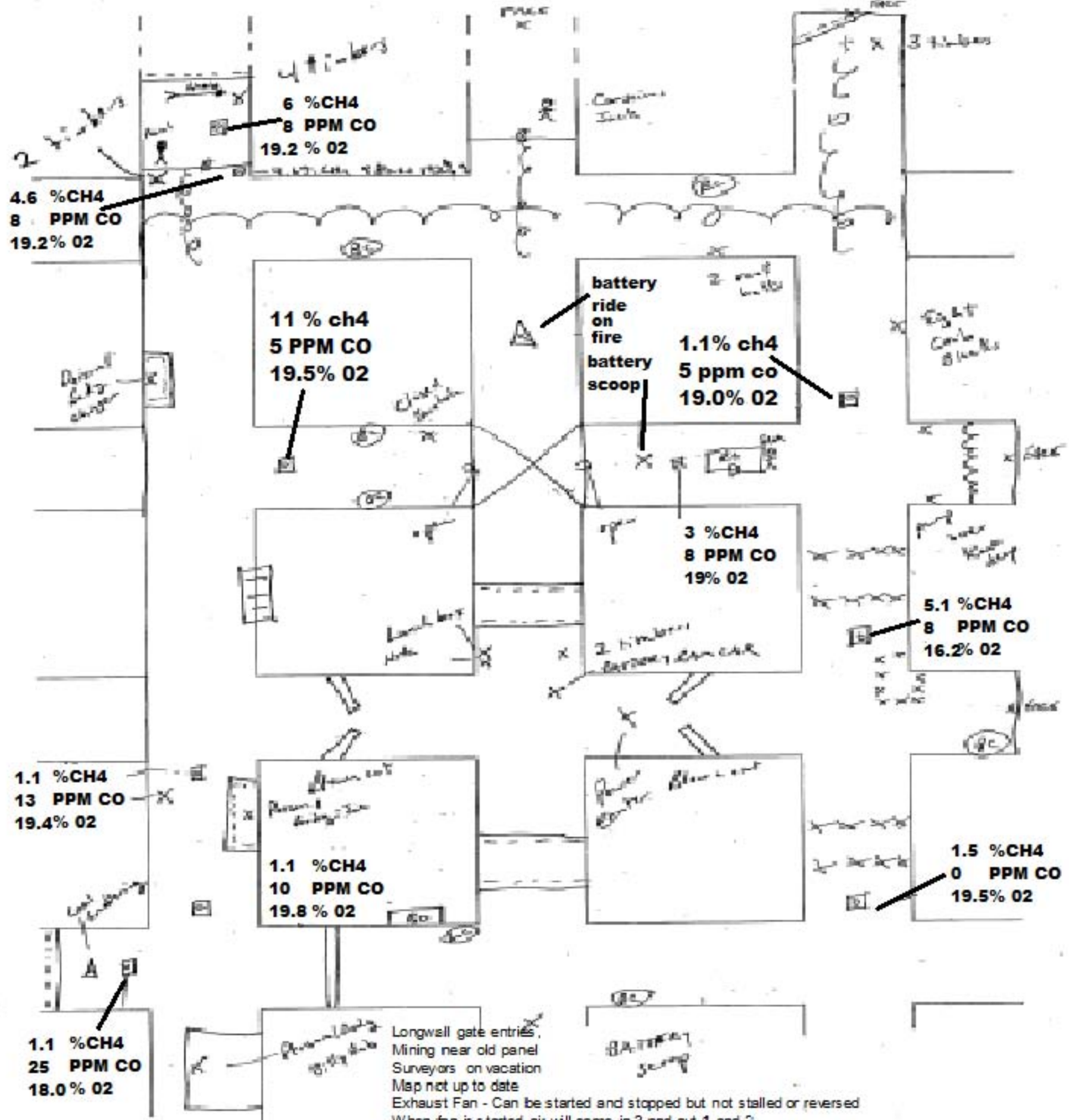

Longwell gate entries,  
 Mining near old panel  
 Surveyors on vacation  
 Map not up to date  
 Exhaust Fan - Can be started and stopped but not stalled or reversed  
 When fan is started air will come in 3 and out 1 and 2  
 7 persons  
 Call out: names of persons before moving.

Person outby in 1 takes 4 timbers to reach.  
 Evidence of fire (25 ppm CO) in 1 right neck is stopped by gas test at fire. No quitter behind barricade in 1.  
 Delay if team explores last open in No. 1 entry.

## **Information missing from this problem**

The 4th ventilation does not have the 2 timbers in front of the barricade in 1.

They need to be set at the person before ventilating.